

BENCH MARK  
COUNTY ROAD DEPT. N 8 EL. 110772  
1 1/2" I.P. PROJECTING 0.48' ABOVE  
GROUND, N 12.009.67 W 35.31087  
APPROX. 290' N.W. OF 60' OF CREST  
ROAD.

- NOTES:**
1. FOR SYMBOLS SEE DRWG. C.S.2
  2. ALL DIMENSIONS TO PIPE LINES ARE GIVEN IN FEET UNLESS OTHERWISE SHOWN
  3. CONTRACTOR SHALL CONSTRUCT CESSPOOL 20" MIN. SIDEWALL DEPTH PER COUNTY DIVISION OF BLDG. & SAFETY, SHEET U.C.P. IS REV. 8-8-88.
  4. FOR STORM DRAIN PROFILES SEE C.S.3
  5. FOR SANITARY SEWER PROFILES SEE C.S.
  6. ROOF DRAIN CONNECTIONS TO STORM DRAIN SYSTEMS TO BE CONSTRUCTED UNDER PLUMBING DRAWINGS.
  7. ALL WATER & GAS LINES SHALL HAVE 30" MIN. COVER IN UNPAVED AREAS AND 36" MIN. COVER IN PAVED AREAS (PRESENT OR FUTURE).
  8. ALL PIPE SHALL HAVE 6" MIN. CLEARANCE FROM OTHER PIPE OR STRUCTURES.

(Private Sewer)  
PRIVATE CONTRACT NO. 5507  
LOMITA LOG DIST. NO. 7.1  
W.E. 27. 2nd's Ord. 8349.5

COUNTY OF LOS ANGELES, CALIFORNIA  
APPROVED, JOHN A. LAMBE, County Engineer  
By: *[Signature]*  
Asst. Sanitation Engineer  
APPROVED, *[Signature]*  
Chief Engineer  
By: *[Signature]*  
Office Engineer  
Checked: *[Signature]*  
Office of County Engineer Reg. C. E. No. 2526  
THE ABOVE APPROVAL IS FOR THE I.C.P.  
SEWER AND SANITATION ONLY.  
FUTURE STEEL PLATING DATE 1983, 1985 APPLY  
IN THE CONSTRUCTION OF THIS PROJECT.

SEE PAGE 2 FOR  
GENERAL NOTES

SUBMITTED *[Signature]*  
PALOS VERDES - CENTINELA VALLEY REGIONAL ENGINEER

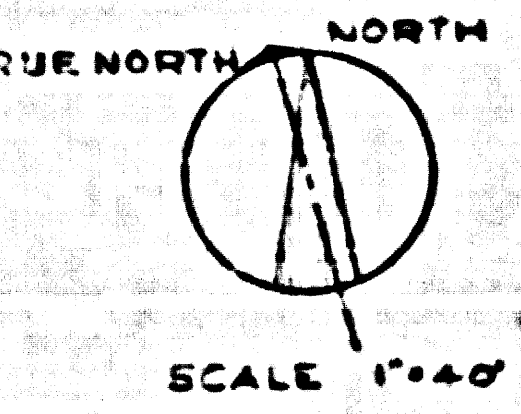

SCALE 1"=40'

NO.	DATE	REVISION	BY	CHK	NO.	DATE	REVISION	BY	CHK

**N O R T R O N I C S**  
ELECTRONIC SYSTEMS & EQUIPMENT FACILITY  
RESEARCH & DEVELOPMENT LABORATORIES  
PALOS VERDES CALIFORNIA

PREPARED BY	APPROVED BY	PREPARED UNDER THE DIRECTION OF
DESIGNER: <i>[Signature]</i>	CHIEF OF PROJECT: <i>[Signature]</i>	ARCHITECT: <i>[Signature]</i>
DRAWING: <i>[Signature]</i>	ENGINEERING COORDINATOR: <i>[Signature]</i>	ENGINEER: <i>[Signature]</i>
NO. CAPTAIN: <i>[Signature]</i>	PROJECT ARCHITECT: <i>[Signature]</i>	NO. ENGINEER: <i>[Signature]</i>
CHECKER: <i>[Signature]</i>	NO. CHECKER: <i>[Signature]</i>	NO. ENGINEER: <i>[Signature]</i>

EXTERIOR  
UTILITY PLAN  
SOUTH HALF

SCALE 1"=40'  
DATE 4-19-87

**CHARLES LUCKMAN ASSOCIATES**  
planning architecture engineering  
9220 sunset boulevard, los angeles 46, california







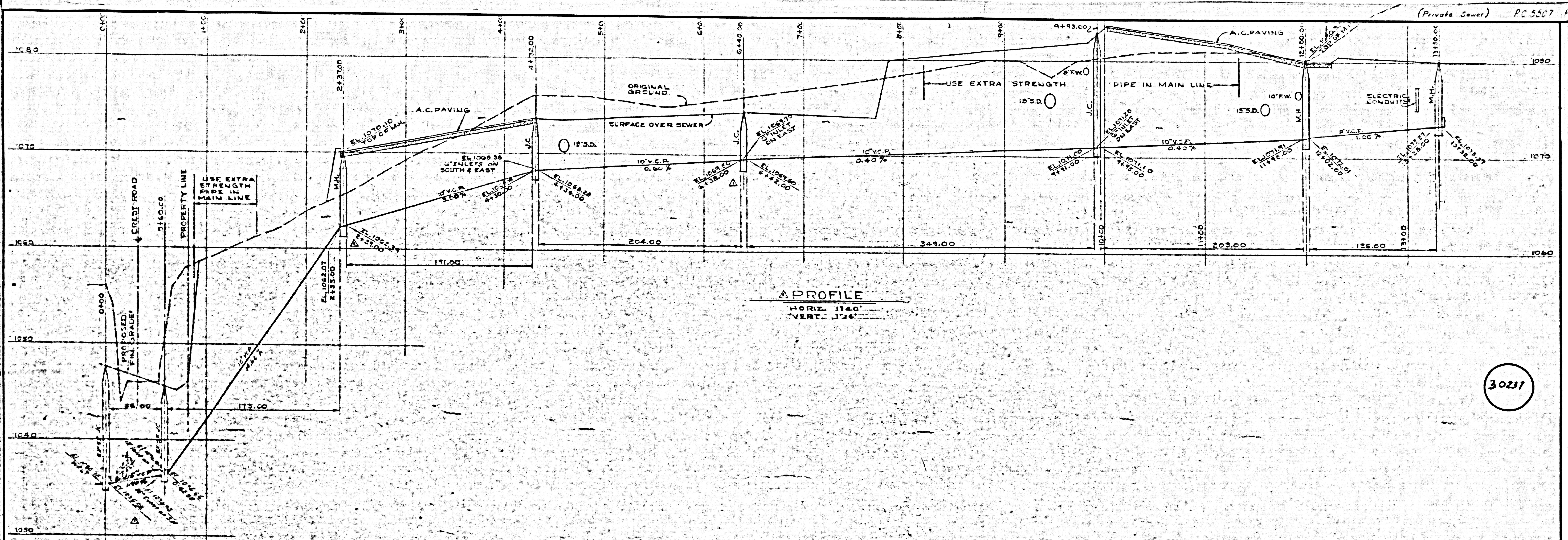

**A PROFILE**  
 HORIZ. 1140'  
 VERT. 1174'

30231

NO.	DATE	REVISION	BY	CHK.	NO.	DATE	REVISION	BY	CHK.

**NORTRONICS**  
 ELECTRONIC SYSTEMS & EQUIPMENT FACILITY  
 RESEARCH & DEVELOPMENT LABORATORIES  
 PALOS VERDES CALIFORNIA

PREPARED BY	APPROVED BY	PREPARED UNDER THE DIRECTION OF
DESIGNED BY C.H.P.	CHIEF OF PROJECTS C.H.P.	ARCHITECT D.P. [Signature]
DRAWN BY C.E.L.L.K.	ENGINEERING SUPERVISOR D.P. [Signature]	ENGINEER D.P. [Signature]
JOB CAPTAIN R.B.	PROJECT ARCHITECT D.P. [Signature]	FOR OFFICE D.P. [Signature]
CHECKER J.C.F.	THIS DRAWING IS NOT TO BE CONSIDERED FINAL UNTIL ALL OF THE REQUIRED SIGNATURES OF APPROVAL HAVE BEEN APPLIED.	

SANITARY SEWER  
 PROFILE

NO. 1164.0  
**C**  
**3.6**  
 DATE 4-1-74

**CHARLES LUCKMAN ASSOCIATES**  
 Planning architecture engineering  
 9220 sunset boulevard, los angeles 46, california

