

LA PUENTE BLDG. DIST. NO. 202

PROFILE ALIGNMENT AND GRADE OF P.C. 5511
 SANITARY SEWERS PAGE 1
 TO BE CONSTRUCTED IN U.N. 086238

SANITARY SEWER RIGHT OF WAY

PRIVATE CONTRACT NO. 5511

W.S. 36

1 SHEET OF 2 PAGES

SCALE: HORIZ. 1" = 40' VERT. 1" = 4' APRIL, 1960

PREPARED IN THE OFFICES OF
 KEMMERER ENGR. CO. INC.

BY: Robert R. Flores
 REG. C. E. NO. 11888

FOR LEGEND SEE PLAN NO. SA-44

- NOTES:
1. PROVIDE STAKES ON THE PROPERTY LINE OR PROPERTY LINES PRODUCED AT RIGHT ANGLES TO THE SEWER LINE AT THE CENTER LINE OF EACH MANHOLE.
 2. NO REPRESENTATIVE OF THE CITY ENGINEER WILL SURVEY OR LAY OUT ANY PORTION OF THE WORK.
 3. THE OWNER OR HIS AUTHORIZED REPRESENTATIVE SHALL FURNISH THE CITY ENGINEER WITH GRADE SHEETS AND STAKING FOR ALL HOUSE LATERALS AND Y BRANCHES AND SHALL PROVIDE STAKES FOR THEM AT THEIR PROPER LOCATIONS WITH STAKING PLAINLY MARKED. ANY CHANGE IN LOCATION SHALL BE REQUESTED IN WRITING BY THE OWNER OR HIS REPRESENTATIVE.
 4. THE PRIVATE ENGINEER SHALL FURNISH THE HOUSE LATERAL DEPTH AT THE PROPERTY LINE BELOW THE TOP OF CURB ELEVATION FOR EACH HOUSE LATERAL ON THE GRADE SHEET.
 5. NO REVISIONS SHALL BE MADE IN THESE PLANS WITHOUT THE APPROVAL OF THE CITY ENGINEER.
 6. USE STANDARD MANHOLE FRAMES AND COVERS, 24" DIA., COVERS TO READ "SEWERS"
 7. USE STANDARD STRENGTH PIPE
 8. USE CEMENT MORTAR OR "WEDGELOCK" OR "SPED-SEAL" FOR ALL V.C.P. JOINTS PER SPEC. SECS. 14 & 15.
 9. RESURFACE ALL TRENCH WITHIN PAVED AREA TO MEET L.A. COUNTY ROAD DEPT. OR CALIF. STATE HIGHWAY REQUIREMENTS IN ACCORDANCE WITH PERMITS.
 10. ENCASE FOUR FEET OF SEWER AT POINTS OF INTERFERENCE WITH POLES, CASE III, 2-172.
 11. HOUSE LATERALS TO BE CONSTRUCTED WITH "WYBRASS-A" PROGRAM LINE 24" BELOW GROUND GRADE EXCEPT 40' HIGHER.
 12. ALL STRUCTURES SHALL BE BRICK SEWER STRUCTURES, 2-104.
 13. FOR ALLOWABLE LEAKAGE TEST SEE FORMULA NO. 1 SPEC. SEC. 24.
 14. MANHOLE TOPS IN UNIMPROVED RIGHTS-OF-WAY TO BE SIX INCHES ABOVE FINISHED GRADE.
 15. THE CONTRACTOR SHALL NOTIFY THE CONSTRUCTION & STORM DRAIN DIVISION BY TELEPHONE, MADISON 5447, EXT. 2424 AT LEAST TWENTY-FOUR HOURS BEFORE STARTING ANY WORK UNDER THIS CONTRACT.
 16. STANDARD SPECIFICATIONS DATED JAN. 1960 ON FILE WITH THE CITY APPLY IN THE CONSTRUCTION OF THIS PROJECT.

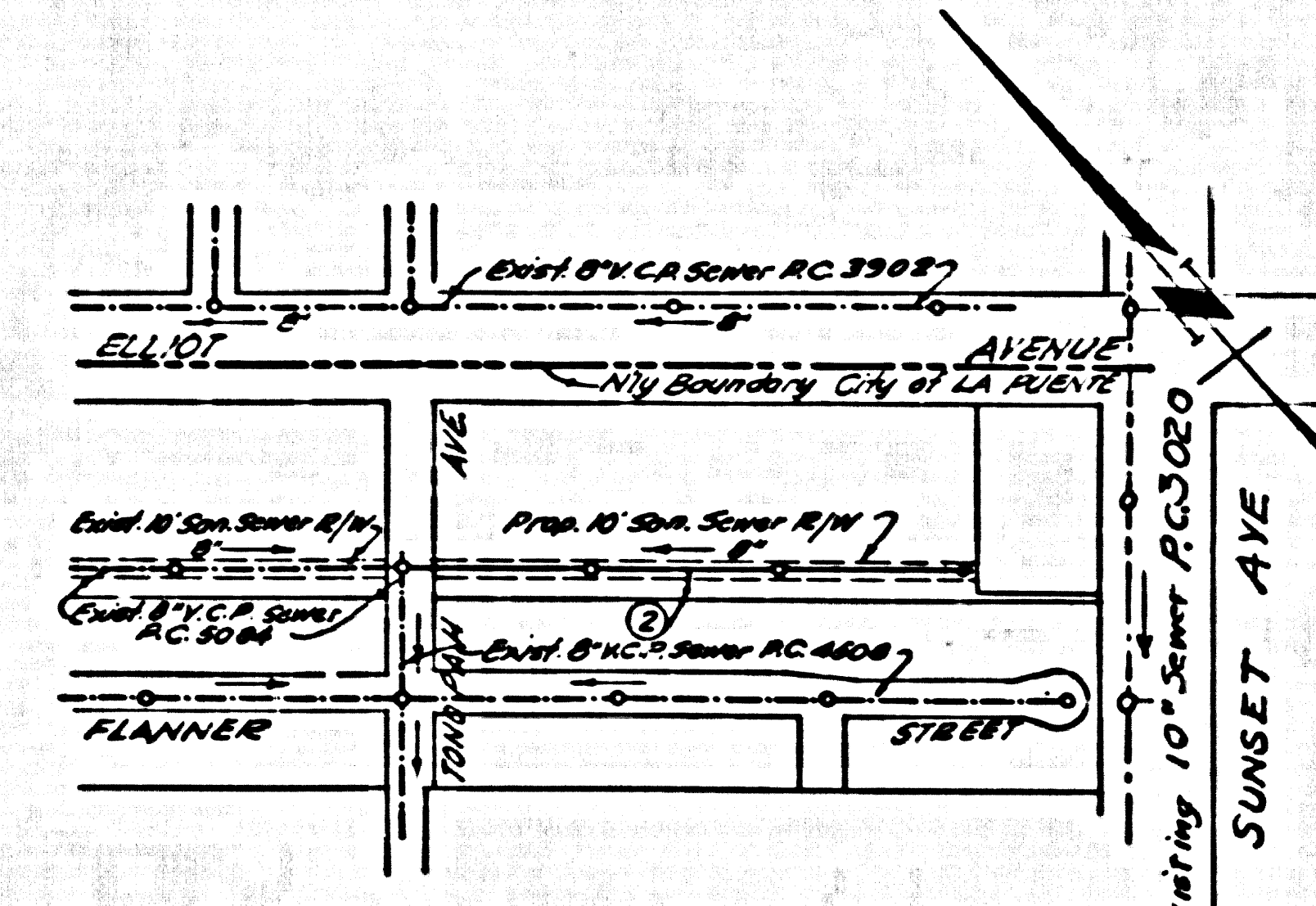

INDEX MAP
 P.C. 5511 Scale: 1" = 300'

B.M. 56 1100 (Reset) L&T. Near center of ck return at southwest cor. of Elliot Ave & Sunset Ave 48' South & 54' West & Inter. (Puente Quad) Elevation 118.313 - 1955

NO CHARGE FOR CONNECTIONS
 7/7/60 J. J. J. 8-26-60

APPROVED BY:
 CITY OF LA PUENTE
 8-29-60

NOTE:
 GRADES TO WHICH THIS IMPROVEMENT IS TO BE CONSTRUCTED ARE SHOWN ON PLANS AND PROFILES. GRADE POINTS FOR TOP OF CURBS, CENTER LINE OF STREETS, OR CENTER LINE OF ALLEYS ARE SHOWN BY CIRCLES ON PROFILES. AT ALL POINTS BETWEEN DESIGNATED POINTS THE GRADE SHALL BE ESTABLISHED SO AS TO CONFORM TO A STRAIGHT LINE DRAWN BETWEEN SAID DESIGNATED POINTS.
 ELEVATIONS ARE IN FEET ABOVE U.S.C. & G.S. SEA LEVEL DATUM OF 1929.
 THIS DRAWING AND THE DATA HEREON ARE HEREBY MADE A PART OF THE SPECIFICATIONS OF THE CITY ENGINEER AND SHALL BE PROSECUTED ONLY IN THE PRESENCE OF THE CITY ENGINEER.
 BEFORE WORK CAN BE STARTED THE CONTRACTOR MUST OBTAIN A PERMIT TO EXCAVATE IN CITY STREETS FROM THE L.A. COUNTY ROAD DEPT., DISTRICT OFFICE NO. 1 AND PAY A FEE TO THE CITY ENGINEER.
 1957 C.E. MEANS ET AL. ARCHITECTS
 APPROVAL OF THIS PLAN BY THE CITY OF LA PUENTE DOES NOT CONSTITUTE A REPRESENTATION AS TO THE ACCURACY OF THE LOCATION OF OR THE EXISTENCE OR NON-EXISTENCE OF ANY UNDERGROUND UTILITY PIPE, OR STRUCTURE WITHIN THE LIMITS OF THIS PROJECT. THIS NOTE APPLIES TO ALL LABELS.
 IF WORK IS TO BE DONE IN A STATE HIGHWAY, A PERMIT MUST BE OBTAINED FROM THE STATE OF CALIFORNIA, DIVISION OF HIGHWAYS, 120 SOUTH SPRING STREET.

CITY OF LA PUENTE, CALIFORNIA
 APPROVED, JOHN A. LAMBE, CITY ENGINEER APPROVED, C.R. COMPTON, CHIEF ENGINEER
 CO. SAN. DIST. NO. 15
 BY: C.E. J. J. J. 8-26-60 BY: E.P. Bennett 8-29-60
 ASST. SANITATION ENGINEER P.L. OFFICE ENGINEER
 CHECKED BY: B.T. H. 8-31-60
 OFFICE OF CITY ENGINEER, REG. C.E. NO. 11636

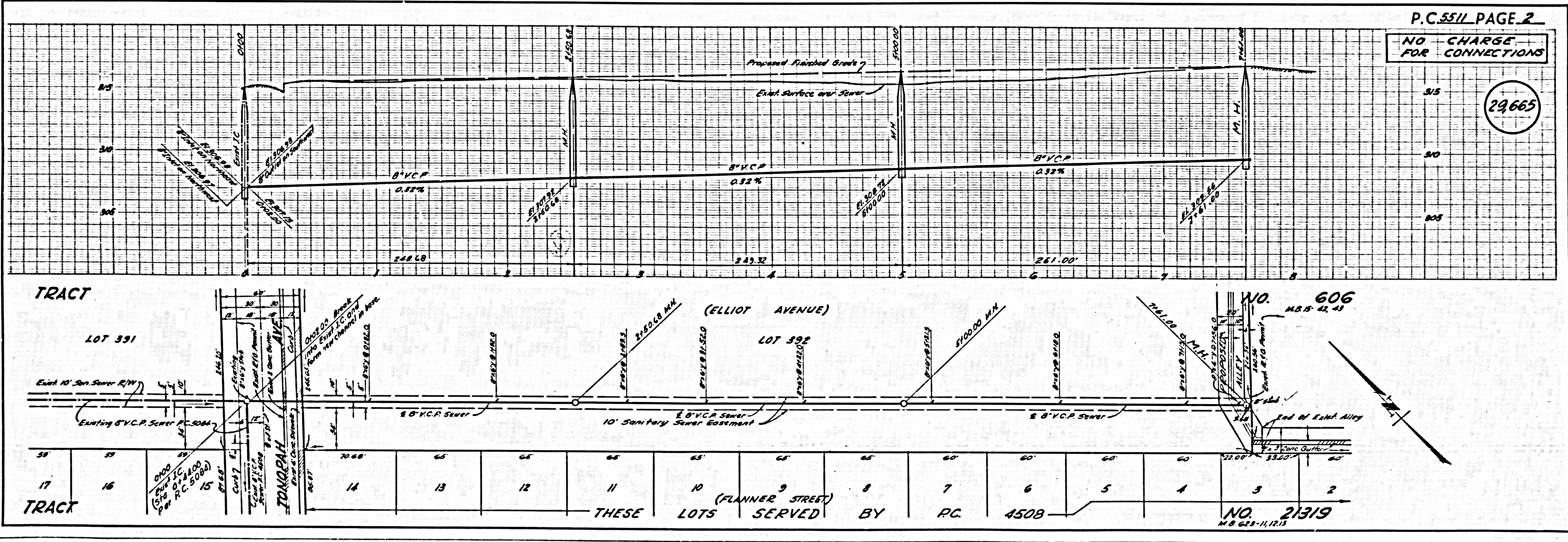

P.C. 5511 PAGE 2

NO CHARGE FOR CONNECTIONS

29665

TRACT

17	16	15	14	13	12	11	10	9	8	7	6	5	4	3	2
THESE LOTS SERVED BY P.C. 4508															

TRACT

NO. 21319
 M.B. 628-11, 12, 13