

WHITTIER BLDG. DIST. NO. 11

PROFILE ALIGNMENT AND GRADE OF P.C. 5536
 SANITARY SEWERS PAGE 1
 TO BE CONSTRUCTED IN JAN. 03.53.59

ANOLA ST. R/W
 PRIVATE CONTRACT NO. 5536

W.S. 34
 1 SHEETS; 2 PAGES

SCALE: HORIZ. 1" = 40' JUNE, 1960
 VERT. 1" = 4'

PREPARED IN THE OFFICES OF
 KEMMERER ENGR. CO., INC.
 BY Robert R. Flores
 REG. C. E. NO. 11349

29,532

FOR LEGEND SEE PLAN NO. S-A-44

- NOTES:
1. PROVIDE STAKES ON THE PROPERTY LINE OR PROPERTY LINES PRODUCED AT RIGHT ANGLES TO THE SEWER LINE AT THE CENTER LINE OF EACH MANHOLE.
 2. NO REPRESENTATIVE OF THE COUNTY ENGINEER WILL SURVEY OR LAY OUT ANY PORTION OF THE WORK.
 3. THE OWNER OR HIS AUTHORIZED REPRESENTATIVE SHALL FURNISH THE COUNTY ENGINEER WITH GRADE SHEETS AND STATIONING FOR ALL HOUSE LATERALS AND Y BRANCHES AND SHALL PROVIDE STAKES FOR THEM AT THEIR PROPER LOCATIONS WITH STATIONING PLAINLY MARKED. ANY CHANGE IN LOCATION SHALL BE REQUESTED IN WRITING BY THE OWNER OR HIS REPRESENTATIVE.
 4. THE PRIVATE ENGINEER SHALL FURNISH THE HOUSE LATERAL DEPTH AT THE PROPERTY LINE BELOW THE $\frac{1}{2}$ OF EASEMENT ELEVATION FOR EACH HOUSE LATERAL ON THE GRADE SHEET.
 5. NO REVISIONS SHALL BE MADE IN THESE PLANS WITHOUT THE APPROVAL OF THE COUNTY ENGINEER.
 6. USE STANDARD MANHOLE FRAMES AND COVERS, S-111, EXCEPT AS NOTED.
 7. USE STANDARD STRENGTH PIPE.
 8. USE CEMENT MORTAR OR "WEDGE-LOCK" OR "SEAL-SEAL" FOR ALL V.C.P. JOINTS PER SPEC'S, SECS. 34 & 41.
 9. RESURFACE ALL TRENCH WITHIN PAVED AREA TO MEET L.A. COUNTY ROAD DEPT. OR CALIF. STATE HIGHWAY REQUIREMENTS IN ACCORDANCE WITH PERMITS.
 10. ENCASE FOUR FEET OF SEWER AT POINTS OF INTERFERENCE WITH POLES, CASE III, S-172.
 11. HOUSE LATERALS TO BE CONSTRUCTED WITH INVERTS AT PROPERTY LINE $\frac{1}{2}$ FEET BELOW $\frac{1}{2}$ OF EASEMENT.
 12. ALL STRUCTURES SHALL BE BRICK SEWER STRUCTURES, S-104, EXCEPT AS NOTED.
 13. FOR ALLOWABLE LEAKAGE TEST USE FORMULA NO. 1 SPEC'S, SEC. 64.
 14. MANHOLE TOPS IN UNIMPROVED RIGHTS-OF-WAY TO BE LEVEL WITH FINISHED GRADE.
 15. THE CONTRACTOR SHALL NOTIFY THE CONSTRUCTION DIVISION BY TELEPHONE, MADISON 5-419, EXT. 8-352 AT LEAST TWENTY-FOUR HOURS BEFORE STARTING ANY WORK UNDER THIS CONTRACT.
 16. STANDARD SPECIFICATIONS DATED JANUARY 1, 1960 APPLY IN THE CONSTRUCTION OF THIS PROJECT.

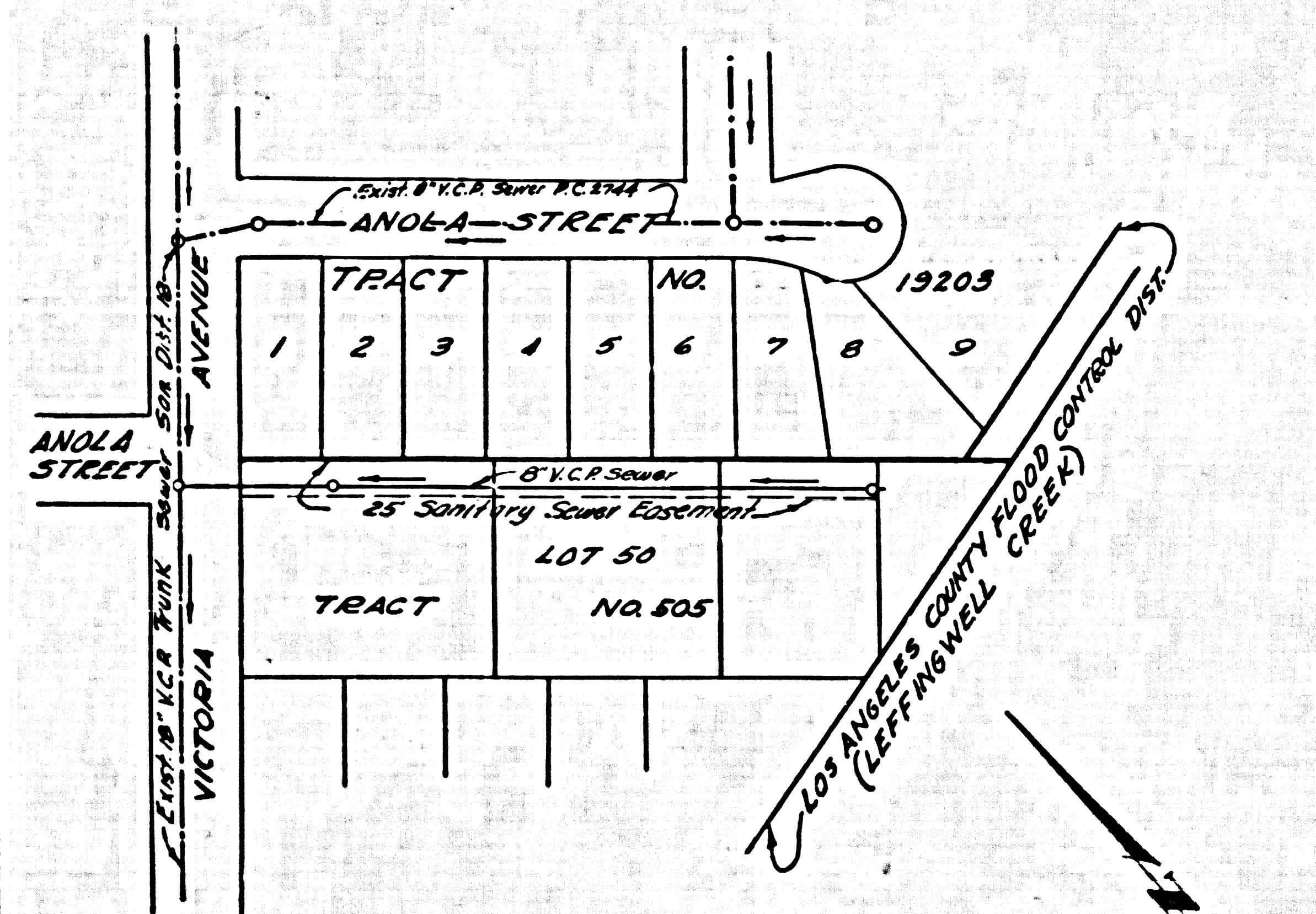

INDEX MAP
 P.C. 5536 SCALE: 1" = 40'
 JAN. 03.53.59

BLK. 50 1291 1ST 1/4 SW COR. OF
 AT SW COR. VICTORIA AVE &
 BROADWAY (SANTA FE ROAD)
 ELK 12203-12205

KEMMERER ENGINEERING CO. INC. ASSUMES NO
 RESPONSIBILITY FOR THE LOCATION OF EXISTING UTILITY
 LINES. A THOROUGH SEARCH HAS BEEN MADE BY THE
 UTILITY COMPANIES KNOWN TO HAVE LINES IN THIS AREA
 AND WITH THE COUNTY OF LOS ANGELES ENGINEERING
 SECTION. THE SEWER CONTRACTOR SHALL VERIFY THE
 LOCATIONS AND ELEVATIONS OF ALL UTILITY LINES.

Before breaking into any existing structure
 and before final acceptance of this work,
 County Sanitation District (DU 4-1281) shall
 be notified in order that required inspection
 can be made.

NO CHARGE FOR
 CONNECTIONS
 R. J. Hickland 7-15-60

NOTE:
 GRADES TO WHICH THIS IMPROVEMENT IS TO BE CONSTRUCTED ARE SHOWN ON PLANS AND PROFILES. GRADE POINTS
 FOR TOP OF CURBS, CENTER LINE OF STREETS, OR CENTER LINE OF ALLEYS ARE SHOWN BY CIRCLES ON PROFILES. AT ALL
 POINTS BETWEEN DESIGNATED POINTS THE GRADE SHALL BE ESTABLISHED SO AS TO CONFORM TO A STRAIGHT LINE DRAWN
 BETWEEN SAID DESIGNATED POINTS.
 ELEVATIONS ARE IN FEET ABOVE U.S.C. & G.S. MEAN SEA LEVEL DATUM OF 1929.
 THIS DRAWING AND THE DATA HEREON ARE HEREBY MADE A PART OF THE SPECIFICATIONS.
 WORK SHALL BE CONSTRUCTED ACCORDING TO SPECIFICATIONS ON FILE IN THE OFFICE OF THE COUNTY ENGINEER
 AND SHALL BE PROSECUTED ONLY IN THE PRESENCE OF THE COUNTY ENGINEER.
 BEFORE WORK CAN BE STARTED THE CONTRACTOR MUST OBTAIN A PERMIT TO EXCAVATE IN COUNTY STREETS FROM
 THE L. A. COUNTY ROAD DEPT., DISTRICT OFFICE NO. 4 AND PAY A FEE WITH THE COUNTY ENGINEER, ROOM
 224 FAY AMERICAN BUILDING, 315 SO. DOWNTOWN SUITE 1000 TO COVER THE COST OF CONSTRUCTION INSPECTION AND
 RECORD PLANS.
 APPROVAL OF THIS PLAN BY THE COUNTY OF LOS ANGELES DOES NOT CONSTITUTE A REPRESENTATION AS TO THE
 ACCURACY OF THE LOCATION OF OR THE EXISTENCE OR NON-EXISTENCE OF ANY UNDERGROUND UTILITY PIPE, OR STAC-
 TURE WITHIN THE LIMITS OF THIS PROJECT. THIS NOTICE APPLIES TO ALL PAGES.
 IF WORK IS TO BE DONE IN A STATE HIGHWAY, A PERMIT MUST BE OBTAINED FROM THE STATE OF CALIFORNIA, DIVISION
 OF HIGHWAYS, 128 SOUTH SPRING STREET.

COUNTY OF LOS ANGELES, CALIFORNIA
 APPROVED, JOHN A. LAMBIE, COUNTY ENGINEER APPROVED, G. R. CHAPMAN, CHIEF ENGINEER
 REG. SAN. ENG. NO. 12
 BY [Signature] BY [Signature]
 ASST. SANITATION ENGINEER OFFICE ENGINEER
 CHECKED BY [Signature] 7-25-60
 OFFICE OF COUNTY ENGINEER, REG. C. E. NO. 11626

SUBMITTED BY John L. Eaton 7-15-60
 LOS ANGELES REGIONAL ENGINEER, REG. C. E. NO. 3671

P.C. 5536 PAGE 2

NO CHARGE FOR CONNECTIONS

29,533

