

BY DIMENSION LINE

BENCH MARK - SG 608  
L.A. Co. Sur. Manu. of C.I.L. Int. of  
Baldwin Ave. and Olive St.  
Arcadia Quad. 1955 Adj.  
Elev. 347.942

NO CHARGE FOR  
CONNECTIONS  
W.L. Jan 9/76

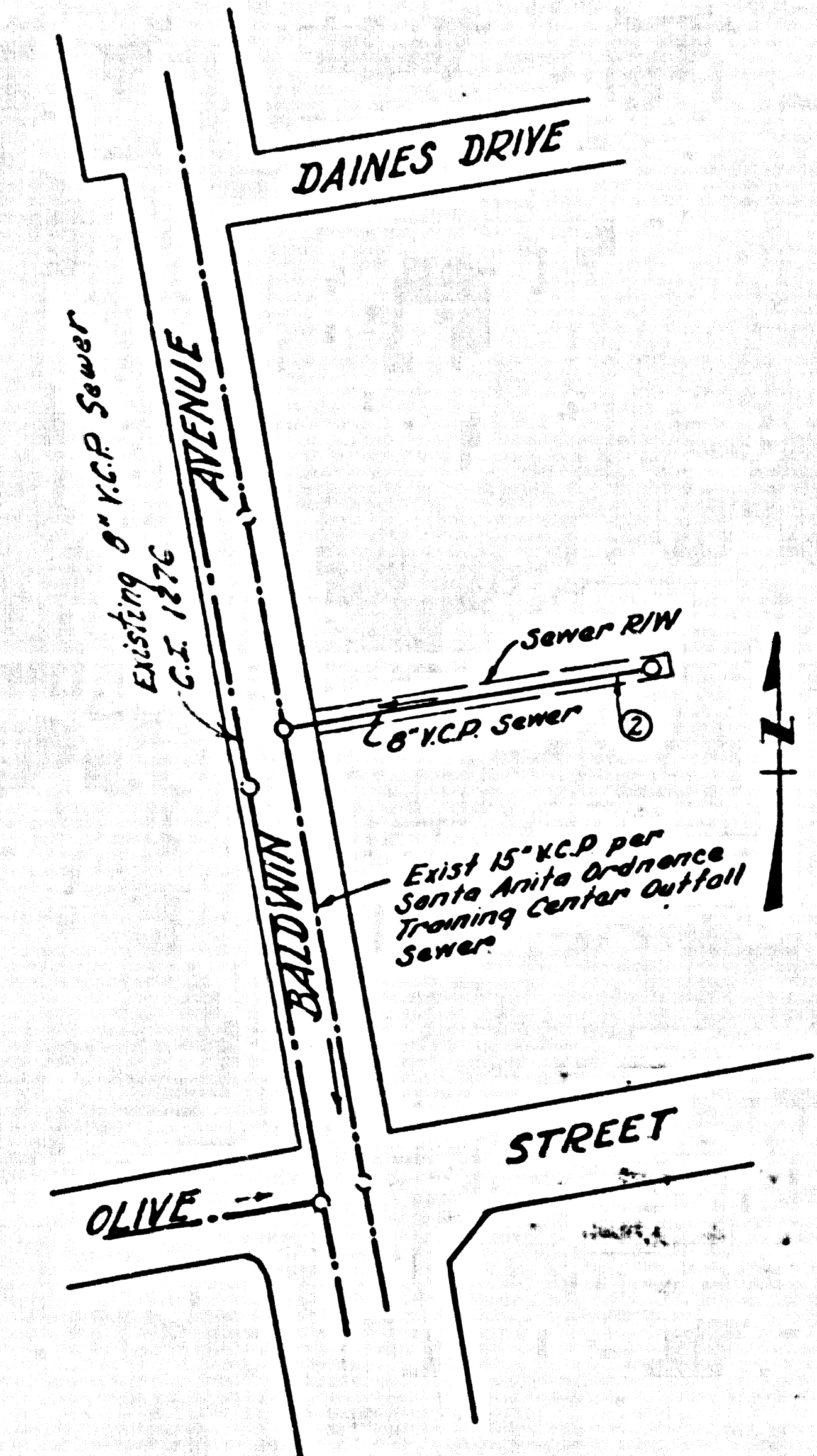

INDEX MAP  
Scale: 1"=100'  
RC 5579

### TEMPLE CITY BLDG. DIST. NO. 5.08

PROFILE ALIGNMENT AND GRADE OF **P.C. 5579**  
**SANITARY SEWERS** PAGE 1  
TO BE CONSTRUCTED IN

**RIGHT OF WAY EAST OF BALDWIN AVE.**  
**PRIVATE CONTRACT NO. 5579**

W.S. 44 D-5  
1 SHEETS; 2 PAGES  
SCALE: VERT. 1"=4'  
HORIZ. 1"=40' JUNE 1960  
PREPARED IN THE OFFICES OF

29,910

By: W.L. Hoffert  
REG. P. E. NO. 72  
FOR LEGEND SEE PLAN NO. S-A-44

- NOTES:
1. PROVIDE STAKES ON THE PROPERTY LINE OR PROPERTY LINES PRODUCED AT RIGHT ANGLES TO THE SEWER LINE AT THE CENTER LINE OF EACH MANHOLE.
  2. NO REPRESENTATIVE OF THE CITY ENGINEER WILL SURVEY OR LAY OUT ANY PORTION OF THE WORK.
  3. THE OWNER OR HIS AUTHORIZED REPRESENTATIVE SHALL FURNISH THE CITY ENGINEER WITH GRADE SHEETS AND STATIONING FOR ALL HOUSE LATERALS AND Y BRANCHES AND SHALL PROVIDE STAKES FOR THEM AT THEIR PROPER LOCATIONS WITH STATIONING PLAINLY MARKED. ANY CHANGE IN LOCATION SHALL BE REQUESTED IN WRITING BY THE OWNER OR HIS REPRESENTATIVE.
  4. NO REVISIONS SHALL BE MADE IN THESE PLANS WITHOUT THE APPROVAL OF THE CITY ENGINEER.
  5. USE STANDARD MANHOLE FRAMES AND COVERS, 2-111, COVER TO READ "SEWER"
  6. USE STANDARD STRENGTH PIPE
  7. USE CEMENT MORTAR OR "WEDGE-LOCK" OR "SPED-SEAL" FOR ALL V.C.P. JOINTS PER SPEC. SECS. M & M.
  8. RESURFACE ALL TRENCH WITHIN PAVED AREA TO MEET L.A. COUNTY ROAD DEPT. OR CALIF. STATE HIGHWAY REQUIREMENTS IN ACCORDANCE WITH PERMITS.
  9. ENCASE FOUR FEET OF SEWER AT POINTS OF INTERFERENCE WITH POLES, CASE III, 5-172.
  10. ALL STRUCTURES SHALL BE BRICK SEWER STRUCTURES, 1-104
  11. FOR ALLOWABLE LEAKAGE TEST USE FORMULA NO. 1, SPEC. SEC. 54
  12. MANHOLE TOPS IN UNIMPROVED AREAS TO BE LEVEL WITH FINISHED GRADE
  13. THE CONTRACTOR SHALL NOTIFY THE CONSTRUCTION DIVISION BY TELEPHONE, MADISON 3-4717, @ 5:30 P.M., AT LEAST TWENTY-FOUR HOURS BEFORE STARTING ANY WORK UNDER THIS CONTRACT.
  14. STANDARD SPECIFICATIONS DATED OCTOBER 1958, SHALL BE USED IN THE CONSTRUCTION OF THIS PROJECT.

Before breaking into any existing structure  
and before final acceptance of this work,  
County Sanitation District (SU 4-1281) shall  
be notified in order that required inspection  
can be made.

NOTE:  
GRADES TO WHICH THIS IMPROVEMENT IS TO BE CONSTRUCTED ARE SHOWN ON PLANS AND PROFILES. GRADE POINTS FOR TOP OF CURB, CENTER LINE OF STREETS OR CENTER LINE OF ALLEYS ARE SHOWN BY CIRCLES ON PROFILE. AT ALL POINTS BETWEEN DESIGNATED POINTS THE GRADE SHALL BE ESTABLISHED SO AS TO CONFORM TO A STRAIGHT LINE DRAWN BETWEEN SAID DESIGNATED POINTS.  
ELEVATIONS ARE IN FEET ABOVE U.S.C. & G.S. SEA LEVEL DATUM OF 1929.  
THIS DRAWING AND THE DATA HEREON ARE HEREBY MADE A PART OF THE SPECIFICATIONS.  
WORK SHALL BE CONSTRUCTED ACCORDING TO SPECIFICATIONS ON FILE IN THE OFFICE OF THE CITY ENGINEER AND SHALL BE PROSECUTED ONLY IN THE PRESENCE OF THE CITY ENGINEER.  
BEFORE WORK CAN BE STARTED, THE CONTRACTOR MUST OBTAIN A PERMIT TO ENCASE IN CITY STREETS FROM THE L.A. COUNTY ROAD DEPT., DISTRICT OFFICE NO. 1, AND MAKE A DEPOSIT WITH THE CITY OF TEMPLE CITY, ENGINEER TO COVER THE COST OF CONSTRUCTION INSPECTION AND RECORD PLANS.  
APPROVAL OF THIS PLAN BY THE CITY OF TEMPLE CITY DOES NOT CONSTITUTE A REPRESENTATION AS TO THE ACCURACY OF THE LOCATION OF OR THE EXISTENCE OR NON-EXISTENCE OF ANY UNDERGROUND UTILITY PIPE, OR STRUCTURE WITHIN THE LIMITS OF THIS PROJECT. THIS NOTE APPLIES TO ALL PAGES.  
IF WORK IS TO BE DONE IN A STATE HIGHWAY, A PERMIT MUST BE OBTAINED FROM THE STATE OF CALIFORNIA, DIVISION OF HIGHWAYS, 126 SOUTH SPRING STREET.

**CITY OF TEMPLE CITY, CALIFORNIA**  
APPROVED, JOHN A. LAMBE, CITY ENGINEER APPROVED, C.R. COMPTON, CHIEF ENGINEER  
CO. ENG. DIV. NO. 15  
BY: W.L. Hoffert ASST. SANITATION ENGINEER BY: W.L. Hoffert OFFICE ENGINEER  
CHECKED BY: W.L. Hoffert 10-21-60  
OFFICE OF CITY ENGINEER, REG. C. E. NO. 3406  
Submitted N.F. Brander  
San Gabriel Valley Regional Engineer

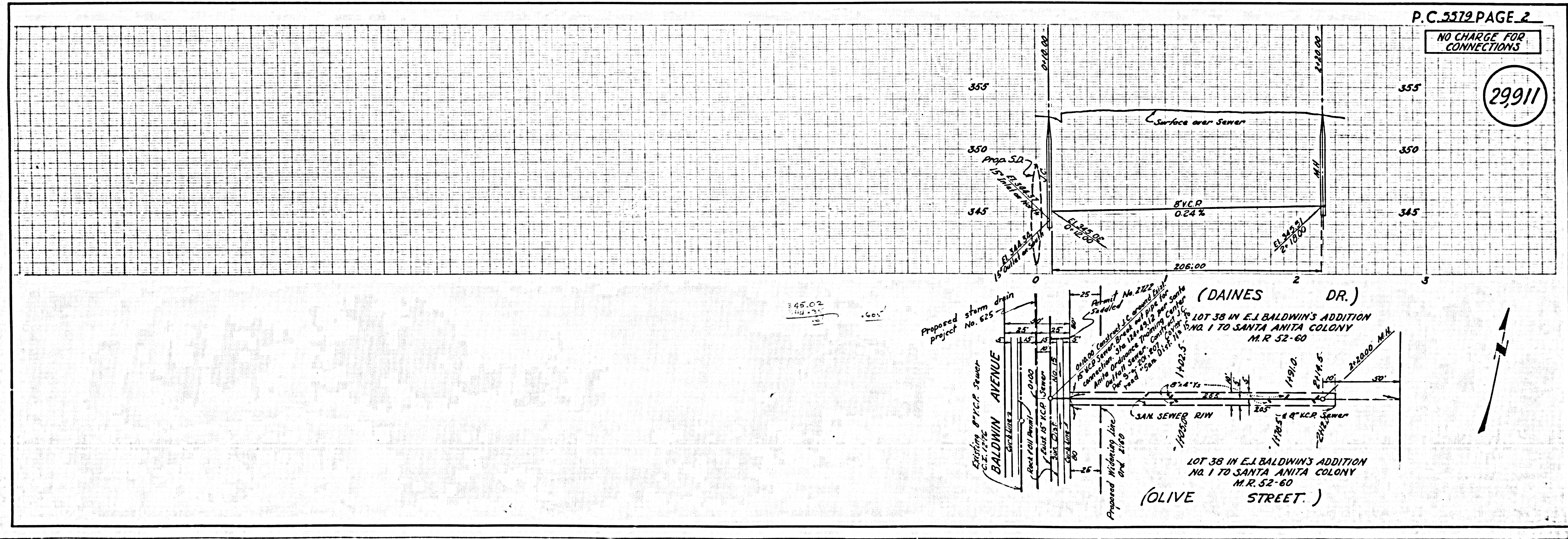

P.C. 5579 PAGE 2

NO CHARGE FOR CONNECTIONS

29,911