

BENCH MARK SY 378 ELEV 153.867
 L#8 NAIL IN 5"x6" CONC. VALVE BOX NEAR EAST
 PROPERTY LINE OF BUILDING 11655 40'± NORTH
 OF THE CENTER LINE OF WASHINGTON BLVD.
 (SANTA FE QUAD)

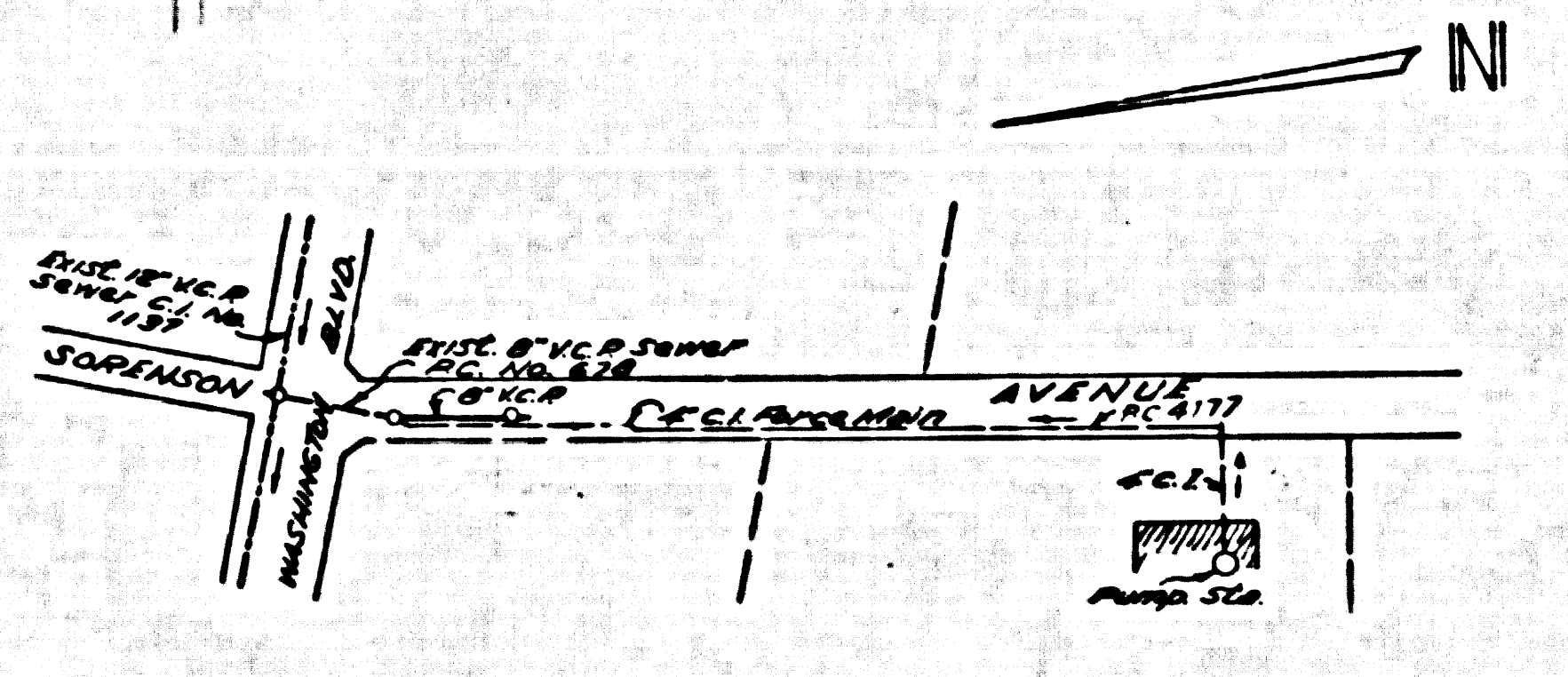

INDEX MAP
 SCALE: 1"=200' P.C. 5620
 J.N. 0354.15

CONNECTION CHARGE
 AS INDICATED
 12-7-60

WHITTIER BLDG. DIST. NO. 11

- NOTES:
- PROVIDE STAKES ON THE PROPERTY LINE OR PROPERTY LINES PRODUCED AT RIGHT ANGLES TO THE SEWER LINE AT THE CENTER LINE OF EACH MANHOLE.
 - NO REPRESENTATIVE OF THE COUNTY ENGINEER WILL SURVEY OR LAYOUT ANY PORTION OF THE WORK.
 - THE OWNER OR HIS AUTHORIZED REPRESENTATIVE SHALL FURNISH THE COUNTY ENGINEER WITH GRADE SHEETS AND STATION FOR ALL HOUSE LATERALS AND Y BRANCHES AND SHALL PROVIDE STAKES FOR THEM AT THEIR PROPER LOCATIONS WITH STATIONING AND PLANTER MARKERS. ANY CHANGE IN LOCATION SHALL BE REQUESTED IN WRITING BY THE OWNER OR HIS REPRESENTATIVE.
 - NO REVISIONS SHALL BE MADE IN THESE PLANS WITHOUT THE APPROVAL OF THE COUNTY ENGINEER.
 - USE STANDARD MANHOLE FRAMES AND COVERS, S-A-117
 - USE STANDARD STRENGTH PIPE
 - USE CEMENT MORTAR OR "WEDGE-LOCK" OR "SPEEDSEAL", PER SPEC'S SECS. 36 & 41
 - ASSURANCE ALL TRENCH WITHIN PAVED AREA TO HAVE 1" A. COUNTY ROAD DEPT., OR CALIF. STATE HIGHWAY DEPT. REQUIREMENTS IN ACCORDANCE WITH PERMITS.
 - ENCASE FOUR FEET OF SEWER AT POINTS OF INTERFERENCE WITH POLES, SA 172 CASE III
 - HOUSE LATERALS TO BE CONSTRUCTED WITH INVERTS AT PROPERTY LINE, 6" FEET BELOW CURB GRADE EXCEPT AS NOTED.
 - ALL STRUCTURES SHALL BE BRICK SEWER STRUCTURES, S-A-104.
 - FOR ALLOWABLE LEAKAGE TEST USE FORMULA NO. 1 SPEC'S, SEC. 54
 - MANHOLE TOPS IN UNIMPROVED RIGHTS-OF-WAY TO BE 6" ABOVE FINISHED GRADE.
 - THE CONTRACTOR SHALL NOTIFY THE CONSTRUCTION DIVISION BY TELEPHONE MAIN 5-4747 EXT. 4151 AT LEAST 24 HOURS BEFORE STARTING ANY WORK UNDER THIS CONTRACT
 - SPECIFICATIONS DATED OCT. 10, 1960 APPLY IN THE CONSTRUCTION OF THIS PROJECT
 - THE PRIVATE ENGINEER SHALL FURNISH THE HOUSE LATERAL DEPTH AT THE PROPERTY LINE BELOW THE TOP OF CURB ELEVATION FOR EACH HOUSE LATERAL ON THE GRADE SHEET.

NO CONNECTIONS FOR THE DISPOSAL OF INDUSTRIAL WASTES SHALL BE MADE TO SEWERS SHOWN ON THESE DRAWINGS WITHOUT WRITTEN PERMISSION FROM THE CHIEF ENGINEER AND GENERAL MANAGER OF THE COUNTY SANITATION DISTRICTS.

PROFILE ALIGNMENT AND GRADE OF P.C. 5620
 SANITARY SEWERS PAGE 1
 TO BE CONSTRUCTED IN J.N. 0354.15
 SORENSON AVENUE

PRIVATE CONTRACT NO. 5620
 W.S. 37
 1 SHEETS; 1 PAGES
 SCALE: VERT. 1"=4' HORIZ. 1"=40' JULY, 1960
 PREPARED IN THE OFFICES OF
 MCDANIEL ENGINEERING COMPANY
 BY: [Signature] REB. C. E. NO. 2808
 FOR LEGEND SEE PLAN NO. S-A-64

NOTES:
 GRADES TO WHICH THIS IMPROVEMENT IS TO BE CONSTRUCTED ARE SHOWN ON PLANS AND PROFILE GRADE POINTS FOR TOP OF CURBS, CENTER LINE OF STREETS, OR CENTER LINE OF ALLEYS ARE SHOWN BY CIRCLES ON PROFILES. AT ALL POINTS BETWEEN DESIGNATED POINTS THE GRADE SHALL BE ESTABLISHED SO AS TO CONFORM TO A STRAIGHT LINE DRAWN BETWEEN SAID DESIGNATED POINTS.
 REVISIONS ARE IN PINK ABOVE U.S.C. & G.S. SEA LEVEL DATUM OF 1929.
 THIS DRAWING AND THE DATA HEREON ARE HEREBY MADE A PART OF THE SPECIFICATIONS.
 WORK SHALL BE CONSTRUCTED ACCORDING TO SPECIFICATIONS ON FILE IN THE OFFICE OF THE COUNTY ENGINEER AND SHALL BE INSPECTED ONLY IN THE PRESENCE OF THE COUNTY ENGINEER.
 BEFORE WORK CAN BE STARTED, THE CONTRACTOR MUST OBTAIN A PERMIT TO EXCAVATE IN COUNTY SPACES FROM THE L.A. COUNTY ROAD DEPT., DISTRICT OFFICE 84-800 1ST FLOOR, WITH THE COUNTY ENGINEER, ROOM 1202 PAV. AMERICAN BLDG., 1100 S. 5TH ST., BROADWAY SUITABLE TO COVER THE COST OF CONSTRUCTION INSPECTION AND RECORD PLANS.
 APPROVAL OF THIS PLAN BY THE COUNTY OF LOS ANGELES DOES NOT CONSTITUTE A REPRESENTATION AS TO THE ACCURACY OF THE LOCATION OF OR THE EXISTENCE OR NON-EXISTENCE OF ANY UNDERGROUND UTILITIES, OR STRUCTURE WITHIN THE LIMITS OF THIS PROJECT. THIS NOTE APPLIES TO ALL PAGES.
 IF WORK IS TO BE DONE IN A STATE HIGHWAY, A PERMIT MUST BE OBTAINED FROM THE STATE OF CALIFORNIA, DIVISION OF HIGHWAYS, 120 SOUTH SPRING STREET.

COUNTY OF LOS ANGELES, CALIFORNIA
 APPROVED, JOHN A. LAMME, COUNTY ENGINEER
 APPROVED, [Signature] CHIEF ENGINEER
 BY: [Signature] DISTRICT SANITATION ENGINEER
 BY: [Signature] OFFICE ENGINEER
 CHECKED BY: [Signature] 12-7-60
 OFFICE OF COUNTY ENGINEER, BUREAU NO. 3505

SUBMITTED BY: [Signature] 12-7-60
 AS GERRITOS REGIONAL ENGINEER RE. 3871

P.C. 5620, PAGE 2
 CONNECTION CHARGES
 AS INDICATED

