

KEY MAP
SCALE 1"=100'
P.C. 5636

LANGASTER BLDG. DIST. NO. 8

- NOTES:
1. PROVIDE STAKES ON THE PROPERTY LINE OR PROPERTY LINES PRODUCED AT RIGHT ANGLES TO THE SEWER LINE AT THE CENTER LINE OF EACH MANHOLE.
 2. NO REPRESENTATIVE OF THE COUNTY ENGINEER WILL SURVEY OR LAY OUT ANY PORTION OF THE WORK.
 3. THE OWNER OR HIS AUTHORIZED REPRESENTATIVE SHALL FURNISH THE COUNTY ENGINEER WITH GRADE SHEETS AND STATIONING FOR ALL HOUSE LATERALS AND Y BRANCHES AND SHALL PROVIDE STAKES FOR THESE AT THEIR PROPER LOCATIONS WITH STATIONING PLAINLY MARKED. ANY CHANGE IN LOCATION SHALL BE REQUESTED IN WRITING BY THE OWNER OR HIS REPRESENTATIVE.
 4. THE PRIVATE LICHENERS SHALL FURNISH THE HOUSE LATERAL DEPTH AT THE PROPERTY LINE BELOW THE TOP OF CURB ELEVATION FOR EACH HOUSE LATERAL ON THE GRADE SHEET.
 5. NO REVISIONS SHALL BE MADE IN THESE PLANS WITHOUT THE APPROVAL OF THE COUNTY ENGINEER.
 6. USE STANDARD MANHOLE FRAMES AND COVERS, S-117.
 7. USE STANDARD STRENGTH PIPE.
 8. USE "WEDGE-LOCK" OR "SPEED-SEAL" FOR ALL V.C.P. JOINTS "8" SPEC., SECL. 34 & 8.
 9. RESURFACE ALL TRENCH WITHIN PAVED AREA TO MEET L.A. COUNTY ROAD DEPT. OR CALIF. STATE HIGHWAY REQUIREMENTS IN ACCORDANCE WITH PERMITS.
 10. DISCASE FOUR FEET OF SEWER AT POINTS OF INTERFERENCE WITH POLES, CASE 11, S-172.
 11. HOUSE LATERALS TO BE CONSTRUCTED WITH INVERTS AT PROPERTY LINE 6" FEET BELOW CURB GRADE EXCEPT AS NOTED.
 12. ALL STRUCTURES SHALL BE BRICK SEWER STRUCTURES, S-114.
 13. FOR ALLOWABLE LEAKAGE TEST USE FORMULA NO. 1, SPEC., SEC. 54.
 14. MANHOLE TOPS IN UNIMPROVED RIGHTS-OF-WAY TO BE SIX INCHES ABOVE FINISHED GRADE.
 15. THE CONTRACTOR SHALL NOTIFY THE CONSTRUCTION DIVISION BY TELEPHONE, HARRISON 9-6107, EXT. 81251 AT LEAST TWENTY-FOUR HOURS IN ONE STARTING ANY WORK UNDER THIS CONTRACT.
 16. STANDARD SPECIFICATION DATED OCTOBER 10, 1960, APPLY IN CONSTRUCTION OF THIS PROJECT.

BENCH MARK 31135
ELEVATION 236.6111 ROAD DEPARTMENT LANGASTER
BR 1957: LANGASTER BOULEVARD (SO. S. OF C.) AT
800' W. OF 15TH STREET WEST. L & T. in Conc.
Drive to House N# 1656, 3' S. and 1' W. of E. Edge
of Drive.

COLLECT CHARGES
AS INDICATED
11/10/60

PROFILE ALIGNMENT AND GRADE OF **P.C. 5636**
SANITARY SEWERS PAGE **1**
TO BE CONSTRUCTED IN JN 0354.30

LANGASTER BOULEVARD

PRIVATE CONTRACT NO. 5636

W.S. 71
1 SHEETS, 2 PAGES

SCALE: VERT. 1"=4' HORIZ. 1"=40'

SEPTEMBER 1960

HARRISON-LUSICH AND ASSOCIATES, INC.
2019 24TH STREET, BAKERSFIELD, CALIF.

FOR LEGEND SEE PLAN NO. S-A-64

NOTE:
GRADES TO WHICH THIS IMPROVEMENT IS TO BE CONSTRUCTED ARE SHOWN ON PLANS AND PROFILES. GRADE POINTS FOR TOP OF CURBS, CENTER LINE OF STREETS, OR CENTER LINE OF ALLEYS ARE SHOWN BY CIRCLES ON PROFILES. AT ALL POINTS BETWEEN INDICATED POINTS THE GRADE SHALL BE ESTABLISHED SO AS TO CONFORM TO A STRAIGHT LINE DRAWN BETWEEN SAID GRADE POINTS.
ELEVATIONS ARE IN FEET ABOVE M.S.C. & F.'S. SEA LEVEL DATUM OF 1929.
THE DRAWING AND THE DATA HEREON ARE HEREBY MADE A PART OF THE SPECIFICATIONS.
WORK SHALL BE CONSTRUCTED ACCORDING TO SPECIFICATIONS ON FILE IN THE OFFICE OF THE COUNTY ENGINEER AND SHALL BE INSPECTED ONLY IN THE PRESENCE OF THE COUNTY ENGINEER.
BEFORE WORK CAN BE STARTED, THE CONTRACTOR MUST OBTAIN A PERMIT TO EXCAVATE IN COUNTY STREETS FROM THE L. A. COUNTY ROAD DEPT., DISTRICT OFFICE NO. 3, AND PAY A FEE WITH THE COUNTY ENGINEER, ROOM 204 FARM ANGLEMAN BUILDING, 230 SO BROADWAY SUFFICIENT TO COVER THE COST OF CONSTRUCTION INSPECTION AND RECORD PLANS.
APPROVAL OF THIS PLAN BY THE COUNTY OF LOS ANGELES DOES NOT CONSTITUTE A REPRESENTATION AS TO THE ACCURACY OF THE LOCATION OF OR THE EXISTENCE OR NON-EXISTENCE OF ANY UNDERGROUND UTILITY PIPE, OR STRUCTURE WITHIN THE LIMITS OF THIS PROJECT. THIS NOTE APPLIES TO ALL PAGES.
IF WORK IS TO BE DONE IN A STATE HIGHWAY, A PERMIT MUST BE OBTAINED FROM THE STATE OF CALIFORNIA, DIVISION OF HIGHWAYS, 130 SOUTH SPRING STREET.

COUNTY OF LOS ANGELES, CALIFORNIA

APPROVED, JOHN A. LAMBE, COUNTY ENGINEER

APPROVED, C. R. COMPTON, CHIEF ENGINEER

CHECKED BY: 10-25-60

SUBMITTED: 10-25-60

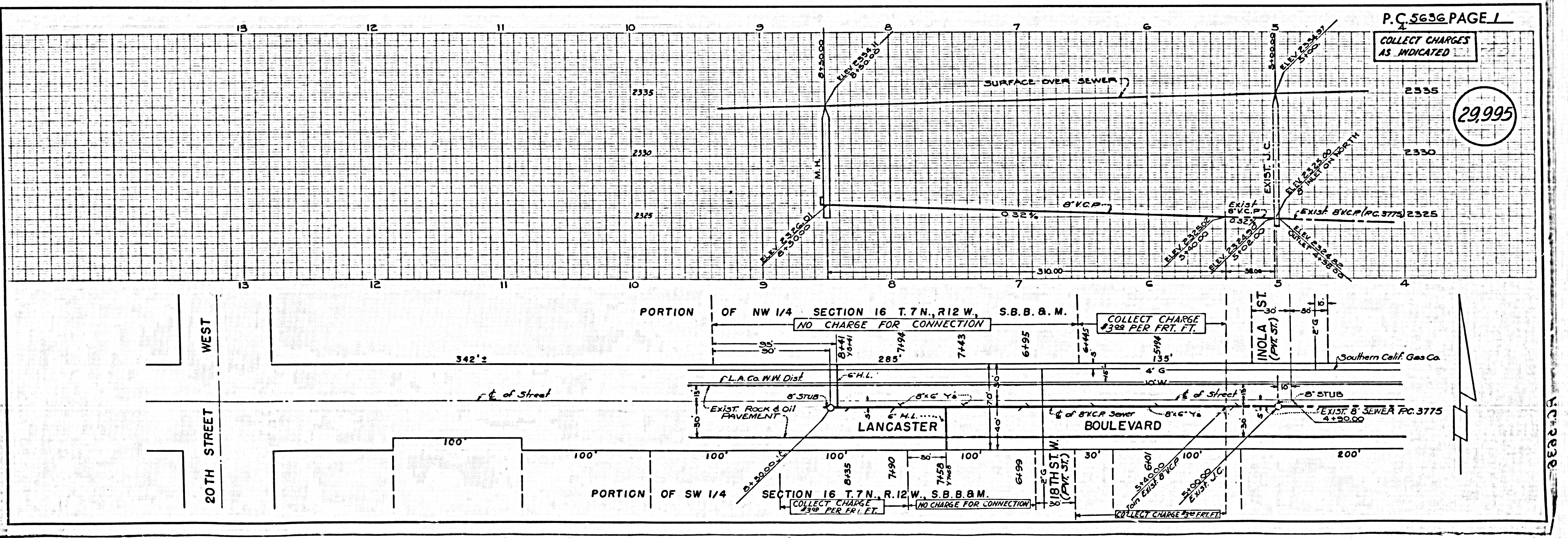

P.C. 5636 PAGE 1
COLLECT CHARGES AS INDICATED

29,995

PORTION OF NW 1/4 SECTION 16 T.7N., R.12W., S.B.B. & M. NO CHARGE FOR CONNECTION

PORTION OF SW 1/4 SECTION 16 T.7N., R.12W., S.B.B. & M. NO CHARGE FOR CONNECTION

COLLECT CHARGE \$325 PER FR. FT.

COLLECT CHARGE \$350 PER FR. FT.

COLLECT CHARGE \$350 PER FR. FT.

P.C. 5636