

Bench Mark S.S. 1107 Lead and tack N. Curb.
 Elliot Avenue 15' ± West of curb return at
 N.W. Corner Cadwell Street & Elliot Ave.
 1153 Adj. Elev. 324.228

(Subtract 0.204' from all elevations on
 this plan to be on 1955 Adjustment which
 is Elev. 324.024 Purple Quad)

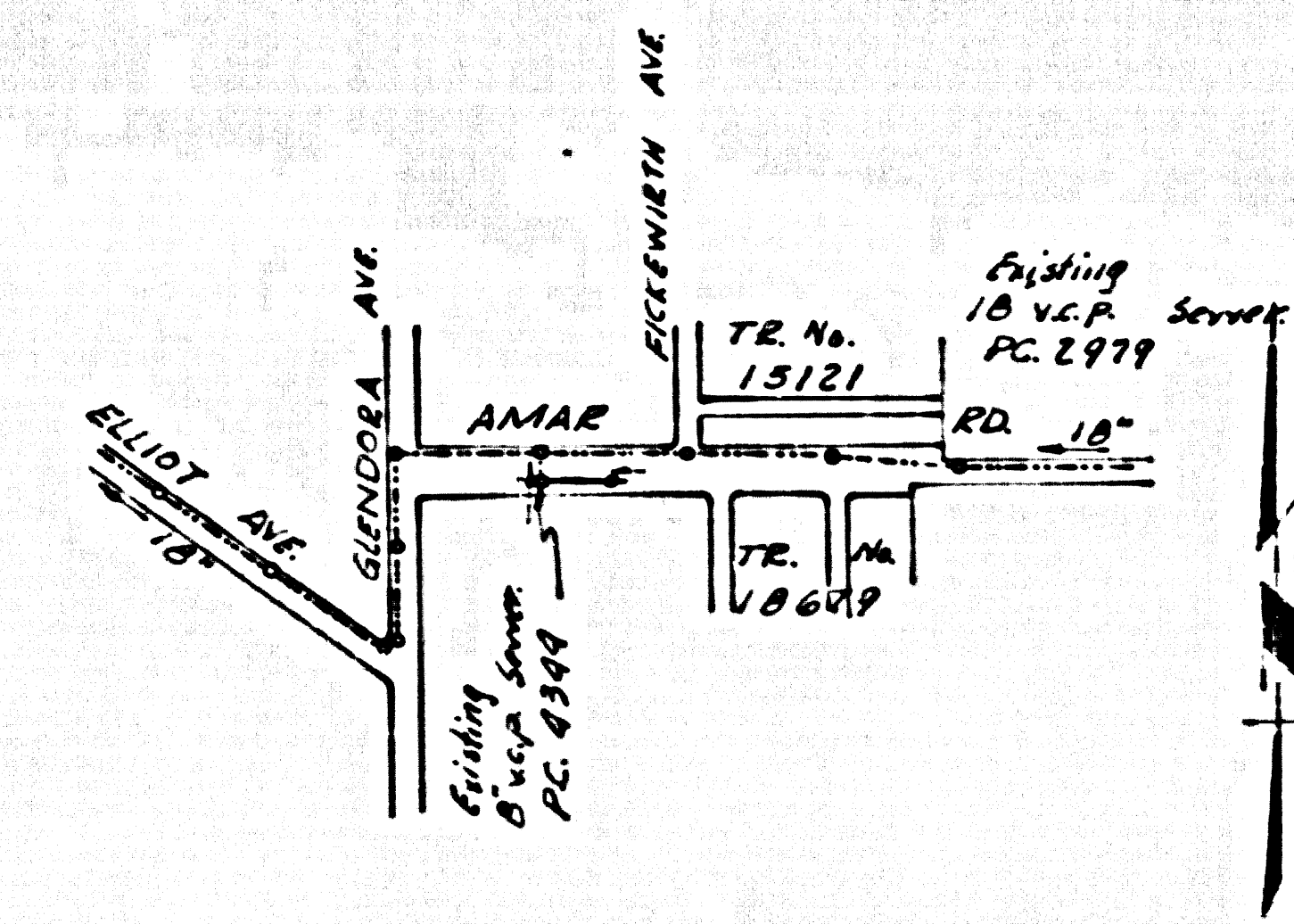

INDEX MAP
 SCALE 1"=600'

LA PUENTE BLDG. DIST. NO. 2.02

- NOTES:
1. PROVIDE STAKES ON THE PROPERTY LINE OR PROPERTY LINES PRODUCED AT RIGHT ANGLES TO THE SEWER LINE AT THE CENTER LINE OF EACH MANHOLE.
 2. NO REPRESENTATIVE OF THE CITY ENGINEER WILL SURVEY OR LAY OUT ANY PORTION OF THE WORK.
 3. THE OWNER OR HIS AUTHORIZED REPRESENTATIVE SHALL FURNISH THE CITY ENGINEER WITH GRADE SHEETS AND STATIONING FOR ALL HOUSE LATERALS AND Y BRANCHES AND SHALL PROVIDE STAKES FOR THEM AT THEIR PROPER LOCATIONS WITH STATIONING PLAINLY MARKED. ANY CHANGE IN LOCATION SHALL BE REQUESTED IN WRITING BY THE OWNER OR HIS REPRESENTATIVE.
 4. THE PRIVATE ENGINEER SHALL FURNISH THE HOUSE LATERAL DEPTH AT THE PROPERTY LINE BELOW THE TOP OF CURB ELEVATION FOR EACH HOUSE LATERAL ON THE GRADE SHEET.
 5. NO REVISIONS SHALL BE MADE IN THESE PLANS WITHOUT THE APPROVAL OF THE CITY ENGINEER.
 6. USE STANDARD MANHOLE FRAMES AND COVERS, 5-117, COVER TO READ "SEWERS"
 7. USE STANDARD STRENGTH PIPE EXCEPT AS NOTED.
 8. USE CEMENT MORTAR OR "WEDGE-LOCK" OR "SPEED-SEAL" FOR ALL V.C.P. JOINTS PER SPECS. SECS. 24 & 41.
 9. RESURFACE ALL TRENCH WITHIN PAVED AREA TO MEET L.A. COUNTY ROAD DEPT. OR CALIF. STATE HIGHWAY REQUIREMENTS IN ACCORDANCE WITH PERMITS.
 10. ENCASE FOUR FEET OF SEWER AT POINTS OF INTERFERENCE WITH POLES, CASE NO. 5-172.
 11. HOUSE LATERALS TO BE CONSTRUCTED WITH INVERTS AT PROPERTY LINE $\frac{1}{2}$ FEET BELOW CURB GRADE
 12. ALL STRUCTURES SHALL BE BRICK SEWER STRUCTURES, 5-104
 13. FOR ALLOWABLE LEAKAGE TEST USE FORMULA NO. 1, SPEC. SEC. 54.
 14. MANHOLE TOPS IN UNIMPROVED RIGHTS-OF-WAY TO BE SIX INCHES ABOVE FINISHED GRADE.
 15. THE CONTRACTOR SHALL NOTIFY THE CONSTRUCTION DIVISION BY TELEPHONE, MADISON 5-4747, EXT. 2521 AT LEAST TWENTY-FOUR HOURS BEFORE STARTING ANY WORK UNDER THIS CONTRACT.

COLLECT CHARGES
 AS INDICATED
 7/27/58

CITY OF LA PUENTE
 APPROVED: *[Signature]*
 CITY MANAGER

PROFILE ALIGNMENT AND GRADE OF P.C. 5666
 SANITARY SEWERS PAGE 1
 TO BE CONSTRUCTED IN

AMAR ROAD
 PRIVATE CONTRACT NO. 5666

W.S. 39
 1 SHEET OF 2 PAGES
 SCALE: VERT. 1"=4' HORIZ. 1"=40'
 AUGUST, 1960
 PREPARED IN THE OFFICES OF

29,920

By: *[Signature]*
 REG. C. E. NO. 2385

FOR LEGEND SEE PLAN NO. S-A-44

NOTE:
 GRADES TO WHICH THIS IMPROVEMENT IS TO BE CONSTRUCTED ARE SHOWN ON PLANS AND PROFILES. GRADE POINTS FOR TOP OF CURBS, CENTER LINE OF STREETS, OR CENTER LINE OF ALLEYS ARE SHOWN BY CIRCLES ON PROFILES. AT ALL POINTS BETWEEN DESIGNATED POINTS THE GRADE SHALL BE ESTABLISHED SO AS TO CONFORM TO A STRAIGHT LINE DRAWN BETWEEN SAID DESIGNATED POINTS.
 ELEVATIONS ARE IN FEET ABOVE U.S.C. & G.S. SEA LEVEL DATUM OF 1929.
 THIS DRAWING AND THE DATA HEREON ARE HEREBY MADE A PART OF THE SPECIFICATIONS.
 WORK SHALL BE CONSTRUCTED ACCORDING TO SPECIFICATIONS ON FILE IN THE OFFICE OF THE CITY ENGINEER AND SHALL BE PROSECUTED ONLY IN THE PRESENCE OF THE CITY ENGINEER.
 BEFORE WORK CAN BE STARTED, THE CONTRACTOR MUST OBTAIN A PERMIT TO EXCAVATE IN CITY STREETS FROM THE L.A. COUNTY ROAD DEPT. DISTRICT OFFICE NO. 1, AND MAKE A DEPOSIT WITH THE CITY OF LA PUENTE, 12921 GLENDOVA AVE., LA PUENTE, CALIF. IN AMOUNT SUFFICIENT TO COVER THE COST OF CONSTRUCTION INSPECTION AND RECORD PLANS.
 APPROVAL OF THIS PLAN BY THE CITY OF LA PUENTE DOES NOT CONSTITUTE A REPRESENTATION AS TO THE ACCURACY OF THE LOCATION OR OF THE EXISTENCE OR NON-EXISTENCE OF ANY UNDERGROUND UTILITY PIPE, OR STRUCTURE WITHIN THE LIMITS OF THIS PROJECT. THIS NOTE APPLIES TO ALL PARTS.
 IF WORK IS TO BE DONE IN A STATE HIGHWAY, A PERMIT MUST BE OBTAINED FROM THE STATE OF CALIFORNIA, DIVISION OF HIGHWAYS, 128 SOUTH SPRING STREET.

CITY OF LA PUENTE, CALIFORNIA
 APPROVED, JOHN A. LAMBIE, CITY ENGINEER APPROVED, C.E. COMPTON, CHIEF ENGINEER
 CO. SAN. DES. NO. 18
 BY: *[Signature]* BY: *[Signature]*
 DIST. SANITATION ENGINEER OFFICE ENGINEER
 CHECKED BY: *[Signature]* 10-7-60
 OFFICE OF CITY ENGINEER, REG. C. E. NO. 2486
 SUBMITTED: *[Signature]*
 SAN DIMAS REGIONAL ENGINEER

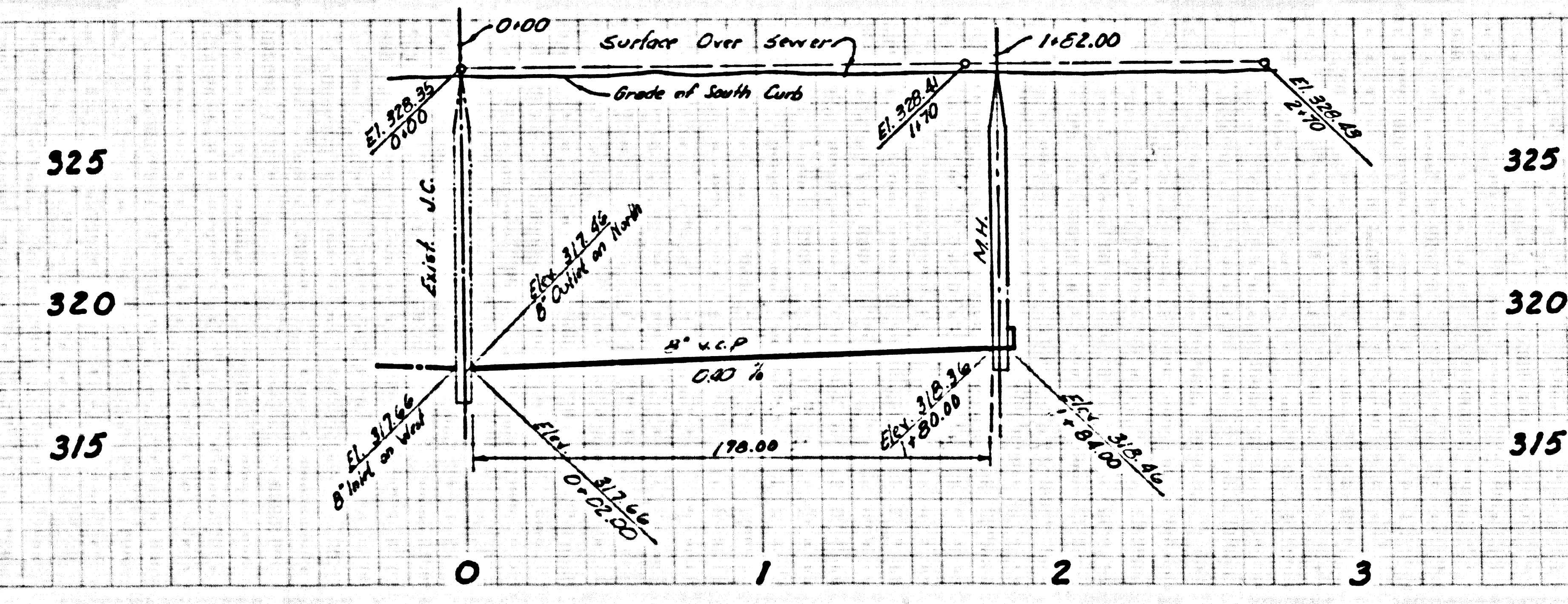

PORCION OF RANCHO LA PUENTE

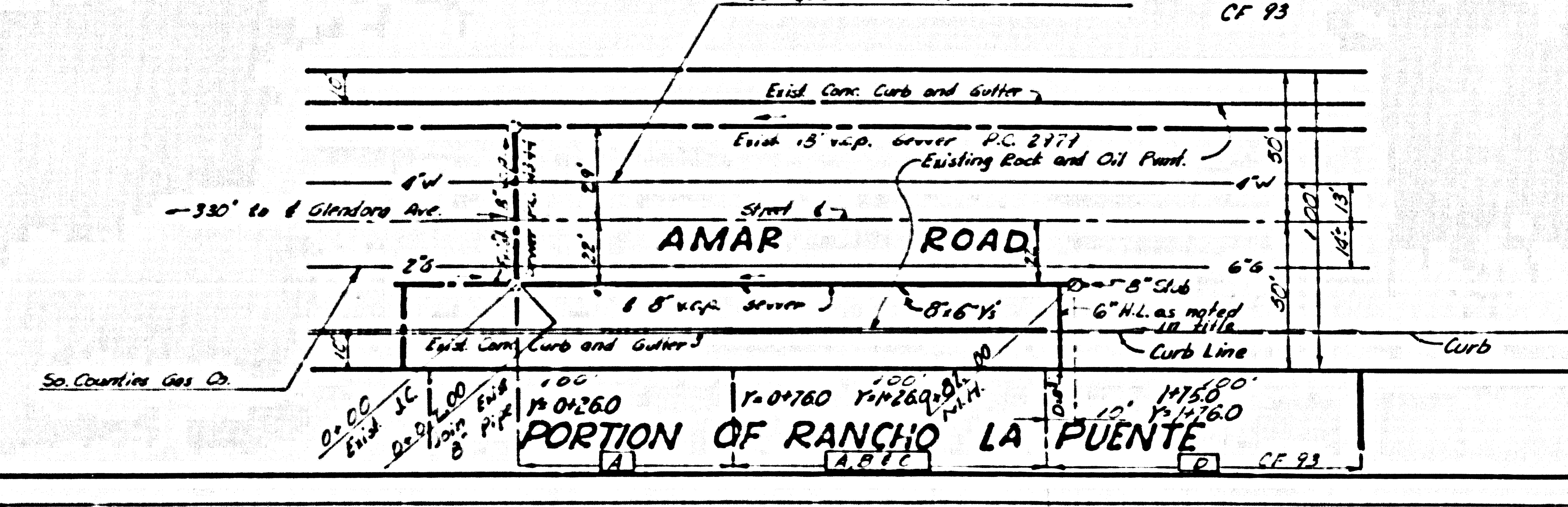

P.C. 5666 PAGE 2

CITY OF LA PUENTE
 COLLECT CHARGES
 AS INDICATED -
 A. CONNECTION CHARGE \$2.00
 PER ASSESSABLE FRONT FOOT
 B. ANNEXATION TO SANITATION
 DISTRICT #15 REQUIRED
 C. REIMB. CHARGE (ACREAGE)
 PAY TO L.A. COUNTY ENGR.
 CALL CENTRAL OFFICE.
 D. NO CHARGE FOR
 CONNECTIONS
 (Charges shown in
 boxes in plan.)

29,921