

TR 02 3A

2992 S 10 S 31 3902

WESTERN AVE

WESTERN AVE

Page 1 of 5 pages

W.C. 2213

B.M. #1 Elev. 324.03 L.B. 233 Pg. 95  
L & T. N. 3 S. 50' B.C.R. 38' W. & Western Ave.  
50' N. & Crestwood St. (Palms Verdes 55)

### LOMITA BUILDING DISTRICT NO. 7.1

### PRIVATE CONTRACT NO. 5677

PROFILE, ALIGNMENT AND GRADE OF  
SANITARY SEWERS  
TO BE CONSTRUCTED IN  
**WESTERN AVENUE**  
AND OTHER RIGHTS OF WAY

30103

J.N. 0600.00  
PAGE 1

PAGE 1 OF 2 PAGES

SCALE: HORIZ. 1" = 20' VERT. 1" = 4'  
SEPT. 1960  
COUNTY OF LOS ANGELES, CALIFORNIA

JOHN A. LAMBE COUNTY ENGINEER

APPROVED: *[Signature]*  
C. B. COMPTON  
COUNTY ENGINEER

FOR LEGEND SEE PLAN SHEET 5A-44

DESIGNED: R. ARZOLA  
TRACED: R. ARZOLA  
CHECKED: H. LEE

DATE	BY	REVISION
SEPT. 1960	R. ARZOLA	DESIGNED
SEPT. 1960	R. ARZOLA	TRACED
SEPT. 1960	H. LEE	CHECKED

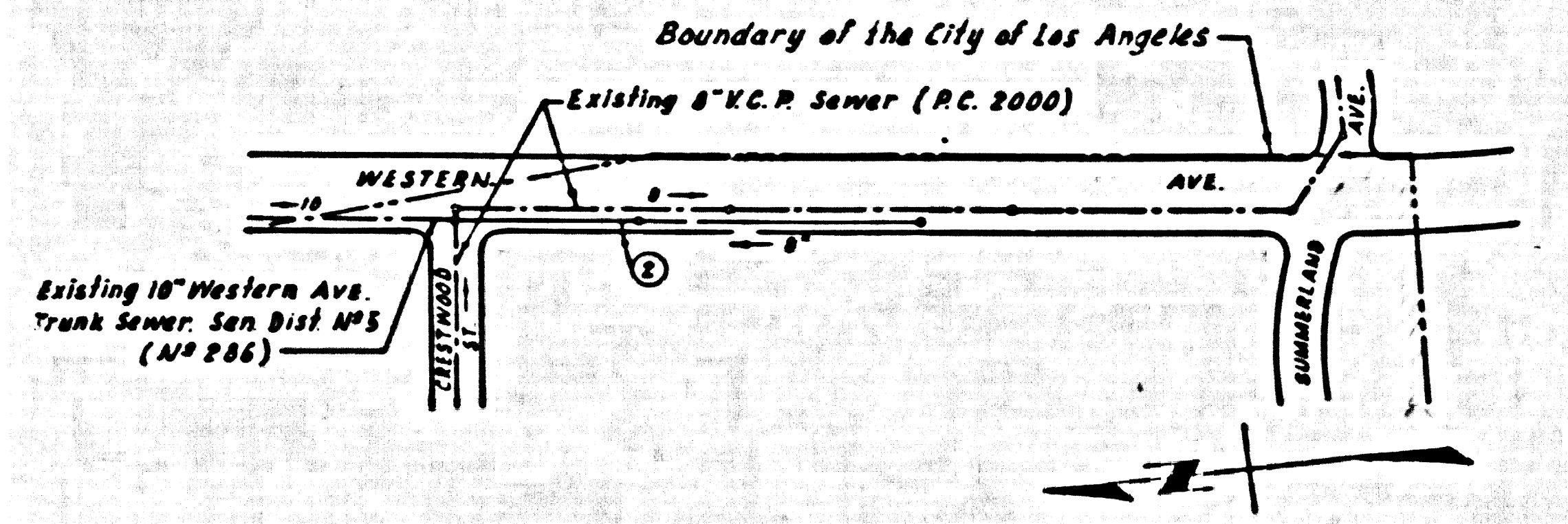

Note: Figure in Circle Indicates Page Number  
**INDEX MAP**  
**P.C. 5677 WESTERN AVE.**  
Scale: 1" = 200'

- USE STANDARD STRENGTH PIPE EXCEPT AS NOTED.
- USE PLASTIC JOINTS FOR ALL VITRIFIED CLAY PIPE JOINTS.
- ALL STRUCTURES SHALL BE BRICK SEWER STRUCTURES AS PER PLAN NO. S-A-104, EXCEPT AS NOTED.
- USE STANDARD MANHOLE FRAMES AND COVERS AS PER PLAN NO. S-A-117, EXCEPT AS NOTED.
- RESURFACE TRENCH WITHIN PAVED AREA WITH PREMIX BACK AND OIL 4 INCHES IN THICKNESS ON 8 INCHES OF AGGREGATE BASE MATERIAL.
- USE FORMULA NO. 1 SEC. 84 OF SPECIFICATIONS TO COMPUTE ALLOWABLE LEAKAGE.
- THE CONTRACTOR SHALL NOTIFY THE CONSTRUCTION AND STORM DRAIN DIVISION BY TELEPHONE MADISON 9-4747, EXT. 81151 AT LEAST 24 HOURS BEFORE STARTING ANY WORK UNDER THIS CONTRACT.
- CONSTRUCT HOUSE LATERALS WITH BRICKS AS PROPOSED UNLESS THE FEEL BELOW CURB GRADE, OR GRADE OF CENTERLINE OF STREET EXCEPT AS NOTED.
- FIGURES IN CIRCLES AT ENDS OF HOUSE LATERALS INDICATE DEPTH BELOW CURB GRADE, OR GRADE OF CENTERLINE OF STREET.
- FIGURES IN CIRCLES AT ENDS OF HOUSE LATERALS INDICATE HOUSE LATERALS SHALL BE CONSTRUCTED WITH 1/2" DIPS PER FOOT TO PROPERTY LINES.
- WORDS IN CIRCLES AT ENDS OF HOUSE LATERALS INDICATE 1/2" SHALL BE LAIN HORIZONTAL AND HOUSE LATERALS SHALL BE CONSTRUCTED WITH 1/2" DIPS PER FOOT TO PROPERTY LINES.
- CONSTRUCTION IN STATE HIGHWAYS SHALL CONFORM WITH STATE HIGHWAY PERMITS.

Before breaking into any existing structure and before final acceptance of this work, County Sanitation District (MS 6-12-1) shall be notified in order that required inspection can be made.

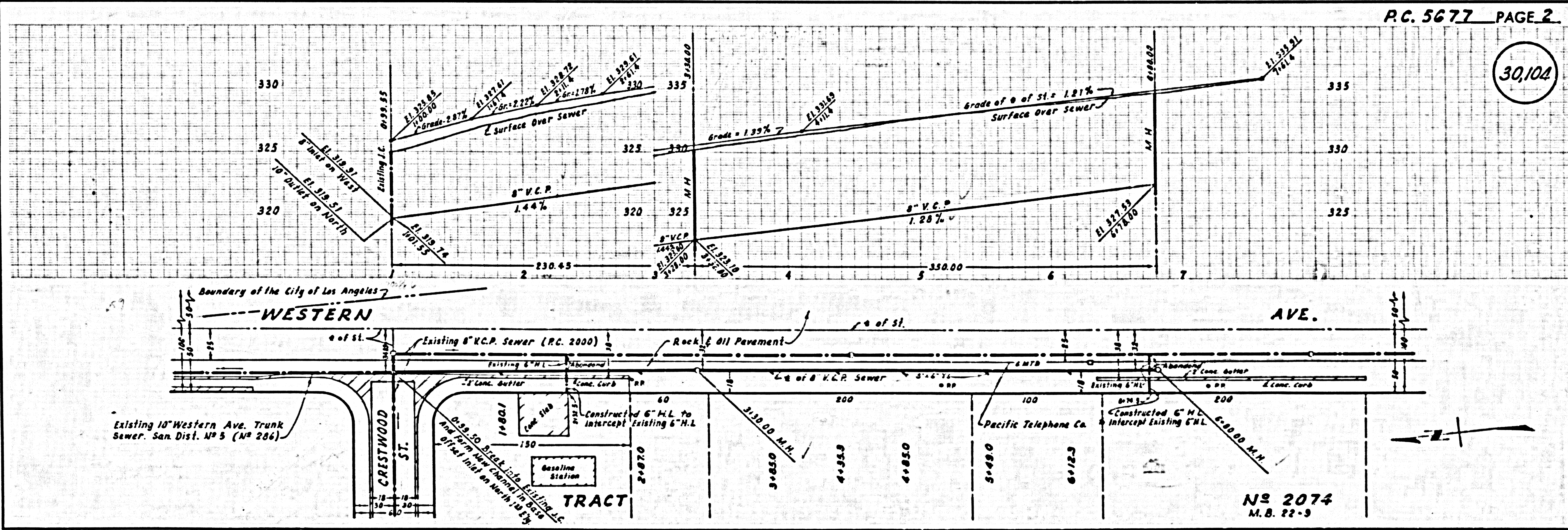

P.C. 5677 PAGE 2

30104

Nº 2074  
M.B. 22-9

U.S. Topo. - F.B. 356 Pg. 76, 77, 93  
U.S. Sect. - L.B. 233 Pg. 119, 229-236

U.S. GEOLOGICAL SURVEY  
WASHINGTON, D.C.