

PAGE 1 OF 5 PAGES

DOUBLE SCALE LOMITA BUILDING DISTRICT NO. 12

CAPITAL PROJECT NO. 8892.06 PRIVATE CONTRACT NO. 5684

PROFILE, ALIGNMENT AND GRADE OF
SANITARY SEWERS
TO BE CONSTRUCTED TO SERVE
LOS VERDES GOLF COURSE

32999

PAGE 1 OF 2 PAGES

SCALE: VERT. 1" = 6' 0" H.C.
HORIZ. 1" = 60' 0" H.C.

NOVEMBER, 1962

COUNTY OF LOS ANGELES, CALIFORNIA

JOHN A. LAMBIE COUNTY ENGINEER

APPROVED: *J.D. Parkhurst*
SANITATION ENGINEER

J.D. PARKHURST
CHIEF ENGINEER OF COUNTY
SANITATION DISTRICT NO. 8

SUBMITTED: *John A. Lambie*
CIVIL ENGINEER E.E. 10078

FOR LEGEND
SEE PLAN NO. 8-A-44

NOTE: GRADES TO WHICH THIS IMPROVEMENT IS TO BE CONSTRUCTED ARE SHOWN ON PLANS AND PROFILES. BENCH POINTS FOR TOP OF CURB, CENTER LINE OF STREET OR CENTER LINE OF ALLY ARE SHOWN BY CIRCLES ON PROFILES. AT ALL POINTS BETWEEN BENCHPOINTS POINTS THE GRADE SHALL BE ESTABLISHED SO AS TO CONFORM TO A STRAIGHT LINE DRAWN BETWEEN SAID BENCHPOINTS.

REFERENCES			
W.S. 27	DESIGNED	C.O. Abbotson	NOV., 1962
A.B. 7580	TRACED	C.O. Abbotson	NOV., 1962
F.B. 2970	CHECKED	M.J. Slawson	DEC., 1962

P.E.M. #19 EL. 858.878 KB-2230-128
C.E. MON. FLUSH IN CONCRETE PER
F.R. 2230-24 STAMPED P-21 WITH 2"
HARKER POST.

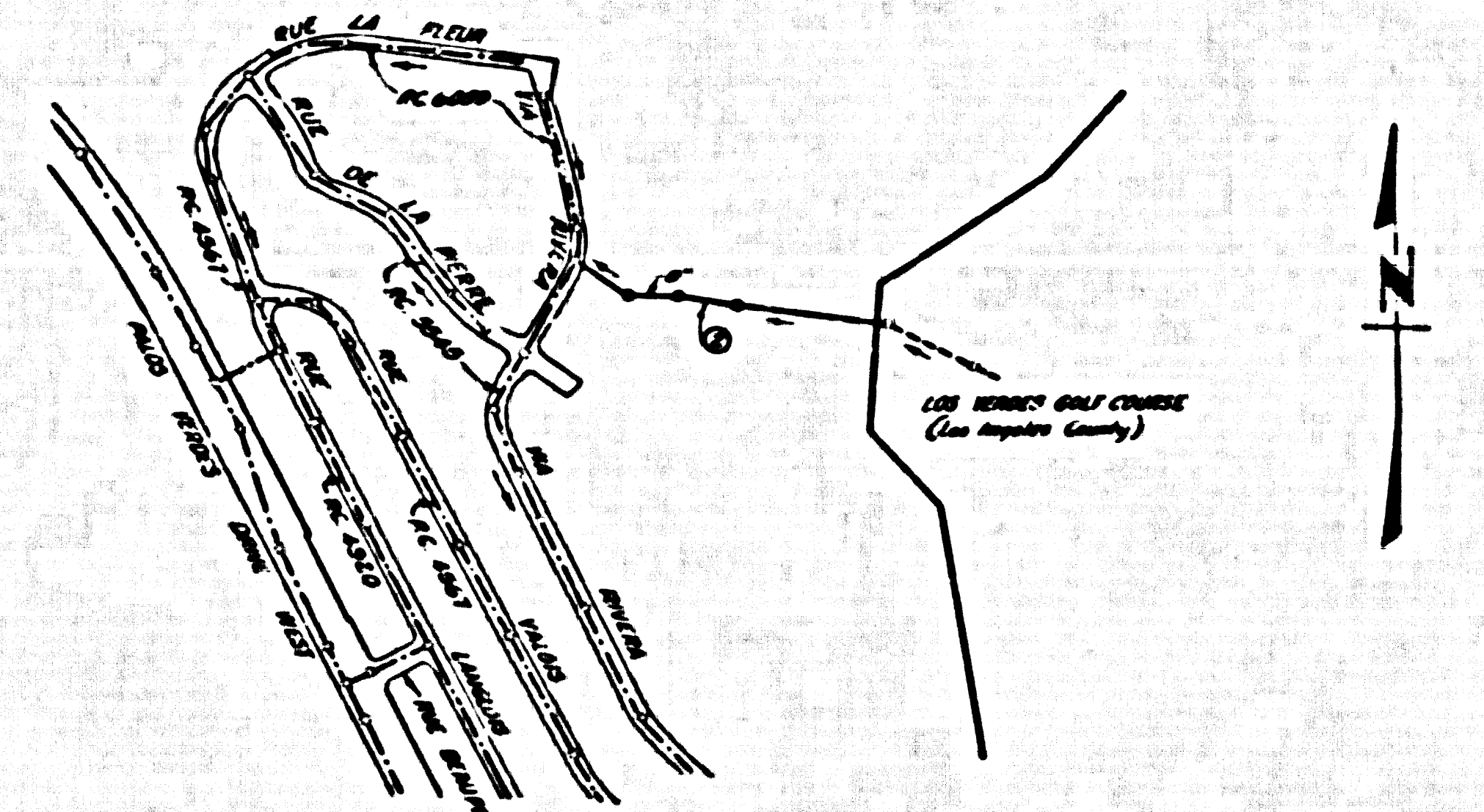

INDEX MAP
PC 5684
SCALE: 1" = 600'
N.S. 27

COLLECT ORDINANCE
FRONTAGE CHARGES
John A. Lambie

- NOTES:
- The contractor shall be held during construction of this project, to strict adherence to the requirements of Section 65 of the S.M. Code.
 - The trench shall be backfilled to one foot above the pipe with sand or selected material in accordance with Sec. 62 of S.M. Code.
 - The upper layer of backfill shall be one foot minimum of compacted sand or selected material in place and between Sta. 2+78.0 and Sta. 2+80.0 the trench shall be placed with material and eye green sand and adequately compacted.
 - The Contractor shall not directly equal to the drainage course adjacent to the main line sewer to a manner that would block drainage or create a hazard.

USE EXTRA STRENGTH PIPE, PIPE EXCEPT 24" TO 30" DIA.
ALL PIPE IS STANDARD DEPTH, EXCEPT AS NOTED.
ALL STRUCTURES SHALL BE BRICK SEWER STRUCTURES AS PER PLAN NO. S-A-104.
USE STANDARD MANHOLE FRAMES AND COVERS AS PER PLAN NO. S-A-117.

RESURFACE TRENCH WITHIN PAVED AREA WITH ASPHALTIC CONCRETE 5" INCHES IN THICKNESS.

USE FORMULA NO. 1 SEC. 54 OF SPECIFICATIONS TO COMPUTE ALLOWABLE LEAKAGE.

THE CONTRACTOR SHALL NOTIFY THE CONSTRUCTION DIV. BY TELEPHONE MADISON 9-4747, EXT. 81/531 AT LEAST 24 HOURS BEFORE STARTING ANY WORK UNDER THIS CONTRACT.

USE MECHANICAL COMPRESSION JOINTS FOR ALL VITRIFIED CLAY PIPE SEWER PER SECTIONS 36 & 48 OF STANDARD SPECIFICATIONS.

APPROVAL OF THIS PLAN BY THE COUNTY OF LOS ANGELES DOES NOT CONSTITUTE A REPRESENTATION AS TO THE ACCURACY OF OR THE EXISTENCE OR NON-EXISTENCE OF ANY UNDERGROUND UTILITY PIPE OR STRUCTURE WITHIN THE LIMITS OF THE PROJECT.

LOS ANGELES COUNTY STANDARD SEWER SPECIFICATIONS DATED MAY 23, 1962, APPLY TO THE CONSTRUCTION OF THIS PROJECT.

NO REVISIONS SHALL BE MADE TO THESE PLANS WITHOUT THE APPROVAL OF THE COUNTY ENGINEER.

MANHOLE TOP IN UNIMPROVED RIGHTS-OF-WAY TO BE SIX INCHES ABOVE FINISHED GRADE, EXCEPT AS NOTED.

ALL STATE AND LOCAL TRENCH SAFETY ORDERS WILL BE RIGIDLY ENFORCED.

NO CONNECTIONS FOR THE DISPOSAL OF INDUSTRIAL WASTES SHALL BE MADE TO SEWERS SHOWN ON THESE DRAWINGS WITHOUT WRITTEN PERMISSION FROM THE CHIEF ENGINEER AND GENERAL MANAGER OF THE COUNTY SANITATION DISTRICTS.

PAGE 2 OF 5 PAGES

DOUBLE SCALE

PC. 5684 PAGE 2

COLLECT ORDINANCE
FRONTAGE CHARGES

33000

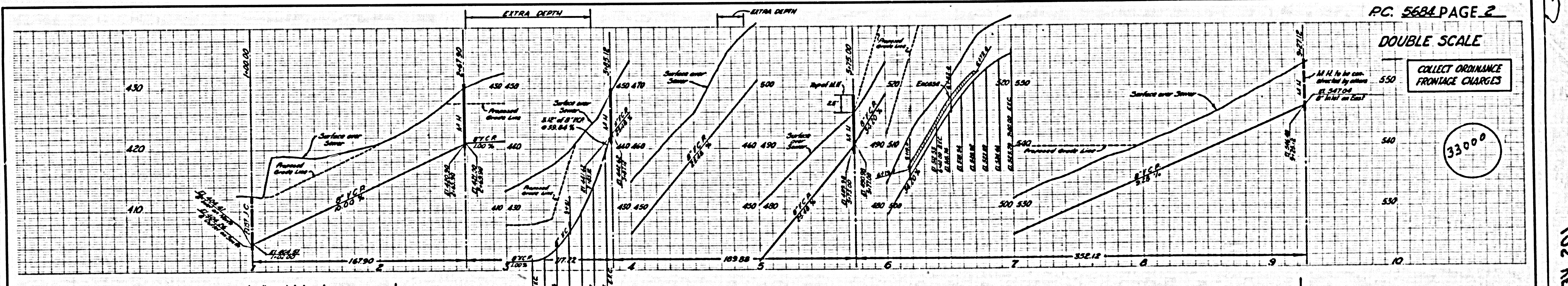

NOTE: Sta. 1+00 to 2+81: Backfill shall be compacted to a minimum relative density of 90% in accordance with Standard Method of Test ASTM D-1556-61T. The Contractor, at his own expense, shall furnish the County Engineer certification from an approved soils laboratory of having achieved such compaction.

NOTE: If the M.H. of Sta. 9+27.12 has not been constructed, the Contractor shall have the M.H. of Sta. 9+27.12 constructed by the end of the S.V.C.R. Season of the 2+78.12, however, with building paper and handily.

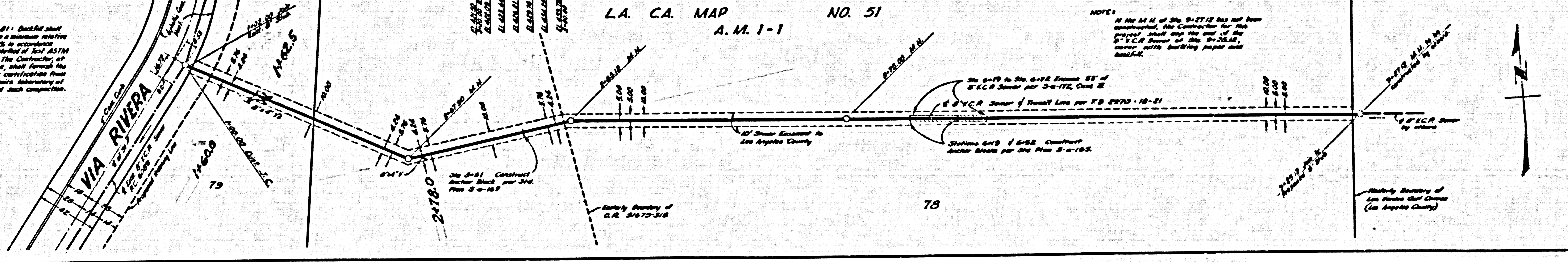

L.A. C.A. MAP NO. 51
A.M. 1-1

NOTE: The M.H. of Sta. 9+27.12 has not been constructed, the Contractor shall have the M.H. of Sta. 9+27.12 constructed by the end of the S.V.C.R. Season of the 2+78.12, however, with building paper and handily.

KB 2970 { 1/2" = 10' 0" H.C.
1/4" = 20' 0" H.C.

U.C. 12-13-62
J.D. 12-13-62

LOS VERDES GOLF COURSE-PC 2284