

B.M. - S.D. 2131, Elev. 150.951, CSFB 2524 Pg. 28
 Telegraph Road & Carrier Avenue N.W. Cor. East
 Spk. in curb 5' N.W. of the N.W. end of Curb Return.

CITY OF COMMERCE BLDG. DIST. NO. 601

PROFILE ALIGNMENT AND GRADE OF P.C. 5770
 SANITARY SEWERS PAGE 1
 TO BE CONSTRUCTED IN
 WASHINGTON AND TELEGRAPH ROAD

PRIVATE CONTRACT NO. 5770

W.S. 36
 1 SHEETS, 2 PAGES
 SCALE: VERT. 1"=4' HORIZ. 1"=40'
 JUNE, 1961
 PREPARED IN THE OFFICES OF
 L.M. NERENBAUM & ASSOCIATES

33503

By: L.M. Nerenbaum
 REG. C. E. NO. 6956
 FOR LEGEND SEE PLAN NO. S-A-64

SPECIAL NOTES:

- ONE LANE IN EACH DIRECTION BE KEPT OPEN BETWEEN THE HOURS OF 8:30 A.M. AND 3:30 P.M.
- TWO LANES IN EACH DIRECTION BE KEPT OPEN BEFORE 8:30 AM AND AFTER 3:30 PM WITH NO CROSSING OPEN DOUBLE LINES.
- ALL SIGNING AND MARKING SHALL CONFORM TO CURRENT "MANUAL OF MARKING SIGNS, LIGHTS, AND DEVICES FOR USE IN PERFORMANCE OF WORK UPON HIGHWAYS," PUBLISHED BY STATE OF CALIFORNIA, DEPT. OF PUBLIC WORKS, DIVISION OF HIGHWAYS.

NOTES:

- PROVIDE STAKES ON THE PROPERTY LINE OR PROPERTY LINES PRODUCED AT RIGHT ANGLES TO THE SEWER LINE AT THE CENTER LINE OF EACH MANHOLE.
- NO REPRESENTATIVE OF THE COUNTY ENGINEER WILL SURVEY OR LAY OUT ANY PORTION OF THE WORK.
- THE OWNER OR HIS AUTHORIZED REPRESENTATIVE SHALL FURNISH THE COUNTY ENGINEER WITH GRADE SHEETS AND STATIONING FOR ALL HOUSE LATERALS AND Y BRANCHES AND SHALL PROVIDE STAKES FOR THEM AT THEIR PROPER LOCATIONS WITH STATIONING PLAINLY MARKED. ANY CHANGE IN LOCATION SHALL BE REQUESTED IN WRITING BY THE OWNER OR HIS REPRESENTATIVE.
- THE PRIVATE ENGINEER SHALL FURNISH THE HOUSE LATERAL DEPTH AT THE PROPERTY LINE BELOW THE TOP OF CURB ELEVATION FOR EACH HOUSE LATERAL ON THE GRADE SHEET.
- NO REVISIONS SHALL BE MADE IN THESE PLANS WITHOUT THE APPROVAL OF THE COUNTY ENGINEER.
- USE STANDARD MANHOLE FRAMES AND COVERS, S-1172, EXCEPT AS NOTED.
- USE "WEDGE-LOCK" OR "SEED-SEAL" FOR ALL V.C.P. JOINTS PER SPECS., SEC. 5, 6 & 48.
- RESURFACE ALL TRENCH WITHIN PAVED AREA TO MEET L.A. COUNTY ROAD DEPT. OR CALIF. STATE HIGHWAY REQUIREMENTS IN ACCORDANCE WITH PERMITS.
- ENCASE FOUR FEET OF SEWER AT POINTS OF INTERFERENCE WITH POLES, CASE III, S-6-172.
- HOUSE LATERALS TO BE CONSTRUCTED WITH INVERTS AT PROPERTY LINE FEET BELOW CURB GRADE EXCEPT AS NOTED.
- ALL STRUCTURES SHALL BE BRICK SEWER STRUCTURES, S-104, EXCEPT AS NOTED.
- FOR ALLOWABLE LEAKAGE TEST USE FORMULA NO. 1, SPECS., SEC. 54.
- MANHOLE TOPS IN IMPROVED RIGHTS-OF-WAY TO BE LEVEL WITH FINISHED GRADE.
- THE CONTRACTOR SHALL NOTIFY THE CONSTRUCTION & STORM DRAIN DIVISION BY TELEPHONE, MAYSON 9-474, EXT. 6561 AT LEAST TWENTY-FOUR HOURS BEFORE STARTING ANY WORK UNDER THIS CONTRACT.
- STANDARD SPECIFICATIONS DATED OCT. 10, 1960 APPLY IN THE CONSTRUCTION OF THIS PROJECT.

REVISION
 REPLACED 10" OF V.C.P. WITH C.I.P. UNDER WATER MAIN AT APPROX. STA. 14+28
 APPROVED: [Signature] DATE: 5-10-63

REVISION
 MISSING REQUIREMENT REMOVED BETWEEN STATIONS 18+50 AND 18+65 SEE SPECIAL NOTES ABOVE FOR NEW REQUIREMENT.
 APPROVED: [Signature] DATE: 1-18-63

NO CONNECTIONS FOR THE DISPOSAL OF INDUSTRIAL WASTES SHALL BE MADE TO SEWERS SHOWN ON THESE DRAWINGS WITHOUT WRITTEN PERMISSION FROM THE CHIEF ENGINEER AND GENERAL MANAGER OF THE COUNTY SANITATION DISTRICTS.

APPROVED BY [Signature] DATE 5/27/61
 INDUSTRIAL WASTE DIVISION

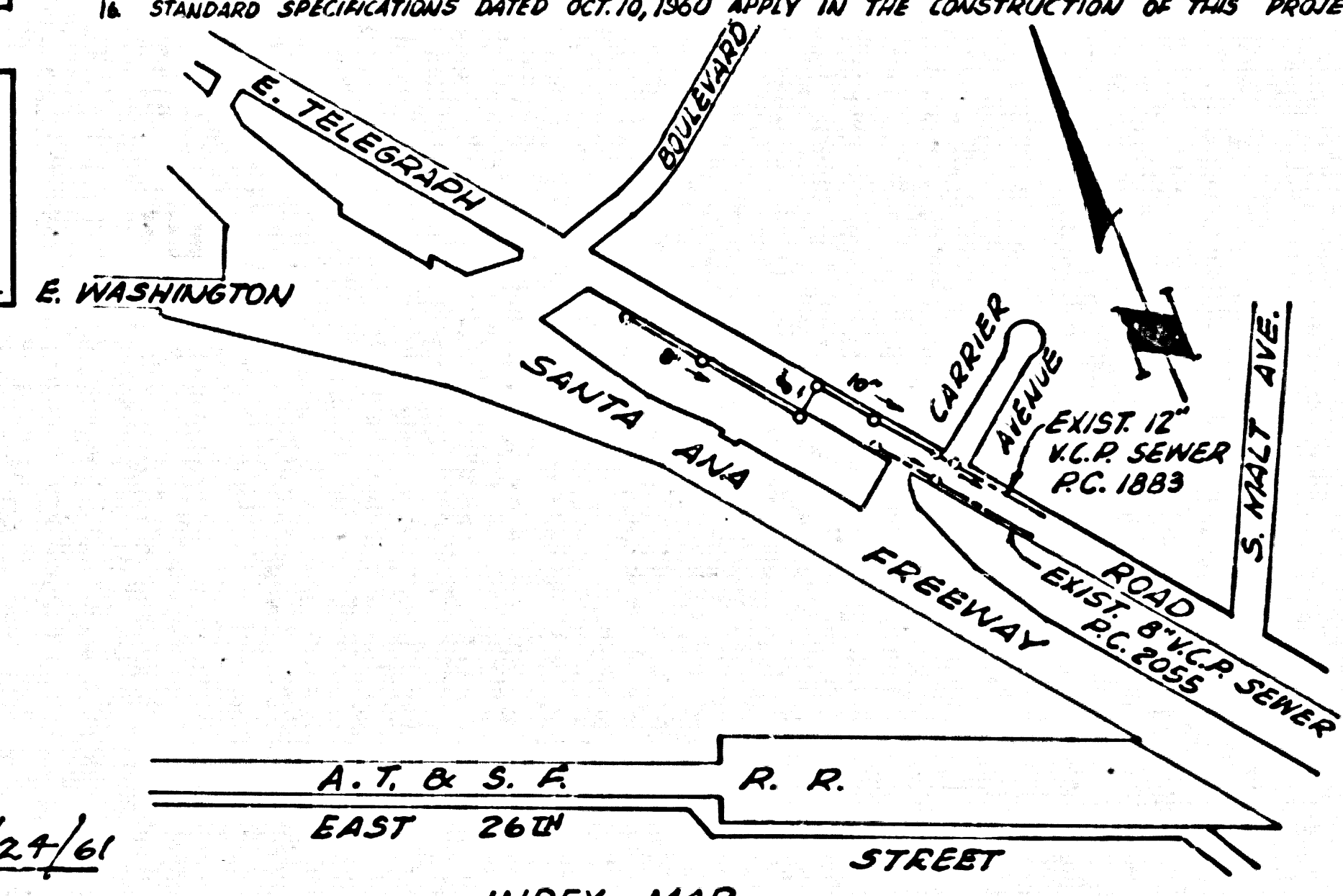

CONNECTION CHARGES AS INDICATED
A.L. Albertson

NOTES:
 GRADES TO WHICH THIS IMPROVEMENT IS TO BE CONSTRUCTED ARE SHOWN ON PLANS AND PROFILE. GRADE POINTS FOR TOP OF CURBS, CENTER LINE OF STREETS, OR CENTER LINE OF ALLEYS ARE SHOWN BY CIRCLES ON PROFILES. AT ALL POINTS BETWEEN DESIGNATED POINTS THE GRADE SHALL BE ESTABLISHED SO AS TO CONFORM TO A STRAIGHT LINE DRAWN BETWEEN SAID DESIGNATED POINTS.
 ELEVATIONS ARE IN FEET ABOVE U.S.C. & G.S. SEA LEVEL DATUM OF 1929.
 THIS DRAWING AND THE DATA HEREON ARE HEREBY MADE A PART OF THE SPECIFICATIONS.
 WORK SHALL BE CONSTRUCTED ACCORDING TO SPECIFICATIONS ON FILE IN THE OFFICE OF THE CITY ENGINEER AND SHALL BE PROSECUTED ONLY IN THE PRESENCE OF THE CITY ENGINEER.
 BEFORE WORK CAN BE STARTED, THE CONTRACTOR MUST OBTAIN A PERMIT TO EXCAVATE IN CITY STREETS FROM THE L.A. COUNTY ROAD DEPT., DISTRICT OFFICE NO. 2, AND MAKE A DEPOSIT WITH THE CITY OF COMMERCE, 11245 ATLANTIC BOULEVARD, SUFFICIENT TO COVER THE COST OF CONSTRUCTION INSPECTION AND RECORD PLANS.
 APPROVAL OF THIS PLAN BY THE COUNTY OF LOS ANGELES DOES NOT CONSTITUTE A REPRESENTATION AS TO THE ACCURACY OF THE LOCATION OR OF THE EXISTENCE OR NON-EXISTENCE OF ANY UNDERGROUND UTILITY PIPE, OR STRUCTURE WITHIN THE LIMITS OF THIS PROJECT. THIS NOTE APPLIES TO ALL PAGES.
 IF WORK IS TO BE DONE IN A STATE HIGHWAY, A PERMIT MUST BE OBTAINED FROM THE STATE OF CALIFORNIA, DIVISION OF HIGHWAYS, 130 SOUTH SPRING STREET.

CITY OF COMMERCE, CALIFORNIA
 APPROVED, JOHN A. LAMBIE, CITY ENGINEER
 APPROVED, C.R. COMPTON, CHIEF ENGINEER
 BY [Signature] ASST. SANITATION ENGINEER
 BY [Signature] OFFICE ENGINEER
 CHECKED BY [Signature]
 OFFICE OF COUNTY ENGINEER, REG. C. E. NO. 9406

SUBMITTED: N.F. Braunders
 SAN GABRIEL VALLEY REGIONAL ENGINEER

P.C. 5770 PAGE 2

CONNECTION CHARGES AS INDICATED
 33504

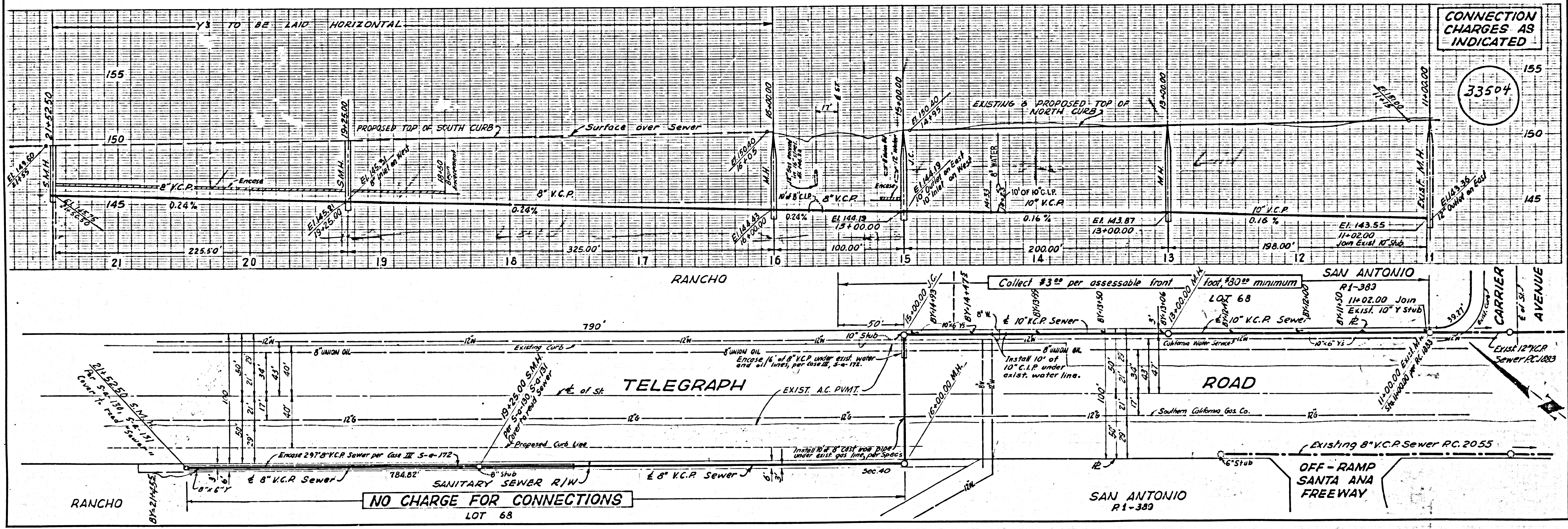

NO CHARGE FOR CONNECTIONS
 LOT 68