

BM 5Y 2606 Elev. 73.985 NORWALK Quad. 1955
 E. 1/4 Sec. 10, Cor. & N.E. cor. of Sec. 10 & 11, T. 28 N. & R. 30 W. of E. 1/4 of Tr. 28 & California Ave.

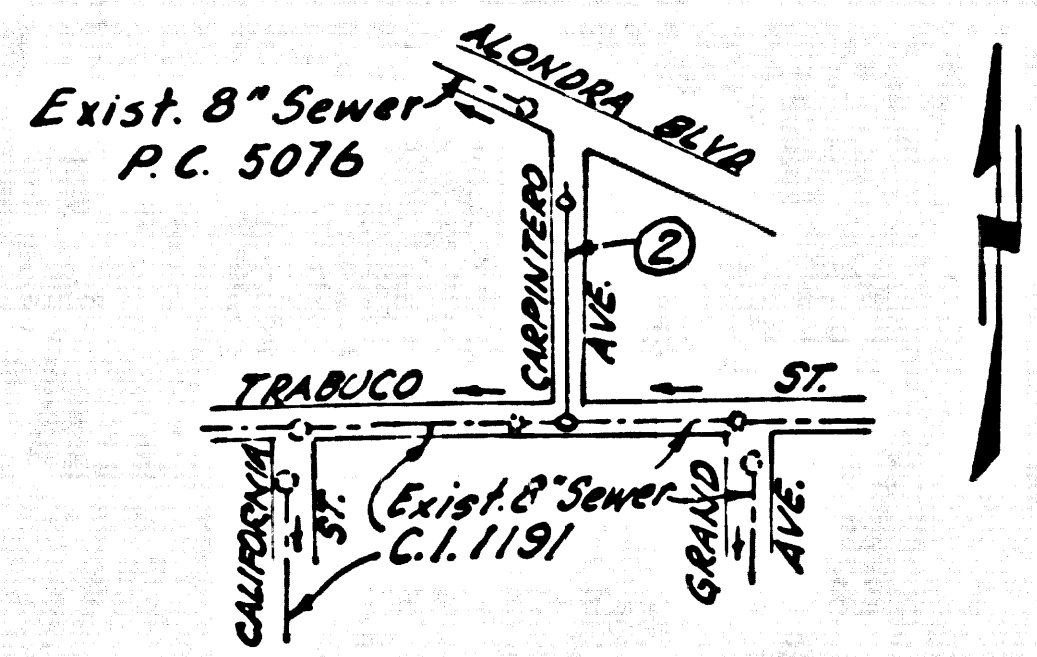

INDEX MAP
 SCALE: 1"=600'
 P.C. 5803

BELFLOWER BLDG. DIST. NO. 4-07

- NOTES:
1. PROVIDE STAKES ON THE PROPERTY LINE OR PROPERTY LINES PRODUCED AT RIGHT ANGLES TO THE SEWER LINE AT THE CENTER LINE OF EACH MANHOLE AND AT THE POINTS OF INTERFERENCE WITH POLES, CASE III, 3-172.
 2. NO REPRESENTATIVE OF THE CITY ENGINEER SHALL SURVEY OR LAY OUT ANY PORTION OF THE WORK.
 3. THE OWNER OR HIS AUTHORIZED REPRESENTATIVE SHALL FURNISH THE CITY ENGINEER WITH GRADE SHEETS AND STATIONING FOR ALL HOUSE LATERALS AND Y BRANCHES AND SHALL PROVIDE STAKES FOR THEM AT THEIR PROPER LOCATIONS WITH STATIONING PLAINLY MARKED. ANY CHANGE IN LOCATION SHALL BE REQUESTED IN WRITING BY THE OWNER OR HIS REPRESENTATIVE.
 4. THE PRIVATE ENGINEER SHALL FURNISH THE HOUSE LATERAL DEPTH AT THE PROPERTY LINE BELOW THE TOP OF CURB ELEVATION FOR EACH HOUSE LATERAL ON THE GRADE SHEET.
 5. NO REVISIONS SHALL BE MADE IN THESE PLANS WITHOUT THE APPROVAL OF THE CITY ENGINEER.
 6. USE STANDARD MANHOLE FRAMES AND COVERS, 3-117A.
 7. USE STANDARD STRENGTH PIPE.
 8. USE CEMENT MORTAR OR "WEDGE-LOCK" OR "SPEED-SEAL" FOR ALL V.C.P. JOINTS PER SPEC'S, SECS. 34 & 4.
 9. RESURFACE ALL TRENCH WITHIN PAVED AREA TO MEET CITY OF BELLFLOWER ROAD DEPT. OR CALIF. STATE HIGHWAY REQUIREMENTS IN ACCORDANCE WITH PERMITS.
 10. ENCASE FOUR FEET OF SEWER AT POINTS OF INTERFERENCE WITH POLES, CASE III, 3-172.
 11. HOUSE LATERALS TO BE CONSTRUCTED WITH INVERTS AT PROPERTY LINE _____ FEET BELOW GRADE OF E. OF STREET.
 12. ALL STRUCTURES SHALL BE BRICK SEWER STRUCTURES, 3-104.
 13. FOR ALLOWABLE LEAKAGE TEST USE FORMULA NO. 1, SPEC'S, SEC. 54.
 14. MANHOLE TOPS IN UNIMPROVED RIGHTS-OF-WAY TO BE SIX INCHES ABOVE FINISHED GRADE.
 15. THE CONTRACTOR SHALL NOTIFY THE CONSTRUCTION DIVISION BY TELEPHONE, MADISON 5-477, 8:00 A.M. TO 5:00 P.M. AT LEAST TWENTY-FOUR HOURS BEFORE STARTING ANY WORK UNDER THIS CONTRACT.
 16. STANDARD SPECIFICATIONS DATED OCTOBER 10, 1960 ON FILE IN THE CITY HALL SHALL APPLY IN THE CONSTRUCTION OF THIS PROJECT.

NO CHARGE FOR CONNECTIONS
 D.M. Hopkins 3-21-61

NO CONNECTIONS FOR THE DISPOSAL OF INDUSTRIAL WASTES SHALL BE MADE TO SEWERS SHOWN ON THESE DRAWINGS WITHOUT WRITTEN PERMISSION FROM THE CHIEF ENGINEER AND GENERAL MANAGER OF THE COUNTY SANITATION DISTRICTS.

OLSON SURVEYING SERVICE INC. ASSUMES NO RESPONSIBILITY FOR THE LOCATION OF EXISTING UTILITY LINES. A THOROUGH SEARCH HAS BEEN MADE WITH UTILITY COMPANIES KNOWN TO HAVE LINES IN THIS AREA AND WITH THE COUNTY OF LOS ANGELES UNDERGROUND SECTION. THE SEWER CONTRACTOR SHALL VERIFY LOCATIONS AND ELEVATIONS OF ALL UTILITY LINES.

PROFILE ALIGNMENT AND GRADE OF **P.C. 5803**
SANITARY SEWERS PAGE 1
 TO BE CONSTRUCTED IN
CARPINTERO AVE.

PRIVATE CONTRACT NO. 5803
 W.S. 33
 1 SHEET ; 2 PAGES
 SCALE: VERT. 1"=4' FEB. 1961
 HORIZ. 1"=40'
 PREPARED IN THE OFFICES OF
OLSON SURVEYING SERVICE 30415
 BY *[Signature]*
 REG. C. E. NO. 7820
 FOR LEGEND SEE PLAN NO. S-A-64

NOTE:
 GRADES TO WHICH THIS IMPROVEMENT IS TO BE CONSTRUCTED ARE SHOWN ON PLANS AND PROFILES. GRADE POINTS FOR TOP OF CURBS, CENTER LINE OF STREETS OR CENTER LINE OF ALLEYS ARE SHOWN BY CIRCLES ON PROFILES. ALL ELEVATIONS ARE IN FEET ABOVE U.S.C. & G.S. SEA LEVEL DATUM OF 1929.
 THIS DRAWING AND THE DATA HEREON ARE HEREBY MADE A PART OF THE SPECIFICATIONS. WORK SHALL BE CONSTRUCTED ACCORDING TO SPECIFICATIONS ON FILE IN THE OFFICE OF THE CITY ENGINEER AND SHALL BE PROSECUTED ONLY IN THE PRESENCE OF THE CITY ENGINEER.
 BEFORE WORK CAN BE STARTED, THE CONTRACTOR MUST OBTAIN A PERMIT TO EXCAVATE IN CITY STREETS FROM THE CITY OF BELLFLOWER P.C.D. DEPARTMENT AND MAKE A DEPOSIT WITH THE CITY ENGINEER, CITY OF BELLFLOWER, 9833 BELMONT ST. SUFFICIENT TO COVER THE COST OF CONSTRUCTION INSPECTION AND RECORD PLANS.
 APPROVAL OF THIS PLAN BY THE CITY OF BELLFLOWER DOES NOT CONSTITUTE A REPRESENTATION AS TO THE ACCURACY OF THE LOCATION OR OF THE EXISTENCE OR NON-EXISTENCE OF ANY UNDERGROUND UTILITY PIPE OR STRUCTURE WITHIN THE LIMITS OF THIS PROJECT. THIS NOTE APPLIES TO ALL PAGES.
 IF WORK IS TO BE DONE IN A STATE HIGHWAY, A PERMIT MUST BE OBTAINED FROM THE STATE OF CALIFORNIA, DIVISION OF HIGHWAYS, 1200 SOUTH SPRING STREET.

CITY OF BELLFLOWER, CALIFORNIA
 APPROVED, JOHN A. LAMBIE, CITY ENGINEER APPROVED, C.R. COMPTON, CHIEF ENGINEER
 CO. SAN. DIST. NO. 2
 BY *[Signature]* ASST. SANITATION ENGINEER BY *[Signature]* OFFICE ENGINEER
 CHECKED BY *[Signature]* 3-22-61
 OFFICE OF CITY ENGINEER, REG. C. E. NO. 11636
 SUBMITTED BY *[Signature]* 3-21-61
 LOS CERRITOS REGIONAL ENGINEER, REG. C. E. NO. 3871

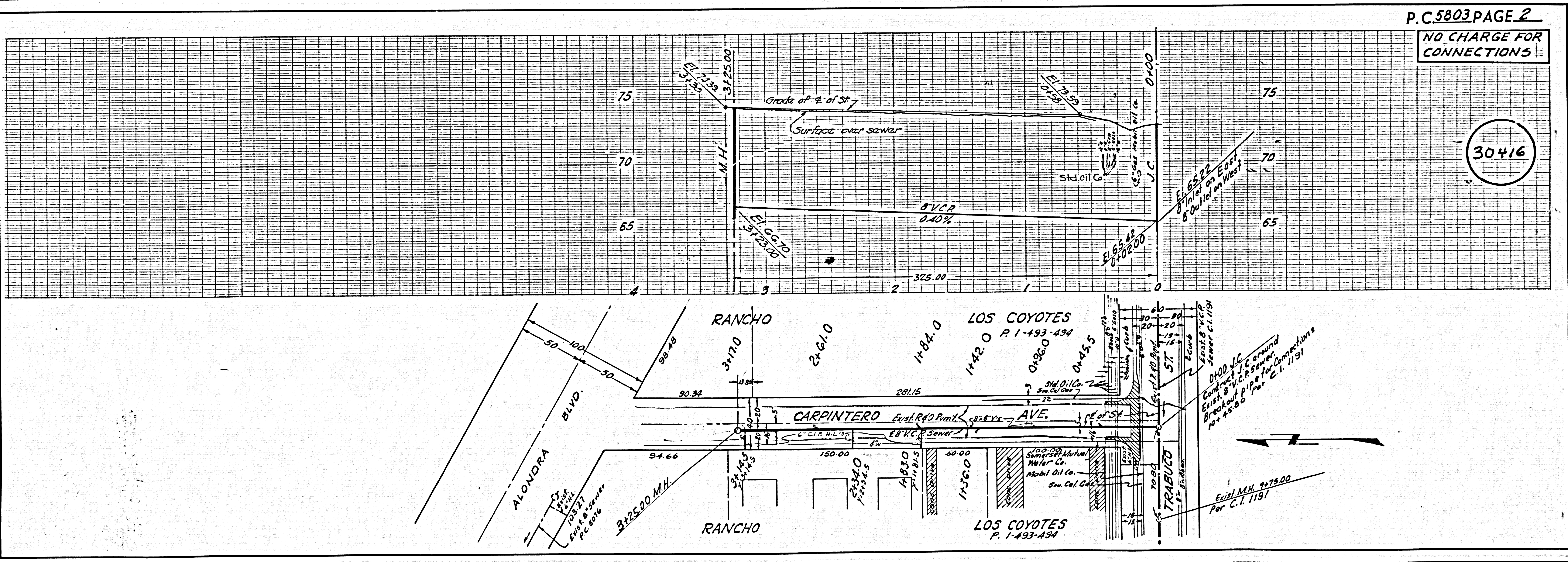

NO CHARGE FOR CONNECTIONS

30416

P.C. 5803 PAGE 2

P.C. 5803 SEWERS IN CARPINTERO AVE.