

CITY OF ROLLING HILLS ESTATE BLDG. DIST. NO. 12.03

PROFILE ALIGNMENT AND GRADE OF P.C. 5805
SANITARY SEWERS PAGE 1

TO BE CONSTRUCTED IN
SANITARY SEWER RIGHT OF WAY
5/8 RANCHVIEW ROAD
PRIVATE CONTRACT NO. 5805

W.S. 27
1 SHEET OF 2 PAGES
SCALE: VERT. 1"=4'
HORIZ. 1"=40'
FEBRUARY, 1961
PREPARED IN THE OFFICES OF
SOUTH BAY ENGINEERING CORP.
By: *Raymond L. Douglas*
REG. C. E. NO. 7191
FOR LEGEND SEE PLAN NO. S-A-44

31832

BENCH MARK
B.M. 49-A, Elev. 425.827 F.R. 1956 Adj. F.R. 1972 page 10.
Palos Verdes Drive North and Silver Sage Lane, 39 1/4 S.W. 1/4
of Approximate Centerline of Palos Verdes Drive North. A Standard
C.S. Brass Cap Monument Stamped "B.M. 49-A, 1955, R.E. 5869"
Flush With Top of Curb.

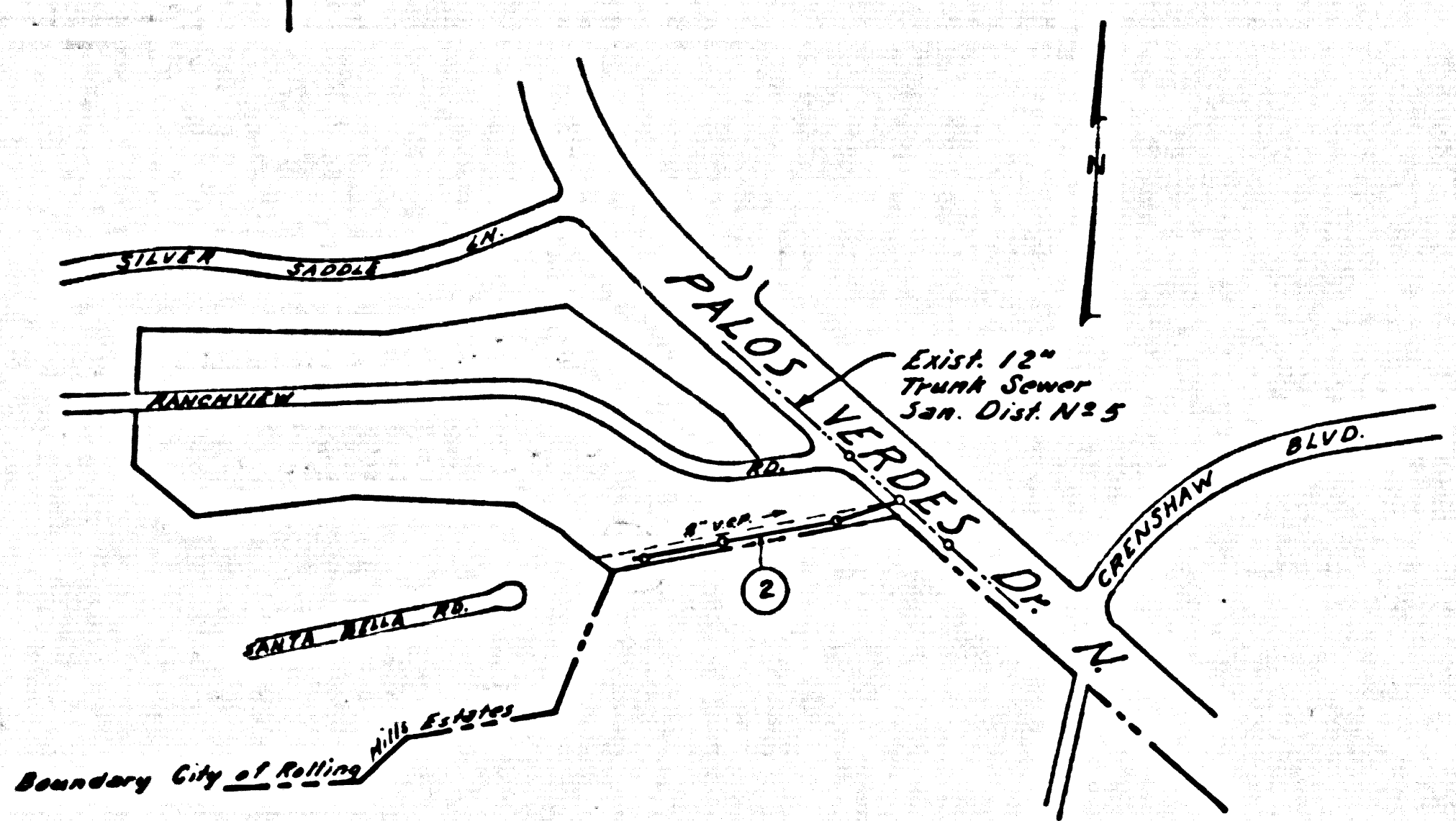

INDEX MAP
Scale 1"=600'
P.C. 5805

- NOTES:**
1. PROVIDE STAKES ON THE PROPERTY LINE OR PROPERTY LINES PRODUCED AT RIGHT ANGLES TO THE SEWER LINE AT THE CENTER LINE OF EACH MANHOLE.
 2. NO REPRESENTATIVE OF THE CITY ENGINEER WILL SURVEY OR LAY OUT ANY PORTION OF THE WORK.
 3. THE OWNER OR HIS AUTHORIZED REPRESENTATIVE SHALL FURNISH THE COUNTY ENGINEER WITH GRADE SHEETS AND STATIONING FOR ALL HOUSE LATERALS AND Y BRANCHES AND SHALL PROVIDE STAKES FOR THEM AT THEIR PROPER LOCATIONS WITH STATIONING PLAINLY MARKED. ANY CHANGE IN LOCATION SHALL BE REQUESTED IN WRITING BY THE OWNER OR HIS REPRESENTATIVE.
 4. THE PRIVATE ENGINEER SHALL FURNISH THE HOUSE LATERAL DEPTH AT THE PROPERTY LINE BELOW THE TOP OF CURB ELEVATION FOR EACH HOUSE LATERAL ON THE GRADE SHEET.
 5. NO REVISIONS SHALL BE MADE IN THESE PLANS WITHOUT THE APPROVAL OF THE CITY ENGINEER.
 6. USE STANDARD MANHOLE FRAMES AND COVERS, S-117.
 7. USE EXTRA STRENGTH PIPE, A.C.I. PIPE IS STANDARD DEPTH.
 8. USE "WEDGE-LOCK" OR "SPEED-SEAL" FOR ALL V.C.P. JOINTS PER SPECS, SECS. 34 & 46.
 9. RESURFACE ALL TRENCH WITHIN PAVED AREA TO MEET CITY ROAD DEPT. OR CALIF. STATE HIGHWAY REQUIREMENTS IN ACCORDANCE WITH PERMITS.
 10. ENCASE FOUR FEET OF SEWER AT POINTS OF INTERFERENCE WITH POLES, CASE III, S-172.
 11. HOUSE LATERALS TO BE CONSTRUCTED WITH INVERTS AT PROPERTY LINE FEET BELOW CURB GRADE EXCEPT AS NOTED.
 12. ALL STRUCTURES SHALL BE BRICK SEWER STRUCTURES, S-104.
 13. FOR ALLOWABLE LEAKAGE TEST USE FORMULA NO. 1 SPECS, SEC. 54.
 14. MANHOLE TOPS IN UNIMPROVED RIGHTS-OF-WAY TO BE SIX INCHES ABOVE FINISHED GRADE.
 15. THE CONTRACTOR SHALL NOTIFY THE CONSTRUCTION DIVISION BY TELEPHONE, M.A.S. 509 9-4747, EXT. 8181 AT LEAST TWENTY-FOUR HOURS BEFORE STARTING ANY WORK UNDER THIS CONTRACT.
 16. Specifications dated Oct. 25, 1961 Apply to the Construction of This Project.

NO CONNECTIONS FOR THE DISPOSAL OF INDUSTRIAL WASTES SHALL BE MADE TO SEWERS SHOWN ON THESE DRAWINGS WITHOUT WRITTEN PERMISSION FROM THE CHIEF ENGINEER AND GENERAL MANAGER OF THE COUNTY SANITATION DISTRICTS.

BEFORE BREAKING INTO ANY EXISTING STRUCTURE AND BEFORE FINAL ACCEPTANCE OF THIS WORK, COUNTY SANITATION DISTRICT (DU 41281) SHALL BE NOTIFIED IN ORDER THAT REQUIRED INSPECTION CAN BE MADE.

CONNECTION CHARGES AS INDICATED.
L. Carter 12-28-61

NOTE:
GRADES TO WHICH THIS IMPROVEMENT IS TO BE CONSTRUCTED ARE SHOWN ON PLANS AND PROFILES. GRADE POINTS FOR TOP OF CURBS, CENTER LINE OF STREETS, OR CENTER LINE OF ALLEYS ARE SHOWN BY CIRCLES ON PROFILES AT ALL POINTS BETWEEN DESIGNATED POINTS. THE GRADE SHALL BE ESTABLISHED SO AS TO CONFORM TO A STRAIGHT LINE DRAWN BETWEEN SAID DESIGNATED POINTS.
ELEVATIONS ARE IN FEET ABOVE U.S.C. & G.S. SEA LEVEL DATUM OF 1929.
THIS DRAWING AND THE DATA HEREON ARE HEREBY MADE A PART OF THE SPECIFICATIONS.
WORK SHALL BE CONSTRUCTED ACCORDING TO SPECIFICATIONS ON FILE IN THE OFFICE OF THE CITY ENGINEER AND SHALL BE PROSECUTED ONLY IN THE PRESENCE OF THE CITY ENGINEER.
BEFORE WORK CAN BE STARTED THE CONTRACTOR MUST OBTAIN A PERMIT TO EXCAVATE IN CITY STREETS FROM THE L. & COUNTY ROAD DEPT., DISTRICT OFFICE NO. 3, AND MAKE A DEPOSIT WITH THE CITY ENGINEER OF \$200.00 AS A GUARANTEE AGAINST DAMAGE TO THE CITY'S PROPERTY.
APPROVAL OF THIS PLAN BY THE CITY OF ROLLING HILLS ESTATES DOES NOT CONSTITUTE A REPRESENTATION AS TO THE ACCURACY OF THE LOCATION OF OR THE EXISTENCE OR NON-EXISTENCE OF ANY UNDERGROUND UTILITY PIPE, OR STRUCTURE WITHIN THE LIMITS OF THIS PROJECT. THIS NOTE APPLIES TO ALL PAGES.
IF WORK IS TO BE DONE IN A STATE HIGHWAY, A PERMIT MUST BE OBTAINED FROM THE STATE OF CALIFORNIA, DIVISION OF HIGHWAYS, 120 SOUTH SPRING STREET.

CITY OF ROLLING HILLS ESTATES
APPROVED, JOHN A. LAMBIE, CITY ENGINEER
APPROVED, J.D. PARKHURST, CHIEF ENGINEER
By: *Richard E. Kuhn* ASST. SANITATION ENGINEER
CHECKED BY: *J.R. Darda* 1-2-61
OFFICE OF CITY ENGINEER, REG. C. E. NO. 9404

SUBMITTED: *Jack C. Lansing*
PALOS VERDES-CENTINELA VALLEY REGIONAL ENGINEER

P.C. 5805 PAGE 2

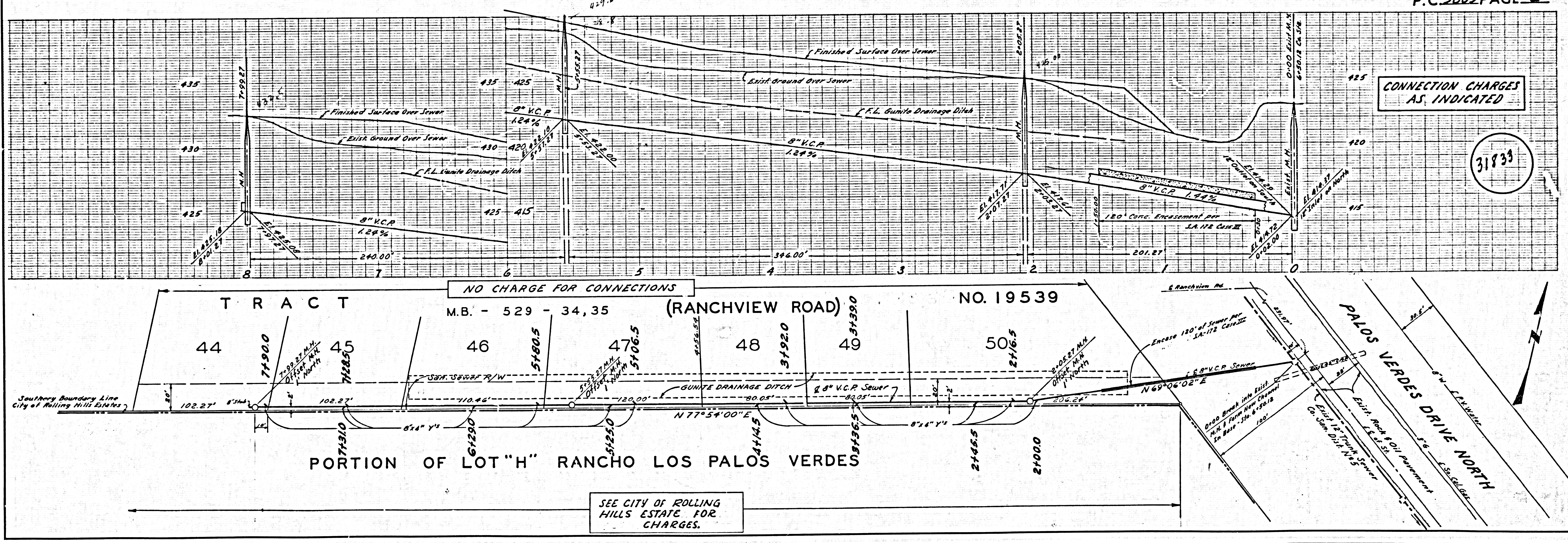

CONNECTION CHARGES AS INDICATED

31833

SEE CITY OF ROLLING HILLS ESTATE FOR CHARGES.