

LENNOX BLDG. DIST. NO. 7

PROFILE ALIGNMENT AND GRADE OF P.C. 5859
 SANITARY SEWERS PAGE 1
 TO BE CONSTRUCTED IN J.N. 0355. 81

107TH STREET EXTENSION

PRIVATE CONTRACT NO. 5859

W.S. 24

1 SHEET ; 2 PAGES

SCALE: VERT. 1" = 4' HORIZ. 1" = 40'

MARCH, 1961

PREPARED IN THE OFFICES OF

BARCLAY - PEARSON CO., INC.

By: *Edward J. Pearson*
 REG. C. E. NO. 9723

FOR LEGEND SEE PLAN NO. S-A-64

NOTE:
 GRADES TO WHICH THIS IMPROVEMENT IS TO BE CONSTRUCTED ARE SHOWN ON PLANS AND PROFILES. GRADE POINTS FOR TOP OF CURBS, CENTER LINE OF STREETS, OR CENTER LINE OF ALLEYS ARE SHOWN BY CIRCLES ON PROFILES. AT ALL POINTS BETWEEN DESIGNATED POINTS THE GRADE SHALL BE ESTABLISHED SO AS TO CONFORM TO A STRAIGHT LINE DRAWN BETWEEN SAID DESIGNATED POINTS.
 ELEVATIONS ARE IN FEET ABOVE U.S.C. & G.S. SEA LEVEL DATUM OF 1929.
 THIS DRAWING AND THE DATA HEREON ARE HEREBY MADE A PART OF THE SPECIFICATIONS.
 WORK SHALL BE CONSTRUCTED ACCORDING TO SPECIFICATIONS ON FILE IN THE OFFICE OF THE COUNTY ENGINEER AND SHALL BE PROSECUTED ONLY IN THE PRESENCE OF THE COUNTY ENGINEER.
 BEFORE WORK CAN BE STARTED, THE CONTRACTOR MUST OBTAIN A PERMIT TO EXCAVATE IN COUNTY STREETS FROM THE L.A. COUNTY ROAD DEPT., DISTRICT OFFICE NO. 8, AND PAY A FEE TO THE COUNTY ENGINEER, ROOM 30 COUNTY ENGINEER BLDG., 100 WASHINGTON STREET, SUFFICIENT TO COVER THE COST OF CONSTRUCTION INSPECTION AND RECORD PLANS.
 APPROVAL OF THIS PLAN BY THE COUNTY OF LOS ANGELES DOES NOT CONSTITUTE A REPRESENTATION AS TO THE ACCURACY OF THE LOCATION OF OR THE EXISTENCE OR NON-EXISTENCE OF ANY UNDERGROUND UTILITY PIPE, OR STRUCTURE WITHIN THE LIMITS OF THIS PROJECT. THIS NOTE APPLIES TO ALL PAGES.
 IF WORK IS TO BE DONE IN A STATE HIGHWAY, A PERMIT MUST BE OBTAINED FROM THE STATE OF CALIFORNIA, DIVISION OF HIGHWAYS, 148 SOUTH SPRING STREET.

COUNTY OF LOS ANGELES, CALIFORNIA

APPROVED, JOHN A. LAMBIE, COUNTY ENGINEER APPROVED, C. R. COMPTON, CHIEF ENGINEER

CO. SAN. DIST. NO. 5

By: *C. R. Compton* ASST. SANITATION ENGINEER By: *J. Lambie* OFFICE ENGINEER

CHECKED BY: *St. Onda* 9-1-61

OFFICE OF COUNTY ENGINEER, REG. C. E. NO. 2446

SUBMITTED BY: *Jack C. Lansing*
 PALOS VERDES - CENTINELA VALLEY REGIONAL ENGINEER

BENCH MARK
 S.V. 2721 L.F.T. in east curb of Prairie Avenue 100' North of Co. Res. at SE. cor. of 107th Street and Prairie Avenue. Elev. = 77.324 HAW. QUAD.

INDEX MAP
 P.C. NO. 5859

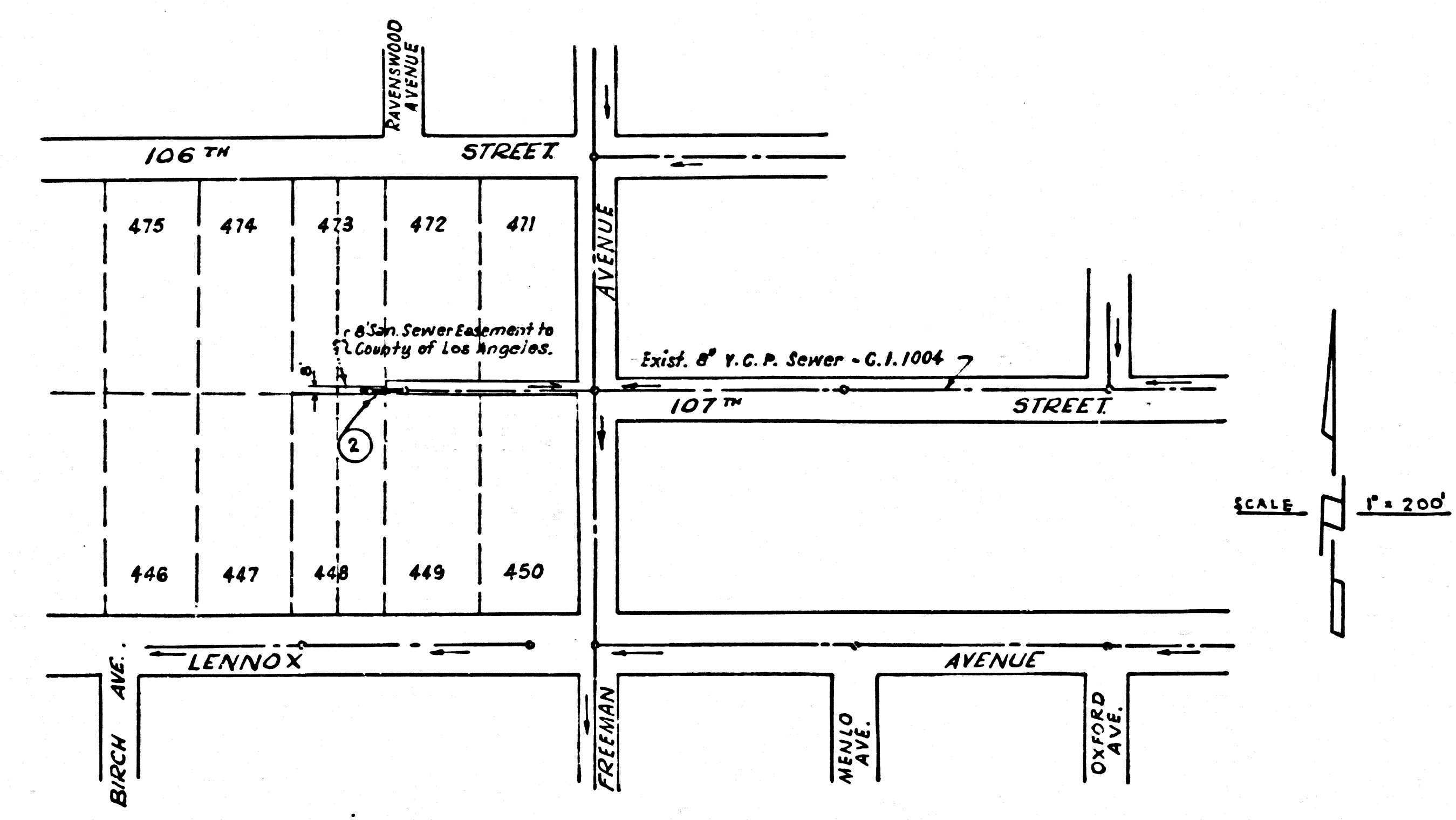

NO CHARGE FOR CONNECTIONS
 8-30-61

NO CONNECTIONS FOR THE DISPOSAL OF INDUSTRIAL WASTES SHALL BE MADE TO SEWERS SHOWN ON THESE DRAWINGS WITHOUT WRITTEN PERMISSION FROM THE CHIEF ENGINEER AND GENERAL MANAGER OF THE COUNTY SANITATION DISTRICTS.

P.C. 5859 PAGE 2

NO CHARGE FOR CONNECTIONS

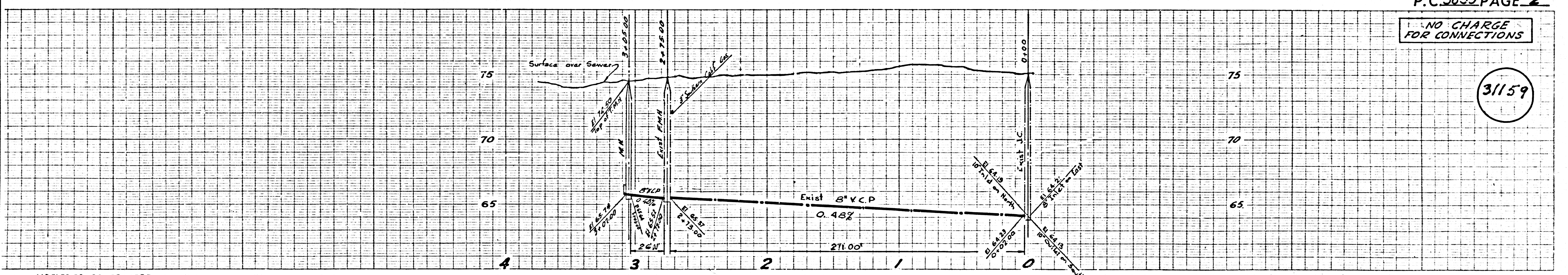

31159

NOTICE TO CONTRACTOR:
 RETURN FLUSHING DEVICE TO COUNTY SEWER MAINTENANCE SOUTH YARD AT 1129 E. 59TH STREET, LOS ANGELES.

TRACT

TRACT

