

BELLFLOWER BLDG. DIST. NO. 407

PROFILE ALIGNMENT AND GRADE OF **P.C. 5900**
SANITARY SEWERS PAGE 1
 TO BE CONSTRUCTED IN

BENCH MARK: M.L. 32 F.B. 1477-31 ELEV. 70.720
 Boat Sp. in conc. paving 5'22" West and 3'21" North of
 centerline intersection of Alondra Blvd. & Virginia Ave.

- NOTES:
1. PROVIDE STAKES ON THE PROPERTY LINE OR PROPERTY LINES PRODUCED AT RIGHT ANGLES TO THE SEWER LINE AT THE CENTER LINE OF EACH MANHOLE.
 2. NO REPRESENTATIVE OF THE CITY ENGINEER WILL SURVEY OR LAY OUT ANY PORTION OF THE WORK.
 3. THE OWNER OR HIS AUTHORIZED REPRESENTATIVE SHALL FURNISH THE CITY ENGINEER WITH GRADE SHEETS AND STATIONING FOR ALL HOUSE LATERALS AND Y BRANCHES AND SHALL PROVIDE STAKES FOR THEM AT THEIR PROPER LOCATIONS WITH STATIONING PLAINLY MARKED. ANY CHANGE IN LOCATION SHALL BE REQUESTED IN WRITING BY THE OWNER OR HIS REPRESENTATIVE.
 4. THE PRIVATE ENGINEER SHALL FURNISH THE HOUSE LATERAL DEPTH AT THE PROPERTY LINE BELOW THE TOP OF CURB ELEVATION FOR EACH HOUSE LATERAL ON THE GRADE SHEET.
 5. NO REVISIONS SHALL BE MADE IN THESE PLANS WITHOUT THE APPROVAL OF THE CITY ENGINEER.
 6. USE 3/4" x 6" x 12" MANHOLE FRAME AND COVER S-2-191
 7. USE STANDARD STRENGTH PIPE.
 8. USE CEMENT MORTAR OR "WEDGE-LOCK" OR "SPEED-SEAL" FOR ALL Y.C.A. JOINTS PER SPECS. SECS. 36 & 41.
 9. RESURFACE ALL TRENCH WITHIN PAVED AREA TO MEET CITY OF BELLFLOWER OR CALIF. STATE HIGHWAY REQUIREMENTS IN ACCORDANCE WITH PERMITS.
 10. ENCASE FOUR FEET OF SEWER AT POINTS OF INTERFERENCE WITH POLES, CASE III, 3-172.
 11. HOUSE LATERALS TO BE CONSTRUCTED WITH 4" x 1/2" x 1/2" pipe per P.C. 5900 property line
 12. ALL STRUCTURES SHALL BE BRICK SEWER STRUCTURES, S-2-190.
 13. FOR ALLOWABLE LEAKAGE TEST USE FORMULA NO. 1, SPECS. SEC. 54.
 14. MANHOLE TOPS IN UNIMPROVED RIGHTS-OF-WAY TO BE SIX INCHES ABOVE FINISHED GRADE.
 15. THE CONTRACTOR SHALL NOTIFY THE CONSTRUCTION DIVISION BY TELEPHONE, MADSON 5-4147, EXT. (155) AT LEAST TWENTY-FOUR HOURS BEFORE STARTING ANY WORK UNDER THIS CONTRACT.
 16. STANDARD SPECIFICATIONS DATED OCTOBER 10, 1960, ON FILE IN CITY HALL, APPLY IN THE CONSTRUCTION OF THIS PROJECT.

VIRGINIA AVENUE
PRIVATE CONTRACT NO. 5900

W.S. 33
 1 SHEETS; 2 PAGES
 SCALE: VERT. 1"=4' HORIZ. 1"=40' MAY, 1961
 PREPARED IN THE OFFICES OF:
GLEN ROOD
 CONGTON, CALIFORNIA
 REG. C. E. NO. 2093

30876

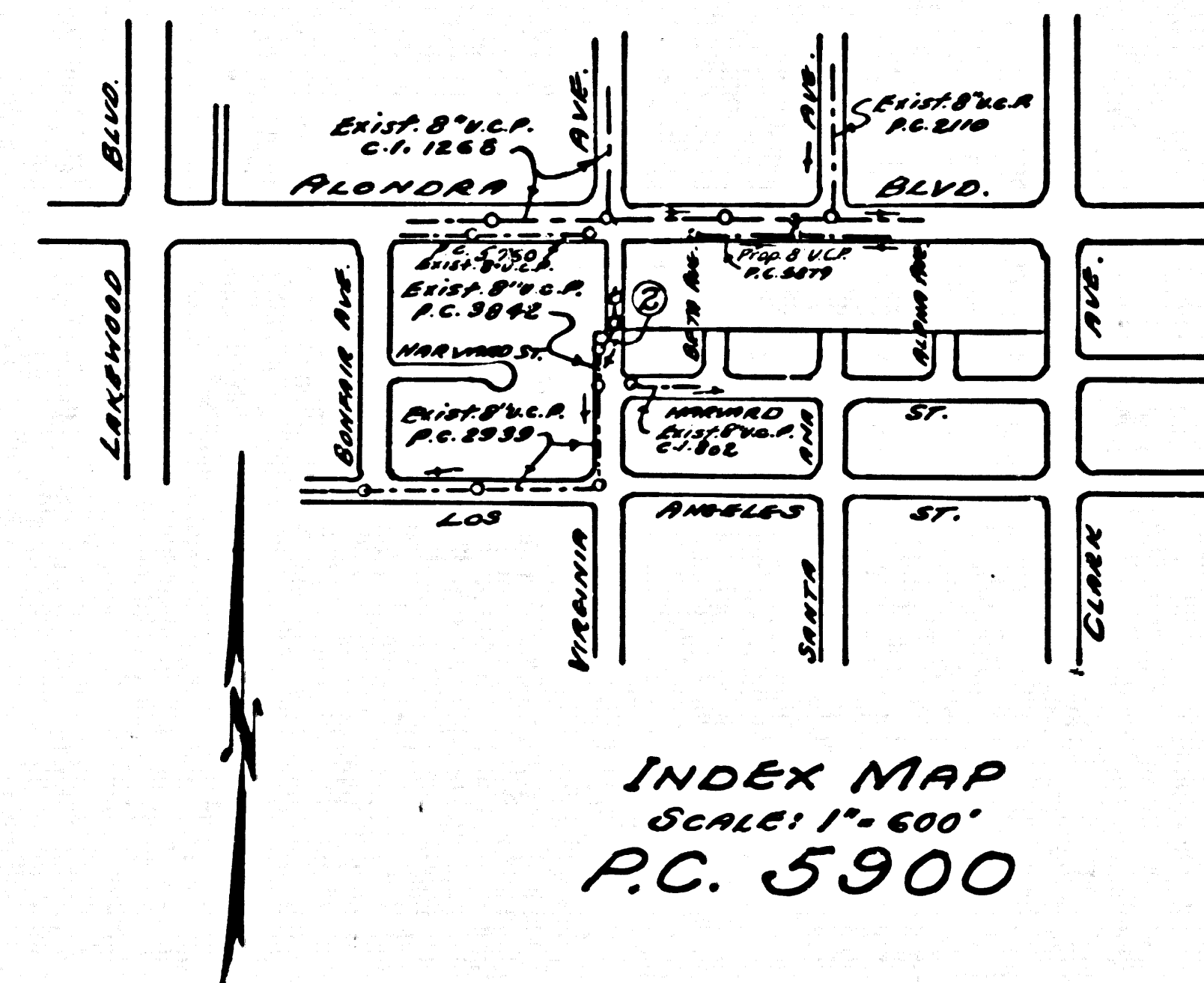

NO CHARGE FOR CONNECTIONS
 J. Hillman 6-22-61

NOTE:
 GRADES TO WHICH THIS IMPROVEMENT IS TO BE CONSTRUCTED ARE SHOWN ON PLANS AND PROFILE. GRADE POINTS FOR TOP OF CURB, CENTER LINE OF STREETS, OR CENTER LINE OF ALLEYS ARE SHOWN BY CIRCLES ON PROFILES. AT ALL POINTS BETWEEN DESIGNATED POINTS THE GRADE SHALL BE ESTABLISHED SO AS TO CONFORM TO A STRAIGHT LINE DRAWN BETWEEN SAID DESIGNATED POINTS.
 ELEVATIONS ARE IN FEET ABOVE U.S.C. & G.S. SEA LEVEL DATUM OF 1929.
 THIS DRAWING AND THE DATA HEREON ARE HEREBY MADE A PART OF THE SPECIFICATIONS.
 WORK SHALL BE CONSTRUCTED ACCORDING TO SPECIFICATIONS ON FILE IN THE OFFICE OF THE CITY ENGINEER AND SHALL BE PROSECUTED ONLY IN THE PRESENCE OF THE CITY ENGINEER.
 BEFORE WORK CAN BE STARTED, THE CONTRACTOR MUST OBTAIN A PERMIT TO EXCAVATE IN CITY STREETS FROM THE CITY OF BELLFLOWER AND MAKE A DEPOSIT WITH THE CITY OF BELLFLOWER \$1,000.00 SUFFICIENT TO COVER THE COST OF CONSTRUCTION IN ACCORDANCE WITH RECORD PLANS.
 APPROVAL OF THIS PLAN BY THE CITY OF BELLFLOWER DOES NOT CONSTITUTE A REPRESENTATION AS TO THE ACCURACY OF THE LOCATION OF OR THE EXISTENCE OR NON-EXISTENCE OF ANY UNDERGROUND UTILITY PIPE, OR STRUCTURE WITHIN THE LIMITS OF THIS PROJECT. THIS NOTE APPLIES TO ALL PAGES.
 IF WORK IS TO BE DONE IN A STATE HIGHWAY, A PERMIT MUST BE OBTAINED FROM THE STATE OF CALIFORNIA, DIVISION OF HIGHWAYS, 120 SOUTH SPRING STREET.

CITY OF BELLFLOWER, CALIFORNIA
 APPROVED, JOHN A. LAMBIE, CITY ENGINEER APPROVED, C. R. CONNOR, CHIEF ENGINEER
 BY C. E. Priddy ASST. SANITATION ENGINEER BY H. C. Priddy OFFICE ENGINEER
 CHECKED BY J. K. Wicks 6-22-61
 OFFICE OF CITY ENGINEER, REG. C. E. NO. 2406

NO CONNECTIONS FOR THE DISPOSAL OF INDUSTRIAL WASTES SHALL BE MADE TO SEWERS SHOWN ON THESE DRAWINGS WITHOUT WRITTEN PERMISSION FROM THE CHIEF ENGINEER AND GENERAL MANAGER OF THE COUNTY SANITATION DISTRICTS.

SUBMITTED BY: John L. Esten 6-22-61
 LOS CERRITOS REGIONAL ENGINEER, REG. C. E. NO. 3371

P.C. 5900 PAGE 2

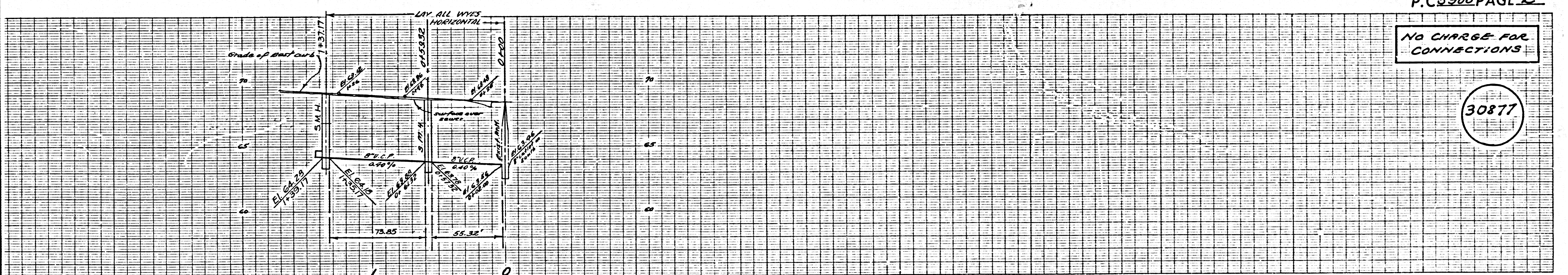

NO CHARGE FOR CONNECTIONS

30877

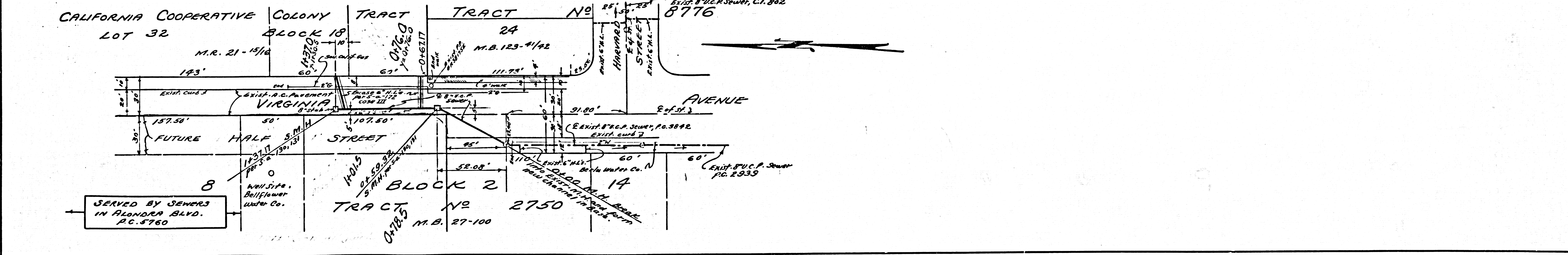

VIRGINIA AVE. P.C. 5900