

LOMITA BLDG. DIST. NO. 12

PROFILE ALIGNMENT AND GRADE OF P.C. 5932

SANITARY SEWERS PAGE 1

TO BE CONSTRUCTED IN J.N. 0356.24

RIGHT-OF-WAY  
WEST OF AVOCADO ST.  
PRIVATE CONTRACT NO. 5932

W.S. 28

1 SHEET ; 2 PAGES  
SCALE: VERT. 1" = 4'  
HORIZ. 1" = 40' OCT 10, 1961

31292

PREPARED IN THE OFFICES OF  
LANCO  
14527 SO. WESTERN AVE., GARDENA, CALIF.  
By *David J. East* REG. C. E. NO. 12460

FOR LEGEND SEE PLAN NO. S-A-64

NOTE:  
GRADES TO WHICH THIS IMPROVEMENT IS TO BE CONSTRUCTED ARE SHOWN ON PLANS AND PROFILES. GRADE POINTS FOR TOP OF CURBS, CENTER LINE OF STREETS, OR CENTER LINE OF ALLEYS ARE SHOWN BY CIRCLES ON PROFILES. AT ALL POINTS BETWEEN DESIGNATED POINTS THE GRADE SHALL BE ESTABLISHED SO AS TO CONFORM TO A STRAIGHT LINE DRAWN BETWEEN SAID DESIGNATED POINTS.  
ELEVATIONS ARE IN FEET ABOVE U.S.C. & G.S. SEA LEVEL DATUM OF 1929.  
THIS DRAWING AND THE DATA HEREON ARE HEREBY MADE A PART OF THE SPECIFICATIONS.  
WORK SHALL BE CONSTRUCTED ACCORDING TO SPECIFICATIONS ON FILE IN THE OFFICE OF THE COUNTY ENGINEER AND SHALL BE PROSECUTED ONLY IN THE PRESENCE OF THE COUNTY ENGINEER.  
BEFORE WORK CAN BE STARTED, THE CONTRACTOR MUST OBTAIN A PERMIT TO EXCAVATE IN COUNTY STREETS FROM THE L. A. COUNTY ROAD DEPT., DISTRICT OFFICE NO. 3, AND PAY A FEE TO WITH THE COUNTY ENGINEER, ROOM 300, COUNTY ENGINEER BLDG., ROOM 120 ST. SUFFICIENT TO COVER THE COST OF CONSTRUCTION INSPECTION AND RECORD PLANS.  
APPROVAL OF THIS PLAN BY THE COUNTY OF LOS ANGELES DOES NOT CONSTITUTE A REPRESENTATION AS TO THE ACCURACY OF THE LOCATION OF OR THE EXISTENCE OR NON-EXISTENCE OF ANY UNDERGROUND UTILITY PIPE, OR STRUCTURE WITHIN THE LIMITS OF THIS PROJECT. THIS NOTE APPLIES TO ALL PAGES.  
IF WORK IS TO BE DONE IN A STATE HIGHWAY, A PERMIT MUST BE OBTAINED FROM THE STATE OF CALIFORNIA, DIVISION OF HIGHWAYS, 128 SOUTH SPRING STREET.

COUNTY OF LOS ANGELES, CALIFORNIA

APPROVED, JOHN A. LAMBIE, COUNTY ENGINEER APPROVED, J. D. PAREKH, CHIEF ENGINEER

BY *John A. Lambie* SANITATION ENGINEER BY *J. D. Parekh* CHIEF ENGINEER

CHECKED BY *Bill Under* 11-2-61 OFFICE OF COUNTY ENGINEER, REG. C. E. NO. 3406

SUBMITTED *Jack C. Kausings* PAUL VERDES - CENTINELY VALLEY REGIONAL ENGINEER

- NOTES:
1. PROVIDE STAKES ON THE PROPERTY LINE OR PROPERTY LINES PRODUCED AT RIGHT ANGLES TO THE SEWER LINE AT THE CENTER LINE OF EACH MANHOLE.
  2. NO REPRESENTATIVE OF THE COUNTY ENGINEER WILL SURVEY OR LAY OUT ANY PORTION OF THE WORK.
  3. THE OWNER OR HIS AUTHORIZED REPRESENTATIVE SHALL FURNISH THE COUNTY ENGINEER WITH GRADE SHEETS AND STATIONING FOR ALL HOUSE LATERALS AND Y BRANCHES AND SHALL PROVIDE STAKES FOR THEM AT THEIR PROPER LOCATIONS WITH STATIONING PLAINLY MARKED. ANY CHANGE IN LOCATION SHALL BE REQUESTED IN WRITING BY THE OWNER OR HIS REPRESENTATIVE.
  4. THE PRIVATE ENGINEER SHALL FURNISH THE HOUSE LATERAL DEPTH AT THE PROPERTY LINE BELOW THE TOP OF CURB ELEVATION FOR EACH HOUSE LATERAL ON THE GRADE SHEET.
  5. NO REVISIONS SHALL BE MADE IN THESE PLANS WITHOUT THE APPROVAL OF THE COUNTY ENGINEER.
  6. USE STANDARD MANHOLE FRAMES AND COVERS, S-117.
  7. USE EXTRA STRENGTH PIPE ALL PIPE IS STANDARD DEPTH.
  8. USE CEMENT MORTAR OR "WEDGE-LOCK" OR "SEAL" FOR ALL V.C.P. JOINTS PER SPEC., SECS. 34 & 48.
  9. RESURFACE ALL TRENCH WITHIN PAVED AREA TO MEET L.A. COUNTY ROAD DEPT. OR CALIF. STATE HIGHWAY REQUIREMENTS IN ACCORDANCE WITH PERMITS.
  10. ENCASE FOUR FEET OF SEWER AT POINTS OF INTERFERENCE WITH POLES, CASE III, S-172.
  11. ALL STRUCTURES SHALL BE BRICK SEWER STRUCTURES, S-104.
  12. FOR ALLOWABLE LEAKAGE TEST USE FORMULA NO. 1, SPEC., SEC. 54.
  13. MANHOLE TOPS IN UNIMPROVED RIGHTS-OF-WAY TO BE FLUSH WITH FINISHED GRADE.
  14. THE CONTRACTOR SHALL NOTIFY THE CONSTRUCTION DIVISION BY TELEPHONE, MADISON 9-4747, AT LEAST TWENTY-FOUR HOURS BEFORE STARTING ANY WORK UNDER THIS CONTRACT.
  15. SPECIFICATIONS DATED OCTOBER 23, 1961, APPLY IN THE CONSTRUCTION OF THIS PROJECT.
  16. THE EXIST. LOCATION OF ANY UNDERGROUND UTILITY PIPES OR STRUCTURES SHOWN ON THIS PLAN ARE OBTAINED BY A SEARCH OF THE AVAILABLE RECORDS. TO THE BEST OF OUR KNOWLEDGE, THERE ARE NO EXISTING UTILITIES EXCEPT AS SHOWN ON THIS MAP. THE CONTRACTOR IS REQUIRED TO TAKE PRECAUTIONS TO PROTECT THE UTILITY LINES SHOWN & ANY OTHER LINES NOT OF RECORD OR NOT SHOWN ON THIS DRAWING.

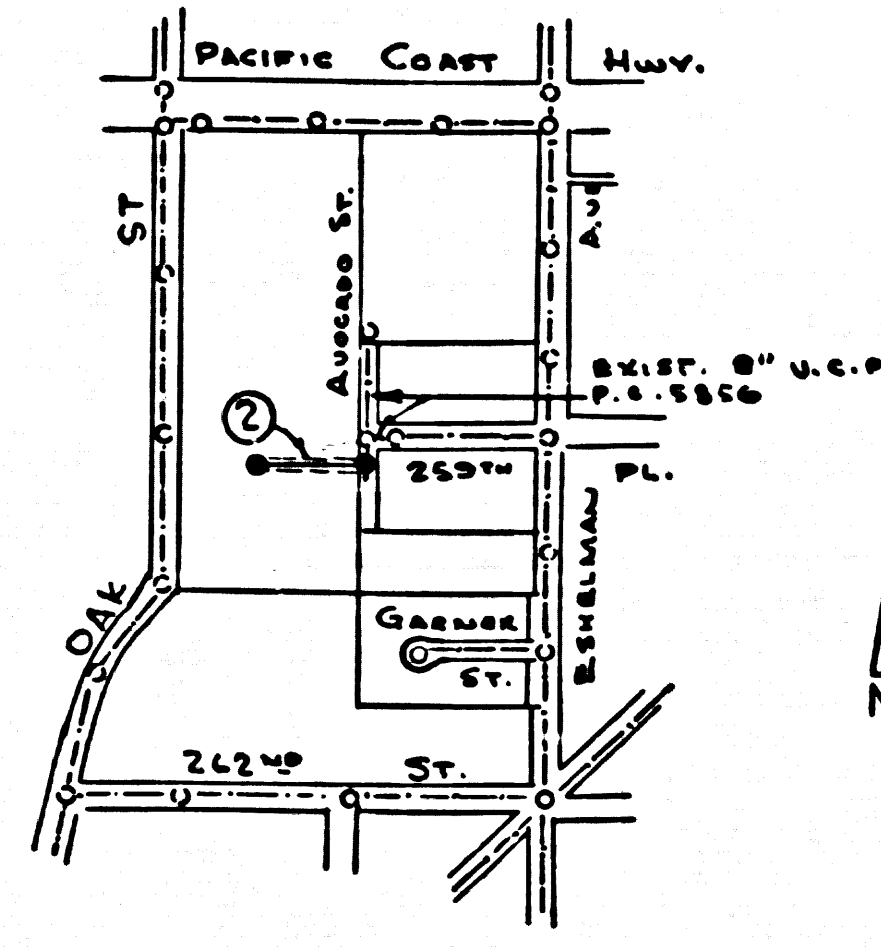

INDEX MAP  
SCALE: 1" = 600'

B.M. 51.3533 EL. 116.700 - STD. DISK  
200' WEST OF 1/4 OF ESHELMAN ON  
THE NORTH SIDE OF PACIFIC COAST  
HWY. AT WEST END OF TWO STORY  
BRICK BLDG. (LOMITA ODD FELLOWS) IN  
THE SOUTHWEST CORN. 2.8' EAST  
OF SOUTHWEST CORN. 2.8' ABOVE  
SIDEWALK. STAMPED S-99, 1932 - B.L. 1955

Revision:  
Break into exist. M.H. at a 45° angle and form  
new channel in base. Make 8" sewer and M.H.  
at Sta. 0+25.00 from 10" to 8" and of wood  
property line to miss concrete encasement of  
8" storm drain.  
APPROVED *E. J. Smith* 10-12-61  
REG. C. E. NO. 7227

NO CHARGE FOR  
CONNECTIONS  
*L. Smith* 10-27-61

NO CONNECTIONS FOR THE DISPOSAL OF  
INDUSTRIAL WASTES SHALL BE MADE TO  
SEWERS SHOWN ON THESE DRAWINGS  
WITHOUT WRITTEN PERMISSION FROM THE  
CHIEF ENGINEER AND GENERAL MANAGER  
OF THE COUNTY SANITATION DISTRICTS.

P.C. 5932 PAGE 2

NO CHARGE FOR  
CONNECTIONS

31293

