

DUB 191861 WAC 8222.09

P.C. 5938

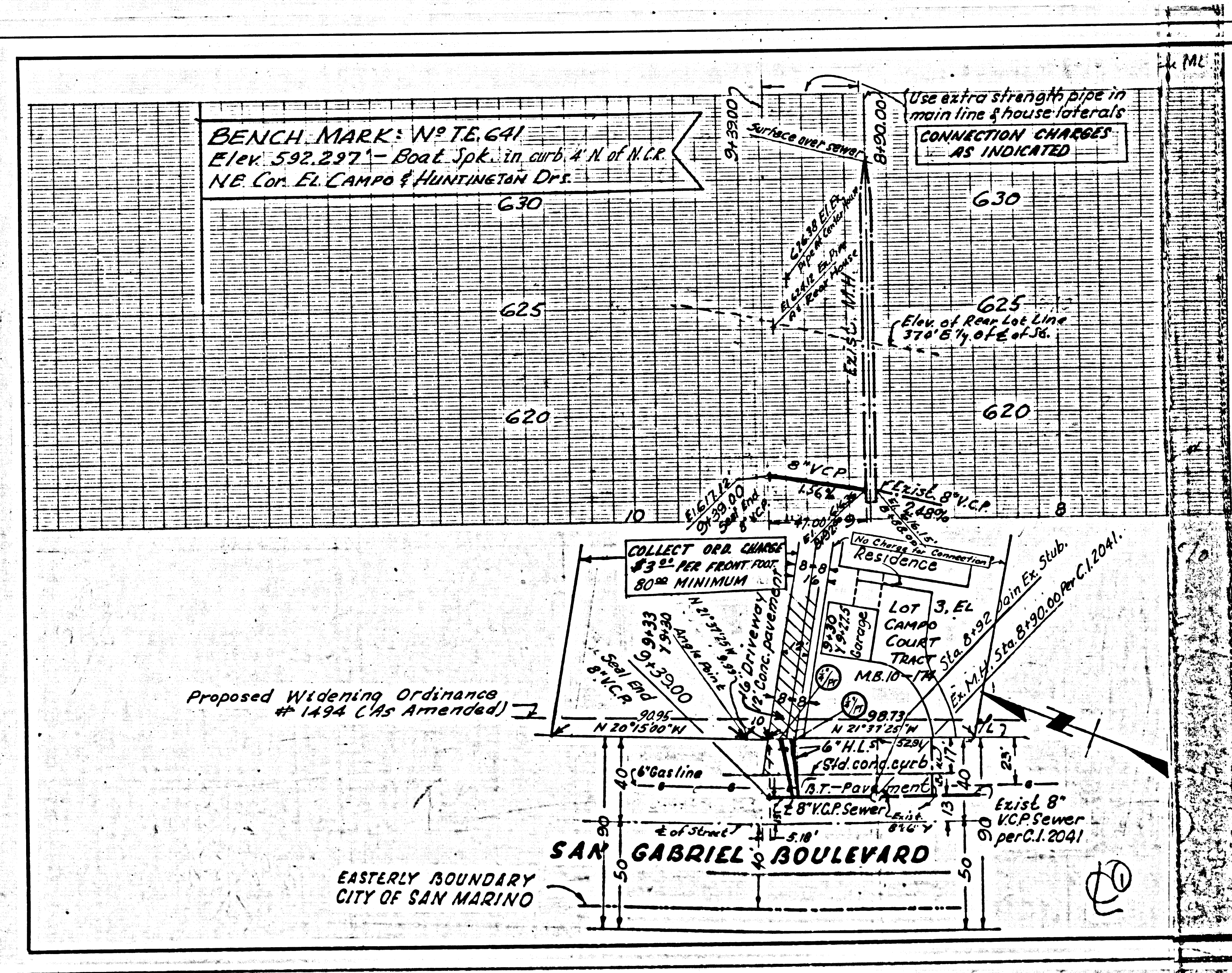

ALTADENA BLDG. DIST. NO. 3

- NOTES:**
- PROVIDE STAKES ON THE PROPERTY LINE OR PROPERTY LINES PRODUCED AT RIGHT ANGLES TO THE SEWER LINE AT THE CENTER LINE OF EACH MANHOLE.
 - NO REPRESENTATIVE OF THE COUNTY ENGINEER WILL SURVEY OR LAYOUT ANY PORTION OF THE WORK.
 - THE OWNER OR HIS AUTHORIZED REPRESENTATIVE SHALL FURNISH THE COUNTY ENGINEER WITH GRADE SHEETS AND STATIONING FOR ALL HOUSE LATERALS AND Y BRANCHES AND SHALL PROVIDE STAKES FOR THEM AT THEIR PROPER LOCATIONS WITH STATIONING PLAINLY MARKED. ANY CHANGE IN LOCATION SHALL BE REQUESTED IN WRITING BY THE OWNER OR HIS REPRESENTATIVE.
 - NO REVISIONS SHALL BE MADE IN THESE PLANS WITHOUT THE APPROVAL OF THE COUNTY ENGINEER.
 - USE STANDARD MANHOLE FRAMES AND COVERS, S.A. 117.
 - USE 8" VCP STRENGTH PIPE.
 - USE CEMENT MORTAR, WEDGE LOCK OR SPEED SEAL JOINTS FOR VCP JOINTS, SPECS - 36 B 48.
 - RESURFACE ALL TRENCH WITHIN PAVED AREA TO MEET L.A. COUNTY ROAD DEPT. OR CALIF. STATE HIGHWAY DEPT. REQUIREMENTS IN ACCORDANCE WITH PERMITS.
 - ENCASE FOUR FEET OF SEWER AT POINTS OF INTERFERENCE WITH POLES, S.A. 119.
 - FIGURES IN CIRCLES AT ENDS OF HOUSE LATERALS INDICATE HOUSE LATERALS SHALL BE CONSTRUCTED WITH A RISE OF 1/8" PER FOOT TO PROPERTY LINE.
 - ALL STRUCTURES SHALL BE BRICK SEWER STRUCTURES, S.A. 104.
 - FOR ALLOWABLE LEAKAGE TEST USE FORMULA NO. 1 - SPCL, SEC. 81.
 - STANDARD SPECIFICATION DATED OCTOBER 10, 1960 APPLY TO THE CONSTRUCTION OF THIS PROJECT.
 - THE CONTRACTOR SHALL NOTIFY THE CONSTRUCTION DIVISION BY TELEPHONE MADISON 9-4747 EXT. 81551, AT LEAST 24 HOURS BEFORE STARTING ANY WORK UNDER THIS CONTRACT.

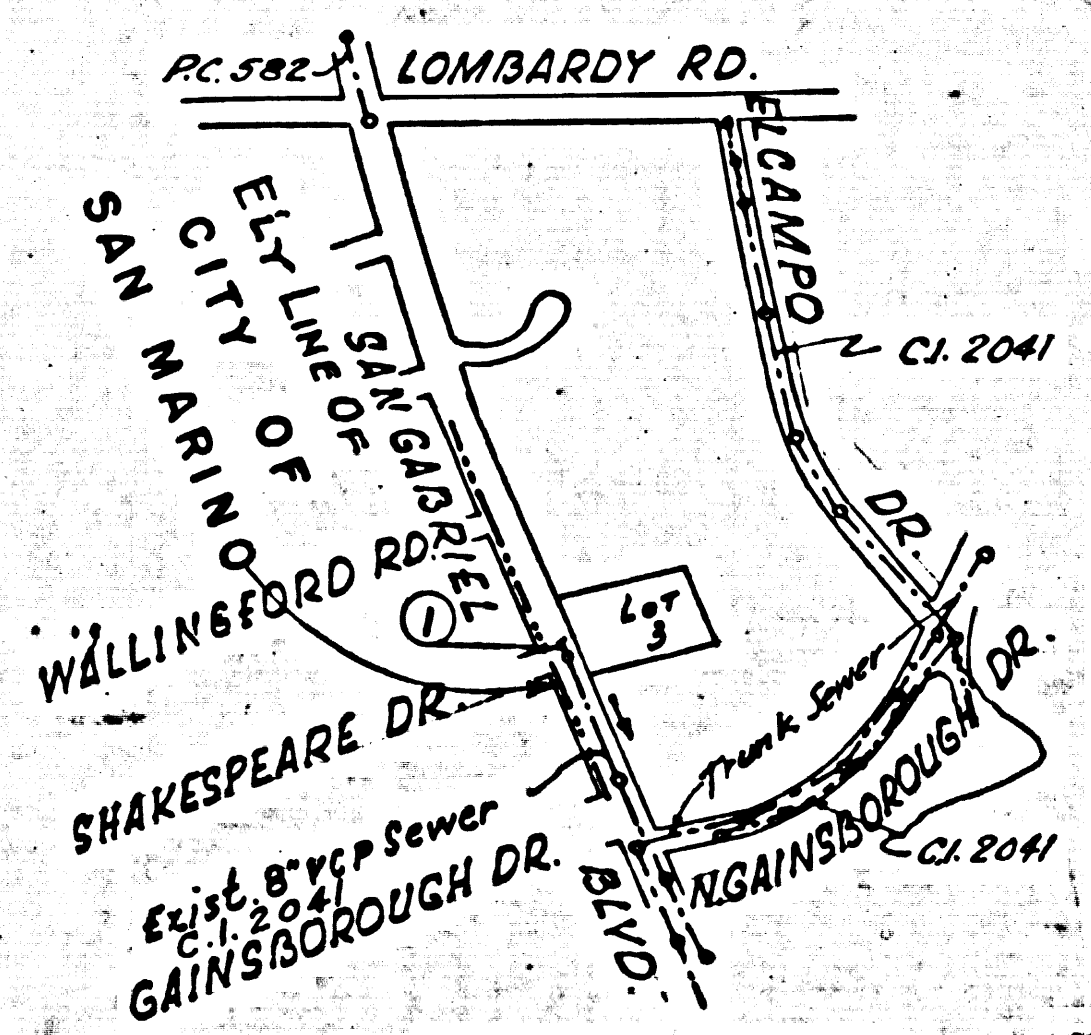

REVISED 8-3-61
DELETED MANHOLE STA. 9+41.00
APPROVED
BY *N.F. Brannan*
SAN GABRIEL VALLEY REGIONAL ENGINEER

CONNECTION CHARGES
AS INDICATED
W.F. Jan 7/12/61

NO CONNECTIONS FOR THE DISPOSAL OF INDUSTRIAL WASTES SHALL BE MADE TO SEWER STRUCTURES UNLESS THE SEWER STRUCTURE IS SPECIFICALLY DESIGNED FOR SUCH PURPOSES BY THE COUNTY ENGINEER.

PROFILE ALIGNMENT AND GRADE OF **P.C. 5938**
SANITARY SEWERS PAGE 1
TO BE CONSTRUCTED IN **J.N. 0356.29**
SAN GABRIEL BOULEVARD

PRIVATE CONTRACT NO. 5938

W.S. 44
1 SHEETS, 1 PAGES
SCALE: VERT. 1" = 4'
HORIZ. 1" = 40'
JULY, 1961.

PREPARED IN THE OFFICES OF
H.C. THORN AND ASSOCIATES

BY *John A. Thorn*
REG. C. E. NO. 2678
FOR LEGEND SEE PLAN NO. S.A-64

NOTES:

GRADES TO WHICH THIS IMPROVEMENT IS TO BE CONSTRUCTED ARE SHOWN ON PLANS AND PROFILES. GRADE POINTS FOR TOP OF CURB, CENTER LINE OF STREETS, OR CENTER LINE OF ALLEYS ARE SHOWN BY CIRCLES ON PROFILES. AT ALL POINTS BETWEEN DESIGNATED POINTS THE GRADE SHALL BE ESTABLISHED SO AS TO CONFORM TO A STRAIGHT LINE DRAWN BETWEEN SAID DESIGNATED POINTS.

ELEVATIONS ARE IN FEET ABOVE U.S.C. & G.S. SEA LEVEL DATUM OF 1929.

THIS DRAWING AND THE DATA HEREON ARE HEREBY MADE A PART OF THE SPECIFICATIONS.

WORK SHALL BE CONSTRUCTED ACCORDING TO SPECIFICATIONS ON FILE IN THE OFFICE OF THE COUNTY ENGINEER AND SHALL BE PROSECUTED ONLY IN THE PRESENCE OF THE COUNTY ENGINEER.

BEFORE WORK CAN BE STARTED, THE CONTRACTOR MUST OBTAIN A PERMIT TO EXCAVATE IN COUNTY STREETS FROM THE L.A. COUNTY ROAD DEPT., DIST. OFF. # 2 AND PAY A FEE TO THE COUNTY ENGINEER, ROOM 310, L.A. CO. ENGR. BLDG., 108 W. 2ND ST., SUFFICIENT TO COVER THE COST OF CONSTRUCTION INSPECTION AND RECORD PLANS.

APPROVAL OF THIS PLAN BY THE COUNTY OF LOS ANGELES DOES NOT CONSTITUTE A REPRESENTATION AS TO THE ACCURACY OF THE LOCATION OR THE EXISTENCE OR NON-EXISTENCE OF ANY UNDERGROUND UTILITY PIPES OR STRUCTURES WITHIN THE LIMITS OF THIS PROJECT. THIS NOTE APPLIES TO ALL PAGES.

IF WORK IS TO BE DONE ON A STATE HIGHWAY, A PERMIT MUST BE OBTAINED FROM THE STATE OF CALIFORNIA, DIVISION OF HIGHWAYS, 120 SOUTH SPRING STREET.

COUNTY OF LOS ANGELES, CALIFORNIA

APPROVED, JOHN A. LAMBE, COUNTY ENGINEER
APPROVED, CR. COMPTON, CHIEF ENGINEER
CO. SAN. DIST. NO. 13

BY *C.E. Brannan* ASST. SANITATION ENGINEER
BY *S.L. Brannan* OFFICE ENGINEER

CHECKED BY *B.F. Harding* 7-29-61
OFFICE OF COUNTY ENGINEER, REG. C. E. NO. 11636

SUBMITTED BY: *N.F. Brannan*
SAN GABRIEL VALLEY REGIONAL ENGINEER

022036