

B.M. G-3
 200' W. of E. Garfield & 300' N. of A.T.&S.F. R.R.
 L. & B.N. in Bottom Step @ Ely Entrance to
 Whse Bldg. (Business Systems Inc.)
 L.B. 193, p. 5 Elev. 157.04
 Road Constr. B.M. Revera Quod.

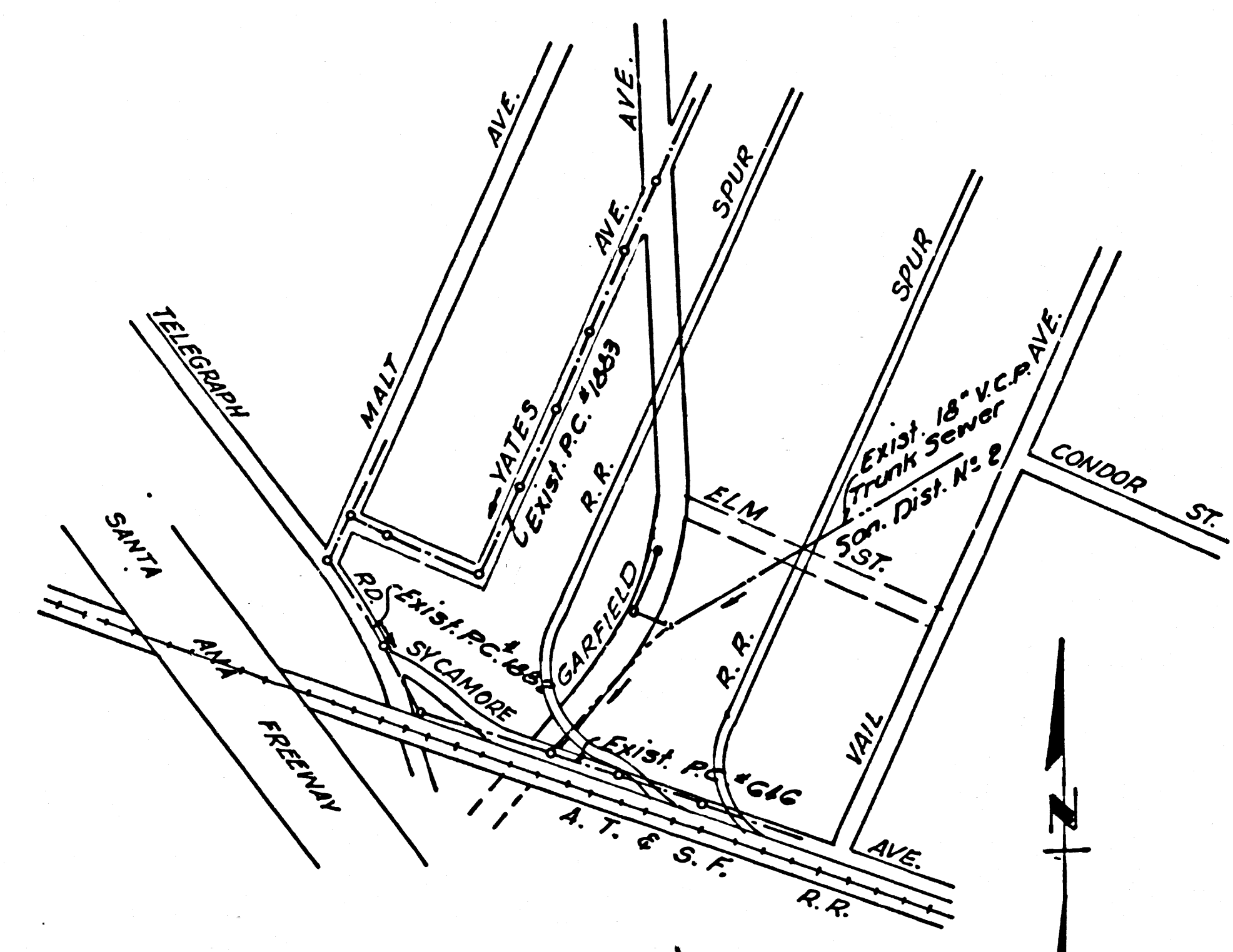

Before breaking into any existing structure
 and before final acceptance of this work,
 County Sanitation District (DU 4-1281) shall
 be notified in order that required inspection
 can be made.

INDEX MAP
 SCALE 1" = 500'
 P.C. NO 5964

CITY OF COMMERCE, BLDG. DIST. NO 6.01

PROFILE ALIGNMENT AND GRADE OF P.C. 5964
 SANITARY SEWERS PAGE 1

GARFIELD AVE.
 PRIVATE CONTRACT NO. 5964

W.S. 36
 1 SHEET 2 PAGES
 SCALE: VERT. 1" = 4'
 HORIZ. 1" = 40'
 SEPT. 1961
 PREPARED IN THE OFFICES OF
 ENGINEERING - SCIENCE
 150 EAST FOOTHILL BOULEVARD
 IRVINE, CALIFORNIA
 By: *James O. Maguire*
 REG. C. E. NO. 9398

32417

- NOTES:
1. PROVIDE STAKES ON THE PROPERTY LINE OR PROPERTY LINES PRODUCED AT RIGHT ANGLES TO THE SEWER LINE AT THE CENTER LINE OF EACH MANHOLE.
 2. NO REPRESENTATIVE OF THE CITY ENGINEER WILL SURVEY OR LAY OUT ANY PORTION OF THE WORK.
 3. THE OWNER OR HIS AUTHORIZED REPRESENTATIVE SHALL FURNISH THE CITY ENGINEER WITH GRADE SHEETS AND STATIONING FOR ALL HOUSE LATERALS AND Y BRANCHES AND SHALL PROVIDE STAKES FOR THEM AT THEIR PROPER LOCATIONS WITH STATIONING PLAINLY MARKED. ANY CHANGE IN LOCATION SHALL BE REQUESTED IN WRITING BY THE OWNER OR HIS REPRESENTATIVE.
 4. THE PRIVATE ENGINEER SHALL FURNISH THE HOUSE LATERAL DEPTH AT THE PROPERTY LINE BELOW THE TOP OF CURB ELEVATION FOR EACH HOUSE LATERAL ON THE GRADE SHEET.
 5. NO REVISIONS SHALL BE MADE IN THESE PLANS WITHOUT THE APPROVAL OF THE CITY ENGINEER.
 6. USE STANDARD MANHOLE FRAMES AND COVERS, 5-117, A.
 7. USE EXTRA STRENGTH PIPES: ALL PIPE IS STANDARD DEPTH EXCEPT AS NOTED.
 8. USE CEMENT MORTAR OR MECHANICAL COMPRESSION JOINTS FOR ALL V.C.P. JOINTS PER SPEC'S, SECS. M & N FOR MAIN LINE.
 9. RESURFACE ALL TRENCH WITHIN PAVED AREA TO MEET L.A. COUNTY ROAD DEPT. OR CALIF. STATE HIGHWAY REQUIREMENTS IN ACCORDANCE WITH PERMITS.
 10. ENCASE FOUR FEET OF SEWER AT POINTS OF INTERFERENCE WITH POLES, CASE III, 5-117.
 11. HOUSE LATERALS TO BE CONSTRUCTED WITH INVERTS AT PROPERTY LINE 7' FT BELOW FUTURE CURB GRADE EXCEPT AS NOTED.
 12. FOR ALLOWABLE LEAKAGE TEST USE FORMULA NO. 1, SPEC'S, SEC. 34.
 13. MANHOLE TOPS IN UNIMPROVED RIGHTS-OF-WAY TO BE SIX INCHES ABOVE FINISHED GRADE.
 14. THE CONTRACTOR SHALL NOTIFY THE CONSTRUCTION DIVISION BY TELEPHONE, MADISON 5-141, EXT. 81227, AT LEAST TWENTY-FOUR HOURS BEFORE STARTING ANY WORK UNDER THIS CONTRACT.
 15. STANDARD SPECIFICATIONS DATED MAY 25, 1962 APPLY IN THE CONSTRUCTION OF THIS PROJECT.
 16. MANHOLES SHALL BE BRICK SEWER STRUCTURES PER S-2-104 EXCEPT AS NOTED. PRECAST CONCRETE MANHOLES PER S-2-125 OR S-2-125 MAY BE USED AS AN ALTERNATE IN LOCATIONS APPROVED BY THE CITY ENGINEER.
 17. USE MECHANICAL COMPRESSION JOINTS FOR ALL V.C.P. HOUSE LATERALS PER SPEC'S, SEC. 36.

NO WELLS WITHIN 200' OF SEWER (107)

CONNECTION CHARGES AS INDICATED
A. S. Albertson 9/22/61

NO CONNECTIONS FOR THE DISPOSAL OF INDUSTRIAL WASTES SHALL BE MADE TO SEWERS SHOWN ON THESE DRAWINGS WITHOUT WRITTEN PERMISSION FROM THE CHIEF ENGINEER AND GENERAL MANAGER OF THE COUNTY SANITATION DISTRICTS.

FOR LEGEND SEE PLAN NO. S-A-64

GRADES TO WHICH THIS IMPROVEMENT IS TO BE CONSTRUCTED ARE SHOWN ON PLANS AND PROFILES. GRADE POINTS FOR TOP OF CURBS, CENTER LINE OF STREETS OR CENTER LINE OF ALLEYS ARE SHOWN BY CIRCLES ON PROFILES. AT ALL POINTS BETWEEN DESIGNATED POINTS THE GRADE SHALL BE ESTABLISHED SO AS TO CONFORM TO A STRAIGHT LINE DRAWN BETWEEN SAID DESIGNATED POINTS.

ELEVATIONS ARE IN FEET ABOVE U.S.C. & G.S. SEA LEVEL DATUM OF 1929.

THIS DRAWING AND THE DATA HEREON ARE HEREBY MADE A PART OF THE SPECIFICATIONS.

WORK SHALL BE CONSTRUCTED ACCORDING TO SPECIFICATIONS ON FILE IN THE OFFICE OF THE CITY ENGINEER AND SHALL BE PROSECUTED ONLY IN THE PRESENCE OF THE CITY ENGINEER.

BEFORE WORK CAN BE STARTED, THE CONTRACTOR MUST OBTAIN A PERMIT TO EXCAVATE IN CITY STREETS FROM THE L. A. COUNTY ROAD DEPT., DISTRICT OFFICE R. 1, AND MAKE A DEPOSIT WITH THE CITY OF COMMERCE, BRIDGE ST., AT L.A. COUNTY, LOS ANGELES, SUFFICIENT TO COVER THE COST OF CONSTRUCTION INSPECTION AND RECORD PLANS.

APPROVAL OF THIS PLAN BY THE CITY OF COMMERCE DOES NOT CONSTITUTE A REPRESENTATION AS TO THE ACCURACY OF THE LOCATION OF OR THE EXISTENCE OR NON-EXISTENCE OF ANY UNDERGROUND UTILITY PIPE, OR STRUCTURE WITHIN THE LIMITS OF THIS PROJECT. THIS NOTE APPLIES TO ALL PAGES.

IF WORK IS TO BE DONE IN A STATE HIGHWAY, A PERMIT MUST BE OBTAINED FROM THE STATE OF CALIFORNIA, DIVISION OF HIGHWAYS, 126 SOUTH SPRING STREET.

CITY OF COMMERCE, CALIFORNIA

APPROVED, JOHN A. LAMBIE, CITY ENGINEER APPROVED, JOHN D. PARKHURST, CHIEF ENGINEER
 CO. SAN. DIST. NO. 2

By: *John S. Kahan* ASST. SANITATION ENGINEER By: *J. Posthumus* OFFICE ENGINEER

CHECKED BY: *Sheila D. Jones*
 OFFICE OF CITY ENGINEER, REG. C. E. NO. 3484

SUBMITTED BY: *A. J. Brumfield*
 SAN GABRIEL VALLEY REGIONAL ENGINEER

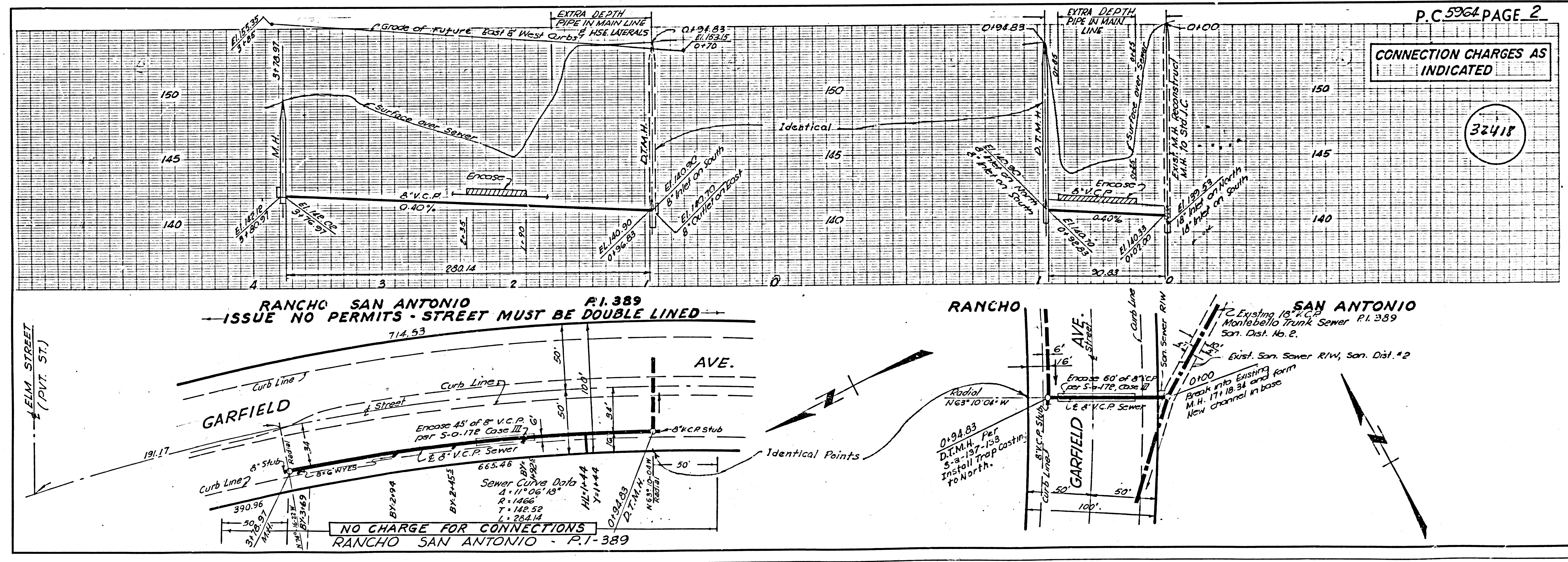

CONNECTION CHARGES AS INDICATED

32418

P.C. 5964 PAGE 2

RANCHO SAN ANTONIO P.I. 389
 ISSUE NO PERMITS - STREET MUST BE DOUBLE LINED

RANCHO SAN ANTONIO P.I. 389
 Existing 18" V.C.P. Montebello Trunk Sewer P.I. 389 San. Dist. No. 2

NO CHARGE FOR CONNECTIONS
 RANCHO SAN ANTONIO - P.I. 389