

Bench Mark: S.Y. 4391
 R.D. B.M. tag in N. curb Crest Road ± 2'
 W. curb opening 40' N. E. Crest Road E
 ± 78' E. Hawthorne Boulevard E1.933.340.

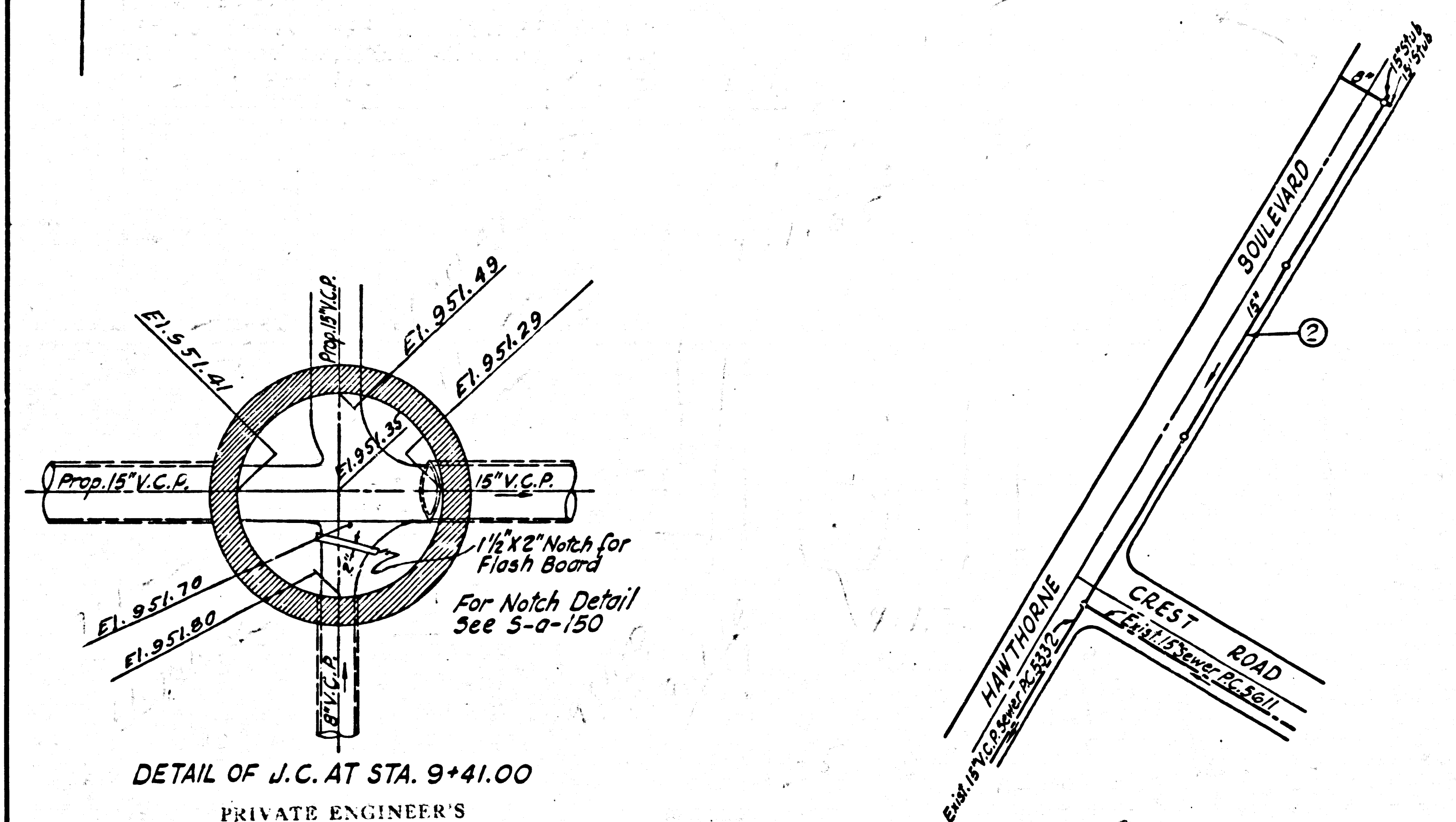

DETAIL OF J.C. AT STA. 9+41.00

PRIVATE ENGINEER'S
 NOTICE TO CONTRACTOR
 THE EXISTENCE AND LOCATION OF ANY UNDERGROUND UTILITY PIPES OR STRUCTURES SHOWN ON THESE PLANS ARE OBTAINED BY A SEARCH OF THE AVAILABLE RECORDS TO THE BEST OF OUR KNOWLEDGE. THERE ARE NO E.B.T.C.G. UTILITIES EXCEPT AS SHOWN ON THIS MAP. THE CONTRACTOR IS REQUIRED TO TAKE PRECAUTIONARY MEASURES TO PROTECT THE UTILITY LINES SHOWN AND ANY OTHER LINES NOT OF RECORD OR NOT SHOWN ON THIS DRAWING.

INDEX MAP
 P.C.5973
 Scale: 1"=200'

APPROVED *[Signature]*
 Industrial Waste Division

NO CHARGE
 FOR CONNECTIONS
[Signature] 11-17-61

DOUBLE SCALE
 LOMITA BLDG. DIST. NO.12
 PROFILE ALIGNMENT AND GRADE OF
 SANITARY SEWERS PAGE 1
 TO BE CONSTRUCTED IN J.N.0356.54
 HAWTHORNE BOULEVARD
 FROM CREST ROAD TO 860' NORTHERLY
 OF CREST ROAD
 PRIVATE CONTRACT NO.5973
 W.S. 27
 1 SHEET, 2 PAGES
 SCALE: VERT. 1"=5' HORIZ. 1"=40' AUGUST, 1961
 PREPARED IN THE OFFICES OF
 ENGINEERING SERVICE CORPORATION
 BY: *[Signature]*
 REG. C. E. NO. 3692

NO CONNECTIONS FOR THE DISPOSAL OF INDUSTRIAL WASTES SHALL BE MADE TO SEWERS SHOWN ON THESE DRAWINGS WITHOUT WRITTEN PERMISSION FROM THE CHIEF ENGINEER AND GENERAL MANAGER OF THE COUNTY SANITATION DISTRICTS.

ENGINEERING SERVICE CORPORATION
 1127 W. WASHINGTON BLVD. RI. 9-7281
 LOS ANGELES 15, CALIF.

REVISIONS		TRACED BY <i>G. Falgout</i>			
		DES'G'D BY <i>E. Komoto</i>			
		CK'D BY <i>A.A. McCloskey</i>			
		SUBMITTED			
SUB STRUCTURES OK'D					
W. O. NO.	DWG. NO.	DATE	SCALE	L. B.	F. B.
7303-15		July 1961	As Noted	964	

NOTE:
 GRADES TO WHICH THIS IMPROVEMENT IS TO BE CONSTRUCTED ARE SHOWN ON PLANS AND PROFILES. GRADE POINTS FOR TOP OF CURBS, CENTER LINE OF STREETS, OR CENTER LINE OF ALLEYS ARE SHOWN BY CIRCLES ON PROFILES. AT ALL POINTS BETWEEN DESIGNATED POINTS THE GRADE SHALL BE ESTABLISHED SO AS TO CONFORM TO A STRAIGHT LINE DRAWN BETWEEN SAID DESIGNATED POINTS.
 ELEVATIONS ARE IN FEET ABOVE U. S. C. & G. S. SEA LEVEL DATUM OF 1929.
 THIS DRAWING AND THE DATA HEREON ARE HEREBY MADE A PART OF THE SPECIFICATIONS.
 WORK SHALL BE CONSTRUCTED ACCORDING TO SPECIFICATIONS ON FILE IN THE OFFICE OF THE COUNTY ENGINEER AND SHALL BE PROSECUTED ONLY IN THE PRESENCE OF THE COUNTY ENGINEER.
 BEFORE WORK CAN BE STARTED, THE CONTRACTOR MUST OBTAIN A PERMIT TO EXCAVATE IN COUNTY STREETS FROM THE L. A. COUNTY ROAD DEPT., DISTRICT VII & PAY A FEE TO THE COUNTY ENGINEER, ROOM 310, COUNTY ENGINEER BLDG. 118 W. 2ND ST., SUFFICIENT TO COVER THE COST OF CONSTRUCTION INSPECTION AND RECORD PLANS.
 APPROVAL OF THIS PLAN BY THE COUNTY OF LOS ANGELES DOES NOT CONSTITUTE A REPRESENTATION AS TO THE ACCURACY OF THE LOCATION OF OR THE EXISTENCE OR NON-EXISTENCE OF ANY UNDERGROUND UTILITY PIPE, OR STRUCTURE WITHIN THE LIMITS OF THIS PROJECT. THIS NOTE APPLIES TO ALL PAGES.
 IF WORK IS TO BE DONE IN A STATE HIGHWAY, A PERMIT MUST BE OBTAINED FROM THE STATE OF CALIFORNIA, DIVISION OF HIGHWAYS, 130 SOUTH SPRING STREET.

COUNTY OF LOS ANGELES, CALIFORNIA
 APPROVED, JOHN A. LAMISE, COUNTY ENGINEER
 APPROVED, J.B. MCGUIRE, CHIEF ENGINEER
 BY: *[Signature]* SAN. DIST. NO. 5
 BY: *[Signature]* OFFICE ENGINEER
 CHECKED BY: *[Signature]* 11-23-61
 OFFICE OF COUNTY ENGINEER, REG. C. E. NO. 2464
 SUBMITTED *[Signature]*
 Palos Verdes-Centintola Valley Regional Engineer

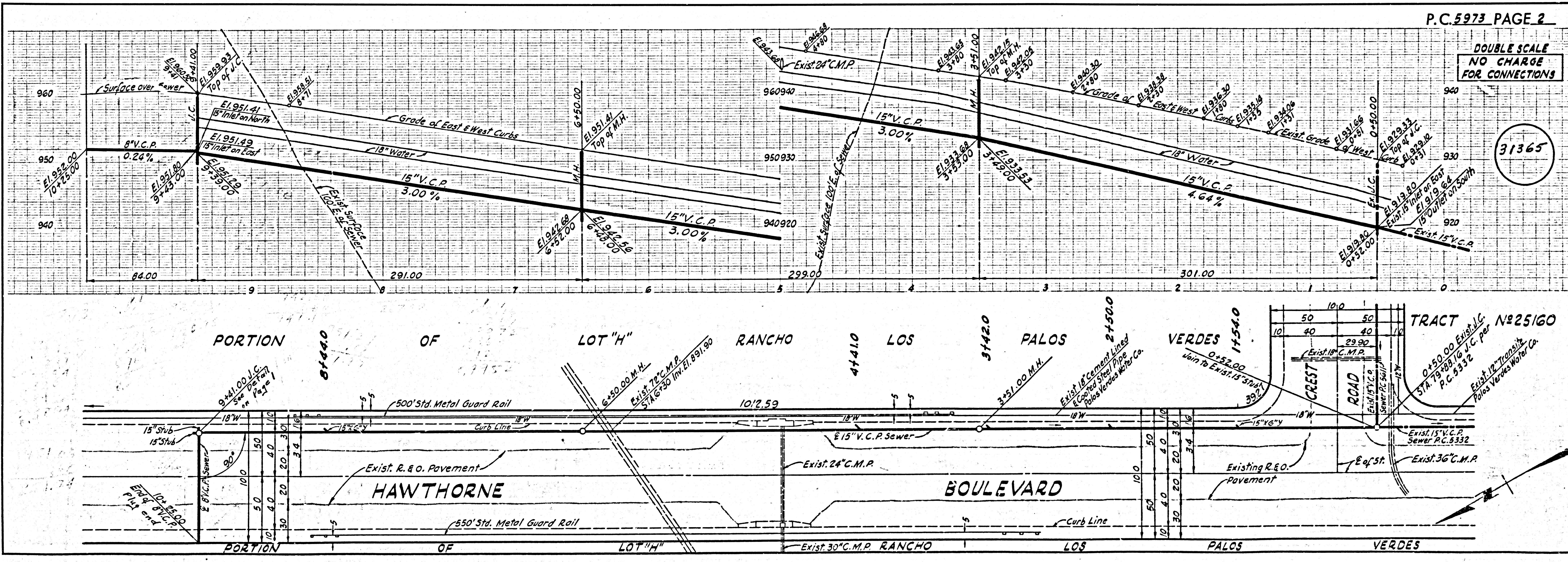

DOUBLE SCALE
 NO CHARGE
 FOR CONNECTIONS

31365

PORTION OF LOT "H" OF RANCHO LOS PALOS VERDES 41410 31420 21500
 HAWTHORNE BOULEVARD
 PORTION OF LOT "H" OF RANCHO LOS PALOS VERDES 41410 31420 21500
 TRACT No 25160
 0.45000 Exst. J.C. STA. 75+89.16 J.C. per P.C. 5973
 Exst. 18" C.M.P.
 Exst. 15" V.C.P. Sewer P.C. 5932
 Exst. 12" Transit Palos Verdes Water Co.