

23297 1 6 5 of 2 PAGES

BM - MW28 El. 272.880 F.B. 2197-14, SWEETZER AVE. & NORTON AVE - S.E. COR WIRE SPK. 2' S. of S. END C.R.

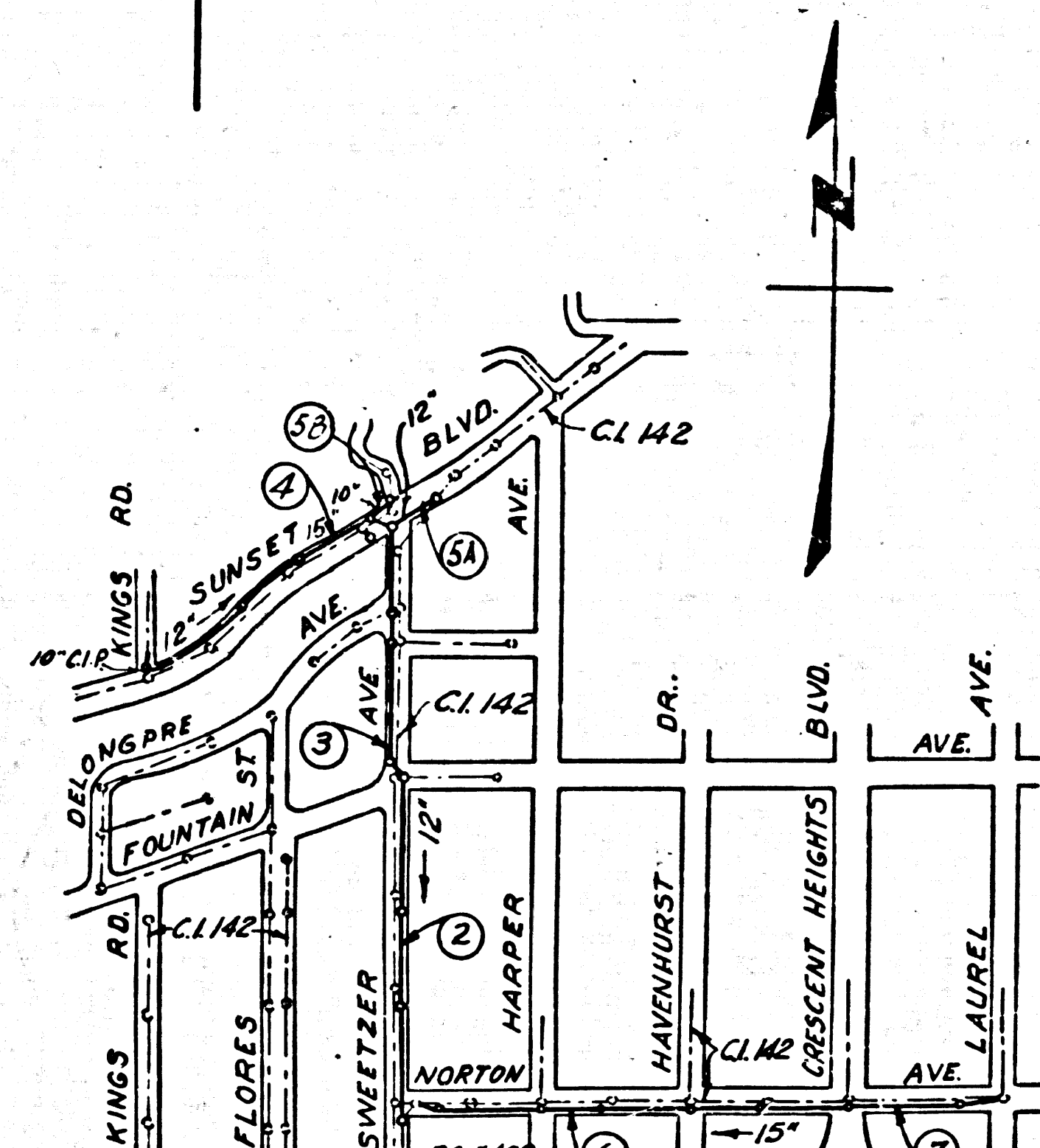

INDEX MAP WEST HOLLYWOOD RELIEF SEWERS SUNSET BLVD & OTHER R/W - P.C. 6051 Scale 1" = 600'

RESURFACING SCHEDULE table with columns: Page No., Street, Station From, Station To, Resurfacing. Includes notes on joint replacement and cement concrete specifications.

Note 'A' - Replace to joints or scores with Cement Concrete equal in thickness to the thickness of the material removed... All Cement Concrete used in resurfacing shall be Class 'A' concrete.

DOUBLE SCALE WEST HOLLYWOOD BUILDING DISTRICT NO. 9

USE EXTRA STRENGTH PIPE. ALL PIPE IS STANDARD DEPTH EXCEPT AS NOTED.

FLOW IN EXISTING SERVICES MUST BE MAINTAINED DURING CONSTRUCTION.

ALL STRUCTURES SHALL BE BRICK SEWER STRUCTURES AS PER PLAN NO. S-A-104, EXCEPT AS NOTED.

USE STANDARD MANHOLE FRAMES AND COVERS AS PER PLAN NO. S-A-117, ALL STATIONING BASED ON SURVEY FOR THIS PROJECT.

RESURFACE TRENCH WITHIN PAVED AREA IN ACCORDANCE WITH RESURFACING SCHEDULE SHOWN AT LEFT.

USE FORMULA NO. 1 SEC. 54 OF SPECIFICATIONS TO COMPUTE ALLOWABLE LEAKAGE.

THE CONTRACTOR SHALL NOTIFY THE CONSTRUCTION DIVISION BY TELEPHONE MADISON 9-4747, EXT. 8151 AT LEAST 24 HOURS BEFORE STARTING ANY WORK UNDER THIS CONTRACT.

USE MECHANICAL COMPRESSION JOINTS FOR ALL VITRIFIED CLAY PIPE PER SECS. 36 & 48 OF STD. SPECS.

APPROVAL OF THIS PLAN BY THE COUNTY OF LOS ANGELES DOES NOT CONSTITUTE A REPRESENTATION AS TO THE ACCURACY OF THE LOCATION OF OR THE EXISTENCE OR NON-EXISTENCE OF ANY UNDERGROUND UTILITY PIPE OR STRUCTURE WITHIN THE LIMITS OF THE PROJECT.

LOS COUNTY STANDARD SEWER SPECIFICATIONS DATED MAY 25, 1962 APPLY TO THE CONSTRUCTION OF THIS PROJECT.

NO REVISIONS SHALL BE MADE TO THESE PLANS WITHOUT THE APPROVAL OF THE COUNTY ENGINEER.

NO CHARGE FOR CONNECTIONS

NO CONNECTIONS FOR THE DISPOSAL OF INDUSTRIAL WASTES SHALL BE MADE TO SEWERS SHOWN ON THESE DRAWINGS WITHOUT WRITTEN PERMISSION FROM THE CHIEF ENGINEER AND GENERAL MANAGER OF THE COUNTY SANITATION DISTRICTS.

WEST HOLLYWOOD RELIEF SEWER PRIVATE CONTRACT NO 6051

PROFILE, ALIGNMENT AND GRADE OF

SANITARY SEWERS

TO BE CONSTRUCTED IN

SUNSET BOULEVARD AND OTHER RIGHTS OF WAY

33091

PAGE 1 OF 7 PAGES

SCALE VERT. 1" = 8 FT. HORIZ. 1" = 40 FT.

AUGUST, 1962

COUNTY OF LOS ANGELES, CALIFORNIA

JOHN A. LAMBIE

COUNTY ENGINEER

RECOMMENDED [Signature] ASSISTANT SANITATION ENGINEER

APPROVED [Signature] SANITATION ENGINEER

JOHN D. PARKHURST CHIEF ENGINEER OF COUNTY SANITATION DISTRICT NO. 9

[Signature] OFFICE ENGINEER

FOR LEGEND SEE PLAN NO. S-A-44

NOTE: GRADES TO WHICH THIS IMPROVEMENT IS TO BE CONSTRUCTED ARE SHOWN ON PLANS AND PROFILES. GRADE POINTS FOR TOP OF CURB CENTER LINE OF STREET OR CENTER LINE OF ALLEY ARE SHOWN BY CIRCLES ON PROFILES AT ALL POINTS BETWEEN DESIGNATED POINTS THE GRADE SHALL BE ESTABLISHED SO AS TO CONFORM TO A STRAIGHT LINE DRAWN BETWEEN SAID DESIGNATED POINTS.

REFERENCES table with columns: W.S., A.B., F.B., DESIGNED, TRACED, CHECKED, L. JAIME, R. FAUST & L. JAIME, C. HIGGINSON, and dates.

23297 1 6 5 of 2 PAGES

WEST HOLLYWOOD

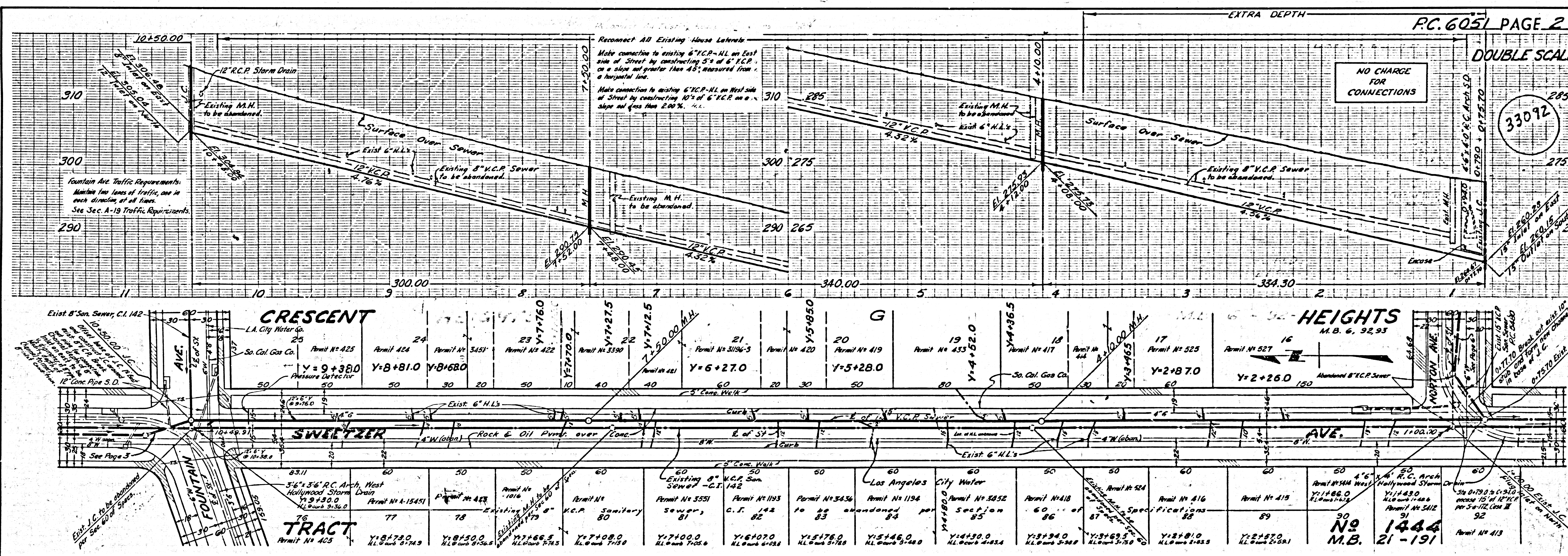

PLAN OF WEST HOLLYWOOD TRACT 2 of 3 PAGES

PLAN OF WEST HOLLYWOOD TRACT 2 of 3 PAGES

Trim Line F.B. 2712 Topo : 13, 20, 26-27 Sect : 60, 69-72 X Sect : 87-93

P.C. 6051 PAGE 3

DOUBLE SCALE

NO CHARGE FOR CONNECTIONS

33097

Fountain Ave. Traffic Requirements: Maximum Two lanes of traffic, one in each direction at all times. See Sec. 8-19 Traffic Requirements.

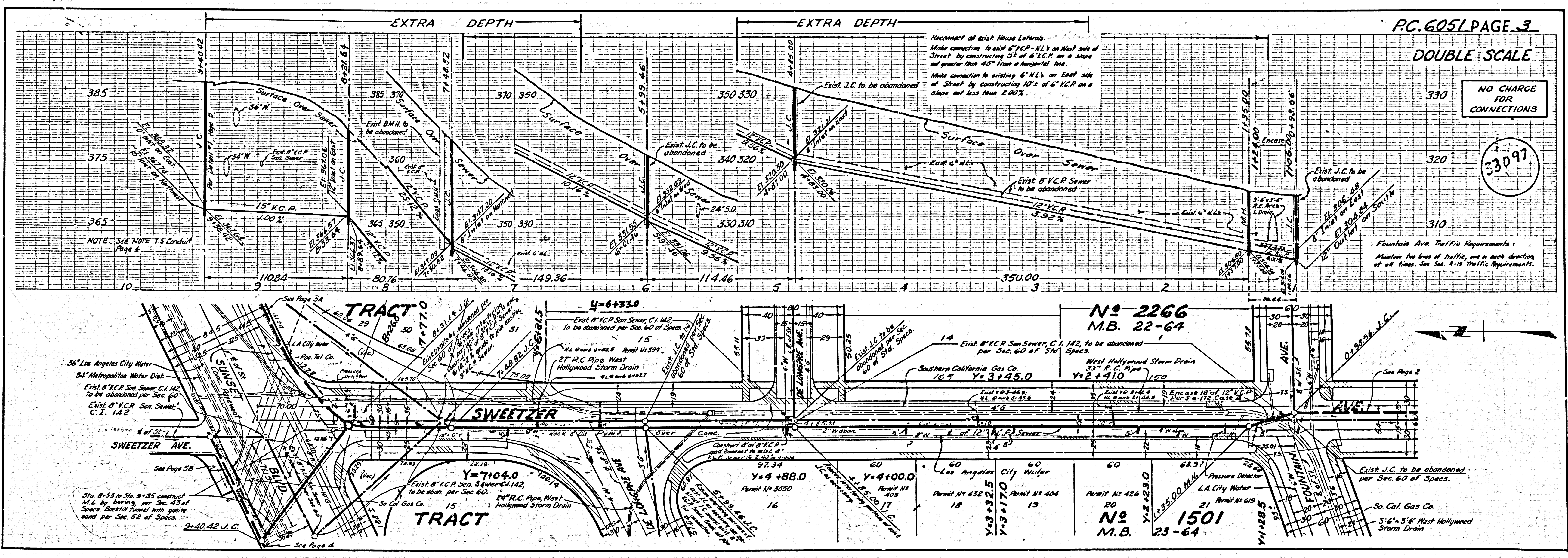

Trim Line

U.C. CHK'D 8-27-62 B.M.'S CHK'D 8-27-62 J.S.

23092 BLD. PC 6051 PAGE 4
WEST HOLLYWOOD

PAGES 4 & 5 of 7 PAGES

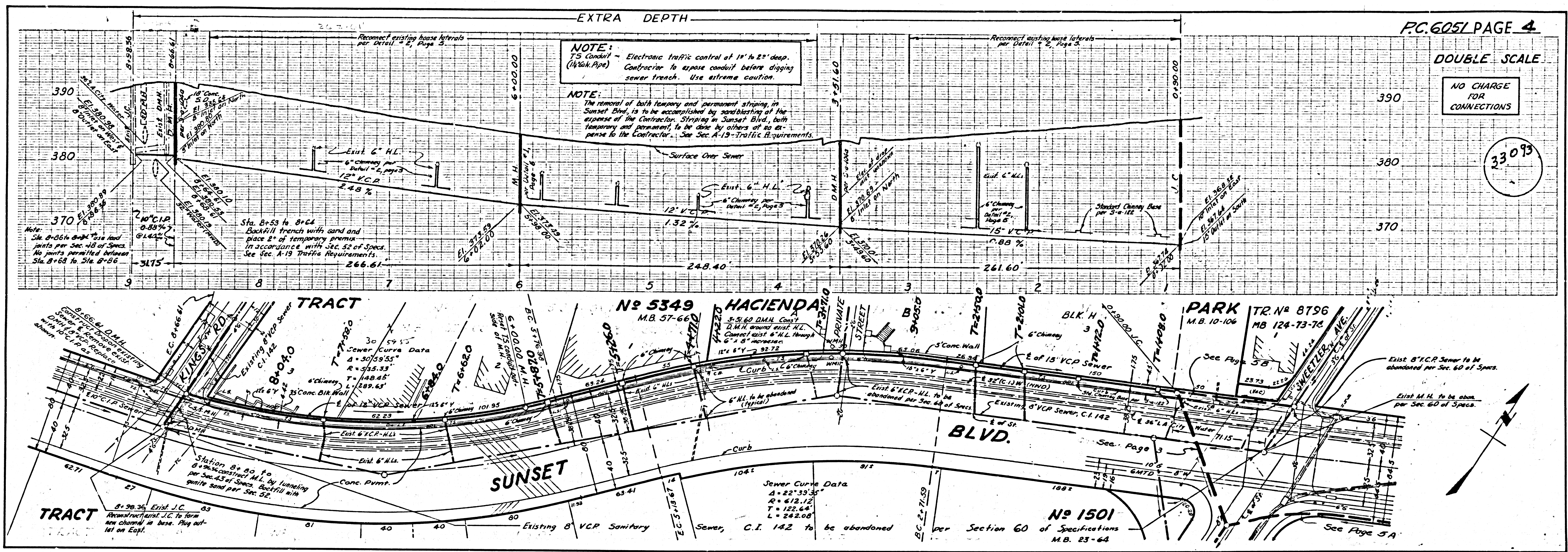

Trim Line

Trim Line

23092 BLD. PC 6051 PAGE 5
WEST HOLLYWOOD

PAGES 4 & 5 of 7 PAGES

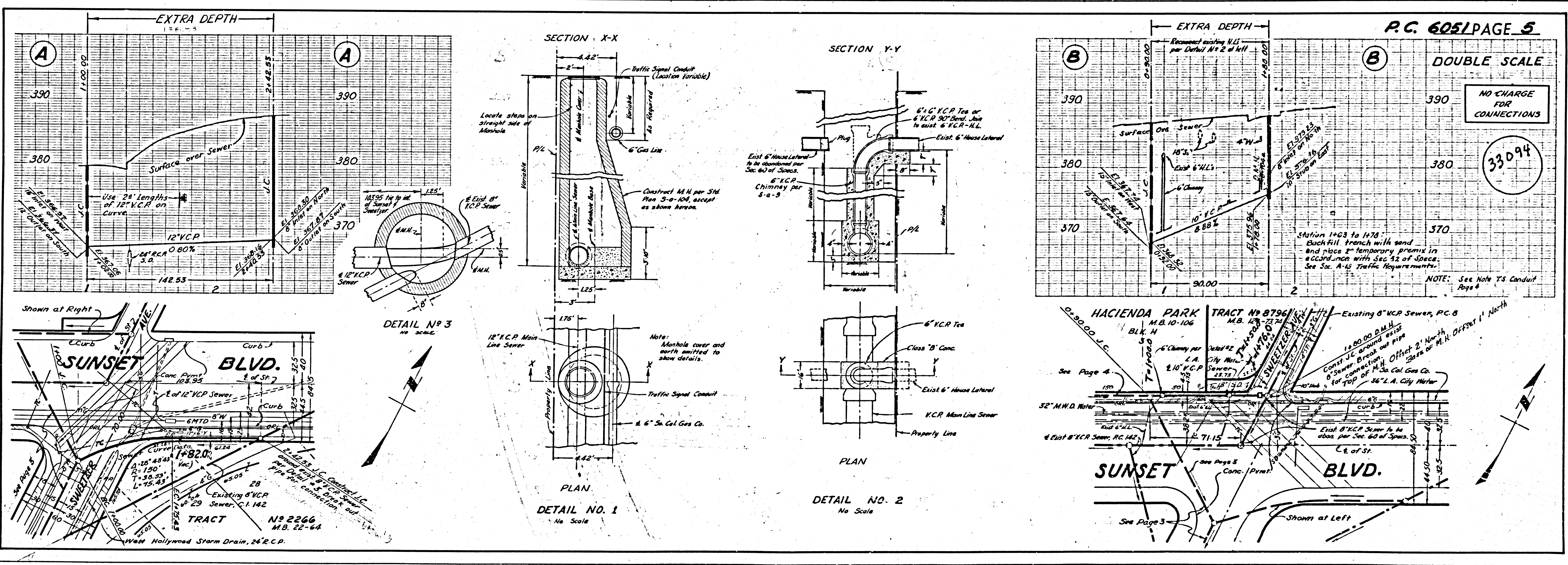

Trim Line

Trim Line

DOWN TOWN WEST HOLLYWOOD

DOWN TOWN WEST HOLLYWOOD

PAGE 6 & 7 OF 2 PAGES

DOWN TOWN WEST HOLLYWOOD

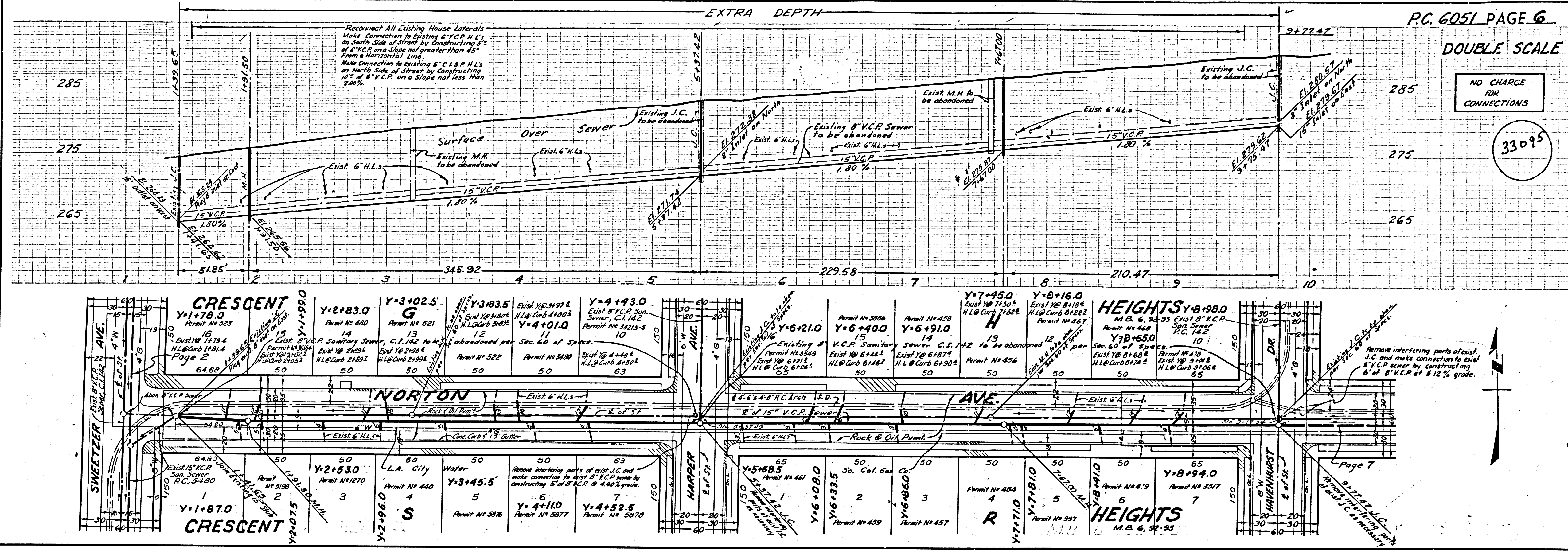

PC. 6051 PAGE 6
DOUBLE SCALE

NO CHARGE FOR CONNECTIONS

33095

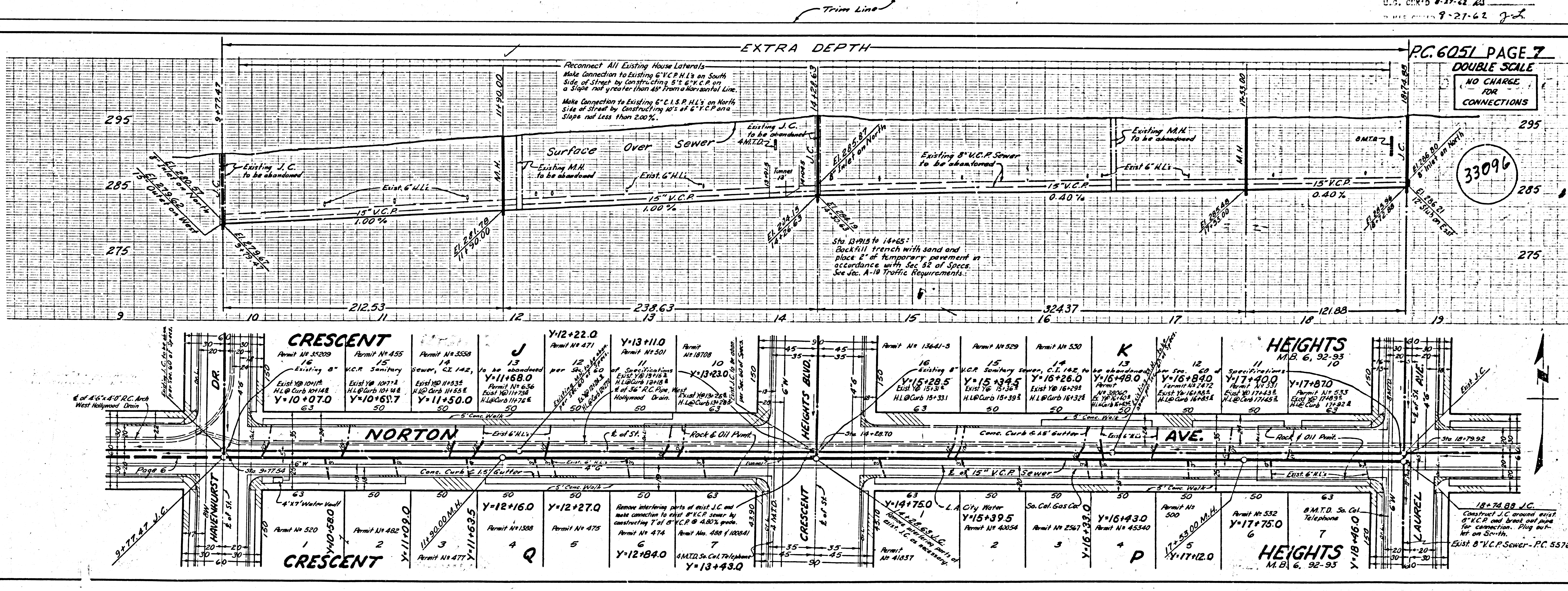

PC. 6051 PAGE 7
DOUBLE SCALE

NO CHARGE FOR CONNECTIONS

33096