

B.M. MW 85, Elev. 211.391, F.B. 2197-44
Santa Monica Blvd. & Palm Ave., N.E. cor.
Bl. Spk. in curb, E. end of N.E. CR

WEST HOLLYWOOD BUILDING DISTRICT NO. 9

WEST HOLLYWOOD RELIEF SEWERS PRIVATE CONTRACT NO. 6074

PROFILE, ALIGNMENT AND GRADE OF
SANITARY SEWERS
TO BE CONSTRUCTED BY
CYNTHIA STREET 39077
AND OTHER RIGHTS OF WAY

PAGE 1 OF 9 PAGES

SCALE VERT. 1" = 8 FT.
HORIZ. 1" = 8 FT.
JUNE, 1966
COUNTY OF LOS ANGELES, CALIFORNIA

JOHN A. LAMBIE COUNTY ENGINEER

APPROVED *Ronald E. Huber*
SANITATION ENGINEER

JOHN D. PARKHURST
CHIEF ENGINEER OF COUNTY
SANITATION DISTRICT NO. 6

SUBMITTED *Rudolph J. Huber*
REG. C.E. NO. 14330
OFFICE ENGINEER

FOR LEGEND
SEE PLAN NO. S-1

NOTE: GRADES TO WHICH THIS IMPROVEMENT IS TO BE CONSTRUCTED ARE SHOWN ON PLANS AND PROFILES. GRADE POINTS FOR TOP OF CURB, CENTER LINE OF STREET OR CENTER LINE OF ALLEY ARE SHOWN BY CIRCLES ON PROFILES. AT ALL POINTS BETWEEN DESIGNATED POINTS THE GRADE SHALL BE ESTABLISHED SO AS TO CONFORM TO A STRAIGHT LINE DRAWN BETWEEN SAID DESIGNATED POINTS.
SITUATIONS ARE IN FEET ABOVE U. S. C. & G. S. SEA LEVEL DATUM AS OF 1929.
UNIT PRICES FOR ADDITIONAL WORK WHICH MAY BE REQUIRED BUT WHICH CANNOT BE ASCERTAINED IN ADVANCE, SHALL BE SUBMITTED IN THE PROPOSAL.
THIS DRAWING AND THE DATA HEREON ARE HEREBY MADE A PART OF THE SPECIFICATIONS.

REFERENCES			
W.S. 22	DESIGNED	CHIN - OBRAD	JUNE, 1966
A. B.	TRACED	CHIN	JUNE, 1966
F.B. 2710, 2716	CHECKED	HOWARD	JUNE, 1966

FIGURE IN CIRCLES AT ENDS OF HOUSE LATERALS INDICATE DEPTH BELOW CURB GRADE, OR GRADE OF CENTER LINE OF STREET.

NOTE: THE CONTRACTOR SHALL USE CASE II BEDDING PER S-2 FOR SEWER PIPE IN PALM AVE. FROM STA. 5+50.00 TO HOLLOWAY DRIVE AND IN CYNTHIA STREET FROM PALM AVE. TO LARRABEE STREET.

USE EXTRA STRENGTH PIPE. ALL PIPE IS STANDARD DEPTH, EXCEPT AS NOTED
USE MECHANICAL COMPRESSION JOINTS FOR ALL VITRIFIED CLAY PIPE PER SEC. 36 & 48 OF SPECIFICATIONS, EXCEPT AS NOTED
ALL STRUCTURES SHALL BE BRICK SEWER STRUCTURES AS PER PLAN NO. S-3, EXCEPT AS NOTED.

USE STANDARD MANHOLE FRAMES AND COVERS AS PER PLAN NO. S-15.
ALL STATE AND LOCAL TRENCH SAFETY ORDERS WILL BE RIGIDLY ENFORCED.

HOUSE LATERALS MAY BE CONNECTED DURING CONSTRUCTION OF THE MAIN LINE SEWER.

USE FORMULA NO. 2-SEC-54 OF SPECIFICATIONS TO COMPUTE ALLOWABLE LEAKAGE.

THE CONTRACTOR SHALL NOTIFY THE CONSTRUCTION DIVISION BY TELEPHONE MADISON 9-4747, EXT. 21551 AT LEAST 24 HOURS BEFORE STARTING ANY WORK UNDER THIS CONTRACT.

APPROVAL OF THIS PLAN BY THE COUNTY OF LOS ANGELES DOES NOT CONSTITUTE A REPRESENTATION AS TO THE ACCURACY OF THE LOCATION OF OR THE EXISTENCE OR NON-EXISTENCE OF ANY UNDERGROUND UTILITY PIPE OR STRUCTURE WITHIN THE LIMITS OF THIS PROJECT.

LOS ANGELES COUNTY STANDARD SEWER SPECIFICATIONS DATED MAY 25, 1962, AS AMENDED, APPLY TO THE CONSTRUCTION OF THIS PROJECT.

NO REVISIONS SHALL BE MADE IN THESE PLANS WITHOUT THE APPROVAL OF THE COUNTY ENGINEER.

FLOW IN EXISTING HOUSE LATERALS AND MAIN LINE SEWERS SHALL BE MAINTAINED DURING CONSTRUCTION.
REPAIRING OF SEWER TRENCHES WITHIN PAVED AREA OF STREETS IN THIS DISTRICT SHALL BE AS FOLLOWS:

PAGE NO.	STREET	TYPE OF RESURFACING
273	PALM AVE.	FOUR INCHES A.C. PAVEMENT ON EIGHT INCHES AGGREGATE BASE, TYPE "A".
7	DOHERTY DR.	FOUR INCHES A.C. PAVEMENT ON FOURTEEN INCHES AGGREGATE BASE, TYPE "A".
8	PHYLIS ST.	FOUR INCHES A.C. PAVEMENT.
4	SUNSET BLVD & HOLLOWAY DR.	TUNNEL CONSTRUCTION AND 9" OF R.C.C. PAVEMENT.
4	HORN AVE.	FOUR INCHES A.C. PAVEMENT.
576	CYNTHIA ST.	FOUR INCHES A.C. PAVEMENT. PAGE 5A: 4 INCHES A.C. PAVEMENT ON FOUR INCHES AGGREGATE BASE, TYPE "A".

NO CONNECTIONS FOR THE PURPOSE OF INDUSTRIAL WASTES SHALL BE MADE TO SEWERS SHOWN ON THESE DRAWINGS WITHOUT WRITTEN PERMISSION FROM THE CHIEF ENGINEER AND GENERAL MANAGER OF THE COUNTY SANITATION DISTRICTS.

BEFORE BREAKING INTO ANY EXISTING STRUCTURE AND BEFORE FINAL ACCEPTANCE OF THIS WORK, COUNTY SANITATION DISTRICT (DU 4-1281) SHALL BE NOTIFIED IN ORDER THAT REQUIRED INSPECTION CAN BE MADE.

NO CHARGE FOR CONNECTIONS
Thomas C. Howard

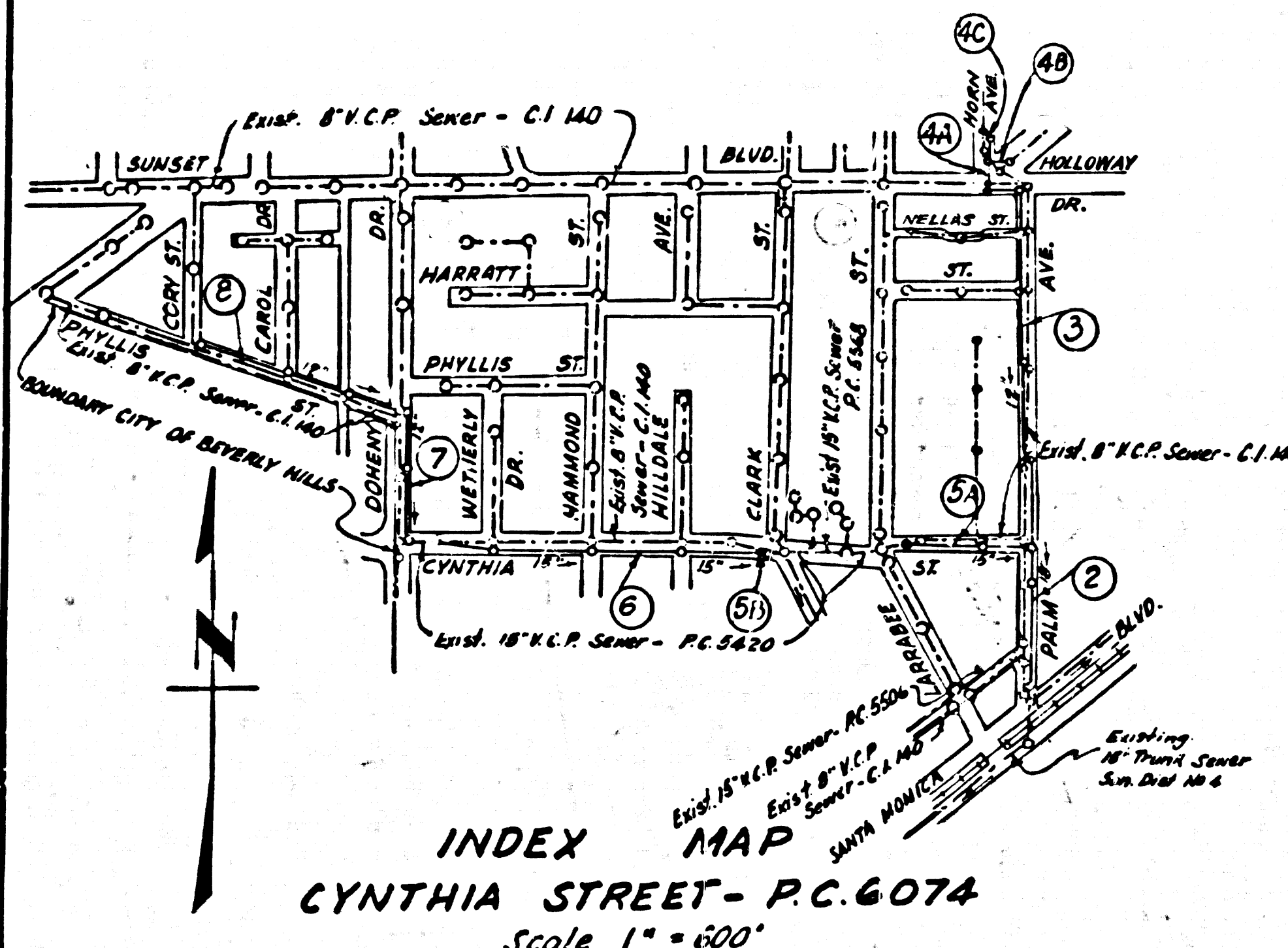

INDEX MAP
CYNTHIA STREET - P.C. 6074
Scale 1" = 600'

U.S. GOVERNMENT PRINTING OFFICE: 1966
7-18-66 J.J. Lonigan

PC 6074 PAGE 2
DOUBLE SCALE
NO CHARGE FOR CONNECTIONS
39078

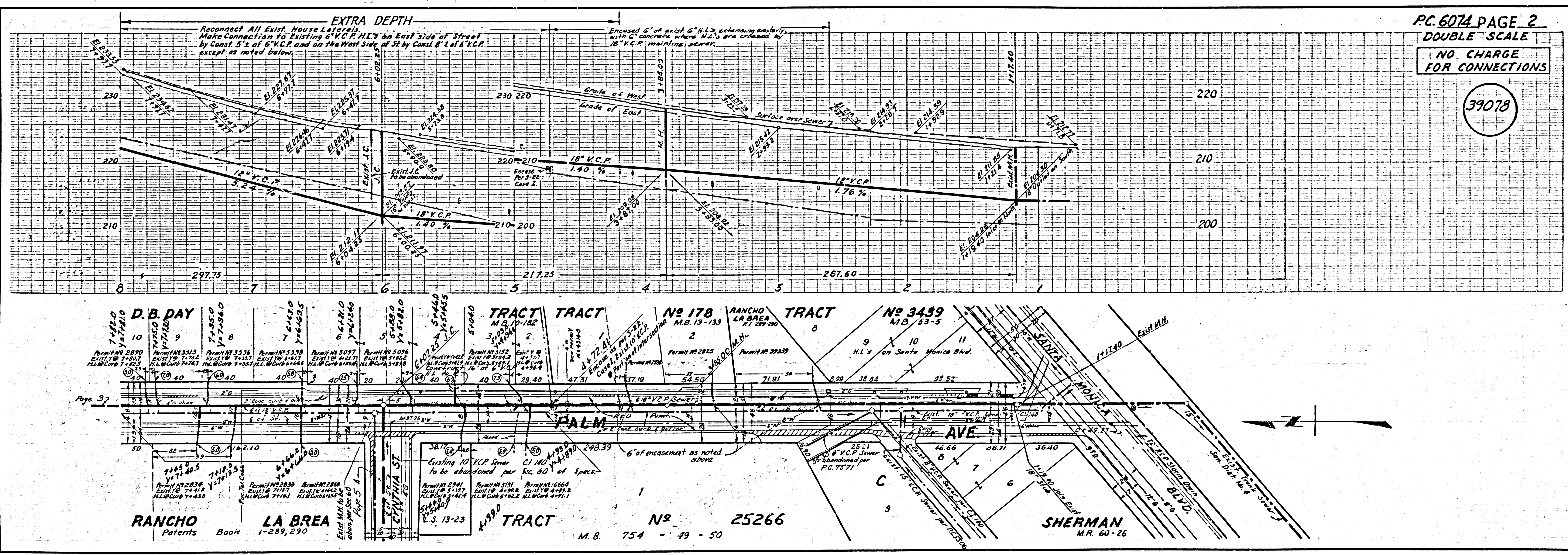

D.B. DAY

RANCHO LA BREA Patents Book 1-289,290

TRACT NO 178 M.B. 13-133

TRACT NO 25266 M.B. 754 - 49 - 50

TRACT NO 3459 M.B. 53-3

SHERMAN M.R. 60-26

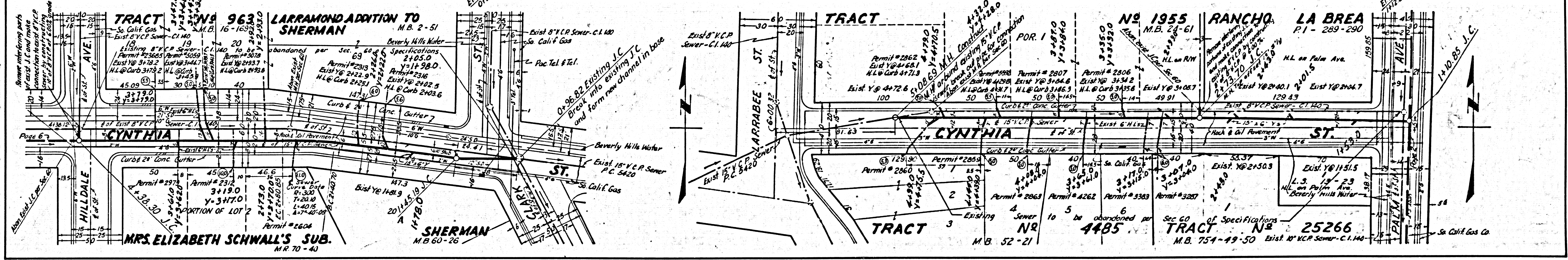
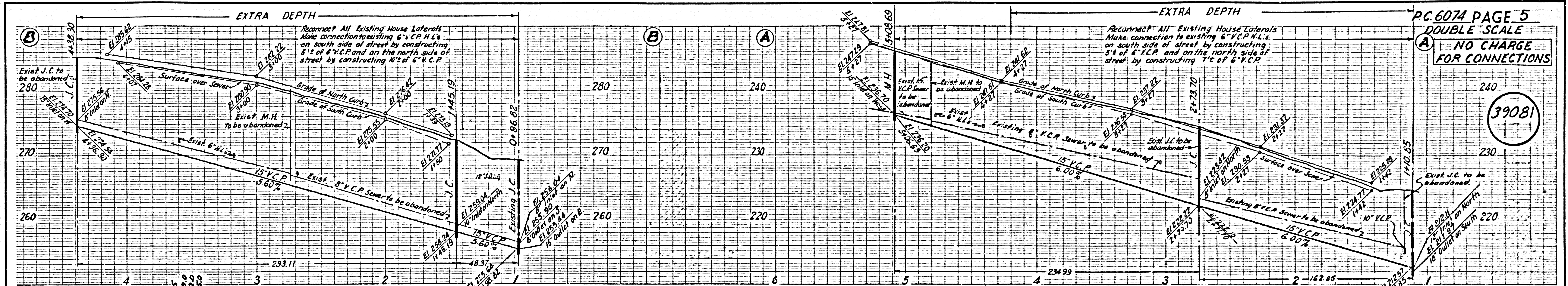

HEATHWOOD RELIEF SEWERS

PC 6074 PAGE 5
DOUBLE SCALE
NO CHARGE FOR CONNECTIONS

PC 6074 PAGE 6
DOUBLE SCALE
NO CHARGE FOR CONNECTIONS

39081

39082

4 F.B. 2710, 33-39-40
7000 F.B. 2716, 38-38
K-SEC. F.B. 2716, 41-50

4 F.B. 2710, 33-39-40
7000 F.B. 2716, 38-38
1-1/2 SEC. F.B. 2716, 41-50

ME 100 IMPERIAL CE 897

4 F.B. 2710, 40-42
7000 F.B. 2716, 38-40
1-1/2 SEC. F.B. 2716, 50-52

WEST HOTTAMOOD RETIEF SEWERS

DOUBLE SCALE
NO CHARGE FOR CONNECTIONS

39083

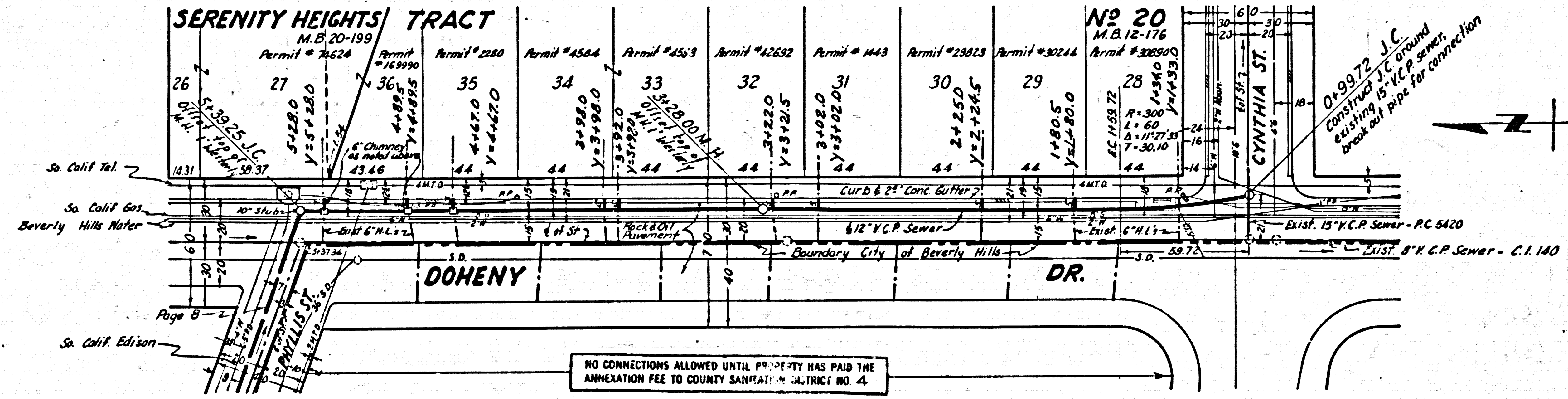
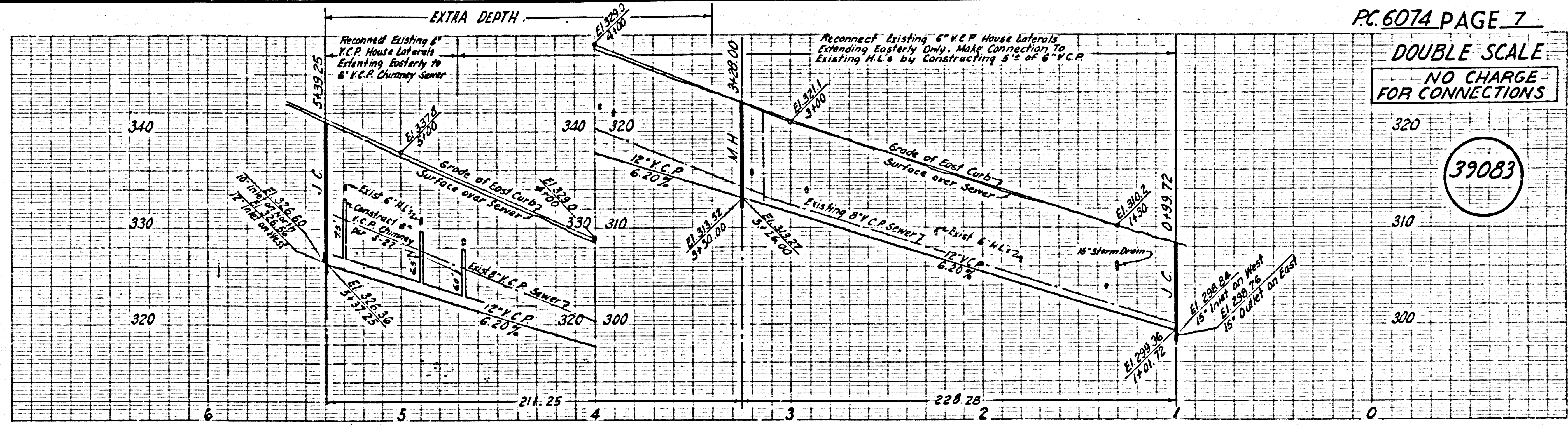

NO CONNECTIONS ALLOWED UNTIL PROPERTY HAS PAID THE ANNEXATION FEE TO COUNTY SANITATION DISTRICT NO. 4

Trim Line 7

DOUBLE SCALE
NO CHARGE FOR CONNECTIONS

39084

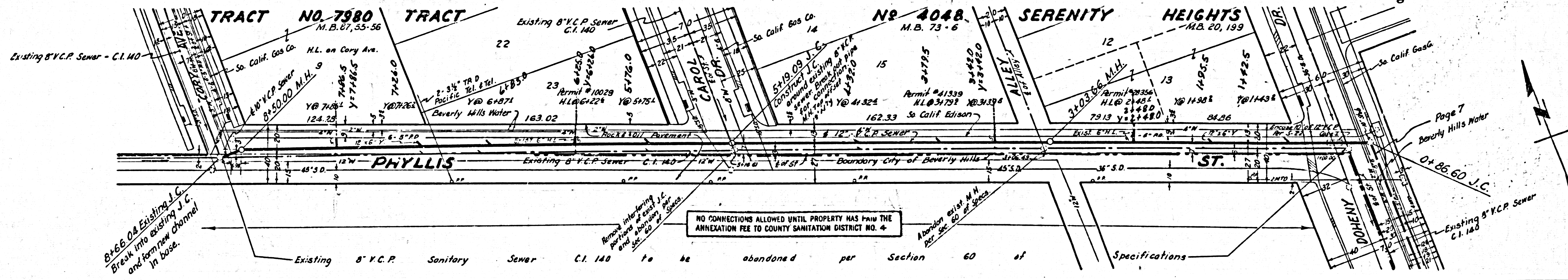
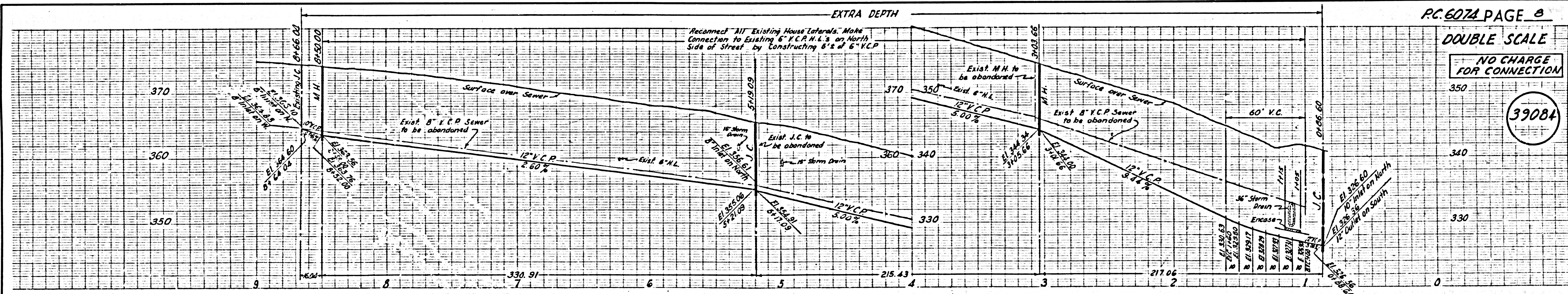

NO CONNECTIONS ALLOWED UNTIL PROPERTY HAS PAID THE ANNEXATION FEE TO COUNTY SANITATION DISTRICT NO. 4

8 1/2\"/>

Trim Line

WEST HOTTAMOOD RETIEF SEWERS

DOUBLE SCALE
NO CHARGE
FOR CONNECTIONS

39085

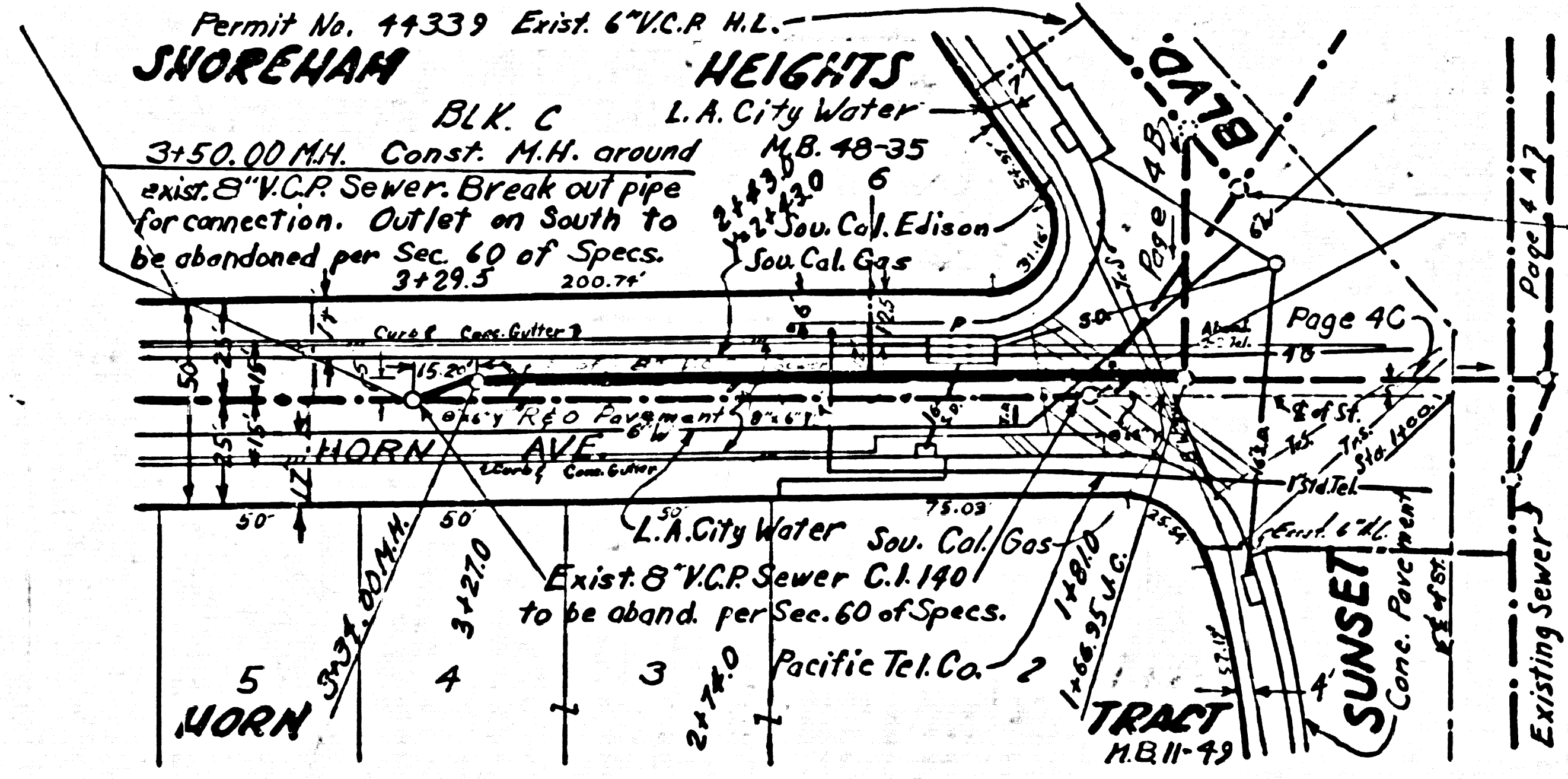
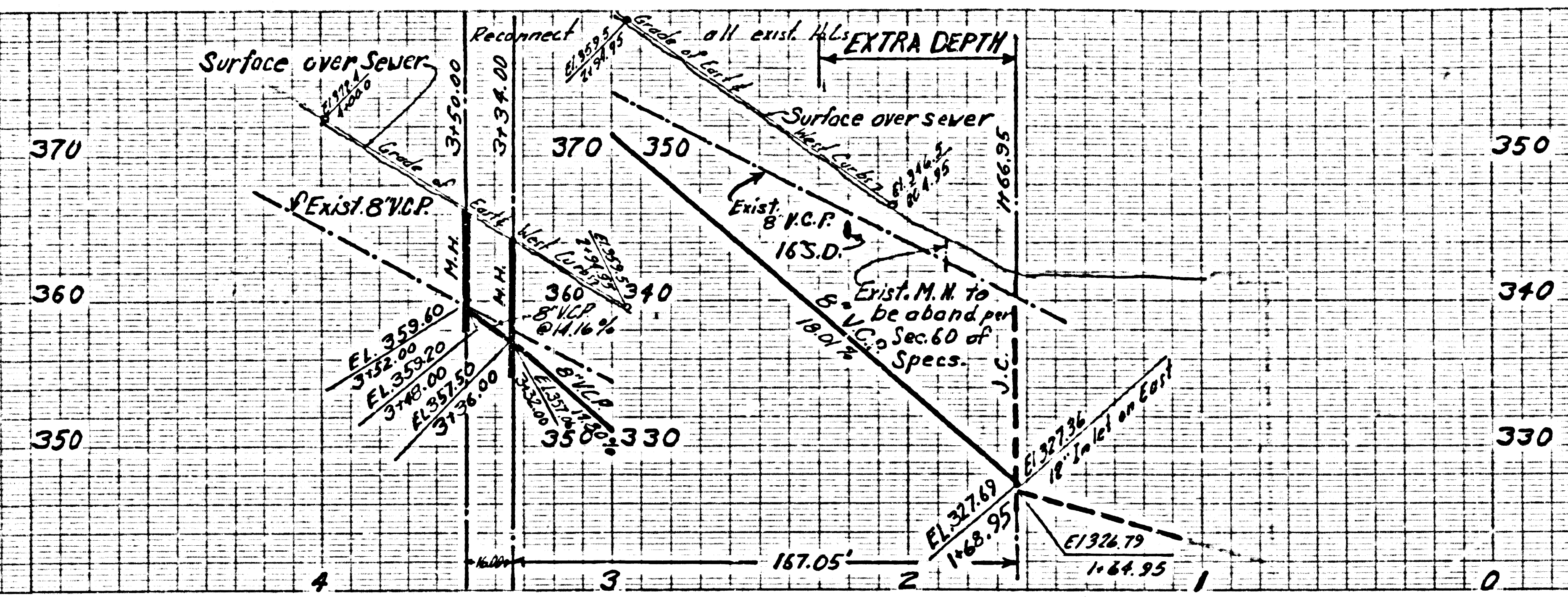

Exist. M.M.s to be
aband. per Sec. 60
of Specs.

CHANGE OF PLAN
 Extension of sewer in Horn Ave. from
 Sta. 1+64.95 to 3+50.00 (See Page 4C)
 Approved: *[Signature]*
 DIVISION ENGINEER
 Submitted: *[Signature]* 11-7-66
 REG. C.E. NO. 14390

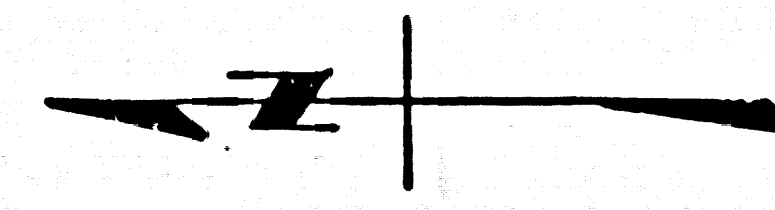

Trim line

PAGE