

PUENTE BLDG. DIST. NO. 2

PROFILE ALIGNMENT AND GRADE OF  
**SANITARY SEWERS** PAGE 1  
 TO BE CONSTRUCTED IN J.N.035749

R/W SOUTH OF  
**GLENSTONE AVENUE**  
 PRIVATE CONTRACT NO. 6121

W.S. 38  
 1 SHEET ; 2 PAGES

SCALE: VERT. 1" = 4'  
 HORIZ. 1" = 40'  
 JANUARY, 1962  
 PREPARED IN THE OFFICES OF  
 LEONARD H. GOWDY, INC.

31963

By: *Leonard H. Gowdy*  
 REG. C. E. NO. 4823  
 FOR LEGEND SEE PLAN NO. S-A-64

- NOTES:
1. PROVIDE STAKES ON THE PROPERTY LINE OR PROPERTY LINES PRODUCED AT RIGHT ANGLES TO THE SEWER LINE AT THE CENTER LINE OF EACH MANHOLE.
  2. NO REPRESENTATIVE OF THE COUNTY ENGINEER WILL SURVEY OR LAY OUT ANY PORTION OF THE WORK.
  3. THE OWNER OR HIS AUTHORIZED REPRESENTATIVE SHALL FURNISH THE COUNTY ENGINEER WITH GRADE SHEETS AND STATIONING FOR ALL HOUSE LATERALS AND Y BRANCHES AND SHALL PROVIDE STAKES FOR THEM AT THEIR PROPER LOCATIONS WITH STATIONING PLAINLY MARKED. ANY CHANGE IN LOCATION SHALL BE REQUESTED IN WRITING BY THE OWNER OR HIS REPRESENTATIVE.
  4. NO REVISIONS SHALL BE MADE IN THESE PLANS WITHOUT THE APPROVAL OF THE COUNTY ENGINEER.
  5. USE STANDARD MANHOLE FRAMES AND COVERS, S-117.
  6. USE EXTRA STRENGTH PIPE. ALL PIPE 16 STANDARD DEPTH.
  7. USE "WEDGE-LOCK" OR "SPED-SEAL" FOR ALL V.C.P. JOINTS PER SPEC'S. SEC. 10.
  8. RESURFACE ALL TRENCH WITHIN PAVED AREA TO MEET L.A. COUNTY ROAD DEPT. OR CALIF. STATE HIGHWAY REQUIREMENTS IN ACCORDANCE WITH PERMITS.
  9. ENCASE FOUR FEET OF SEWER AT POINTS OF INTERFERENCE WITH POLES CASE III, S-172.
  10. STANDARD SPECIFICATIONS DATED OCTOBER 25, 1961 APPLY TO THE CONSTRUCTION OF THIS PROJECT.
  11. MANHOLE SHALL BE BRICK SEWER STRUCTURE, S-104.
  12. FOR ALLOWABLE LEAKAGE TEST USE FORMULA NO. 2, SPEC'S. SEC. 14.
  13. MANHOLE TOP IN RIGHT-OF-WAY TO BE LEVEL WITH FINISHED GRADE.
  14. THE CONTRACTOR SHALL NOTIFY THE CONSTRUCTION DIVISION BY TELEPHONE, MADISON 9-4147, EXT. 1551 AT LEAST TWENTY-FOUR HOURS BEFORE STARTING ANY WORK UNDER THIS CONTRACT.

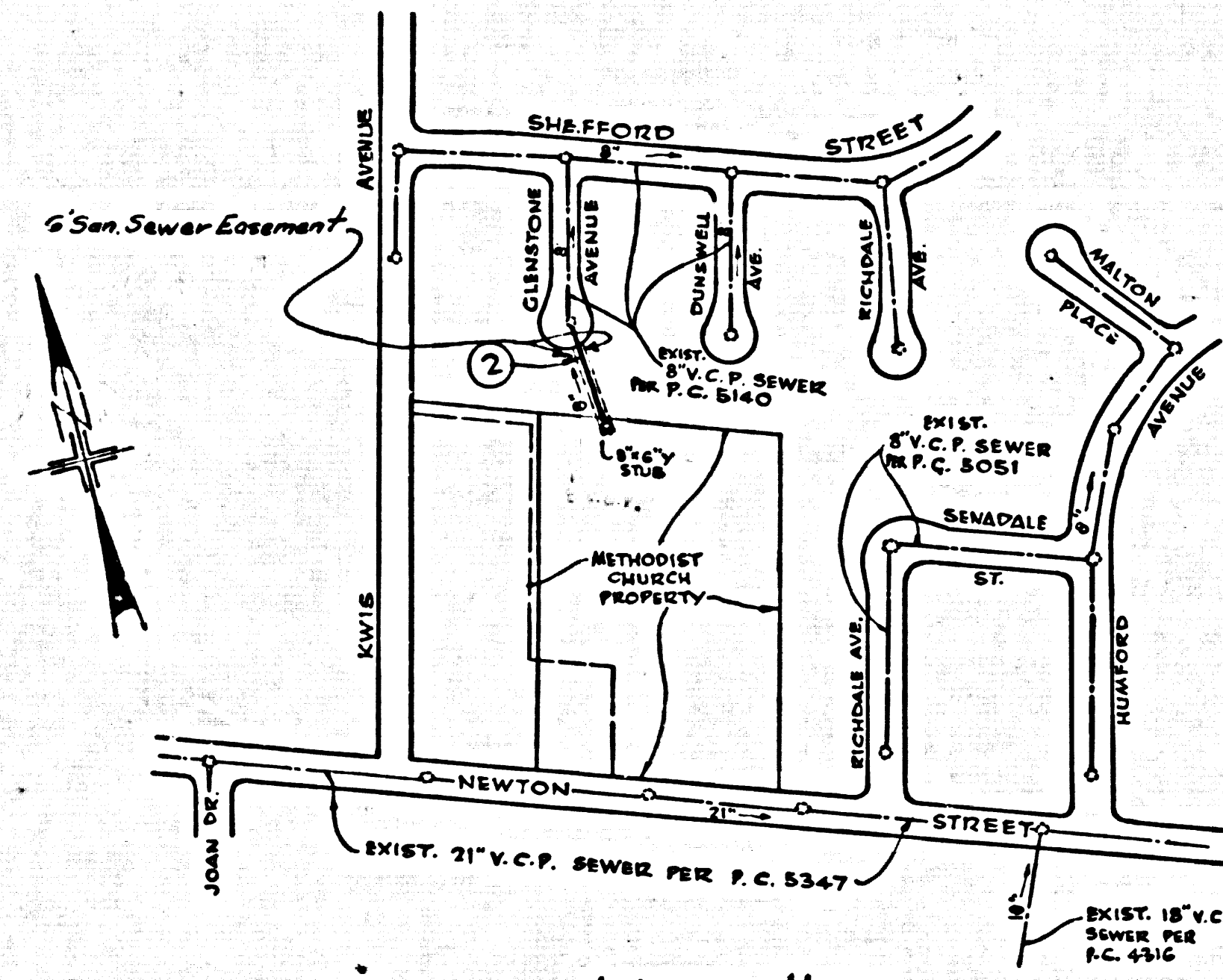

INDEX MAP  
 SCALE: 1" = 300'  
 - PC. 6121 -

BENCH MARK: SG 1619 - LBN - S. CURB NEWTON ST.  
 19' 2" W. OF ENTRANCE TO PLAY YARD - 98' W. OF  
 KWIS AVE ± 20' SOUTH OF E. OF NEWTON ST. ELEV. 420.294  
 WHITTIER QUAD. 1955.

NO CHARGE FOR  
 CONNECTIONS  
*Ernest W. Kenny 5-17-62*

NO CONNECTIONS FOR THE DISPOSAL OF  
 INDUSTRIAL WASTES SHALL BE MADE TO  
 SEWERS SHOWN ON THESE DRAWINGS  
 WITHOUT WRITTEN PERMISSION FROM THE  
 CHIEF ENGINEER AND GENERAL MANAGER  
 OF THE COUNTY SANITATION DISTRICTS.

NOTE:  
 GRADES TO WHICH THIS IMPROVEMENT IS TO BE CONSTRUCTED ARE SHOWN ON PLANS AND PROFILES. GRADE POINTS FOR TOP OF CURBS, CENTER LINE OF STREETS, OR CENTER LINE OF ALLEYS ARE SHOWN BY CIRCLES ON PROFILES AT ALL POINTS BETWEEN DESIGNATED POINTS THE GRADE SHALL BE ESTABLISHED SO AS TO CONFORM TO A STRAIGHT LINE DRAWN BETWEEN SAID DESIGNATED POINTS. ELEVATIONS ARE IN FEET ABOVE U.S.C. & G.S. SEA LEVEL DATUM OF 1929. THIS DRAWING AND THE DATA HEREON ARE HEREBY MADE A PART OF THE SPECIFICATIONS. WORK SHALL BE CONSTRUCTED ACCORDING TO SPECIFICATIONS ON FILE IN THE OFFICE OF THE COUNTY ENGINEER AND SHALL BE PROSECUTED ONLY IN THE PRESENCE OF THE COUNTY ENGINEER. BEFORE WORK CAN BE STARTED, THE CONTRACTOR MUST OBTAIN A PERMIT TO EXCAVATE IN COUNTY STREETS FROM THE L.A. COUNTY ROAD DEPT., DISTRICT OFFICE NO. 1, AND PAY A FEE TO THE COUNTY ENGINEER ROOM 310 CO. ENGINEER'S BLDG., 706 W. SECOND ST. SUFFICIENT TO COVER THE COST OF CONSTRUCTION INSPECTION AND RECORD PLANS. APPROVAL OF THIS PLAN BY THE COUNTY OF LOS ANGELES DOES NOT CONSTITUTE A REPRESENTATION AS TO THE ACCURACY OF THE LOCATION OF OR THE EXISTENCE OR NON-EXISTENCE OF ANY UNDERGROUND UTILITY PIPE, OR STRUCTURE WITHIN THE LIMITS OF THIS PROJECT. THIS NOTE APPLIES TO ALL PAGES. IF WORK IS TO BE DONE IN A STATE HIGHWAY, A PERMIT MUST BE OBTAINED FROM THE STATE OF CALIFORNIA, DIVISION OF HIGHWAYS, 120 SOUTH SPRING STREET.

COUNTY OF LOS ANGELES, CALIFORNIA

APPROVED, JOHN A. LAMBIE, COUNTY ENGINEER APPROVED, J.D. PARKHURST, CHIEF ENGINEER  
 CO. SAN. DIST. NO. 21  
 BY: *John A. Lambie* ASSISTANT SANITATION ENGINEER BY: *J.D. Parkhurst* OFFICE ENGINEER  
 CHECKED BY: *Bill Under* 5-18-62  
 OFFICE OF COUNTY ENGINEER, REG. C. E. NO. 9406  
 SUBMITTED: *W.C. Reinhardt* SAN. DIST. REGIONAL ENGINEER

P.C. 6121 PAGE 2

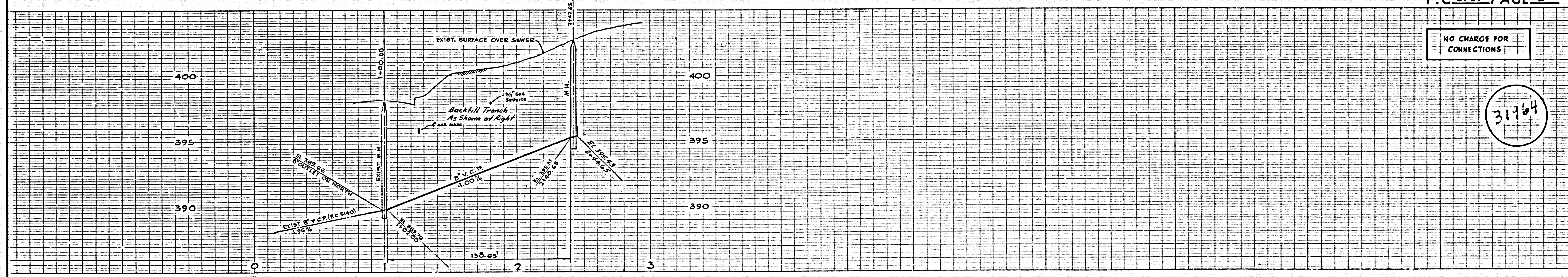

NO CHARGE FOR  
 CONNECTIONS

31964

