

**ORLANDO ROAD**  
**PRIVATE CONTRACT NO. 6130**

W.S. 44  
 2 SHEETS; 4 PAGES  
 SCALE: VERT. 1"=4' APRIL, 1962  
 HORIZ. 1"=40'  
 PREPARED IN THE OFFICES OF  
**BARNETT, HOPEN, SMITH & SALIT**  
 BY: Harold A. Barnett  
 REG. C. E. NO. 1216  
 FOR LEGEND SEE PLAN NO. S-A-64

32335

BENCH MARK  
 S.G.-1701 ELEV. 585.375  
 C.S. BRASS CAP MONUMENT IN WELL 6" DEEP  
 6' S. NORTH OF CENTER LINE OF NORTH DR. OF  
 HUNTINGTON DRIVE AND CENTER LINE OF LA  
 PRESA DRIVE. Arcadia 1955

- NOTES:
1. PROVIDE STAKES ON THE PROPERTY LINE OR PROPERTY LINES PRODUCED AT RIGHT ANGLES TO THE SEWER LINE AT THE CENTER LINE OF EACH MANHOLE.
  2. NO REPRESENTATIVE OF THE COUNTY ENGINEER WILL SURVEY OR LAY OUT ANY PORTION OF THE WORK.
  3. THE OWNER OR HIS AUTHORIZED REPRESENTATIVE SHALL FURNISH THE COUNTY ENGINEER WITH GRADE SHEETS AND STATIONING FOR ALL HOUSE LATERALS AND Y BRANCHES AND SHALL PROVIDE STAKES FOR THEM AT THEIR PROPER LOCATIONS WITH STATIONING PLAINLY MARKED. ANY CHANGE IN LOCATION SHALL BE REQUESTED IN WRITING BY THE OWNER OR HIS REPRESENTATIVE.
  4. THE PRIVATE ENGINEER SHALL FURNISH THE HOUSE LATERAL DEPTH AT THE PROPERTY LINE BELOW THE TOP OF CURB ELEVATION FOR EACH HOUSE LATERAL ON THE GRADE SHEET.
  5. NO REVISIONS SHALL BE MADE IN THESE PLANS WITHOUT THE APPROVAL OF THE COUNTY ENGINEER.
  6. USE STANDARD MANHOLE FRAMES AND COVERS, S-117, EXCEPT AS NOTED.
  7. USE EXTRA STRENGTH PIPE. ALL PIPE STANDARD DEPTH. EXCEPT AS NOTED.
  8. USE CEMENT MORTAR OR "WEDGE-LOCK" OR "SPEED-SEAL" FOR ALL Y.C.P. JOINTS PER SPECS, SECS. 34 & 4.
  9. RESURFACE ALL TRENCH WITHIN PAVED AREA TO MEET L.A. COUNTY ROAD DEPT. OR CALIF. STATE HIGHWAY REQUIREMENTS IN ACCORDANCE WITH PERMITS.
  10. ENCASE FOUR FEET OF SEWER AT POINTS OF INTERFERENCE WITH POLES, CASE III, S-117.
  11. HOUSE LATERALS TO BE CONSTRUCTED WITH INVERTS AT PROPERTY LINE 6" FEET BELOW CURB GRADE EXCEPT AS NOTED.
  12. MANHOLES SHALL BE BRICK SEWER STRUCTURES PER S-117-109. PRECAST CONCRETE MANHOLES PER S-117-123 OR S-117-173 MAY BE USED AS AN ALTERNATE IN LOCATIONS APPROVED BY THE COUNTY ENGINEER.
  13. FOR ALLOWABLE LEAKAGE TEST USE FORMULA NO. 1, SPEC. SEC. 34.
  14. MANHOLE TOPS IN UNIMPROVED RIGHTS-OF-WAY TO BE SIX INCHES ABOVE FINISHED GRADE.
  15. THE CONTRACTOR SHALL NOTIFY THE CONSTRUCTION DIVISION BY TELEPHONE, MADISON 5-4141, EXT. 81551 AT LEAST TWENTY-FOUR HOURS BEFORE STARTING ANY WORK UNDER THIS CONTRACT.
  16. STANDARD SPECIFICATIONS DATED OCT. 25, 1961 APPLY IN THE CONSTRUCTION OF THIS PROJECT.
  17. FIGURES IN CIRCLES AT ENDS OF HOUSE LATERALS INDICATE HOUSE LATERAL SHALL BE CONSTRUCTED WITH 1/4" RISE PER FOOT TO PROPERTY LINE.
  18. FIGURES IN CIRCLES AT ENDS OF HOUSE LATERALS INDICATE DEPTH BELOW CURB GRADE, OR GRADE OF CENTER LINE OF STREET.

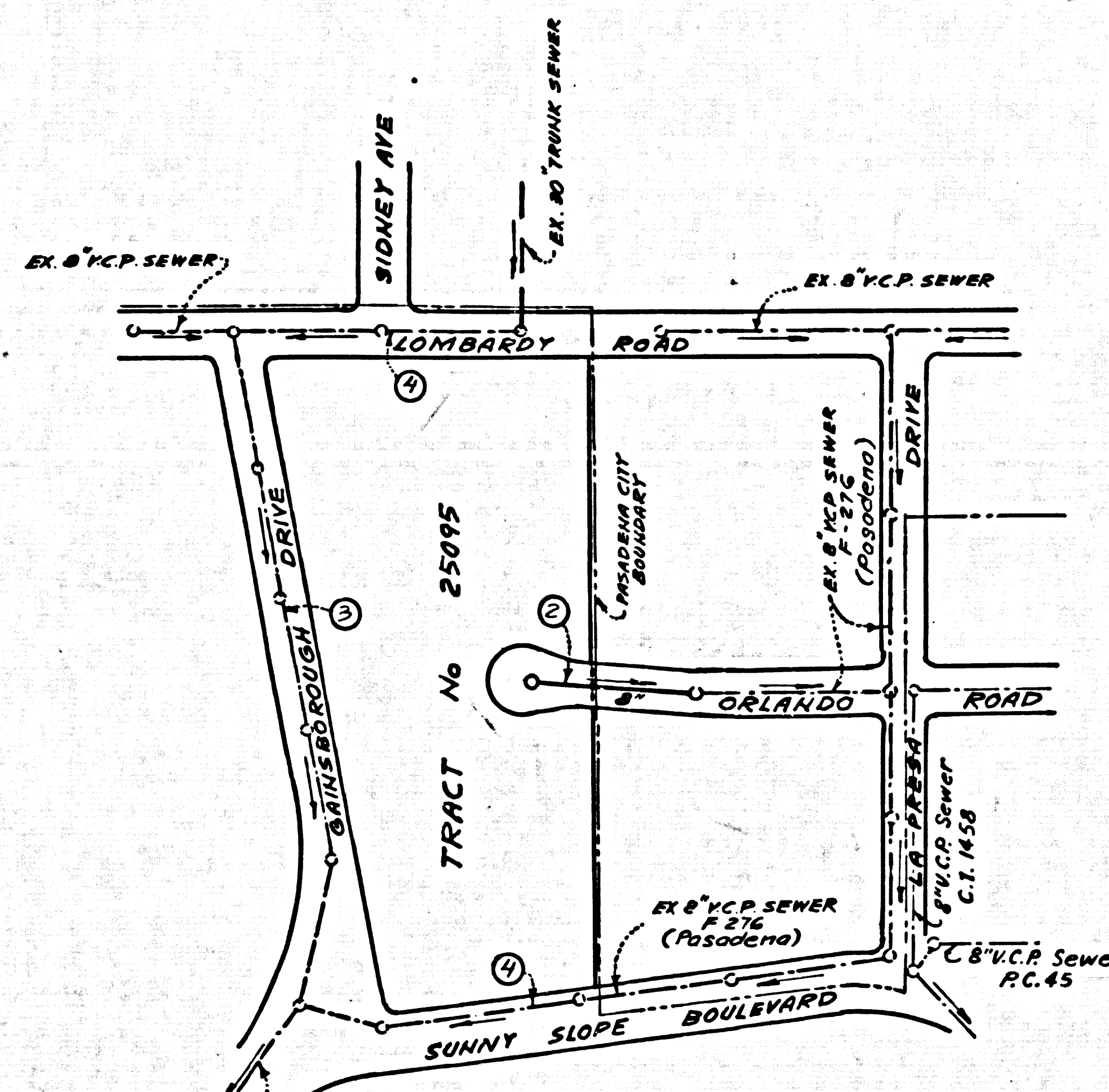

① Indicates page numbers  
**INDEX MAP**  
**TRACT No 25095**  
**P.C. 6130**  
 SCALE: 1"=200'

**NO CHARGE FOR CONNECTIONS**  
W. G. Lane 5/8/62

APPROVED, NO CHARGE APPROVED,  
 BY Harold A. Barnett SANITARY ENGINEER CITY OF PASADENA  
 DATE: 6-9-62  
 BY John A. Lambie CITY ENGINEER & SUPT. OF STREETS CITY OF PASADENA  
 DATE: 6-7-62  
 Prior to connecting H.L. to existing Sewer on Lombardy Rd. & Gainsborough Dr., Contractor shall call County Sanitation District (CSD 35825) for inspection. Conditions of H.L. to EX. 8" 30" Sewer shall be core drilled per C.S.D. Std. Disp. 5-2-66

NOTE:  
 GRADES TO WHICH THIS IMPROVEMENT IS TO BE CONSTRUCTED ARE SHOWN ON PLANS AND PROFILES. GRADE POINTS FOR TOP OF CURBS, CENTER LINE OF STREETS, OR CENTER LINE OF ALLEYS ARE SHOWN BY CIRCLES ON PROFILES. AT ALL POINTS BETWEEN DESIGNATED POINTS THE GRADE SHALL BE ESTABLISHED SO AS TO CONFORM TO A STRAIGHT LINE DRAWN BETWEEN SAID DESIGNATED POINTS.  
 ELEVATIONS ARE IN FEET ABOVE U.S.C. & G.S. SEA LEVEL DATUM OF 1929.  
 THIS DRAWING AND THE DATA HEREON ARE HEREBY MADE A PART OF THE SPECIFICATIONS.  
 WORK SHALL BE CONSTRUCTED ACCORDING TO SPECIFICATIONS ON FILE IN THE OFFICE OF THE COUNTY ENGINEER AND SHALL BE PROSECUTED ONLY IN THE PRESENCE OF THE COUNTY ENGINEER.  
 BEFORE WORK CAN BE STARTED, THE CONTRACTOR MUST OBTAIN A PERMIT TO EXCAVATE IN COUNTY STREETS FROM THE L. A. COUNTY ROAD DEPT., DISTRICT OFFICE NO. 2, AND PAY A FEE TO THE COUNTY ENGINEER, ROOM 310 L. A. CO. BLDG., 808 N. 2ND ST. SUFFICIENT TO COVER THE COST OF CONSTRUCTION INSPECTION AND RECORD PLANS.  
 APPROVAL OF THIS PLAN BY THE COUNTY OF LOS ANGELES DOES NOT CONSTITUTE A REPRESENTATION AS TO THE ACCURACY OF THE LOCATION OF OR THE EXISTENCE OR NON-EXISTENCE OF ANY UNDERGROUND UTILITY PIPE, OR STRUCTURE WITHIN THE LIMITS OF THIS PROJECT. THIS NOTE APPLIES TO ALL PAGES.  
 IF WORK IS TO BE DONE IN A STATE HIGHWAY, A PERMIT MUST BE OBTAINED FROM THE STATE OF CALIFORNIA, DIVISION OF HIGHWAYS, 120 SOUTH SPRING STREET.  
**COUNTY OF LOS ANGELES, CALIFORNIA**  
 APPROVED, JOHN A. LAMBIE, COUNTY ENGINEER APPROVED, J. D. PARKHURST, CHIEF ENGINEER  
 CO. SAN. DIST. NO. 15  
 BY Harold A. Barnett ASST. SANITATION ENGINEER BY John A. Lambie OFFICE ENGINEER  
 CHECKED BY W. G. Lane OFFICE ENGINEER  
 OFFICE OF COUNTY ENGINEER, REG. C. E. NO. 2946  
 SUBMITTED BY K. R. Brown SAN GABRIEL VALLEY REGIONAL ENGINEER

**NO CHARGE FOR CONNECTIONS**

32336

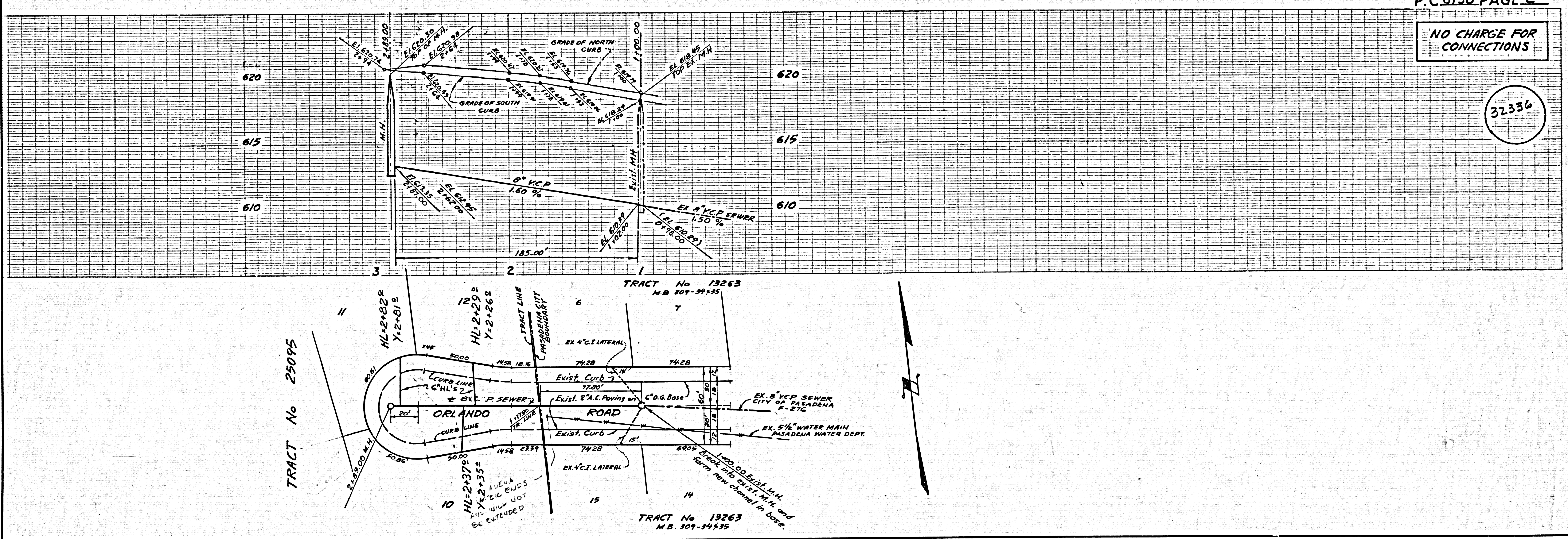



NO CHARGE FOR CONNECTIONS

32337

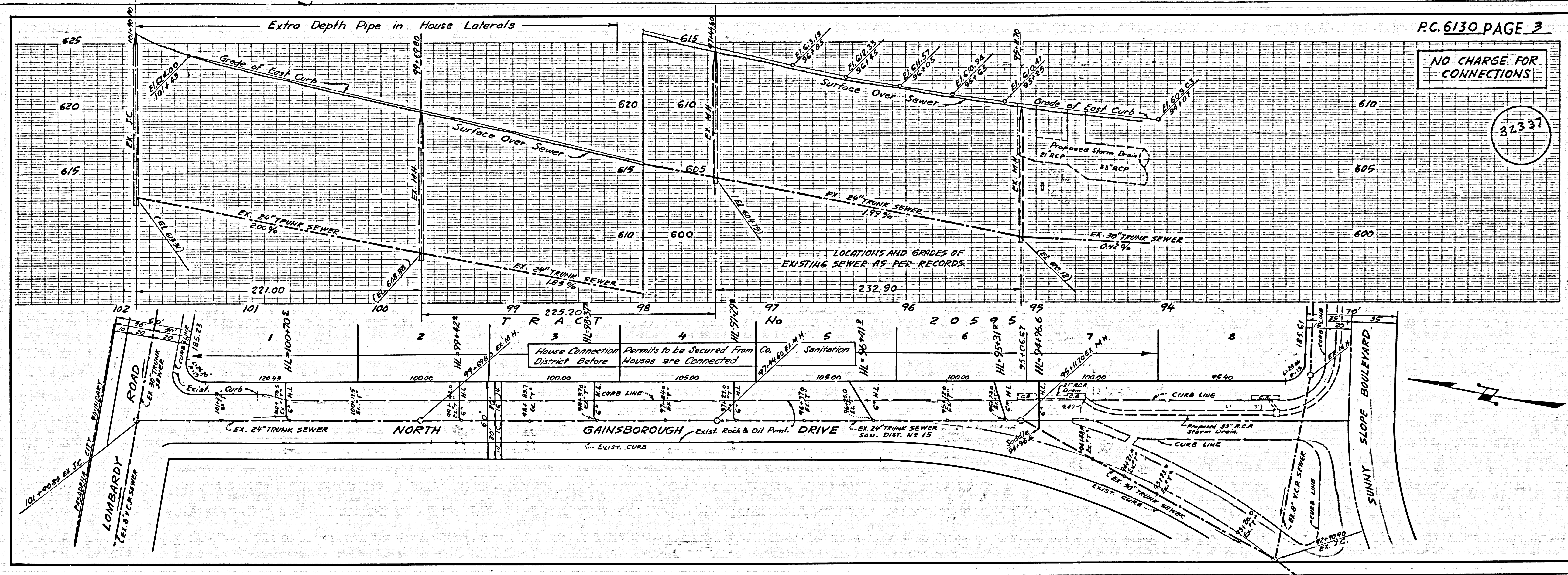

NO CHARGE FOR CONNECTIONS

32338

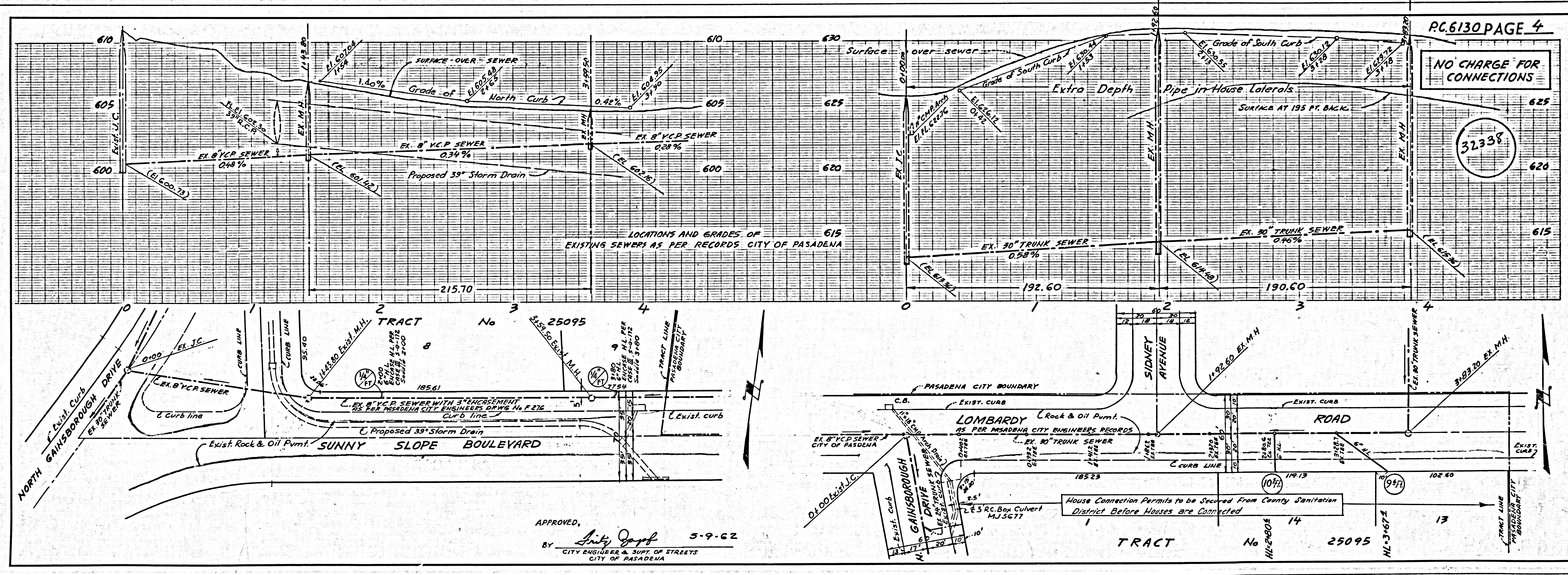

APPROVED,  
 BY *Anty Goyt* 5-9-62  
 CITY ENGINEER & SUPT. OF STREETS  
 CITY OF PASADENA