

B.M. SY 2340 Elev. 75.061
 L & T near NE. cor. of 1st conc. strip to house
 #18303 Downey Ave. 1.50' S. of d. 2nd St.
 6.55' N. of d. Downey Ave. @ S.W. cor.
 Downey Ave. @ 2nd St.
 Newark Quad 1255

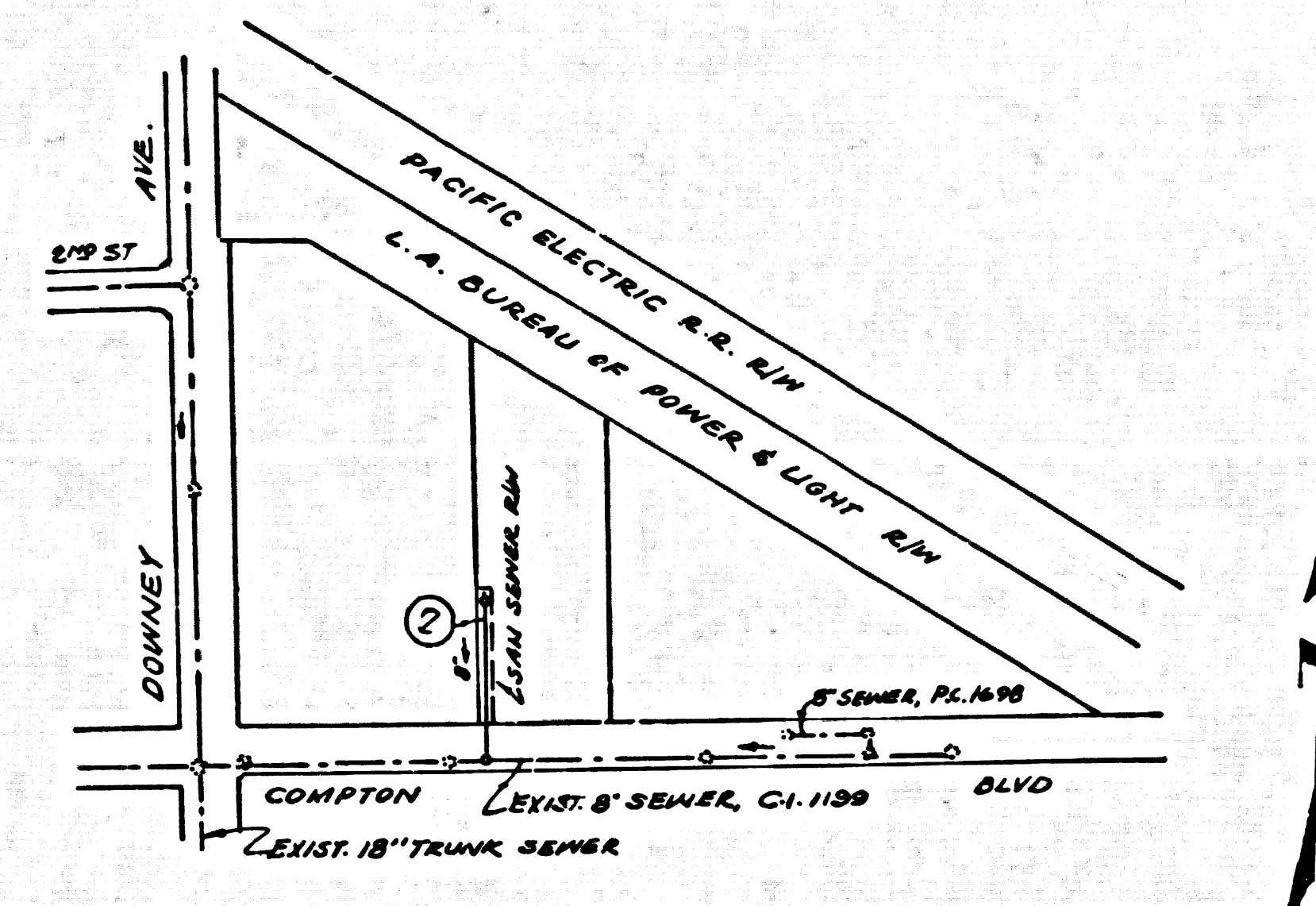

INDEX MAP
 P.C. 6134
 Scale: 1"=300'

NOTE: CALL THE PACIFIC TELEPHONE CO.
 RICHMOND 8-0436 24 HOURS IN ADVANCE
 OF ANY EXCAVATION

**PRIVATE ENGINEER'S
 NOTICE TO CONTRACTOR**

The existence and location of any underground utility lines or structures shown on these plans are obtained by a search of the available records. To the best of our knowledge there are no existing utilities except as shown on this map.
 The Contractor is required to take due precautionary measures to protect the utility lines shown and any other lines not shown on this drawing.

PARAMOUNT BLDG. DIST. NO. 4.04

- NOTES:
1. PROVIDE STAKES ON THE PROPERTY LINE OR PROPERTY LINES PRODUCED AT RIGHT ANGLES TO THE SEWER LINE AT THE CENTER LINE OF EACH MANHOLE.
 2. NO REPRESENTATIVE OF THE CITY ENGINEER WILL SURVEY OR LAY OUT ANY PORTION OF THE WORK.
 3. THE OWNER OR HIS AUTHORIZED REPRESENTATIVE SHALL FURNISH THE CITY ENGINEER WITH GRADE SHEETS AND STATIONING FOR ALL HOUSE LATERALS AND Y BRANCHES AND SHALL PROVIDE STAKES FOR THEM AT THEIR PROPER LOCATIONS WITH STATIONING PLAINLY MARKED. ANY CHANGE IN LOCATION SHALL BE REQUESTED IN WRITING BY THE OWNER OR HIS REPRESENTATIVE.
 4. THE PRIVATE ENGINEER SHALL FURNISH THE HOUSE LATERAL DEPTH AT THE PROPERTY LINE BELOW THE TOP OF CURB ELEVATION FOR EACH HOUSE LATERAL ON THE GRADE SHEET.
 5. NO REVISIONS SHALL BE MADE IN THESE PLANS WITHOUT THE APPROVAL OF THE CITY ENGINEER.
 6. USE STANDARD MANHOLE FRAMES AND COVERS, S-117, EXCEPT AS NOTED.
 7. USE EXTRA STRENGTH PIPE. ALL PIPE STANDARD DEPTH EXCEPT AS NOTED.
 8. USE CEMENT MORTAR OR "WEDGE-LOCK" OR "SPEED-SEAL" FOR ALL V.C.P. JOINTS PER SPECS, SECS. 36 & 48.
 9. RESURFACE ALL TRENCH WITHIN PAVED AREA TO MEET L.A. COUNTY ROAD DEPT. OR CALIF. STATE HIGHWAY REQUIREMENTS IN ACCORDANCE WITH PERMITS.
 10. ENCASE FOUR FEET OF SEWER AT POINTS OF INTERFERENCE WITH POLES, CASE III, S-172.
 11. HOUSE LATERALS TO BE CONSTRUCTED WITH 1/4" RISE PER FOOT TO R/W LINE.
 12. ALL STRUCTURES SHALL BE BRICK SEWER STRUCTURES, S-104, EXCEPT AS NOTED.
 13. FOR ALLOWABLE LEAKAGE TEST USE FORMULA NO. 1, SPECS, SEC. 64.
 14. MANHOLE TOPS IN IMPROVED RIGHTS-OF-WAY TO BE 5' LEVEL WITH FINISHED GRADE.
 15. THE CONTRACTOR SHALL NOTIFY THE CONSTRUCTION & STORM-DRAIN DIVISION BY TELEPHONE, MADISON 9-4171, EXT. 632 AT LEAST TWENTY-FOUR HOURS BEFORE STARTING ANY WORK UNDER THIS CONTRACT.
 16. STANDARD SPECIFICATIONS DATED OCT 25, 1961, ON FILE IN THE CITY, SHALL APPLY IN THE CONSTRUCTION OF THIS PROJECT.

COLLECT CHARGES
 AS INDICATED
 William A. Hopkins
 4-9-62

REVISED 5-14-62
 ADD 6" HOUSE LATERALS AT
 STA. 0+180 & 2+120 ON EAST
 SIDE
 APPROVED John P. Rowe
 5-16-62 Reg. C.E. 12437

NO CONNECTIONS FOR THE DISPOSAL OF INDUSTRIAL WASTES SHALL BE MADE TO SEWERS SHOWN ON THESE DRAWINGS WITHOUT WRITTEN PERMISSION FROM THE CHIEF ENGINEER AND GENERAL MANAGER OF THE COUNTY SANITATION DISTRICTS.

PROFILE ALIGNMENT AND GRADE OF
SANITARY SEWERS PAGE 1
 TO BE CONSTRUCTED IN
R/W EAST OF DOWNEY AVENUE

PRIVATE CONTRACT NO. 6134

W.S. 32
 1 SHEET ; 2 PAGES
 SCALE: VERT. 1"=4' HORIZ. 1"=40'
 JAN, 1962
 PREPARED IN THE OFFICES OF
OLSON SURVEYING SERVICE, INC.

31920

By: William A. Hopkins
 REG. C. E. NO. 16220

FOR LEGEND SEE PLAN NO. S-A-64

NOTE:
 GRADES TO WHICH THIS IMPROVEMENT IS TO BE CONSTRUCTED ARE SHOWN ON PLANS AND PROFILES. GRADE POINTS FOR TOP OF CURBS, CENTER LINE OF STREETS, OR CENTER LINE OF ALLEYS ARE SHOWN BY CIRCLES ON PROFILES AT ALL POINTS BETWEEN DESIGNATED POINTS THE GRADE SHALL BE ESTABLISHED SO AS TO CONFORM TO A STRAIGHT LINE DRAWN BETWEEN SAID DESIGNATED POINTS.
 ELEVATIONS ARE IN FEET ABOVE U.S.C. & G.S. SEA LEVEL DATUM OF 1929.
 THIS DRAWING AND THE DATA HEREON ARE HEREBY MADE A PART OF THE SPECIFICATIONS.
 BEFORE WORK CAN BE STARTED, THE CONTRACTOR MUST OBTAIN A PERMIT TO EXCAVATE IN CITY STREETS FROM THE L. A. COUNTY ROAD DEPT., DISTRICT OFFICE NO. 4, AND MAKE A DEPOSIT WITH THE CITY OF PARAMOUNT, 16.25' S.D. PARAMOUNT'S BLDG. PERMITS, SUFFICIENT TO COVER THE COST OF CONSTRUCTION INSPECTION AND RECORD PLANS.
 APPROVAL OF THIS PLAN BY THE CITY OF PARAMOUNT DOES NOT CONSTITUTE A REPRESENTATION AS TO THE ACCURACY OF THE LOCATION OF OR THE EXISTENCE OR NON-EXISTENCE OF ANY UNDERGROUND UTILITY PIPE, OR STRUCTURE WITHIN THE LIMITS OF THIS PROJECT. THIS NOTE APPLIES TO ALL PAGES.
 IF WORK IS TO BE DONE IN A STATE HIGHWAY, A PERMIT MUST BE OBTAINED FROM THE STATE OF CALIFORNIA, DIVISION OF HIGHWAYS, 130 SOUTH SPRING STREET.

CITY OF PARAMOUNT, CALIFORNIA

APPROVED, JOHN A. LAMBIE, CC CITY ENGINEER APPROVED, J.D. MEDWESS, CHIEF ENGINEER
 CO. SAN. DIST. NO. 2
 BY: John A. Lambie ASST. SANITATION ENGINEER BY: J.D. Medwess OFFICE ENGINEER
 CHECKED BY: W. D. Duda 4-10-62
 OFFICE OF CITY ENGINEER, REG. C. E. NO. 2466

SUBMITTED BY: John A. Lambie 4-9-62
 LOS CERRITOS REGIONAL ENGINEER, REG. C.E. 3871

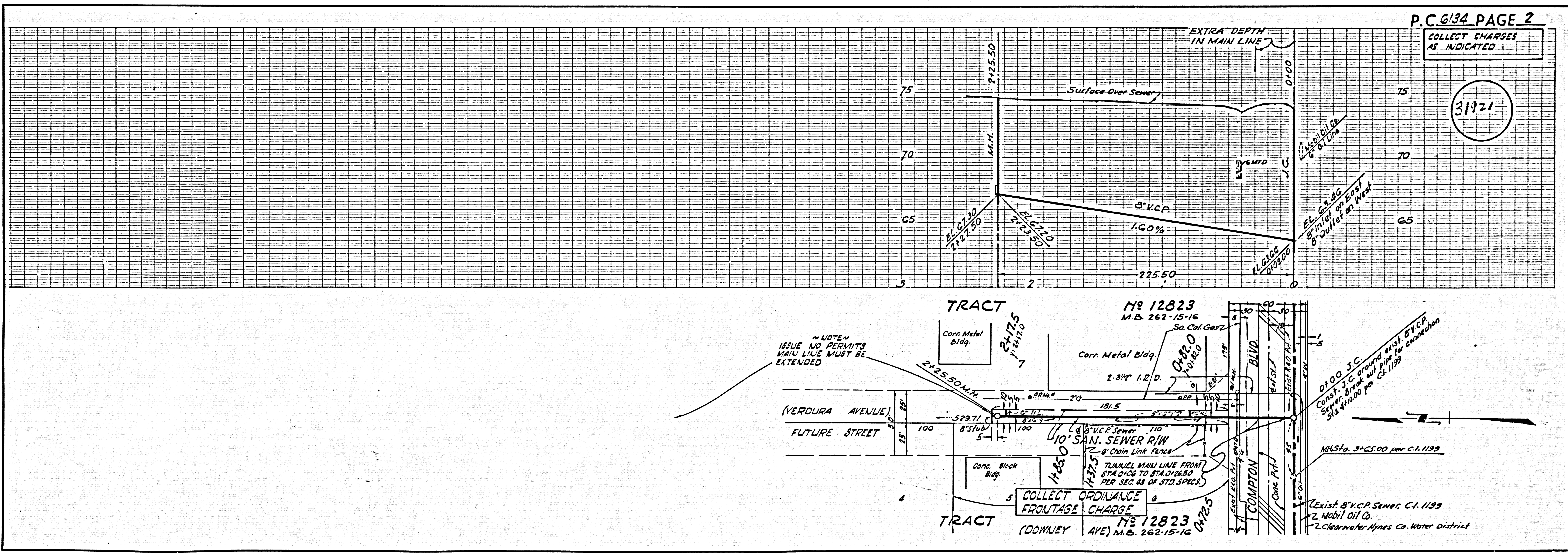

P.C. 6134 PAGE 2

COLLECT CHARGES
 AS INDICATED

31921

NOTE:
 ISSUE NO PERMITS
 MAIN LINE MUST BE
 EXTENDED

COLLECT ORDINANCE
 FRONTAGE CHARGE