

BEACH MARK: 5' 1968 ELEV. 87.094 (1955)
 L.B. 7' 2.3" W. of C.B. Rd. at S.W. cor. Stonbridge
 Ave. and Foster Rd. (Service Rd)
 NORMAL W. QUAD

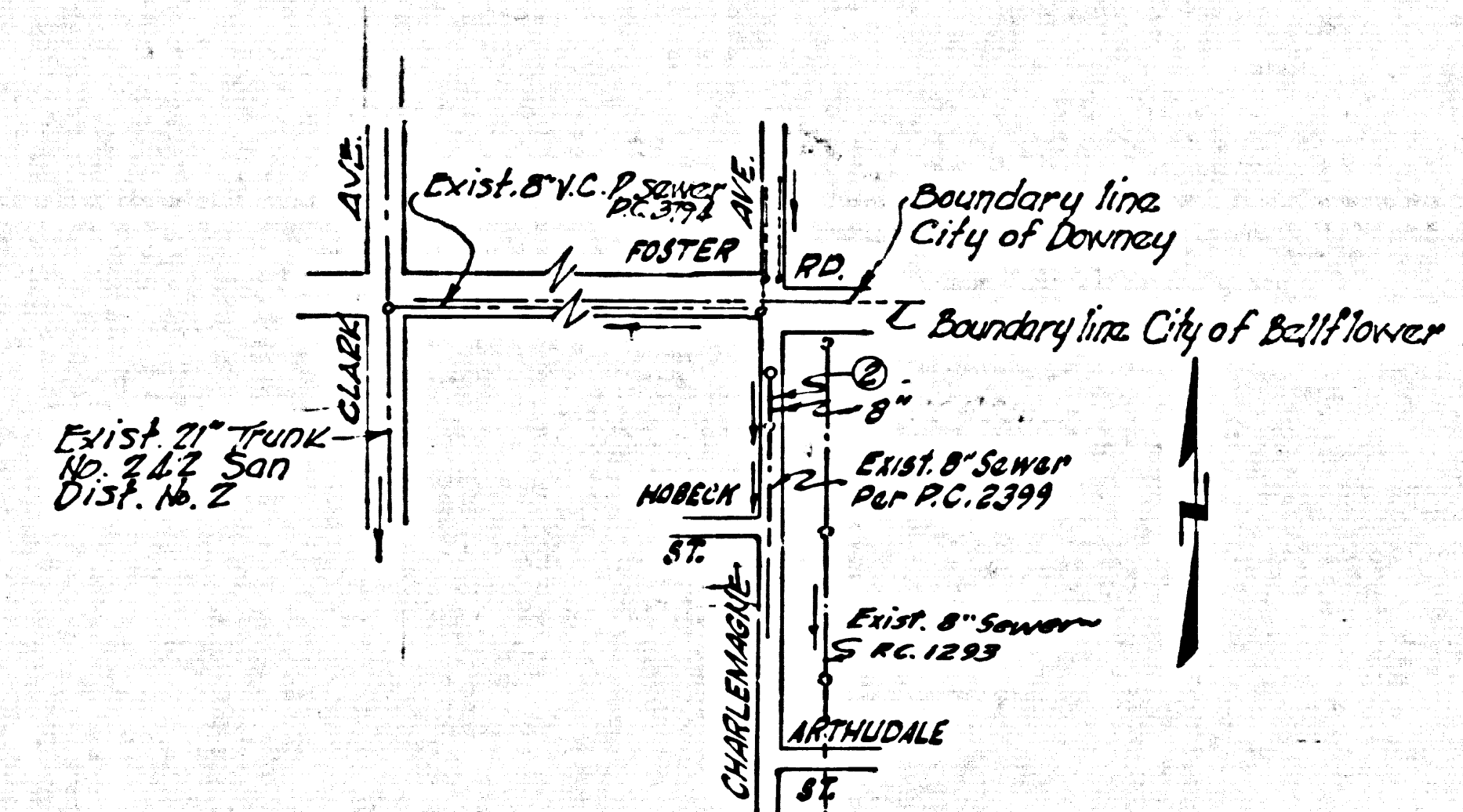

INDEX MAP
 P.C. 6179
 SCALE: 1" = 500'

BELFLOWER BLDG. DIST. NO. 407

NOTES:

1. PROVIDE STAKES ON THE PROPERTY LINE OR PROPERTY LINES PRODUCED AT RIGHT ANGLES TO THE SEWER LINE, AT THE CENTER LINE OF EACH MANHOLE.
2. NO REPRESENTATIVE OF THE CITY ENGINEER WILL SURVEY OR LAY OUT ANY PORTION OF THE WORK.
3. THE OWNER OR HIS AUTHORIZED REPRESENTATIVE SHALL FURNISH THE CITY ENGINEER WITH GRADE SHEETS AND STATIONING FOR ALL HOUSE LATERALS AND Y BRANCHES AND SHALL PROVIDE STAKES FOR THEM AT THEIR PROPER LOCATIONS WITH STATIONING PLAINLY MARKED. ANY CHANGE IN LOCATION SHALL BE REQUESTED IN WRITING BY THE OWNER OR HIS REPRESENTATIVE.
4. THE PRIVATE ENGINEER SHALL FURNISH THE HOUSE LATERAL DEPTH AT THE PROPERTY LINE BELOW THE TOP OF CURB ELEVATION FOR EACH HOUSE LATERAL ON THE GRADE SHEET.
5. NO REVISIONS SHALL BE MADE IN THESE PLANS WITHOUT THE APPROVAL OF THE CITY ENGINEER.
6. USE STANDARD MANHOLE FRAMES AND COVERS, S-117.
7. USE 4" STRENGTH PIPE "ALL PIPE IS STANDARD DEPTH"
8. USE CEMENT MORTAR OR "WEDGE-LOCK" OR "SPEED-SEAL" FOR ALL V.C.P. JOINTS PER SPEC'S, SECS. 36 & 48.
9. RESURFACE ALL TRENCH WITHIN PAVED AREA TO MEET BELFLOWER ROAD DEPT. OR CALIF. STATE HIGHWAY REQUIREMENTS IN ACCORDANCE WITH PERMITS.
10. ENCASE FOUR FEET OF SEWER AT POINTS OF INTERFERENCE WITH POLES, CASE III, S-117.
11. HOUSE LATERALS TO BE CONSTRUCTED WITH $\frac{1}{2}$ " RISE PER FOOT TO PROPERTY LINE
12. ALL STRUCTURES SHALL BE BRICK SEWER STRUCTURES, S-114.
13. FOR ALLOWABLE LEAKAGE TEST USE FORMULA NO. 1, SPEC'S, SEC. 54.
14. MANHOLE TOPS IN UNIMPROVED RIGHTS-OF-WAY TO BE SIX INCHES ABOVE FINISHED GRADE.
15. THE CONTRACTOR SHALL NOTIFY THE CONSTRUCTION DIVISION BY TELEPHONE, MADISON 9-6747 EXT. 833, AT LEAST TWENTY-FOUR HOURS BEFORE STARTING ANY WORK UNDER THIS CONTRACT.
16. STANDARD SPECIFICATIONS DATED OCTOBER 23, 1967 ON FILE IN THE CITY APPLY IN THE CONSTRUCTION OF THIS PROJECT.

NO CONNECTIONS FOR THE DISPOSAL OF INDUSTRIAL WASTES SHALL BE MADE TO SEWERS SHOWN ON THESE DRAWINGS WITHOUT WRITTEN PERMISSION FROM THE CHIEF ENGINEER AND GENERAL MANAGER OF THE COUNTY SANITATION DISTRICTS.

PRIVATE ENGINEER'S
 NOTICE TO CONTRACTOR

The existence and location of any underground utility pipes or structures shown on these plans are obtained by a search of the available records. To the best of our knowledge there are no other utility lines shown on this map.

The Contractor is required to take such preliminary measures to protect the utility lines shown and any other lines not shown or not shown on this drawing.

NO CHARGE FOR CONNECTION

TO BE CONSTRUCTED IN

CHARLEMAGNE AVE.

PRIVATE CONTRACT NO. 6179

W.S. 33

1 SHEET : 2 PAGES

SCALE: VERT. 1" = 4' HORIZ. 1" = 40'

MARCH, 1962

32159

PREPARED IN THE OFFICES OF

OLSON SURVEYING SERVICE

By: *[Signature]*

REG. C. E. NO. 7825

FOR LEGEND SEE PLAN NO. S.A-64

NOTE:

GRADES TO WHICH THIS IMPROVEMENT IS TO BE CONSTRUCTED ARE SHOWN ON PLANS AND PROFILES. GRADE POINTS FOR TOP OF CURBS, CENTER LINE OF STREETS OR CENTER LINE OF ALLEYS ARE SHOWN BY CIRCLES ON PROFILES. AT ALL POINTS BETWEEN DESIGNATED POINTS THE GRADE SHALL BE ESTABLISHED SO AS TO CONFORM TO A STRAIGHT LINE DRAWN BETWEEN SAID DESIGNATED POINTS.

ELEVATIONS ARE IN FEET ABOVE U.S.C. & G.S. SEA LEVEL DATUM OF 1929.

THIS DRAWING AND THE DATA HEREON ARE HEREBY MADE A PART OF THE SPECIFICATIONS. ENGINEER WORK SHALL BE CONSTRUCTED ACCORDING TO SPECIFICATIONS ON FILE IN THE OFFICE OF THE CITY ENGINEER AND SHALL BE PROSECUTED ONLY IN THE PRESENCE OF THE CITY ENGINEER.

BEFORE WORK CAN BE STARTED, THE CONTRACTOR MUST OBTAIN A PERMIT TO EXCAVATE IN CITY STREETS FROM THE CITY OF BELFLOWER, ROAD DEPT. AND MAKE A DEPOSIT WITH THE CITY OF BELFLOWER, ROAD DEPT. SUFFICIENT TO COVER THE COST OF CONSTRUCTION INSPECTION AND RECORD PLANS.

APPROVAL OF THIS PLAN BY THE CITY OF BELFLOWER DOES NOT CONSTITUTE A REPRESENTATION AS TO THE ACCURACY OF THE LOCATION OR OF THE EXISTENCE OR NON-EXISTENCE OF ANY UNDERGROUND UTILITY PIPE OR STRUCTURE WITHIN THE LIMITS OF THIS PROJECT. THIS NOTE APPLIES TO ALL PAGES.

IF WORK IS TO BE DONE IN A STATE HIGHWAY, A PERMIT MUST BE OBTAINED FROM THE STATE OF CALIFORNIA, DIVISION OF HIGHWAYS, 120 SOUTH SPRING STREET.

CITY OF BELFLOWER, CALIFORNIA

APPROVED JOHN A. LAMBIE, CITY ENGINEER APPROVED J.A. BARNHART, CHIEF ENGINEER

By: *[Signature]* ASST. SANITATION ENGINEER By: *[Signature]* OFFICE ENGINEER

CHECKED BY: *[Signature]*

OFFICE OF CITY ENGINEER, REG. C. E. NO. 5454

SUBMITTED BY: *[Signature]* 4-24-62
 JOSE CARRITOS REGIONAL ENGINEER, REG. C.E. 3871

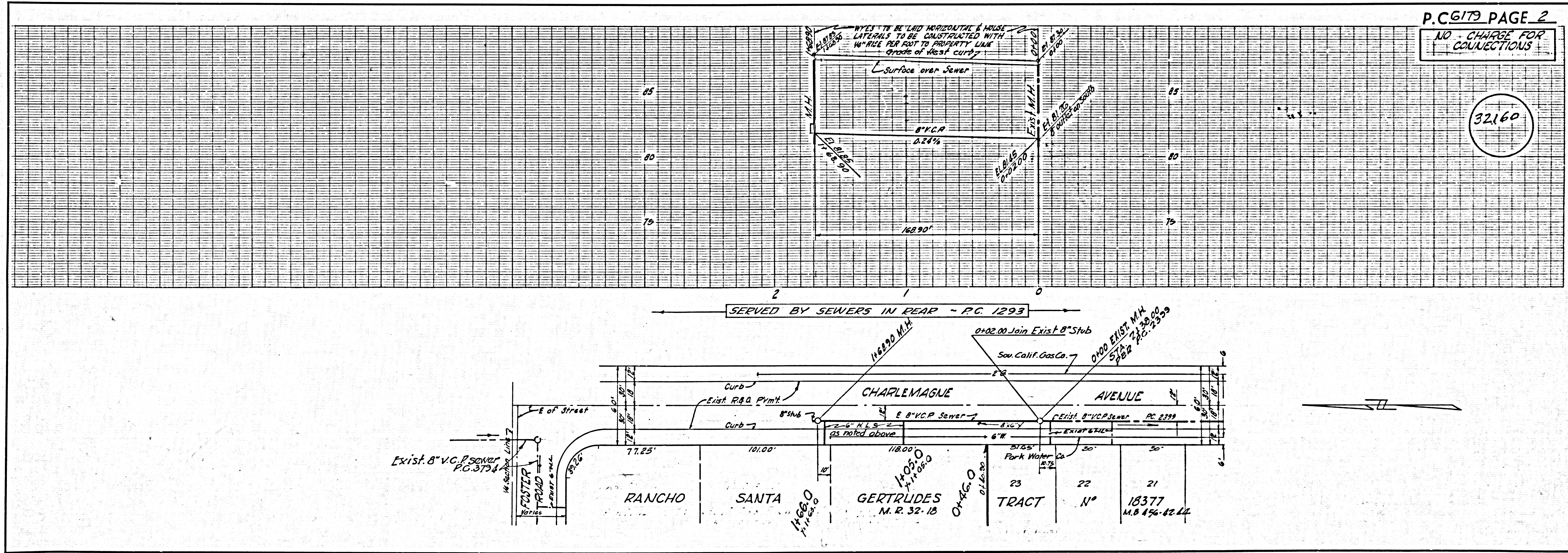

NO CHARGE FOR CONNECTIONS

32160