

PC 6184

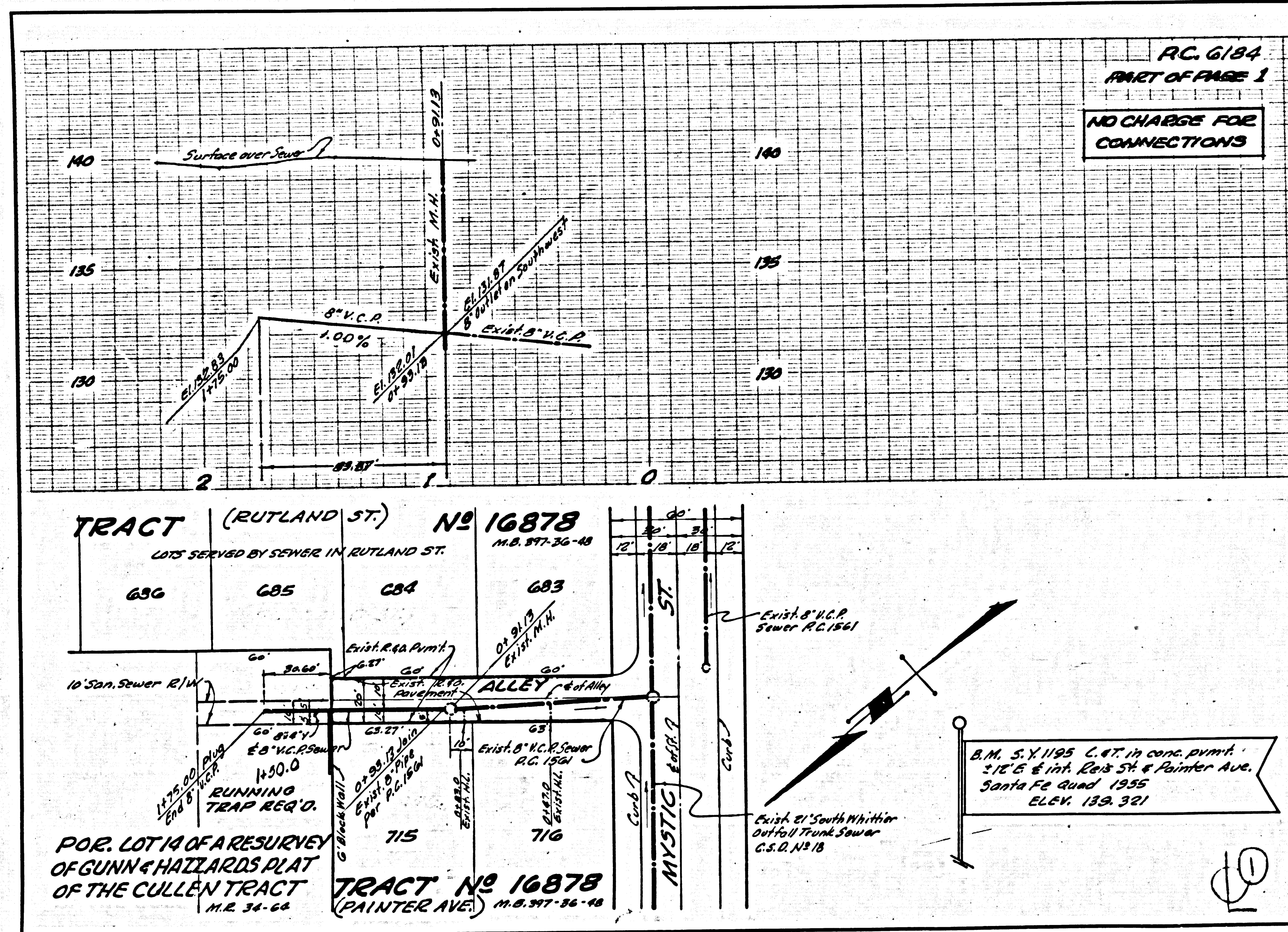

### WHITTIER BLDG. DIST. NO. 11

- NOTES:**
1. PROVIDE STAKES ON THE PROPERTY LINE OR PROPERTY LINES PRODUCED AT RIGHT ANGLES TO THE SEWER LINE AT THE CENTER LINE OF EACH MANHOLE.
  2. NO REPRESENTATIVE OF THE COUNTY ENGINEER WILL SURVEY OR LAY OUT ANY PORTION OF THE WORK.
  3. THE OWNER OR HIS AUTHORIZED REPRESENTATIVE SHALL FURNISH THE COUNTY ENGINEER WITH GRADE SHEETS AND STATIONING FOR ALL HOUSE LATERALS AND Y BRANCHES AND SHALL PROVIDE STAKES FOR THEM AT THEIR PROPER LOCATIONS WITH STATIONING PLAINLY MARKED. ANY CHANGE IN LOCATION SHALL BE REQUESTED IN WRITING BY THE OWNER OR HIS REPRESENTATIVE.
  4. THE PRIVATE ENGINEER SHALL FURNISH THE HOUSE LATERAL DEPTH AT THE PROPERTY LINE BELOW THE TOP OF CURB ELEVATION FOR EACH HOUSE LATERAL ON THE GRADE SHEET.
  5. NO REVISIONS SHALL BE MADE IN THESE PLANS WITHOUT THE APPROVAL OF THE COUNTY ENGINEER.
  6. USE STANDARD MANHOLE FRAMES AND COVERS 5'-0" DIA. UNLESS NOTED.
  7. USE EXTRA STRENGTH PIPE. ALL PIPE IS STANDARD DEPTH, UNLESS NOTED.
  8. USE CEMENT MORTAR OR MECHANICAL COMPRESSION FOR ALL V.C.P. PER SPEC. SECT. M & N.
  9. RESURFACE ALL TRENCH WITHIN PAVED AREA TO MEET L.A. COUNTY ROAD DEPT. OR CALIF. STATE HIGHWAY REQUIREMENTS IN ACCORDANCE WITH PERMITS.
  10. ENCASE FOUR FEET OF SEWER AT POINTS OF INTERFERENCE WITH POLES, CASE III, S-172.
  11. HOUSE LATERALS TO BE CONSTRUCTED WITH INVERTS AT PROPERTY LINE 1'-00" BELOW CURB GRADE UNLESS NOTED.
  12. ALL STRUCTURES SHALL BE BRICK-SEWER STRUCTURES, UNLESS NOTED.
  13. FOR ALLOWABLE LEAKAGE TEST USE FORMULA NO. 1 SPEC. SEC. 84.
  14. MANHOLE TOPS IN UNIMPROVED AREAS TO BE 2'-00" HIGHER ABOVE FINISHED GROUND.
  15. THE CONTRACTOR SHALL NOTIFY THE CONSTRUCTION DIVISION BY TELEPHONE, MADISON 3-4747, 672-8151 AT LEAST TWENTY-FOUR HOURS BEFORE STARTING ANY WORK UNDER THIS CONTRACT.
  16. STANDARD SPECIFICATIONS DATED MAY 25, 1962 APPLY IN THE CONSTRUCTION OF THIS PROJECT.

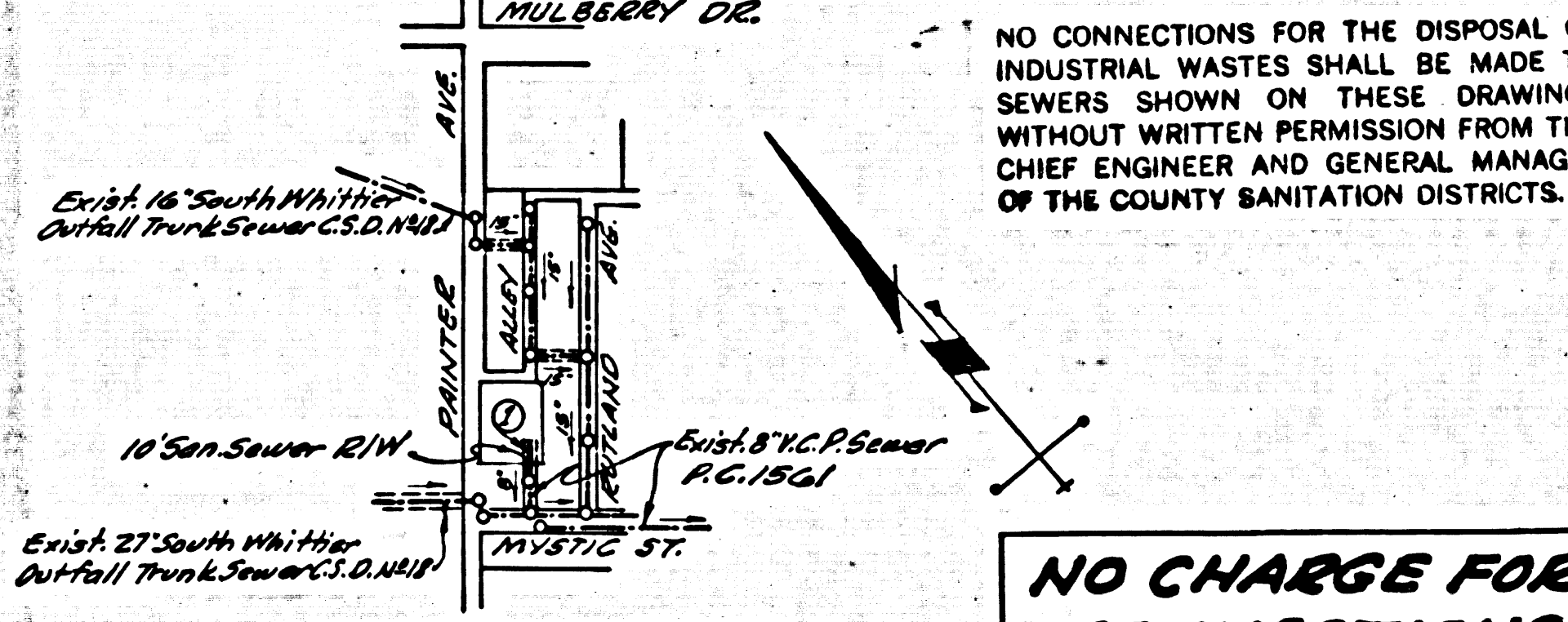

**INDEX MAP**  
RC. 6184 SCALE: 1"=60'  
J.N. 0357.98

**NO CHARGE FOR CONNECTIONS**  
R. Chickland 2-20-62

PROFILE ALIGNMENT AND GRADE OF  
**SANITARY SEWERS** PAGE 1  
TO BE CONSTRUCTED IN  
**SANITARY SEWER R/W**  
**E/O PAINTER AVE.**

PRIVATE CONTRACT NO. 6184

W.S. 34  
1 SHEET OF 1 PAGE  
SCALE: VERT. 1"=4'  
HORIZ. 1"=40'  
JAN., 1962  
PREPARED IN THE OFFICES OF  
**HANS C. THOMSEN**

BY: *Hans C. Thomsen*  
REG. C. E. NO. 8268  
FOR LEGEND SEE PLAN NO. S-A-64

**NOTE:**  
GRADES TO WHICH THIS IMPROVEMENT IS TO BE CONSTRUCTED ARE SHOWN ON PLANS AND PROFILES. GRADE POINTS FOR TOP OF CURBS, CENTER LINE OF STREETS, OR CENTER LINE OF ALLEYS ARE SHOWN BY CIRCLES ON PROFILES AT ALL POINTS BETWEEN DESIGNATED POINTS THE GRADE SHALL BE ESTABLISHED SO AS TO CONFORM TO A STRAIGHT LINE DRAWN BETWEEN SAID DESIGNATED POINTS.  
ELEVATIONS ARE IN FEET ABOVE U.S.C. & G.S. SEA LEVEL DATUM OF 1929.  
THIS DRAWING AND THE DATA HEREON ARE HEREBY MADE A PART OF THE SPECIFICATIONS.  
WORK SHALL BE CONSTRUCTED ACCORDING TO SPECIFICATIONS ON FILE IN THE OFFICE OF THE COUNTY ENGINEER AND SHALL BE PROSECUTED ONLY IN THE PRESENCE OF THE COUNTY ENGINEER.  
BEFORE WORK CAN BE STARTED THE CONTRACTOR MUST OBTAIN A PERMIT TO EXCAVATE IN COUNTY STREETS FROM THE L.A. COUNTY ROAD DEPT., DISTRICT OFFICE NO. 24 AND 2474 1922 TO THE COUNTY ENGINEER, ROOM 210, 1000 WEST 7TH STREET, LOS ANGELES, CALIF. SUFFICIENT TO COVER THE COST OF CONSTRUCTION INSPECTION AND RECORD PLANS.  
APPROVAL OF THIS PLAN BY THE COUNTY OF LOS ANGELES DOES NOT CONSTITUTE A REPRESENTATION AS TO THE ACCURACY OF THE LOCATION OF OR THE EXISTENCE OR NON-EXISTENCE OF ANY UNDERGROUND UTILITY PIPE, OR STRUCTURE WITHIN THE LIMITS OF THIS PROJECT. THIS NOTE APPLIES TO ALL PAGES.  
IF WORK IS TO BE DONE IN A STATE HIGHWAY, A PERMIT MUST BE OBTAINED FROM THE STATE OF CALIFORNIA, DIVISION OF HIGHWAYS, 120 SOUTH SPRING STREET.

COUNTY OF LOS ANGELES, CALIFORNIA  
APPROVED, JOHN A. LAMBIE, COUNTY ENGINEER  
APPROVED, J. D. PARSONS, CHIEF ENGINEER  
BY: *[Signature]* ASSISTANT SANITATION ENGINEER  
BY: *[Signature]* OFFICE ENGINEER  
CHECKED BY: *[Signature]*  
OFFICE OF COUNTY ENGINEER, REG. C. E. NO. 5644  
SUBMITTED BY: *[Signature]* 1-20-62  
LOS ANGELES REGIONAL ENGINEER, REG. C. E. NO. 3871

PC 6184 B/LM E/O PAINTER AVE