

CITY OF IRWINDALE BLDG. DIST. NO. 5.05

PROFILE ALIGNMENT AND GRADE OF P.C. 6225

SANITARY SEWERS PAGE 1

TO BE CONSTRUCTED IN

RIGHT OF WAY
EAST OF MOUNTAIN AVENUE

PRIVATE CONTRACT NO. 6225

W.S. 46-C.2

1 SHEET 2 PAGES

32472

SCALE: VERT. 1"=4'
HORIZ. 1"=40' JUNE, 1962

PREPARED IN THE OFFICES OF
JOHN S. GREGORY CO. CIVIL ENGINEERS
820 WEST COLORADO BLVD., LOS ANGELES, CALIFORNIA

REG. C. E. NO. 6353

FOR LEGEND SEE PLAN NO. S.A-64

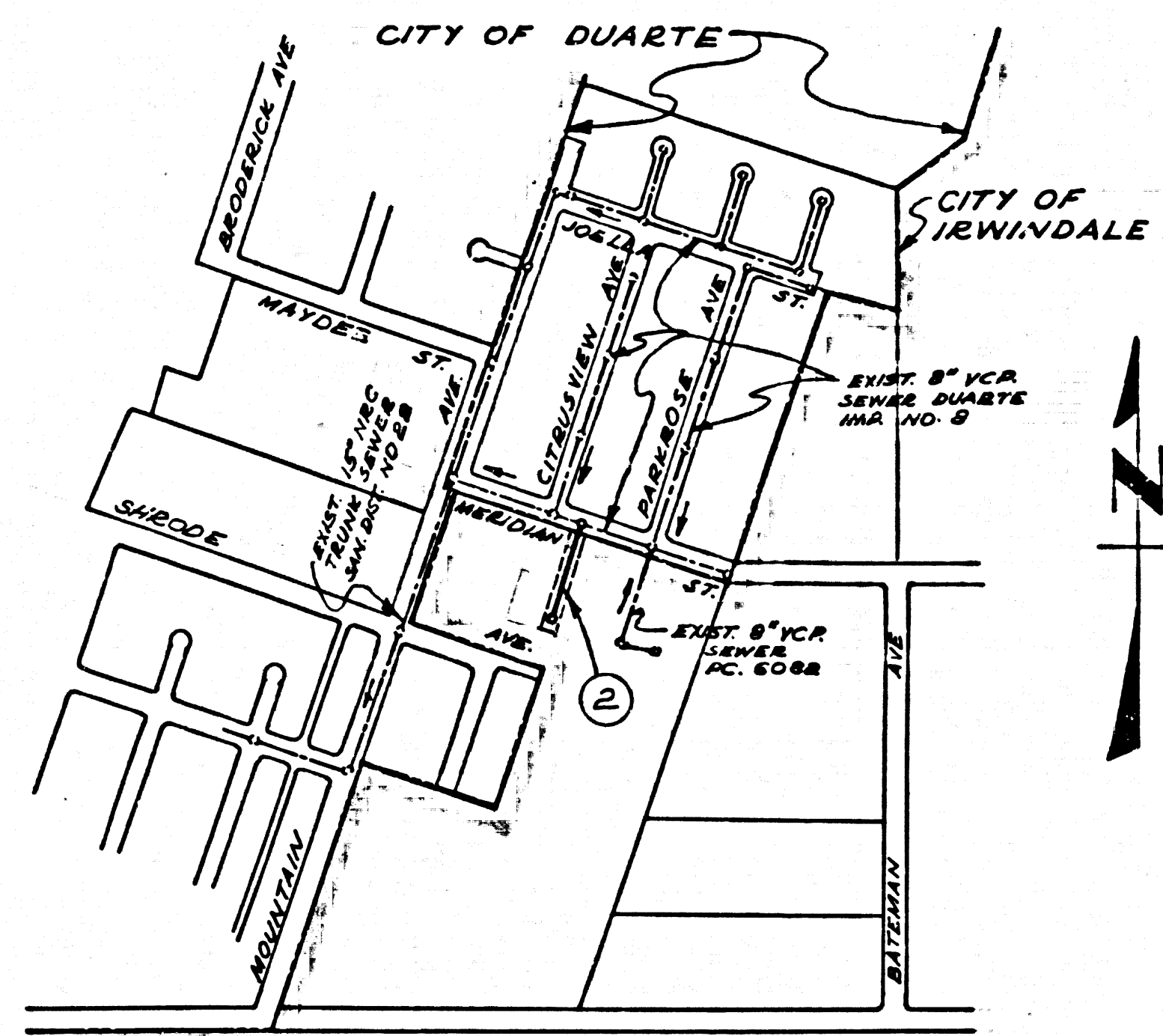

INDEX MAP
P.C. 6225
SCALE: 1"=600'

NOTE: NUMBER IN CIRCLE INDICATES PAGE NUMBER.

BM KK-248 L.A. CO. ENGN. EL.=398.705
F.B. 1982 P. 100 MOUNTAIN AVE. AND
MAYDEE ST. N.W. COR. ST. 54'. W
CURB 5' N. OF N. END C.B.

- NOTES:
1. PROVIDE STAKES ON THE PROPERTY LINE OR PROPERTY LINES PRODUCED AT RIGHT ANGLES TO THE SEWER LINE AT THE CENTER LINE OF EACH MANHOLE.
 2. NO REPRESENTATIVE OF THE CITY ENGINEER WILL SURVEY OR LAY OUT ANY PORTION OF THE WORK.
 3. THE OWNER OR HIS AUTHORIZED REPRESENTATIVE SHALL FURNISH THE CITY ENGINEER WITH GRADE SHEETS AND STATIONING FOR ALL HOUSE LATERALS AND Y BRANCHES AND SHALL PROVIDE STAKES FOR THEM AT THEIR PROPER LOCATIONS WITH STATIONING PLAINLY MARKED. ANY CHANGE IN LOCATION SHALL BE REQUESTED IN WRITING BY THE OWNER OR HIS REPRESENTATIVE.
 4. THE PRIVATE ENGINEER SHALL FURNISH THE HOUSE LATERAL DEPTH AT THE PROPERTY LINE BELOW $\frac{1}{2}$ OF STREET ELEVATION FOR EACH HOUSE LATERAL ON THE GRADE SHEET.
 5. NO REVISIONS SHALL BE MADE IN THESE PLANS WITHOUT THE APPROVAL OF THE CITY ENGINEER.
 6. USE STANDARD MANHOLE FRAMES AND COVERS, S-87, EXCEPT AS NOTED.
 7. USE EXTRA STRENGTH PIPE. ALL PIPE IS STANDARD DEPTH.
 8. USE CEMENT MORTAR JOINTS OR MECHANICAL COMPRESSION JOINTS FOR ALL V.C.P. IN MAIN LINE PER SPECS, SEC. 35 AND 42.
 9. RESURFACE ALL TRENCH WITHIN PAVED AREA TO MEET L.A. COUNTY ROAD DEPT. OR CALIF. STATE HIGHWAY REQUIREMENTS IN ACCORDANCE WITH PERMITS.
 10. ENCASE FOUR FEET OF SEWER AT POINTS OF INTERFERENCE WITH POLES, CASE III, S-172.
 11. HOUSE LATERALS TO BE CONSTRUCTED WITH INVERTS AT PROPERTY LINE $\frac{1}{2}$ FEET BELOW GRADE OF $\frac{1}{2}$ OF SEWER R/W EXCEPT AS NOTED.
 12. MANHOLES SHALL BE BRICK SEWER STRUCTURES PER S-87-109. PRECAST CONCRETE MANHOLES PER S-87-125 OR S-87-175 MAY BE USED AS AN ALTERNATE IN LOCATIONS APPROVED BY THE CITY ENGINEER.
 13. FOR ALLOWABLE LEAKAGE TEST USE FORMULA NO. 1 PER SPECS, SEC. 58.
 14. MANHOLE TOPS IN IMPROVED RIGHTS-OF-WAY TO BE LEVEL WITH FINISHED GRADE.
 15. THE CONTRACTOR SHALL NOTIFY THE CONSTRUCTION DIVISION BY TELEPHONE, MADISON 3-9797 EXT. 8151 AT LEAST TWENTY-FOUR HOURS BEFORE STARTING ANY WORK UNDER THIS CONTRACT.
 16. USE MECHANICAL COMPRESSION JOINTS FOR ALL V.C.P. HOUSE LATERALS PER SPECS, SEC. 36.
 17. SPECIFICATIONS DATED MAY 25, 1962 APPLY IN THE CONSTRUCTION OF THIS PROJECT.

APPROVED: *[Signature]* DATE: *July 14, 1962*
CITY ADMINISTRATOR, CITY OF DUARTE

NO CONNECTIONS FOR THE DISPOSAL OF INDUSTRIAL WASTES SHALL BE MADE TO SEWERS SHOWN ON THESE DRAWINGS WITHOUT WRITTEN PERMISSION FROM THE CHIEF ENGINEER AND GENERAL MANAGER OF THE COUNTY SANITATION DISTRICTS.

CONNECTION CHARGES
AS INDICATED
[Signature]

NOTE:
GRADES TO WHICH THIS IMPROVEMENT IS TO BE CONSTRUCTED ARE SHOWN ON PLANS AND PROFILES. GRADE POINTS FOR TOP OF CURBS, CENTER LINE OF STREETS OR CENTER LINE OF ALLEYS ARE SHOWN BY CIRCLES ON PROFILES. AT ALL POINTS BETWEEN DESIGNATED POINTS THE GRADE SHALL BE ESTABLISHED SO AS TO CONFORM TO A STRAIGHT LINE DRAWN BETWEEN SAID DESIGNATED POINTS.
ELEVATIONS ARE IN FEET ABOVE U.S.C. & G.S. SEA LEVEL DATUM OF 1929.
THIS DRAWING AND THE DATA HEREON ARE HEREBY MADE A PART OF THE SPECIFICATIONS.
WORK SHALL BE CONSTRUCTED ACCORDING TO SPECIFICATIONS ON FILE IN THE OFFICE OF THE CITY ENGINEER AND SHALL BE PROSECUTED ONLY IN THE PRESENCE OF THE CITY ENGINEER.
BEFORE WORK CAN BE STARTED, THE CONTRACTOR MUST OBTAIN A PERMIT TO EXCAVATE IN COUNTY STREETS FROM THE L.A. COUNTY ROAD DEPT., DISTRICT OFFICE NO. 1, AND MAKE A DEPOSIT WITH THE CITY OF IRWINDALE \$150 N. IRWINDALE AVE., CITY OF IRWINDALE SUFFICIENT TO COVER THE COST OF CONSTRUCTION INSPECTION AND RECORD PLANS.
APPROVAL OF THIS PLAN BY THE CITY OF IRWINDALE DOES NOT CONSTITUTE A REPRESENTATION AS TO THE ACCURACY OF THE LOCATION OF OR THE EXISTENCE OR NON-EXISTENCE OF ANY UNDERGROUND UTILITY PIPE, OR STRUCTURE WITHIN THE LIMITS OF THIS PROJECT. THIS NOTE APPLIES TO ALL PAGES.
IF WORK IS TO BE DONE IN A STATE HIGHWAY, A PERMIT MUST BE OBTAINED FROM THE STATE OF CALIFORNIA, DIVISION OF HIGHWAYS, 120 SOUTH SPRING STREET.

CITY OF IRWINDALE, CALIFORNIA

APPROVED, JOHN A. LAMBIE, CITY ENGINEER APPROVED, J.D. PARKHURST, CHIEF ENGINEER
CO. SAN. DIST. NO. 22

BY *[Signature]* ASST. SANITATION ENGINEER BY *[Signature]* OFFICE ENGINEER

CHECKED BY *[Signature]* DATE: *7-62*
OFFICE OF CITY ENGINEER, REG. C. E. NO. 10443

SUBMITTED BY: *N.F. Braumder*
SAN GABRIEL VALLEY REGIONAL ENGINEER

*No water wells
within 100 FT*

P.C. 6225 PAGE 2

CONNECTION CHARGES AS INDICATED

32473

