

REVISION # 2
 Sewer M.H. Sta. 2+45.53 Page
 3, Per Revision #1 15 NOV
 2+42.00
 Robert R. Flores 10-9-62
 Res. C.E. No. 3871 DATE
 LOS CERRITOS REGIONAL ENGINEER

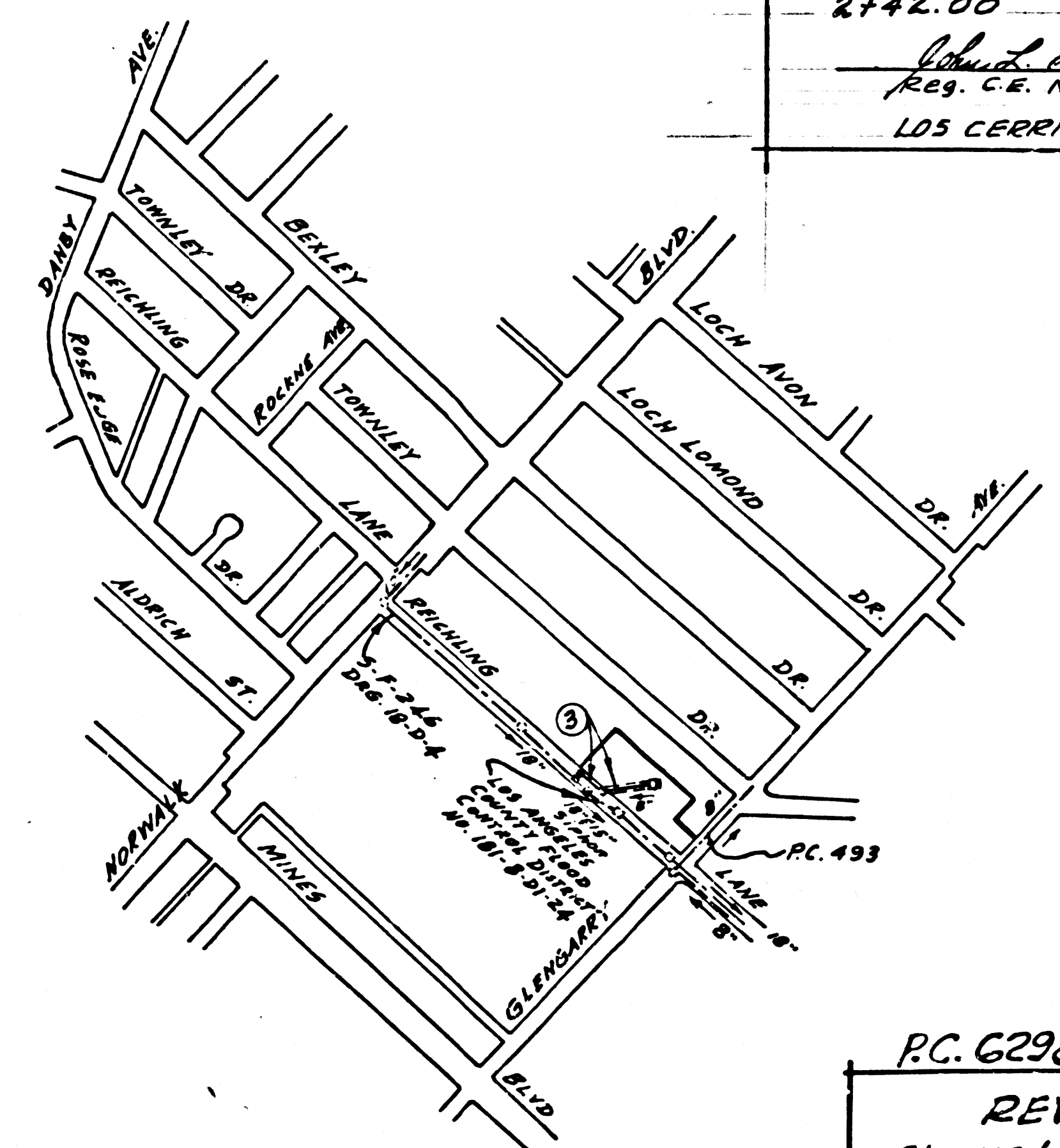

INDEX MAP
 TRACT NO. 26969
 P.C. 6298 SCALE: 1" = 600'

REVISION
 Changed Lot line between
 Lots 5 & 6, Sta. 2+45.53
 on 8" MAIN LINE, on page
 3 Was 2+45.56 S.M.N. &
 P.O.R. of 8" MAIN LINE TO BE AS SHOWN IN P.P.
 APPROVED BY: Robert R. Flores 10-25-62
 LOS CERRITOS REGIONAL ENGINEER

THE LOWEST OUTLET IN ANY
 HOUSE OR BUILDING SHALL NOT
 BE LOWER THAN ELEVATION 166.88

BEFORE BREAKING INTO ANY EXISTING STRUCTURE
 AND BEFORE FINAL ACCEPTANCE OF THIS WORK,
 COUNTY SANITATION DISTRICT (DU 41281) SHALL
 BE NOTIFIED IN ORDER THAT REQUIRED INSPECTION
 CAN BE MADE.

BENCH MARK
 5-Y-3255 - Ft. L.B.W. Co. Norwalk Blvd.
 2.3' S. of Cb. rd. At N.W. Cor. Reichling
 Lane and Norwalk Blvd.
 Elev. 167.956 Base Line 1955

NO CONNECTIONS FOR THE DISPOSAL OF
 INDUSTRIAL WASTES SHALL BE MADE TO
 SEWERS SHOWN ON THESE DRAWINGS
 WITHOUT WRITTEN PERMISSION FROM THE
 CHIEF ENGINEER AND GENERAL MANAGER
 OF THE COUNTY SANITATION DISTRICTS.

WHITTIER BLDG. DIST. NO. 11

- NOTES:
- PROVIDE STAKES ON THE PROPERTY LINE OR PROPERTY LINES PRODUCED AT RIGHT ANGLES TO THE SEWER LINE AT THE CENTER LINE OF EACH MANHOLE.
 - NO REPRESENTATIVE OF THE COUNTY ENGINEER WILL SURVEY OR LAY OUT ANY PORTION OF THE WORK.
 - THE OWNER OR HIS AUTHORIZED REPRESENTATIVE SHALL FURNISH THE COUNTY ENGINEER WITH GRADE SHEETS AND STATIONING FOR ALL HOUSE LATERALS AND Y BRANCHES AND SHALL PROVIDE STAKES FOR THEM AT THEIR PROPER LOCATIONS WITH STATIONING PLAINLY MARKED. ANY CHANGE IN LOCATION SHALL BE REQUESTED IN WRITING BY THE OWNER OR HIS REPRESENTATIVE. ALL HOUSE LATERALS SHALL BE CONSTRUCTED IN A STRAIGHT ALIGNMENT AT RIGHT ANGLES FROM THE MAIN LINE SEWER. ANY CHANGE IN ALIGNMENT SHALL BE REQUESTED IN WRITING BY THE PRIVATE ENG.
 - NO REVISIONS SHALL BE MADE IN THESE PLANS WITHOUT THE APPROVAL OF THE COUNTY ENGINEER.
 - USE STANDARD MANHOLE FRAMES AND COVERS, 5'-10" EXCEPT AS NOTED.
 - USE EXTRA STRENGTH PIPE, ALL PIPE IS STANDARD DEPTH, EXCEPT AS NOTED.
 - USE MECHANICAL COMPRESSION JOINTS FOR ALL V.C.P. PER SPECS. SECS. 18 & 4.
 - RESURFACE ALL TRENCH WITHIN PAVED AREA TO MEET L.A. COUNTY ROAD DEPT. OR CALIF. STATE HIGHWAY REQUIREMENTS IN ACCORDANCE WITH PERMITS.
 - ENCASE FOUR FEET OF SEWER AT POINTS OF INTERFERENCE WITH POLES, CASE III, 5-172.
 - HOUSE LATERALS TO BE CONSTRUCTED WITH 1/2" RISE PER FOOT TO PROPERTY LINE, EXCEPT AS NOTED.
 - ALL STRUCTURES SHALL BE BRICK SEWER STRUCTURES, 5'-10" EXCEPT AS NOTED.
 - FOR ALLOWABLE LEAKAGE TEST USE FORMULA NO. 1, SPECS. SEC. 54.
 - MANHOLE TOPS IN UNIMPROVED RIGHTS-OF-WAY TO BE SIX INCHES ABOVE FINISHED GRADE.
 - THE CONTRACTOR SHALL NOTIFY THE CONSTRUCTION DIVISION BY TELEPHONE, MADISON 5-4741, EXT. 81-851 AT LEAST TWENTY-FOUR HOURS BEFORE STARTING ANY WORK UNDER THIS CONTRACT.
 - STANDARD SPECIFICATIONS DATED MAY 23, 1952 APPLY IN THE CONSTRUCTION OF THIS PROJECT.
 - THE PRIVATE ENGINEER SHALL FURNISH THE HOUSE LATERAL DEPTH AT THE PROPERTY LINE BELOW THE TOP OF CURB ELEVATION FOR EACH HOUSE LATERAL ON THE GRADE STREET.
 - ALL STATE AND LOCAL TRENCH SAFETY ORDERS WILL BE RIGIDLY ENFORCED.

Note: House connection permits to be secured from County Sanitation District before houses are connected.

Note:
 The Contractor Shall Notify Robert Powell of the County San. Dist. No. 11 by Telephone, NE 6-3097, 48 Hours Before Core Drilling the Trench For Lots 7 & 8.

NO CHARGE FOR CONNECTIONS
 John D. Rose

PROFILE ALIGNMENT AND GRADE OF P.C. 6298
 SANITARY SEWERS PAGE 1
 TO BE CONSTRUCTED IN J.N. 0358.68
 P.C. 6298-B J.N. 0361.41
 TRACT NO. 26969

PRIVATE CONTRACT NO. 6298

W.S. 37
 2 SHEETS; 3 PAGES
 SCALE: VERT. 1" = 4'
 HORIZ. 1" = 40' JULY, 1962
 PREPARED IN THE OFFICES OF
 KEMMERER ENGR. CO. INC.
 BY: Robert R. Flores
 REG. C. E. NO. 11349

33103

FOR LEGEND SEE PLAN NO. S-A-64

NOTES:
 GRADES TO WHICH THIS IMPROVEMENT IS TO BE CONSTRUCTED ARE SHOWN ON PLANS AND PROFILES. GRADE POINTS FOR TOP OF CURBS, CENTER LINE OF STREETS, OR CENTER LINE OF ALLEYS ARE SHOWN BY CIRCLES ON PROFILES. AT ALL POINTS BETWEEN DESIGNATED POINTS THE GRADE SHALL BE ESTABLISHED SO AS TO CONFORM TO A STRAIGHT LINE DRAWN BETWEEN SAID DESIGNATED POINTS.
 ELEVATIONS ARE IN FEET ABOVE U.S.C. & G.S. SEA LEVEL DATUM OF 1929.
 THIS DRAWING AND THE DATA HEREON ARE HEREBY MADE A PART OF THE SPECIFICATIONS.
 WORK SHALL BE CONSTRUCTED ACCORDING TO SPECIFICATIONS ON FILE IN THE OFFICE OF THE COUNTY ENGINEER AND SHALL BE PROSECUTED ONLY IN THE PRESENCE OF THE COUNTY ENGINEER.
 BEFORE WORK CAN BE STARTED, THE CONTRACTOR MUST OBTAIN A PERMIT TO EXCAVATE IN COUNTY STREETS FROM THE L.A. COUNTY ROAD DEPT., DISTRICT OFFICE NO. 4 AND PAY A FEE TO THE COUNTY ENGINEER ROOM 300 COUNTY ENGINEER BUILDING, 100 N. 1ST ST. SUFFICIENT TO COVER THE COST OF CONSTRUCTION INSPECTION AND RECORD PLANS.
 APPROVAL OF THIS PLAN BY THE COUNTY OF LOS ANGELES DOES NOT CONSTITUTE A REPRESENTATION AS TO THE ACCURACY OF THE LOCATION OF OR THE EXISTENCE OR NON-EXISTENCE OF ANY UNDERGROUND UTILITY PIPE, OR STRUCTURE WITHIN THE LIMITS OF THIS PROJECT. THIS NOTE APPLIES TO ALL PAGES.
 IF WORK IS TO BE DONE IN A STATE HIGHWAY, A PERMIT MUST BE OBTAINED FROM THE STATE OF CALIFORNIA, DIVISION OF HIGHWAYS, 120 SOUTH SPRING STREET.

COUNTY OF LOS ANGELES, CALIFORNIA

APPROVED, JOHN A. LAMBIE, COUNTY ENGINEER APPROVED, J.D. MURPHY, CHIEF ENGINEER
 BY: Paul S. Klein ASST. SANITATION ENGINEER BY: J. D. Murphy OFFICE ENGINEER
 CHECKED BY: S.W. Under 10-23-62
 OFFICE OF COUNTY ENGINEER, REG. C. E. NO. 9426

SUBMITTED BY: Robert R. Flores 10-10-62
 LOS CERRITOS REGIONAL ENGINEER RES. C.E. NO. 3871

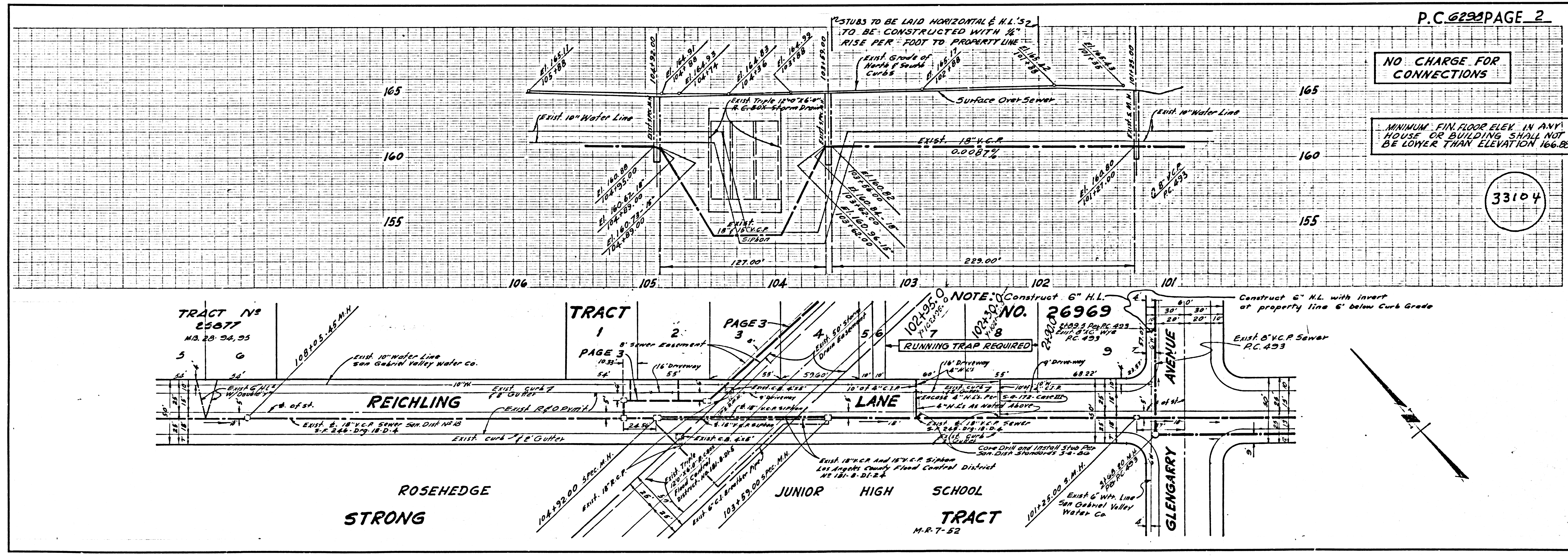

NO CHARGE FOR CONNECTIONS

MINIMUM FIN. FLOOR ELEV. IN ANY
 HOUSE OR BUILDING SHALL NOT
 BE LOWER THAN ELEVATION 166.88

33104

