

B.M. AZ 48, F.B. 1926-37
 N.W. Corner Fourth Ave & Proctor Ave. Boat Spk
 in conc driveway to House # 261, 115' W of Fourth
 Ave
 1952 Adj. Elev. 301.502

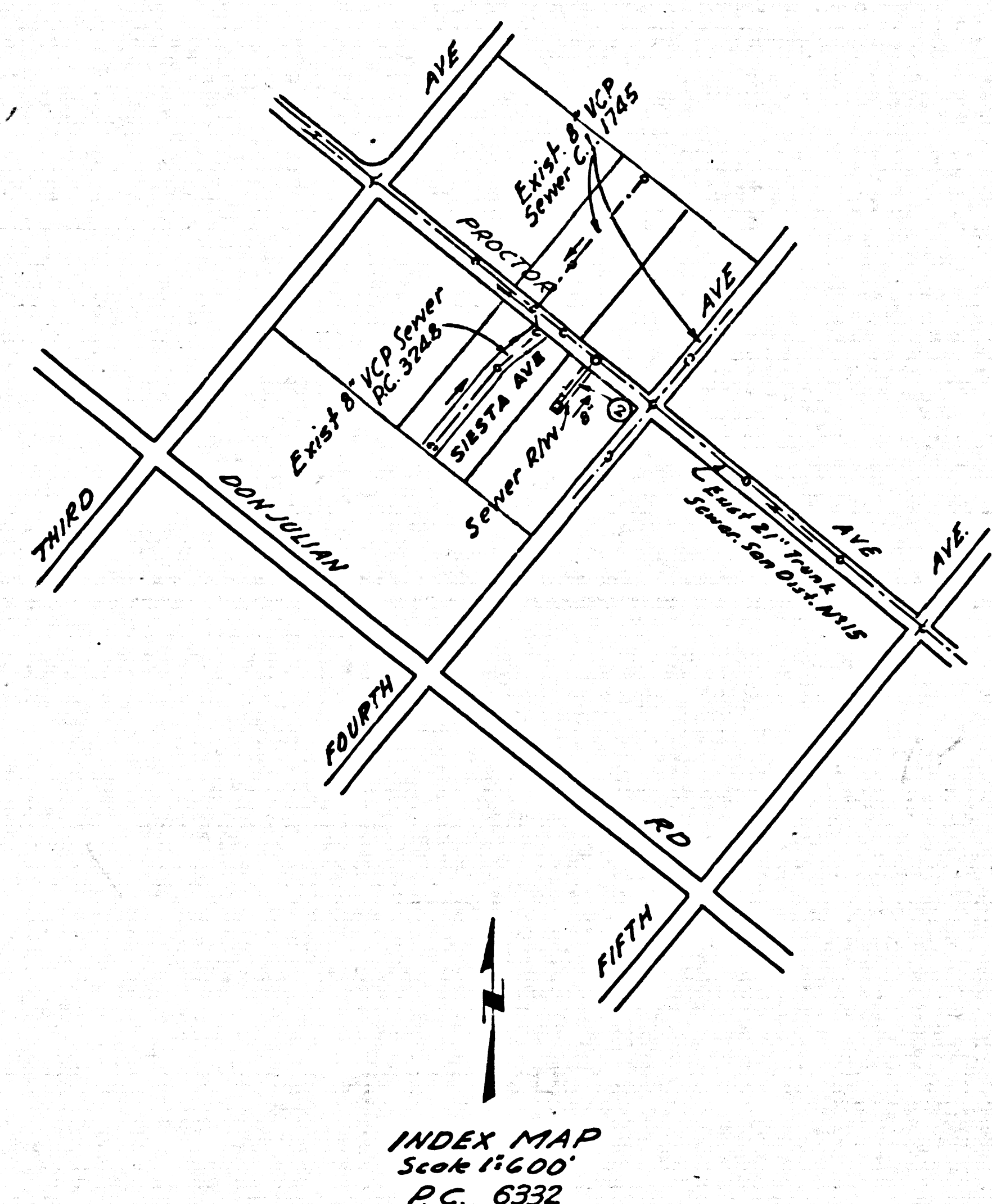

PUENTE BLDG. DIST. NO. 2

- NOTES:
1. PROVIDE STAKES ON THE PROPERTY LINE OR PROPERTY LINES PRODUCED AT RIGHT ANGLES TO THE SEWER LINE AT THE CENTER LINE OF EACH MANHOLE.
 2. NO REPRESENTATIVE OF THE COUNTY ENGINEER WILL SURVEY OR LAY OUT ANY PORTION OF THE WORK.
 3. THE PRIVATE ENGINEER SHALL FURNISH THE COUNTY ENGINEER WITH GRADE SHEETS AND STATIONING FOR ALL HOUSE LATERALS AND Y BRANCHES AND SHALL PROVIDE STAKES FOR THEM AT THEIR PROPER LOCATIONS WITH STATIONING PLAINLY MARKED. ANY CHANGE IN ALIGNMENT SHALL BE REQUESTED IN WRITING BY THE PRIVATE ENGINEER.
 4. THE PRIVATE ENGINEER SHALL FURNISH THE HOUSE LATERAL DEPTH AT THE PROPERTY LINE BELOW THE TOP OF CURB ELEVATION FOR EACH HOUSE LATERAL ON THE GRADE SHEET.
 5. NO REVISIONS SHALL BE MADE IN THESE PLANS WITHOUT THE APPROVAL OF THE COUNTY ENGINEER.
 6. USE STANDARD MANHOLE FRAMES AND COVERS, 5'-11".
 7. USE EXTRA STRENGTH PIPE, ALL PIPE STANDARD DEPTH EXCEPT AS NOTED.
 8. USE MECHANICAL COMPRESSION JOINTS FOR ALL V.C.P. JOINTS PER SPECS. SECS. 34, 4, 49.
 9. RESURFACE ALL TRENCH WITHIN PAVED AREA TO MEET L.A. COUNTY ROAD DEPT. OR CALIF. STATE HIGHWAY REQUIREMENTS IN ACCORDANCE WITH PERMITS.
 10. IF A POWER POLE IS WITHIN THREE FEET OF THE SEWER THE POLE SHALL BE ENCASED, PER S-172 CASE III, TWO FEET ON EITHER SIDE FROM POINT OF INTERFERENCE.
 11. MANHOLE SHALL BE BRICK SEWER STRUCTURE PER S-9-104 EXCEPT AS NOTED.
 12. FOR ALLOWABLE LEAKAGE TEST USE FORMULA NO. 1, SPECS. SEC. 34.
 13. THE CONTRACTOR SHALL NOTIFY THE SANITATION DISTRICT FIELD DIVISION BY TELEPHONE, MADISON 5-4741, AT LEAST TWENTYFOUR HOURS BEFORE STARTING ANY WORK UNDER THIS CONTRACT.
 14. ALL STATE AND LOCAL TRENCH SAFETY ORDERS WILL BE RIGIDLY ENFORCED.
 15. WHENEVER GROUND WATER IS ENCOUNTERED DURING THE CONSTRUCTION OF THE SEWERS THE V.C.P. JOINTS SHALL BE OF JOINT COMPOUND PER SPECS. SEC. 33 (48) OR MECHANICAL COMPRESSION JOINTS, PER SPECS. SEC. 34.
 16. IF DURING THE COURSE OF CONSTRUCTION IT IS DETERMINED THAT THERE IS LESS THAN FOUR FEET OF COVER OVER THE TOP OF THE MAIN LINE OR HOUSE LATERAL V.C.P. SEWER WHICH IS NOT INDICATED ON THE PLANS THIS PIPE SHALL BE ENCASED PER S-172, CASE III, UNLESS OTHERWISE APPROVED BY THE COUNTY ENGINEER.
 17. ALL WORK ON SANITATION DISTRICT LINES SHALL BE DONE IN ACCORDANCE WITH SANITATION DISTRICT SPECIFICATIONS.
 18. THE CONTRACTOR SHALL NOTIFY THE SANITATION DISTRICT FIELD DIVISION ENGINEER (THE ROBERT POWELL) NEVADA 6-3037, 48 HOURS PRIOR TO BEGINNING OF CONSTRUCTION.

COLLECT CHARGES
 AS INDICATED
 PR Smith

NO CONNECTIONS FOR THE DISPOSAL OF INDUSTRIAL WASTES SHALL BE MADE TO SEWERS SHOWN ON THESE DRAWINGS WITHOUT WRITTEN PERMISSION FROM THE CHIEF ENGINEER AND GENERAL MANAGER OF THE COUNTY SANITATION DISTRICTS.

TO BE CONSTRUCTED IN
 SANITARY SEWER RIGHT OF WAY
 WEST OF FOURTH AVENUE

PRIVATE CONTRACT NO. 6332

W.S. 37
 1 SHEET ; 2 PAGES
 SCALE: VERT. 1"=4'
 HORIZ. 1"=40'
 JULY, 1962
 PREPARED IN THE OFFICES OF
 ADAMS AND ELLS
 CIVIL ENGINEERS
 REG. C. E. NO. 10880
 FOR LEGEND SEE PLAN NO. S-A-64

32817

NOTE:
 GRADES TO WHICH THIS IMPROVEMENT IS TO BE CONSTRUCTED ARE SHOWN ON PLANS AND PROFILES. GRADE POINTS FOR TOP OF CURBS, CENTER LINE OF STREETS, OR CENTER LINE OF ALLEYS ARE SHOWN BY CIRCLES ON PROFILES AT ALL POINTS BETWEEN DESIGNATED POINTS THE GRADE SHALL BE ESTABLISHED SO AS TO CONFORM TO A STRAIGHT LINE DRAWN BETWEEN SAID DESIGNATED POINTS.
 ELEVATIONS ARE IN FEET ABOVE U.S.C. & G.S. SEA LEVEL DATUM OR 1929 SPECIFICATIONS
 THIS DRAWING AND THE DATA HEREON ARE HEREBY MADE A PART OF THE SPECIFIC CONTRACT.
 WORK SHALL BE CONSTRUCTED ACCORDING TO STANDARDS ON FILE IN THE OFFICE OF THE COUNTY ENGINEER AND SHALL BE PROSECUTED ONLY IN THE PRESENCE OF THE COUNTY ENGINEER.
 BEFORE WORK CAN BE STARTED, THE CONTRACTOR MUST OBTAIN A PERMIT TO EXCAVATE IN COUNTY STREETS FROM THE L.A. COUNTY ROAD DEPT., DISTRICT OFFICE NO. 1 AND 247-A 115-70 THE COUNTY ENGINEER, ROOM 330 COUNTY ENGINEERS BLDG., 408 W 2ND ST., SUFFICIENT TO COVER THE COST OF CONSTRUCTION INSPECTION AND RECORD PLANS.
 APPROVAL OF THIS PLAN BY THE COUNTY OF LOS ANGELES DOES NOT CONSTITUTE A REPRESENTATION AS TO THE ACCURACY OF THE LOCATION OF OR THE EXISTENCE OR NON-EXISTENCE OF ANY UNDERGROUND UTILITY PIPE, OR STRUCTURE WITHIN THE LIMITS OF THIS PROJECT. THIS NOTE APPLIES TO ALL PAGES.
 IF WORK IS TO BE DONE IN A STATE HIGHWAY, A PERMIT MUST BE OBTAINED FROM THE STATE OF CALIFORNIA, DIVISION OF HIGHWAYS, 120 SOUTH SPRING STREET.

COUNTY OF LOS ANGELES, CALIFORNIA
 APPROVED BY: JOHN A. LAMBIE, COUNTY ENGINEER
 APPROVED BY: JOHN D. PARKHURST, CHIEF ENGINEER
 DO. SAN. DIST. NO. 15
 ASSISTANT SANITATION ENGINEER BY: [Signature]
 OFFICE ENGINEER
 SUBMITTED BY: W.C. Reinhardt 11-13-62
 SAN DIMAS REGIONAL ENGINEER REG. C. E. NO. 2413
 CHECKED BY: [Signature] 11-13-62
 REG. C. E. NO. 9406

JN10358.92

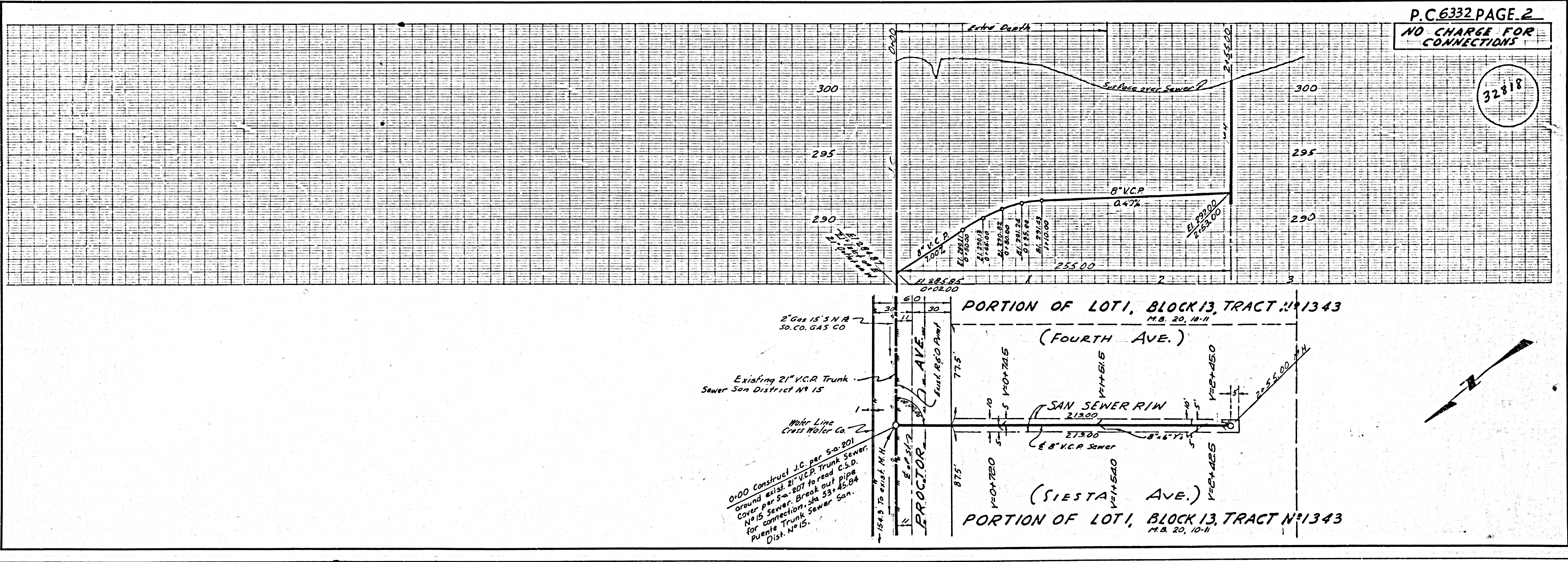

R/M W/O FOURTH AVE. P.C. 6332

W/O FOURTH AVE. P.C. 6332