

B.M. 5Y 3213 ELEV. 131.661  
 Fd. Lgt. S. cd. Watcher St. 31'  
 W. of cb ref. @ S.W. cor.  
 Watcher St. & Eastern Ave.  
 RIVERA QUAD. 1955

COMMERCE BLDG. DIST. NO. 6.01

PROFILE ALIGNMENT AND GRADE OF  
 SANITARY SEWERS PAGE 1  
 TO BE CONSTRUCTED IN

RANDOLPH STREET  
 (PRIVATE STREET)  
 PRIVATE CONTRACT NO. 6490

W.S. 36, A-5

1 SHEET, 2 PAGES  
 SCALE: VERT. 1"=4'  
 HORIZ. 1"=40' FEB, 1963

PREPARED IN THE OFFICES OF  
 OLSON SURVEYING SERVICE

By: *Earl A. P. Plakos*  
 REG. C. E. NO. 7820

FOR LEGEND SEE PLAN NO. S-64

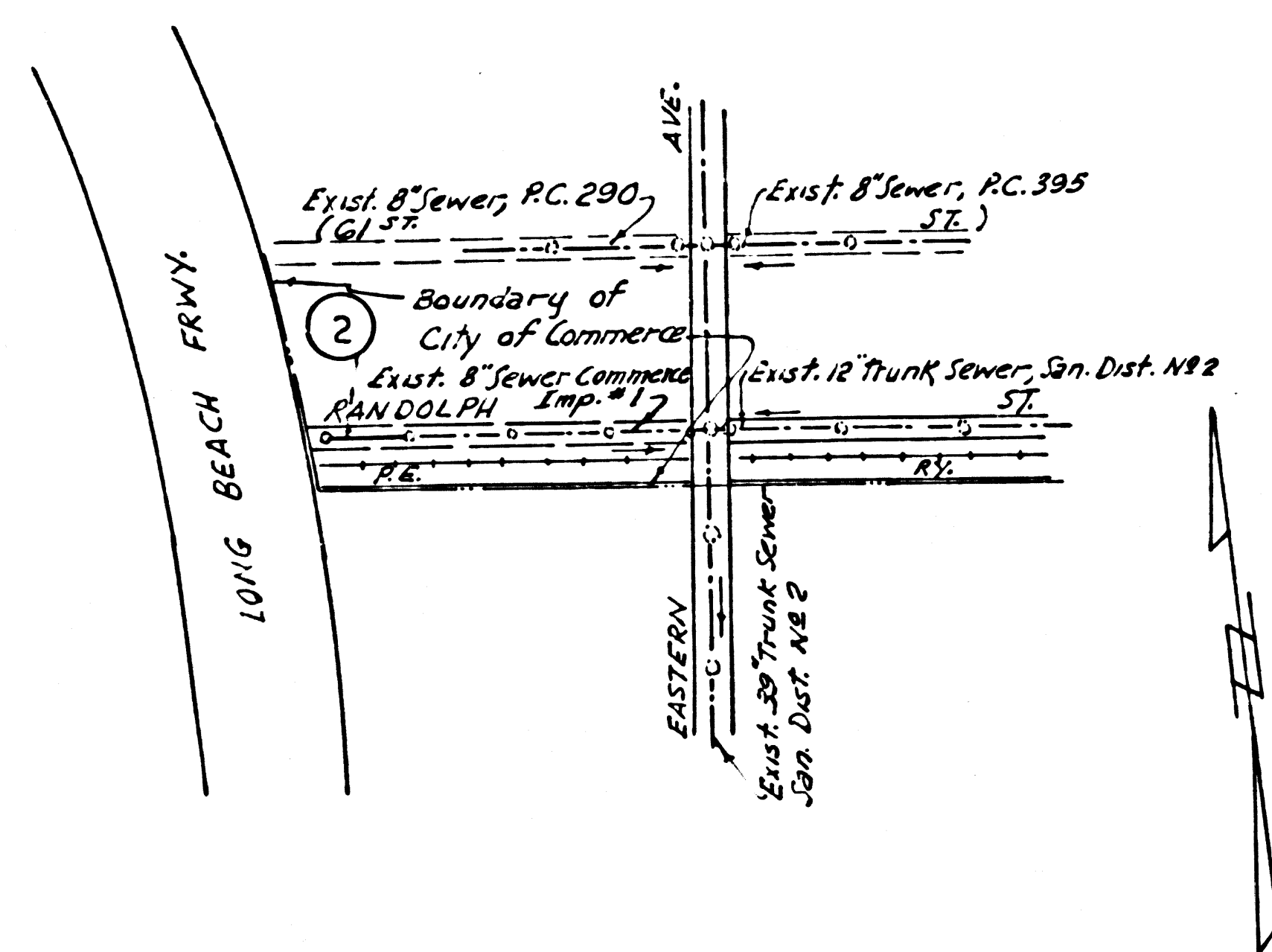

INDEX MAP  
 P.C. 6490  
 Scale 1"=600'

Revision:  
 Changed Manhole from Sta 13+01.75  
 to Sta 13+10.25 Date 9-4-64  
 Approved: *[Signature]*  
 Office of City Engineer

NO CONNECTIONS FOR THE DISPOSAL OF  
 INDUSTRIAL WASTES SHALL BE MADE TO  
 SEWERS SHOWN ON THESE DRAWINGS  
 WITHOUT WRITTEN PERMISSION FROM THE  
 CHIEF ENGINEER AND GENERAL MANAGER  
 OF THE COUNTY SANITATION DISTRICTS

APPROVED: *[Signature]* DATE: 5-10-63  
 INDUSTRIAL WASTE DIVISION

COLLECT CHARGES  
 AS INDICATED  
*R. Pearce* 3/21/63

NOTE:  
 GRADES TO WHICH THIS IMPROVEMENT IS TO BE CONSTRUCTED ARE SHOWN ON PLANS AND PROFILES. GRADE POINTS FOR TOP OF CURBS, CENTER LINE OF STREETS, OR CENTER LINE OF ALLEYS ARE SHOWN BY CIRCLES ON PROFILES. AT ALL POINTS BETWEEN DESIGNATED POINTS THE GRADE SHALL BE ESTABLISHED SO AS TO CONFORM TO A STRAIGHT LINE DRAWN BETWEEN SAID DESIGNATED POINTS. ELEVATIONS ARE IN FEET ABOVE U.S.C. & G.S. SEA LEVEL DATUM OF 1929.  
 THIS DRAWING AND THE DATA HEREON ARE HEREBY MADE A PART OF THE SPECIFICATIONS.  
 BEFORE WORK CAN BE STARTED, THE CONTRACTOR MUST OBTAIN A PERMIT TO EXCAVATE IN CITY STREETS FROM THE L.A. COUNTY ROAD DEPT., DISTRICT OFFICE NO. 11, AND MAKE A DEPOSIT WITH THE CITY OF COMMERCE SUFFICIENT TO COVER THE COST OF CONSTRUCTION INSPECTION AND RECORD PLANS.  
 APPROVAL OF THIS PLAN BY THE CITY OF COMMERCE DOES NOT CONSTITUTE A REPRESENTATION AS TO THE ACCURACY OF THE LOCATION OF OR THE EXISTENCE OR NON-EXISTENCE OF ANY UNDERGROUND UTILITY PIPE, OR STRUCTURE WITHIN THE LIMITS OF THIS PROJECT. THIS NOTE APPLIES TO ALL PAGES.  
 IF WORK IS TO BE DONE IN A STATE HIGHWAY, A PERMIT MUST BE OBTAINED FROM THE STATE OF CALIFORNIA, DIVISION OF HIGHWAYS, 120 SOUTH SPRING STREET, LOS ANGELES, CALIFORNIA.

CITY OF COMMERCE, CALIFORNIA  
 JOHN A. LAMBIE, CITY ENGINEER  
 J. D. PARKHURST, CHIEF ENGINEER  
 CO. SAN. DIST. NO. 11  
 APPROVED BY: *[Signature]* OFFICE ENGINEER

APPROVED BY: *[Signature]*  
 ASSISTANT SANITATION ENGINEER

SUBMITTED BY: *[Signature]*  
 MECHANICAL ENGINEER

CHECKED BY: *[Signature]* 5-14-63  
 REG. C. E. NO. 9406

36050

P. C. 6490 PAGE 2  
 COLLECT CHARGES  
 AS INDICATED

36051

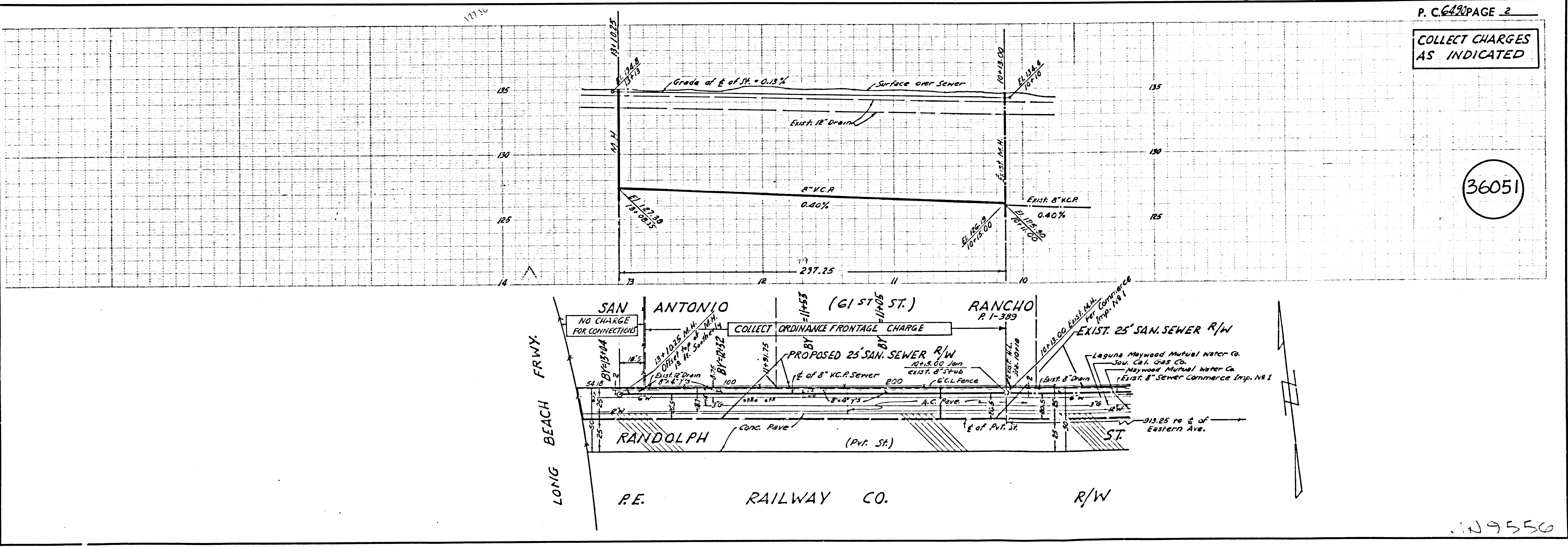

129550