

B.M. 57.3032 ELEV. 45.749
 City of Los Angeles Eng. Man.
 @ 8 Int. Normandie &
 Francisco St. 1500 S. E. Knox St.
 GARDENA QUAD. 1960

DOUBLE SCALE
 LENNOX BLDG. DIST. NO. 7

PROFILE ALIGNMENT AND GRADE OF
 SANITARY SEWERS PAGE 1

TO BE CONSTRUCTED IN
 NORMANDIE AVE.

PRIVATE CONTRACT NO. 6516

W.S. 26
 1 SHEET 2 PAGES
 SCALE: VERT. 1"=8'
 HORIZ. 1"=20'
 MARCH, 1963
 PREPARED IN THE OFFICE OF
 J. H. EDWARDS CO.
 16905 S. Western Avenue, 24 78583
 Gardena, California
 REG. C. E. NO. 11302

33923

- NOTE:
- PROVIDE STAKES ON THE PROPERTY LINE OR PROPERTY LINES PRODUCED AT RIGHT ANGLES TO THE SEWER LINE AT THE CENTER LINE OF EACH MANHOLE.
 - NO REPRESENTATIVE OF THE COUNTY ENGINEER WILL SURVEY OR LAY OUT ANY PORTION OF THE WORK.
 - THE PRIVATE ENGINEER SHALL FURNISH THE COUNTY ENGINEER WITH GRADE SHEETS AND STATIONING FOR ALL HOUSE LATERALS AND Y BRANCHES AND SHALL PROVIDE THE PROPER LOCATIONS WITH SHOWN ON THE PLANS. HOUSE LATERALS FROM CHIMNEYS SHALL NOT HAVE AN ANGLE OF LESS THAN 45° WITH THE EXISTING SEWER. ANY CHANGE OF ATTACHMENT SHALL BE REQUESTED IN WRITING BY THE PRIVATE ENGINEER.
 - THE PRIVATE ENGINEER SHALL FURNISH THE HOUSE LATERAL DEPTH AT THE PROPERTY LINE FROM THE TOP OF CURB ELEVATION FOR EACH HOUSE LATERAL TO THE MANHOLE.
 - NO REVISIONS SHALL BE MADE IN THESE PLANS WITHOUT THE APPROVAL OF THE COUNTY ENGINEER.
 - THE CONTRACTOR SHALL NOTIFY THE CONSTRUCTION DIVISION BY TELEPHONE, MADISON 9-4747, EXT. 81551, AT LEAST TWENTY-FOUR HOURS BEFORE STARTING ANY WORK UNDER THIS CONTRACT.
 - MANHOLES SHALL BE BRICK SEWER STRUCTURES PER S-104. PRECAST CONCRETE MANHOLES PER S-100 OR S-105 MAY BE USED AS AN ALTERNATE IN LOCATIONS APPROVED BY THE COUNTY ENGINEER.
 - USE STANDARD MANHOLE FRAMES AND COVERS PER S-107 EXCEPT AS NOTED.
 - MANHOLE TOPS IN UNIMPROVED AREAS OF WAYS TO BE SIX INCHES ABOVE FINISHED GRADE.
 - USE EXTRA STRENGTH PIPE. ALL PIPE IS EXTRA DEPTH.
 - USE MECHANICAL COMPRESSION JOINTS FOR ALL V.C.P. JOINTS PER SPEC. SECT. 34, 43 & 49.
 - WHERE EVER GROUND WATER IS ENCOUNTERED DURING THE CONSTRUCTION OF THE SEWER, THE CONTRACTOR SHALL BE RESPONSIBLE FOR PROTECTING THE SAME AND FOR THE MECHANICAL COMPRESSION JOINTS PER SPEC. 34-43.
 - IF A POWER POLE IS WITHIN THREE FEET OF THE SEWER, THE SEWER SHALL BE ENCASED, PER S-173, CASE III, TWO FEET ON EACH SIDE FROM THE POINT OF INTERFERENCE.
 - IF DURING THE COURSE OF CONSTRUCTION IT IS DETERMINED THAT THERE IS LESS THAN FOUR FEET OF COVER OVER THE TOP OF A MAIN LINE OR HOUSE LATERAL V.C.P. SEWER WHICH IS NOT INDICATED ON THE PLANS, THE PIPE SHALL BE ENCASED PER S-173, CASE III, UNLESS OTHERWISE APPROVED BY THE COUNTY ENGINEER.
 - HOUSE LATERALS TO BE CONSTRUCTED WITHIN UNIMPROVED AREAS TO MEET L.A. COUNTY ROAD DEPT. OR CALIFORNIA STATE HIGHWAY REQUIREMENTS IN ACCORDANCE WITH PERMITS, EXCEPT AS NOTED.
 - FOR ALLOWABLE LEAKAGE TEST USE FORMULA NO. 2, SPEC. SEC. 54.
 - RESURFACE TRENCH IN NORMANDIE AVE IN ACCORDANCE WITH REQUIREMENTS OF THE CITY OF LOS ANGELES.
 - ALL STATE AND LOCAL TRENCH SAFETY ORDINANCES WILL BE STRICTLY ENFORCED.

NOTE:
 GRADES TO WHICH THIS IMPROVEMENT IS TO BE CONSTRUCTED ARE SHOWN ON PLANS AND PROFILES. GRADE POINTS FOR TOP OF CURBS, CENTER LINE OF STREETS, OR CENTER LINE OF ALLEYS ARE SHOWN BY CIRCLES ON PROFILES AT ALL POINTS BETWEEN DESIGNATED POINTS. THE GRADE SHALL BE ESTABLISHED SO AS TO CONFORM TO A STRAIGHT LINE DRAWN BETWEEN SAID DESIGNATED POINTS. ELEVATIONS ARE IN FEET ABOVE U.S.C. & G.S. SEA LEVEL DATUM OF 1929.
 THIS DRAWING AND THE DATA HEREON ARE HEREBY MADE A PART OF THE SPECIFICATIONS.
 BEFORE WORK CAN BE STARTED, THE CONTRACTOR MUST OBTAIN A PERMIT TO EXCAVATE IN COUNTY STREETS FROM THE L.A. COUNTY ROAD DEPT., DISTRICT OFFICE NO. 5, AND PAY A FEE TO THE COUNTY ENGINEER, ROOM 300, COUNTY ENGINEERING BUILDING, 104 WEST SECOND STREET OR ADELE S. HARRIS, COUNTY REGIONAL OFFICE, SUFFICIENT TO COVER THE COST OF CONSTRUCTION INSPECTION AND RECORD PLANS.
 APPROVAL OF THIS PLAN BY THE COUNTY OF LOS ANGELES DOES NOT CONSTITUTE A REPRESENTATION AS TO THE ACCURACY OF THE LOCATION OF OR THE EXISTENCE OR NON-EXISTENCE OF ANY UNDERGROUND UTILITY PIPE, OR STRUCTURE WITHIN THE LIMITS OF THIS PROJECT. THIS NOTE APPLIES TO ALL PAGES.
 IF WORK IS TO BE DONE IN A STATE HIGHWAY, A PERMIT MUST BE OBTAINED FROM THE STATE OF CALIFORNIA, DIVISION OF HIGHWAYS, 126 SOUTH SPRING STREET, LOS ANGELES, CALIFORNIA.

BEFORE BREAKING INTO ANY EXISTING STRUCTURE AND BEFORE FINAL ACCEPTANCE OF THIS WORK, COUNTY SANITATION DISTRICT (DU 4-1281) SHALL BE NOTIFIED IN ORDER THAT REQUIRED INSPECTION CAN BE MADE.

COLLECT CHARGES
 AS INDICATED
Edith A. Scott

COUNTY OF LOS ANGELES, CALIFORNIA
 JOHN A. LAMBIE, COUNTY ENGINEER
 APPROVED BY: *J. D. Parkhurst*
 SUBMITTED BY: *Jack S. ...*
 CHECKED BY: *Mike ...*
 REG. C. E. NO. 2665

J. D. PARKHURST, CHIEF ENGINEER
 CO. SAN DIST NO. 5
 That portion of the 12" sewer shown hereon as being constructed within the 20' R/W of County Sanitation District No. 5 shall be operated and maintained by said Sanitation District No. 5.

J.N. 0360.01

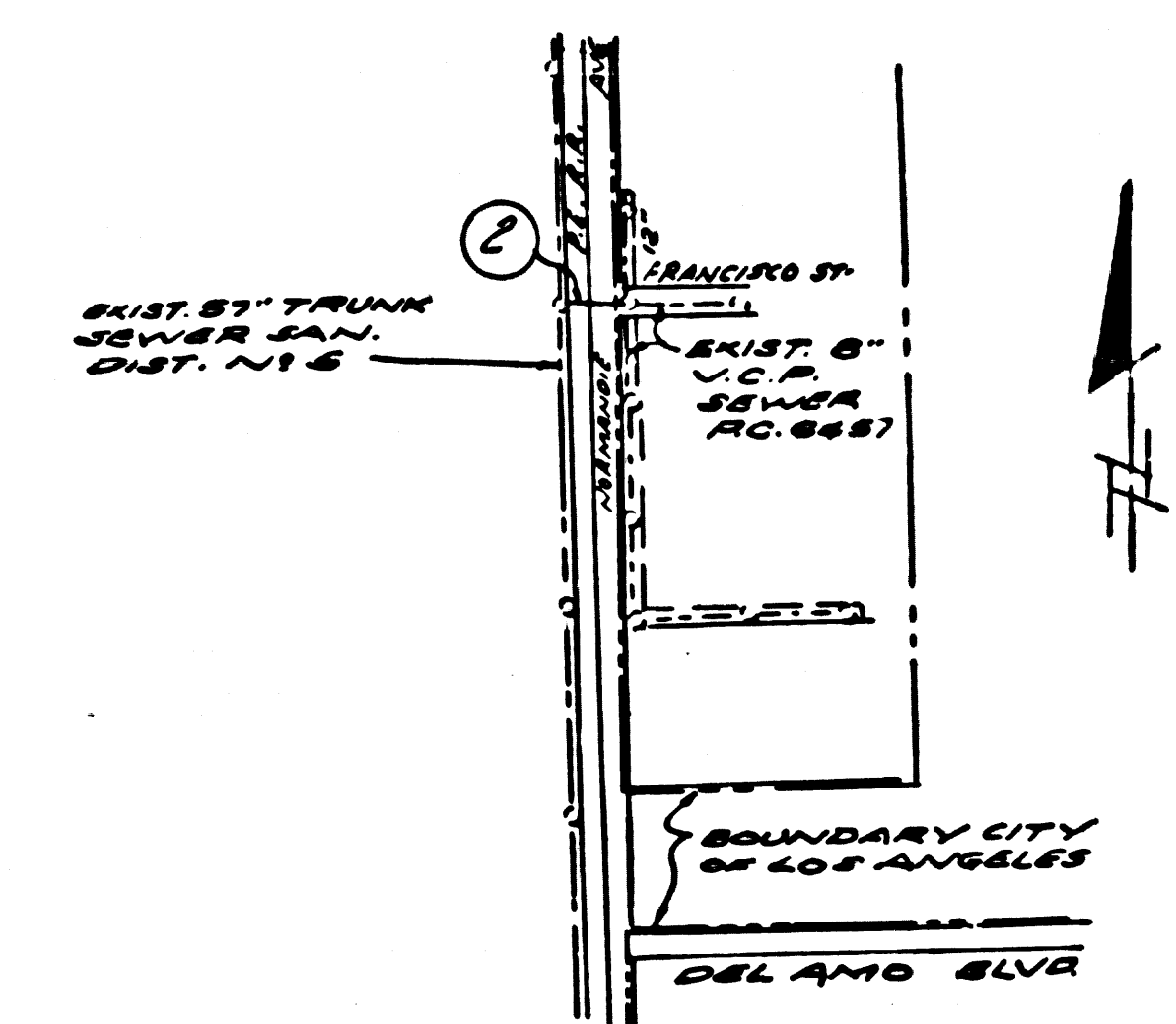

INDEX MAP
 P.C. 6516
 SCALE: 1"=600'

APPROVED
Joe P. ... 6-5-63
 INDUSTRIAL WASTE DIVISION - COUNTY ENGINEER

CITY OF LOS ANGELES
 Submitted July 29, 1963
 By *CM Allright* District Engineer
Herbert B. Brown Deputy Engineer (Design)
 Approved July 30, 1963
George A. ... City Engineer

P. C. 6516 PAGE 2
 DOUBLE SCALE
 ISSUE NO PERMITS

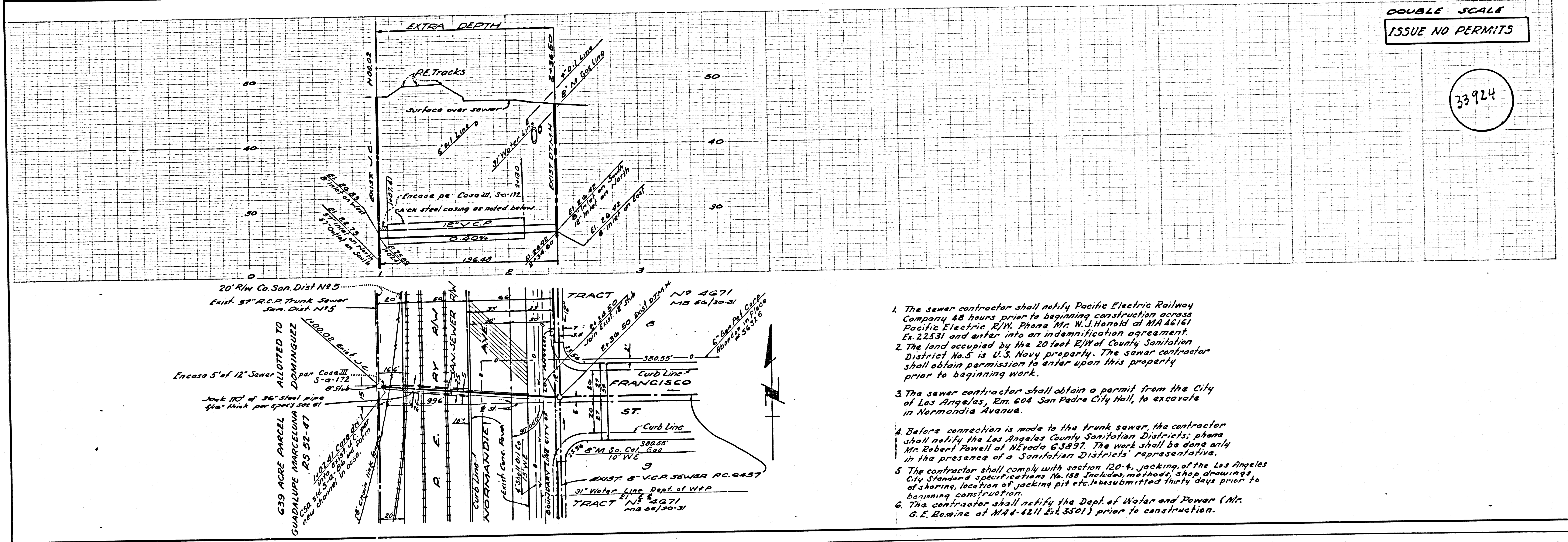

33924

- The sewer contractor shall notify Pacific Electric Railway Company 48 hours prior to beginning construction across Pacific Electric R/W. Phone Mr. W.J. Harold at MA 46161 Ext. 2231 and enter into an indemnification agreement.
- The land occupied by the 20' R/W of County Sanitation District No. 5 is U.S. Navy property. The sewer contractor shall obtain permission to enter upon this property prior to beginning work.
- The sewer contractor shall obtain a permit from the City of Los Angeles, Rm. 604 San Pedro City Hall, to excavate in Normandie Avenue.
- Before connection is made to the trunk sewer, the contractor shall notify the Los Angeles County Sanitation Districts; phone Mr. Robert Powell at NEyoda 63897. The work shall be done only in the presence of a Sanitation Districts' representative.
- The contractor shall comply with section 120-4, jacking of the Los Angeles City Standard specifications No. 158. Includes methods, shop drawings of shoring, location of jacking pit etc. to be submitted thirty days prior to beginning construction.
- The contractor shall notify the Dept. of Water and Power (Mr. G. E. Rowine at MA 4-4211 Ext. 3501) prior to construction.