

B.M. S.G. 1534 ELEV. 229.022
 P.I. L&T in conc. cb. ± 1'E. of B.C.P. N.E. cor.
 of Rush St. & Potrero Ave. ± 45' E. of
 Potrero Ave. ± 30' W. of Rush St.
 Whittier QUAD. 1955

SOUTH EL MONTE BLDG. DIST. NO. 5.04

PROFILE ALIGNMENT AND GRADE OF P.C. 6578
SANITARY SEWERS PAGE 1
 TO BE CONSTRUCTED IN
**SANITARY SEWER RIGHT-OF-WAY
 WEST OF POTRERO AVE.**

PRIVATE CONTRACT NO. 6578

W.S. 37
 SHEET 1 OF 2 PAGES
 SCALE: VERT. 1" = 4'
 HORIZ. 1" = 40' APRIL 1963
 PREPARED IN THE OFFICES OF
ADAMS AND ELLS
 CIVIL ENGINEERS
 BY: *William C. Adams*
 REG. C. E. NO. 10880
 FOR LEGEND SEE PLAN NO. S-64

33562

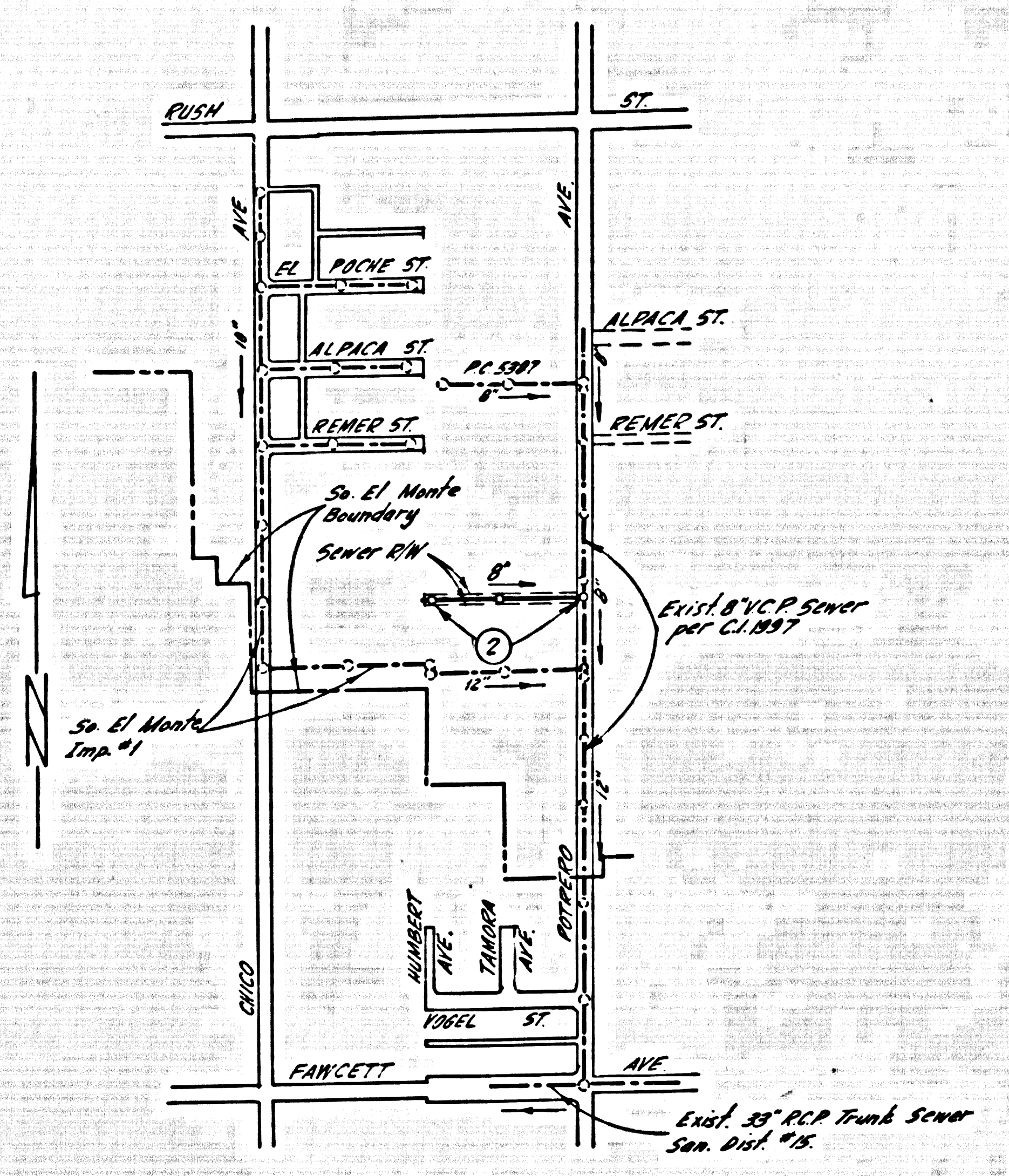

- NOTES:
1. PROVIDE STAKES ON THE PROPERTY LINE OR PROPERTY LINES PRODUCED AT RIGHT ANGLES TO THE SEWER LINE AT THE CENTER LINE OF EACH MANHOLE.
 2. NO REPRESENTATIVE OF THE CITY ENGINEER WILL SURVEY OR LAY OUT ANY PORTION OF THE WORK.
 3. THE PRIVATE ENGINEER SHALL FURNISH THE CITY ENGINEER WITH GRADE SHEETS AND STATIONING FOR ALL HOUSE LATERALS AND Y BRANCHES AND SHALL PROVIDE STAKES FOR THEM AT THEIR PROPER LOCATIONS WITH STATIONING PLAINLY MARKED. ALL HOUSE LATERALS SHALL BE CONSTRUCTED IN A STRAIGHT ALIGNMENT AT RIGHT ANGLES FROM THE MAIN LINE SEWER EXCEPT AS SHOWN ON THE PLANS. HOUSE LATERALS FROM CHIMNEYS SHALL NOT HAVE AN ANGLE OF LESS THAN 45° WITH THE MAIN LINE SEWER. ANY CHANGE IN ALIGNMENT SHALL BE REQUESTED IN WRITING BY THE PRIVATE ENGINEER.
 4. THE PRIVATE ENGINEER SHALL FURNISH THE HOUSE LATERAL DEPTH AT THE PROPERTY LINE BELOW THE TOP OF CURB ELEVATION FOR EACH HOUSE LATERAL ON THE GRADE SHEET.
 5. NO REVISIONS SHALL BE MADE IN THESE PLANS WITHOUT THE APPROVAL OF THE CITY ENGINEER.
 6. THE CONTRACTOR SHALL NOTIFY THE CONSTRUCTION DIVISION BY TELEPHONE, MADISON 9-4747, EXT. 8158, AT LEAST TWENTY-FOUR HOURS BEFORE STARTING ANY WORK UNDER THIS CONTRACT.
 7. MANHOLES SHALL BE BRICK SEWER STRUCTURES PER S-2034. PRECAST CONCRETE MANHOLES PER S-115 OR S-173 MAY BE USED AS AN ALTERNATE IN LOCATIONS APPROVED BY THE CITY ENGINEER.
 8. USE STANDARD MANHOLE FRAMES AND COVERS, S-117.
 9. MANHOLE TOPS IN UNIMPROVED RIGHTS-OF-WAY TO BE SIX INCHES ABOVE FINISHED GRADE.
 10. USE EXTRA STRENGTH PIPE. ALL PIPE IS STANDARD DEPTH EXCEPT AS NOTED.
 11. USE MECHANICAL COMPRESSION JOINTS FOR ALL V.C.P. JOINTS PER SPECS., SECS. 36 & 48.
 12. WHERE EVER GROUND WATER IS ENCOUNTERED DURING THE CONSTRUCTION OF THE SEWERS, THE V.C.P. JOINTS SHALL BE OF JOINT COMPOUND PER SPECS., SECS. 33 & 48, OR MECHANICAL COMPRESSION JOINTS PER SPECS., SEC. 36.
 13. IF A POWER POLE IS WITHIN THREE FEET OF THE SEWER, THE SEWER SHALL BE ENCASED, PER S-172, CASE III, TWO FEET ON EITHER SIDE FROM THE POINT OF INTERFERENCE.
 14. IF DURING THE COURSE OF CONSTRUCTION IT IS DETERMINED THAT THERE IS LESS THAN FOUR FEET OF COVER OVER THE TOP OF A MAIN LINE OR HOUSE LATERAL V.C.P. SEWER WHICH IS NOT INDICATED ON THE PLANS, THE PIPE SHALL BE ENCASED PER S-172, CASE III, UNLESS OTHERWISE APPROVED BY THE CITY ENGINEER.
 15. HOUSE LATERALS TO BE CONSTRUCTED IN ACCORDANCE WITH THE SPECIFICATIONS OF THE CITY ENGINEER.
 16. RESURFACE ALL TRENCHES WITHIN PAVED AREAS TO MEET L.A. COUNTY ROAD DEPT. OR CALIFORNIA STATE HIGHWAY REQUIREMENTS IN ACCORDANCE WITH PERMITS.
 17. FOR ALLOWABLE LEAKAGE TEST USE FORMULA NO., SPECS., SEC. 54.
 18. ALL STATE AND LOCAL TRENCH SAFETY ORDERS WILL BE RIGIDLY ENFORCED.

APPROVED: *Edward R. Thompson* 5-29-63
 INDUSTRIAL WASTE DIVISION

NO CHARGE FOR CONNECTIONS
R. Pearce 5-27-63

CITY OF SOUTH EL MONTE, CALIFORNIA
 JOHN A. LAMBIE, CITY ENGINEER
 APPROVED BY: *John A. Lambie*
 SANITATION ENGINEER
 SUBMITTED BY: *W.C. Brindley*
 SAN GABRIEL VALLEY REGIONAL ENGINEER
 CHECKED BY: *J.K. Wanda* 7-11-63
 OFFICE OF CITY ENGINEER REG. C. E. NO. 3464

P. C. 6578 PAGE 2
 NO CHARGE FOR CONNECTIONS

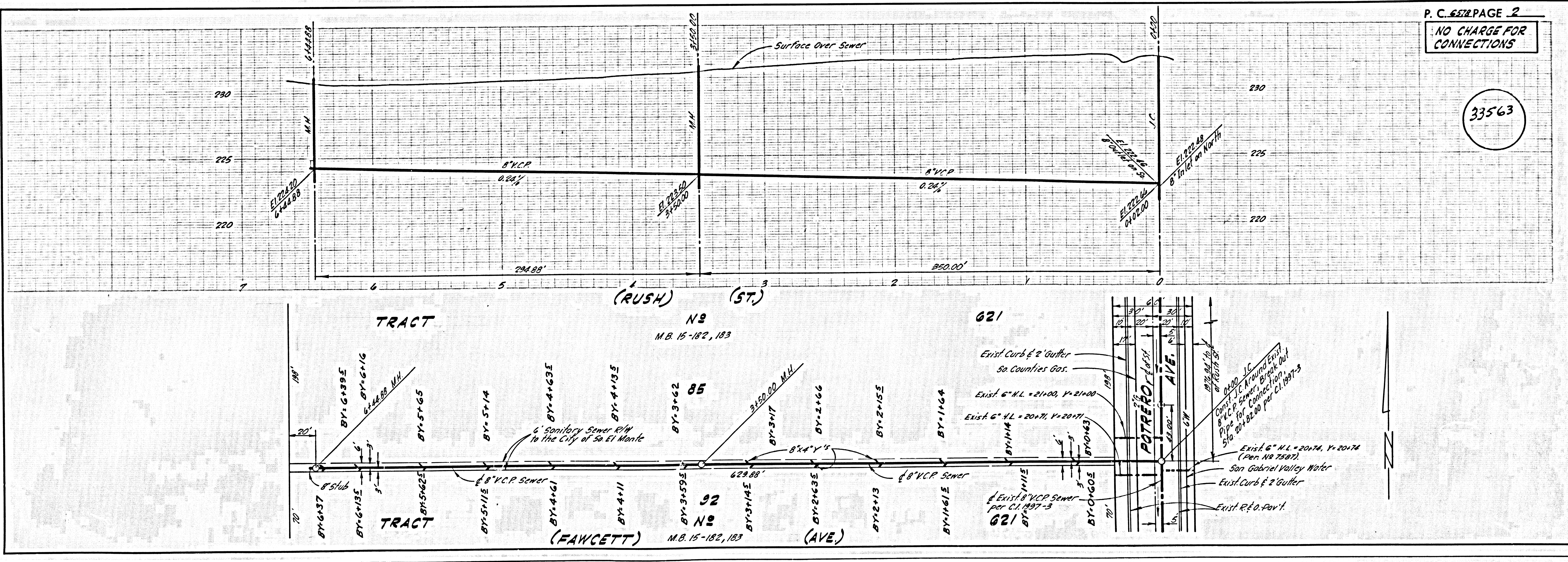

33563