

PARAMOUNT BLDG. DIST. NO. 4.04

COVER FOR EXISTING PUMP STATION
VICINITY OF ROSECRANS AVENUE AND ORANGE AVENUE
PRIVATE CONTRACT NO. 6581
W.S. 32
1 SHEETS, 2 PAGES
SCALE: AS SHOWN MAY 1, 1963

- NOTES:
1. RECORD STAKES ON THE PROPERTY LINE OR PROPERTY LINES PRODUCED AT RIGHT ANGLES TO THE SEWER LINE AT THE CENTER LINE OF EACH MANHOLE.
 2. NO REPRESENTATIVE OF THE CITY ENGINEER WILL SURVEY OR LAY OUT ANY PORTION OF THE WORK.
 3. THE MANHOLE ENGINEER SHALL FURNISH THE QUANTITY OF MATERIALS AND SUPPLIES FOR ALL ITEMS LISTED HEREIN AND SHALL FURNISH CHARGES FOR THE SAME AT THE PROPER LOCATION WITH THE WORKING PARTY. ALL ITEMS LISTED HEREIN SHALL BE CONSTRUCTED IN A STRAIGHT ALIGNMENT AT RIGHT ANGLES FROM THE MAIN LINE SEWER EXCEPT AS SHOWN ON THE PLANS. HOUSE LATERALS FROM EXISTING SEWERS SHALL NOT BE DELETED OR 180° TURNED WITH THE MAIN LINE SEWER UNLESS OTHERWISE SPECIFIED BY THE ENGINEER.
 4. THE PRIVATE ENGINEER SHALL FURNISH THE HOUSE LATERAL SEWER AT THE PROPERTY LINE AND THE TOP OF CURB OR SEWER FOR EACH HOUSE LATERAL ON THE GRADE SHEET.
 5. NO REVISIONS SHALL BE MADE IN THESE PLANS WITHOUT THE APPROVAL OF THE CITY ENGINEER.
 6. THE CONTRACTOR SHALL NOTIFY THE CONSTRUCTION DIVISION BY TELEPHONE, MADISON 9-4747, EXT. 8153, AT LEAST TWENTY-FOUR HOURS BEFORE STARTING ANY WORK UNDER THIS CONTRACT.
 7. MANHOLES SHALL BE BUILT AS SHOWN ON THESE PLANS PER S-104. MANHOLE COVERS SHALL BE PER S-105 OR S-170 MAY BE USED AS AN ALTERNATE TO THE COVER SHOWN ON THESE PLANS.
 8. USE STANDARD MANHOLE FRAMES AND COVERS, S-107, EXCEPT AS NOTED.
 9. MANHOLE TOPS IN UNIMPAVED AREAS OF HIGHWAYS OR SIX INCHES ABOVE FINISHED GRADE.
 10. USE STEEL STANCHIONS ALL 4" X 4" X 1/4" OR 6" X 6" X 1/4" EXCEPT AS NOTED.
 11. USE CEMENT MORTAR OR MECHANICAL COMPRESSION JOINTS FOR ALL J.C.P. JOINTS PER SPEC. SEC. 24-3-A.
 12. UNLESS OTHERWISE NOTED, ALL JOINTS SHALL BE CONSTRUCTED IN ACCORDANCE WITH THE U.C.A. JOINTS SHALL BE OF JOINT COMPOUND PER SPEC. SEC. 20-3-A, OR MECHANICAL COMPRESSION JOINTS PER SPEC. SEC. 24.
 13. IF A POWER POLE IS WITHIN THREE FEET OF THE SEWER, THE SEWER SHALL BE ENCASED PER S-373, CASE III, TWO FEET ON SIDES AND FROM THE POINT OF INTERFERENCE.
 14. IF DURING THE COURSE OF CONSTRUCTION IT IS DETERMINED THAT THERE ARE LESS THAN FOUR FEET OF COVER OVER THE TOP OF A MAIN LINE OR HOUSE LATERAL PIPE OR CONDUIT WHICH IS NOT INDICATED ON THE PLANS, THE PIPE SHALL BE ENCASED PER S-373, CASE III, UNLESS OTHERWISE APPROVED BY THE COUNTY ENGINEER.
 15. HOUSE LATERALS TO BE CONSTRUCTED WITH INVERTS AT PROPERTY LINE. SEE SHOW-UP CURB CANCELS AS NOTED.
 16. SECURE ALL TRENCHES WITHIN PAVED AREAS TO MEET ALL COUNTY ROAD DEPT. OR CALIFORNIA STATE HIGHWAY REQUIREMENTS IN ACCORDANCE WITH PERMITS.
 17. FOR ALLOWABLE SEWAGE TEST USE FORMULA NO. 100 PER SPEC. SEC. 6-A.

PREPARED IN THE OFFICES OF
BOLE AND WILSON
ENGINEERS
730 E. THIRD STREET, LONG BEACH, CALIF.
BY: *James O. Bole*
REG. C. E. NO. 5283
FOR LEGEND SEE PLAN NO. S-6-64

34191

NOTE:
GRADES TO WHICH THIS IMPROVEMENT IS TO BE CONSTRUCTED ARE SHOWN ON PLANS AND PROFILES. GRADE POINTS FOR TOP OF CURBS, CENTER LINE OF STREETS, OR CENTER LINE OF ALLEYS ARE SHOWN BY CIRCLES ON PROFILES. AT ALL POINTS BETWEEN DESIGNATED POINTS THE GRADE SHALL BE ESTABLISHED SO AS TO CONFORM TO A STRAIGHT LINE DRAWN BETWEEN SAID DESIGNATED POINTS. ELEVATIONS ARE IN FEET ABOVE U.S.C. & G.S. SEA LEVEL DATUM OF 1929.
THIS DRAWING AND THE DATA HEREON ARE HEREBY MADE A PART OF THE SPECIFICATIONS. ON FILE IN THE OFFICE OF THE CITY ENGINEER AND SHALL BE PROSECUTED ONLY IN THE PRESENCE OF THE CITY ENGINEER.
BEFORE WORK CAN BE STARTED, THE CONTRACTOR MUST OBTAIN A PERMIT TO EXCAVATE IN COUNTY STREETS FROM THE L.A. COUNTY ROAD DEPT., DISTRICT OFFICE NO. 4, AND PAY A FEE TO THE CITY OF PARAMOUNT, 12115 PARK AVENUE, LONG BEACH, CALIF. SUFFICIENT TO COVER THE COST OF CONSTRUCTION INSPECTION AND RECORD PLANS.
APPROVAL OF THIS PLAN BY THE CITY OF PARAMOUNT DOES NOT CONSTITUTE A REPRESENTATION AS TO THE ACCURACY OF THE LOCATION OF OR THE EXISTENCE OR NON-EXISTENCE OF ANY UNDERGROUND UTILITY PIPE, OR STRUCTURE WITHIN THE LIMITS OF THIS PROJECT. THIS NOTE APPLIES TO ALL PAGES.
IF WORK IS TO BE DONE IN A STATE HIGHWAY, A PERMIT MUST BE OBTAINED FROM THE STATE OF CALIFORNIA, DIVISION OF HIGHWAYS, 126 SOUTH SPRING STREET, LOS ANGELES, CALIFORNIA.

CITY OF PARAMOUNT, CALIFORNIA
JOHN A. LAMBIE, CITY ENGINEER
APPROVED BY: *James O. Bole*
ASSISTANT SANITATION ENGINEER
APPROVED: _____
APPROVED, MAINTENANCE BRANCH
CHECKED BY: *Bernard J. Valenty*
REG. C. E. NO. 10653
BY: *Carl H. Pore*
REG. C. E. NO. 10687

COLLECTY CHARGES AS INDICATED

J.N. 0864.22

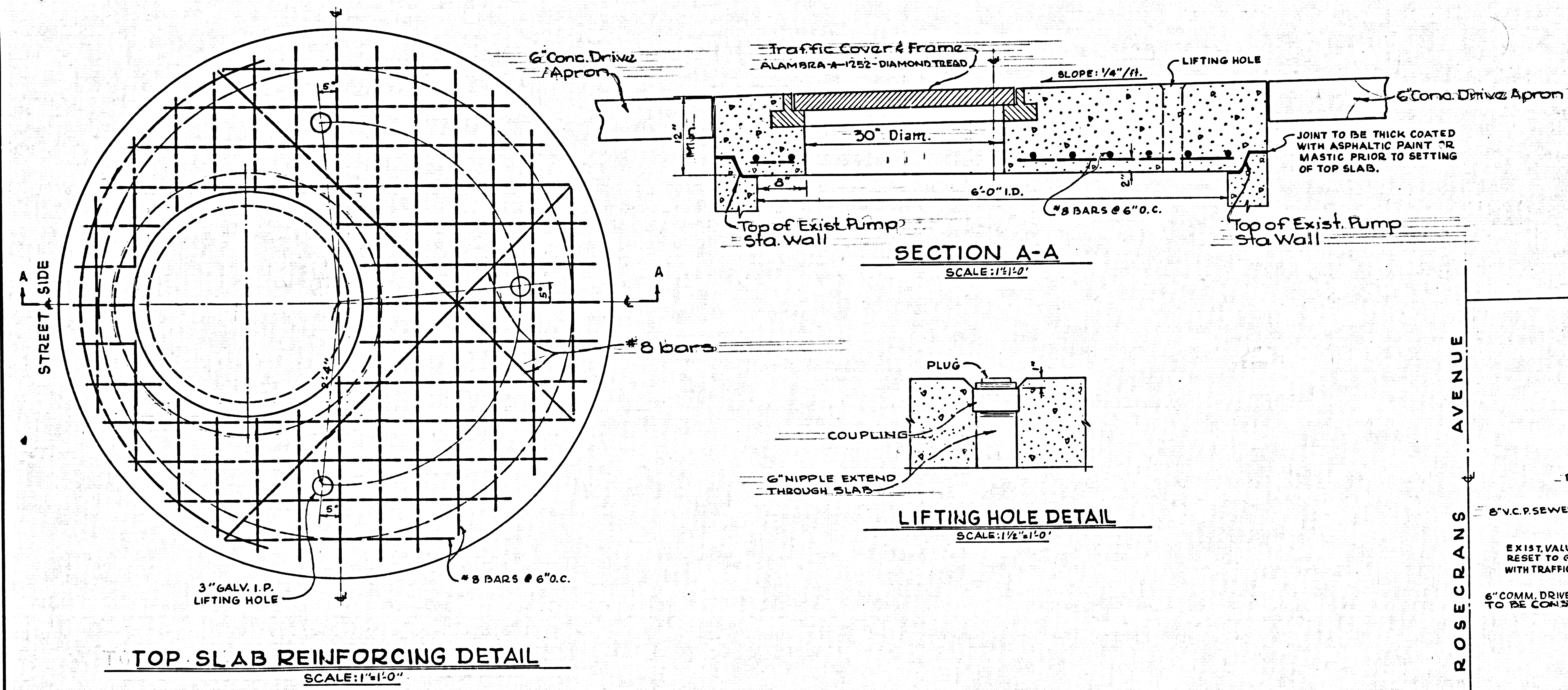

GENERAL NOTES

USE DEFORMED BARS INTERMEDIATE GRADE.
ULTIMATE CONC. STRESS (28 DAYS) $f_c = 3,000$ psi.
ALLOWABLE STEEL STRESS $f_s = 20,000$ psi.
ALL STEEL REINFORCEMENT TO HAVE MINIMUM COVER OF 2 INCHES.
POSITION MANHOLE COVER OVER $\frac{1}{2}$ OF STEPS TO PROVIDE ACCESS TO PUMP STATION.

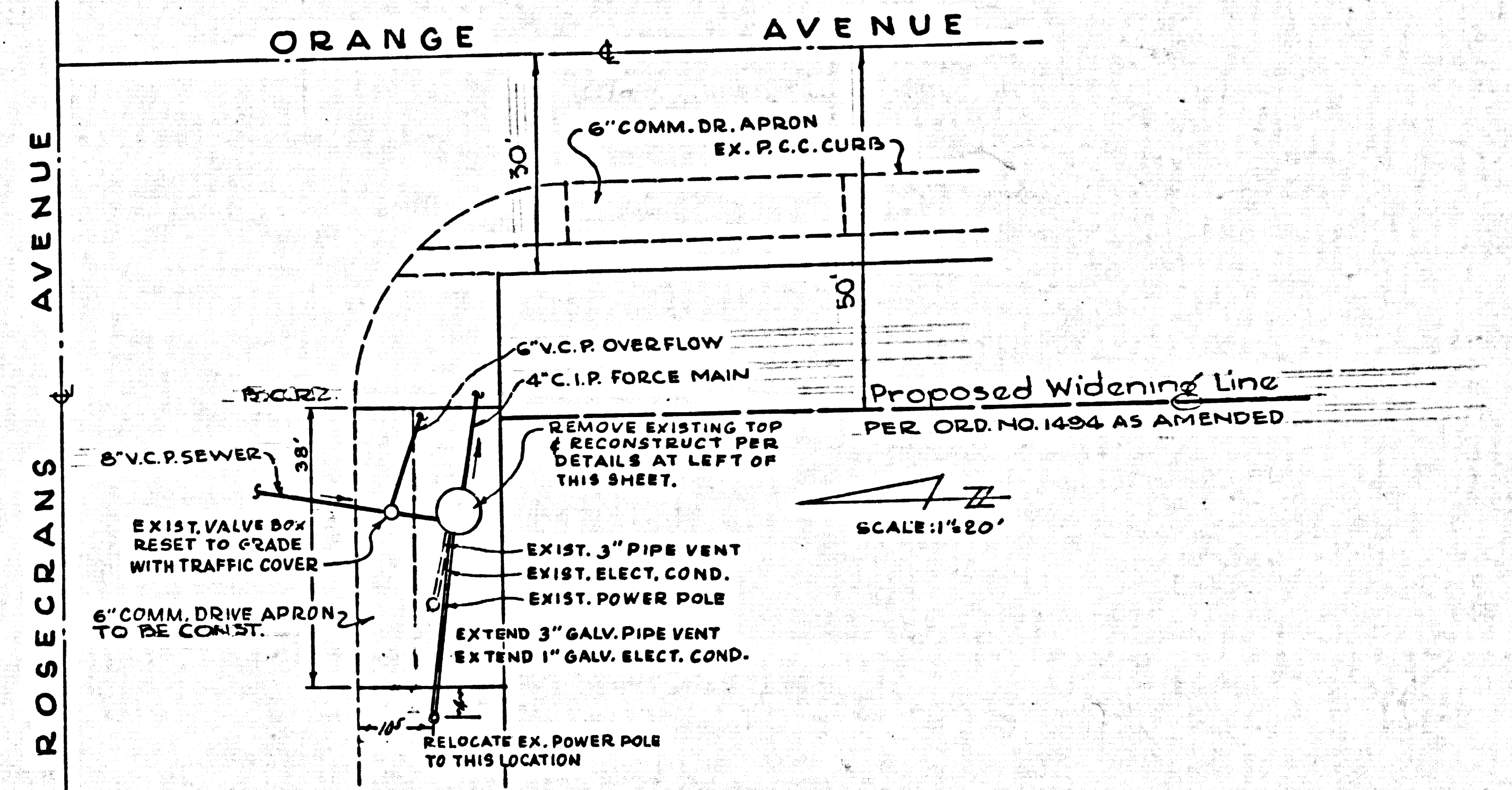

P. C. 6581 PAGE 2

34192