

**LA PUENTE BLDG. DIST. NO. 2**

**PRIVATE CONTRACT NO. 6702**

W.S. 37  
 1 SHEET : 2 PAGES  
 SCALE: VERT. 1" = 4'  
 HORIZ. 1" = 40'  
 SEPTEMBER, 1963  
 PREPARED IN THE OFFICES OF  
**NATIONAL ENGINEERING COMPANY**  
 By: *J. Epperson* REG. C. E. NO. 5928  
 FOR LEGEND SEE PLAN NO. S-A-64

33983

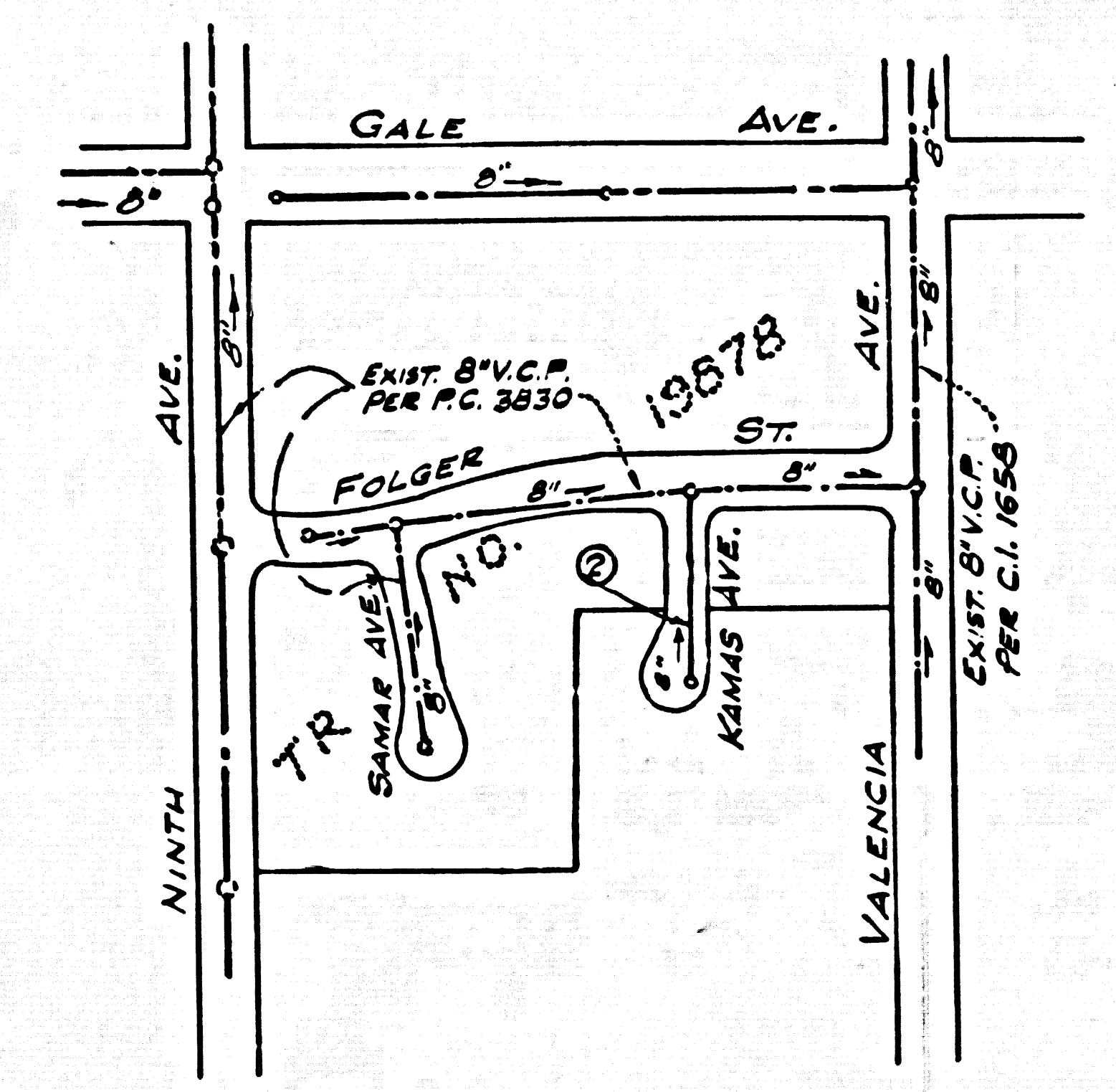

**Index Map**  
 SCALE 1" = 200'  
 P.C. NO. 6702

19. STANDARD SPECIFICATION DATED MAY 23, 1962  
 APPLY IN THE CONSTRUCTION OF THIS PROJECT.

- NOTES:**
1. PROVIDE STAKES ON THE PROPERTY LINE OR PROPERTY LINES PRODUCED AT RIGHT ANGLES TO THE SEWER LINE AT THE CENTER LINE OF EACH MANHOLE.
  2. NO REPRESENTATIVE OF THE COUNTY ENGINEER WILL SURVEY OR LAY OUT ANY PORTION OF THE WORK.
  3. THE OWNER OR HIS AUTHORIZED REPRESENTATIVE SHALL FURNISH THE COUNTY ENGINEER WITH GRADE SHEETS AND STATIONINGS FOR ALL HOUSE LATERALS AND Y BRANCHES AND SHALL PROVIDE STAKES FOR THEM AT THEIR PROPER LOCATIONS WITH STATIONINGS PLAINLY MARKED. ANY CHANGE IN LOCATION SHALL BE REQUESTED IN WRITING BY THE OWNER OR HIS REPRESENTATIVE.
  4. THE PRIVATE ENGINEER SHALL FURNISH THE HOUSE LATERAL DEPTH AT THE PROPERTY LINE BELOW THE TOP OF CURB ELEVATION FOR EACH HOUSE LATERAL ON THE GRADE SHEET.
  5. NO REVISIONS SHALL BE MADE IN THESE PLANS WITHOUT THE APPROVAL OF THE COUNTY ENGINEER.
  6. USE STANDARD MANHOLE FRAMES AND COVERS, 1-117.
  7. USE EXTRA STRENGTH PIPE. ALL PIPE IS STANDARD DEPTH.
  8. USE CEMENT MORTAR OR MECHANICAL COMPRESSION JOINTS FOR ALL V.C.P. PER SPECS. SECS. 36 & 40, IN MAINLINE ONLY.
  9. RESURFACE ALL TRENCH WITHIN PAVED AREA TO MEET L.A. COUNTY ROAD DEPT. OR CALIF. STATE HIGHWAY REQUIREMENTS IN ACCORDANCE WITH PERMITS.
  10. ENCASE FOUR FEET OF SEWER AT POINTS OF INTERFERENCE WITH POLES, CASE III, 1-172.
  11. HOUSE LATERALS TO BE CONSTRUCTED WITH INVERTS AT PROPERTY LINE 6 FEET BELOW CURB GRADE.
  12. ALL MANHOLES SHALL BE BRICK SEWER STRUCTURES 3'-0" PRECAST CONC. MANHOLES PER S-8-155 OR S-8-173 MAY BE USED AS AN ALTERNATE IN LOCATIONS APPROVED BY THE COUNTY ENGINEER.
  13. FOR ALLOWABLE LEAKAGE TEST USE FORMULA NOTED IN SPECS. SEC. 34.
  14. USE MECHANICAL COMPRESSION JOINTS FOR ALL V.C.P. HOUSE LATERALS PER SPECS. SECS. 36 & 40.
  15. THE CONTRACTOR SHALL NOTIFY THE CONSTRUCTION DIVISION BY TELEPHONE, MADISON 9-4747, EXT. 8956 AT LEAST TWENTY-FOUR HOURS BEFORE STARTING ANY WORK UNDER THIS CONTRACT.
  16. UNLESS GROUNDWATER IS ENCOUNTERED DURING THE CONSTRUCTION OF THE SEWERS, THE J.C.P. JOINTS SHALL BE OF JOINT COMPOUND PER SPECS. SECS. 33 & 40, OR MECHANICAL COMPRESSION JOINTS PER SPECS. SEC. 36.
  17. IF DURING THE COURSE OF THE CONSTRUCTION IT IS DETERMINED THAT THERE IS LESS THAN FOUR (4) FEET OF COVER OVER THE TOP OF THE MAIN LINE OR HOUSE LATERAL V.C.P. SEWER WHICH IS NOT INDICATED ON THE PLANS, THE PIPE SHALL BE ENCASED PER S-8-172, CASE III, UNLESS OTHERWISE APPROVED BY THE COUNTY ENGINEER.
  18. ALL STATE AND LOCAL TRENCH SAFETY ORDERS WILL BE RIGIDLY ENFORCED.

**BENCH MARK :** SG. - 1339

L & B. N. 1/4' EAST OF CURB RETURN  
 AT N.E. CORNER OF GALE AVENUE  
 AND VALENCIA AVENUE.

BASELINE QUAD 1955 ELEV. 324.835

ISSUE NO HOUSE CONNECTION  
 PERMITS UNTIL KAMAS AVENUE  
 IS DEDICATED

**COLLECT CHARGES AS  
 INDICATED.**  
*Harold W. King 9-25-63*

NO CONNECTIONS FOR THE DISPOSAL OF  
 INDUSTRIAL WASTES SHALL BE MADE TO  
 SEWERS SHOWN ON THESE DRAWINGS  
 WITHOUT WRITTEN PERMISSION FROM  
 THE CHIEF ENGINEER AND GENERAL MAN-  
 AGER OF THE COUNTY SANITATION DISTRICTS.

**NOTE:**  
 GRADES TO WHICH THIS IMPROVEMENT IS TO BE CONSTRUCTED ARE SHOWN ON PLANS AND PROFILES. GRADE POINTS FOR TOP OF CURB, CENTER LINE OF STREETS, OR CENTER LINE OF ALLEYS ARE SHOWN BY CIRCLES ON PROFILES AT ALL POINTS BETWEEN DESIGNATED POINTS THE GRADE SHALL BE ESTABLISHED SO AS TO CONFORM TO A STRAIGHT LINE DRAWN BETWEEN SAID DESIGNATED POINTS.  
 ELEVATIONS ARE IN FEET ABOVE U.S.C. & G.S. SEA LEVEL DATUM OF 1929.  
 THIS DRAWING AND THE DATA HEREON ARE HEREBY MADE A PART OF THE SPECIFICATIONS.  
 WORK SHALL BE CONSTRUCTED ACCORDING TO SPECIFICATIONS ON FILE IN THE OFFICE OF THE COUNTY ENGINEER AND SHALL BE PROSECUTED ONLY IN THE PRESENCE OF THE COUNTY ENGINEER.  
 BEFORE WORK CAN BE STARTED THE CONTRACTOR MUST OBTAIN A PERMIT TO EXCAVATE IN COUNTY STREETS FROM THE L.A. COUNTY ROAD DEPT., DISTRICT OFFICE NO. 1, AND PAY A FEE TO THE COUNTY ENGINEER, ROOM 310, 108 W. 2ND ST., LOS ANGELES, SUFFICIENT TO COVER THE COST OF CONSTRUCTION INSPECTION AND RECORD PLANS.  
 APPROVAL OF THIS PLAN BY THE COUNTY OF LOS ANGELES DOES NOT CONSTITUTE A REPRESENTATION AS TO THE ACCURACY OF THE LOCATION OF OR THE EXISTENCE OR NON-EXISTENCE OF ANY UNDERGROUND UTILITY PIPE, OR STRUCTURE WITHIN THE LIMITS OF THIS PROJECT. THIS NOTE APPLIES TO ALL PAGES.  
 IF WORK IS TO BE DONE IN A STATE HIGHWAY, A PERMIT MUST BE OBTAINED FROM THE STATE OF CALIFORNIA, DIVISION OF HIGHWAYS, 120 SOUTH SPRING STREET.

**COUNTY OF LOS ANGELES, CALIFORNIA**  
 APPROVED, JOHN A. LAMBIE, COUNTY ENGINEER APPROVED, J.D. PARKHURST, CHIEF ENGINEER  
 CO. SAN. DIST. NO. 15  
 BY: *John S. Kelen* ASSISTANT SANITATION ENGINEER BY: *J. D. Parkhurst* OFFICE ENGINEER  
 CHECKED BY: *W. W. King* 10-5-63  
 OFFICE OF COUNTY ENGINEER, REG. C. E. NO. 7136  
 SUBMITTED: *Harold W. King 10-5-63*  
 SAN DIMAS REGIONAL ENGINEER  
 J.N. 036137

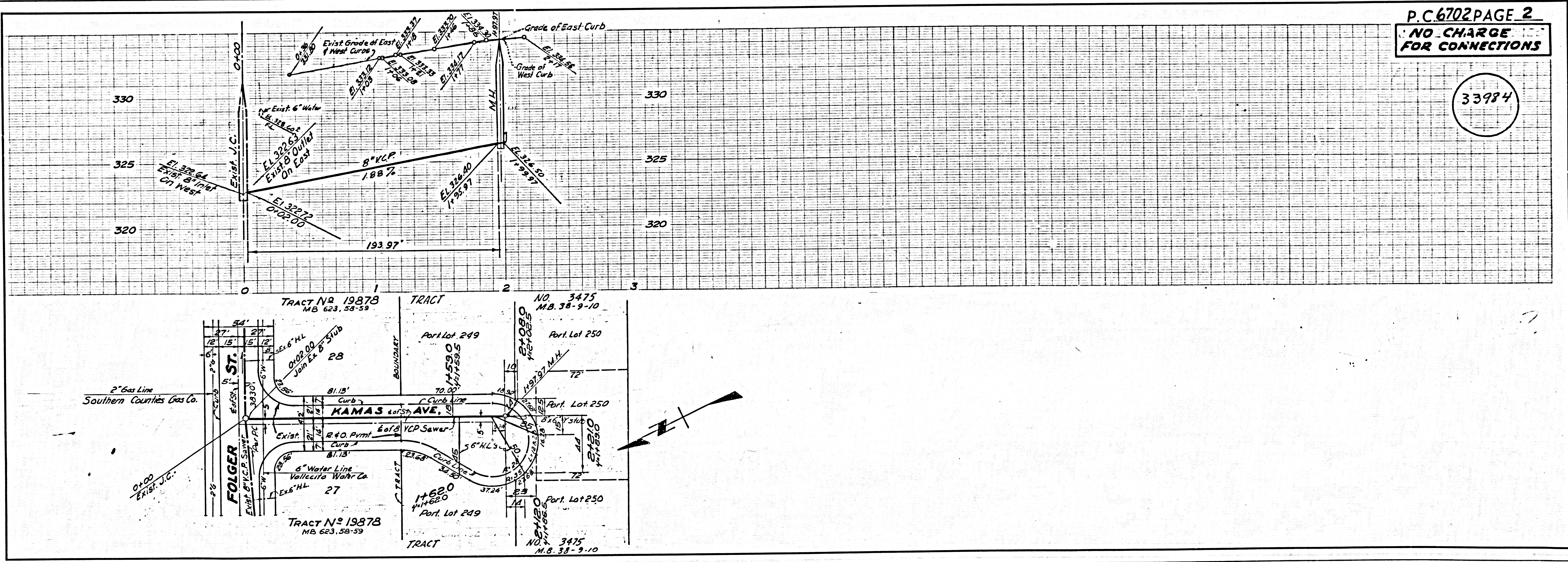

**P.C. 6702 PAGE 2**  
**NO CHARGE  
 FOR CONNECTIONS**

33984