

B.M. LE 114 ELEV. 670.280
 In P.B. 2705 pg. 204, Jeolier Ave.
 E. side 63.5' No. of 4 of Cienega
 Ave. Bolt Spt. in curb 5' So. of Bldg.
 of c/d 800 in front of No. 5058
 QUAD. 19 63

SAN DIMAS BLDG. DIST. NO. 10

PROFILE ALIGNMENT AND GRADE OF
SANITARY SEWERS PAGE 1
 TO BE CONSTRUCTED IN
ARROW HIGHWAY

PRIVATE CONTRACT NO. 6742

W.S. 48
 1 SHEET, 2 PAGES
 SCALE: VERT. 1"=4' HORIZ. 1"=40'
 OCTOBER, 1963
 PREPARED IN THE OFFICES OF

34208

RUSS CONNORS & ASSOCIATES
 WA-21257
 REG. C. E. NO. 2921

FOR LEGEND SEE PLAN NO. S-64

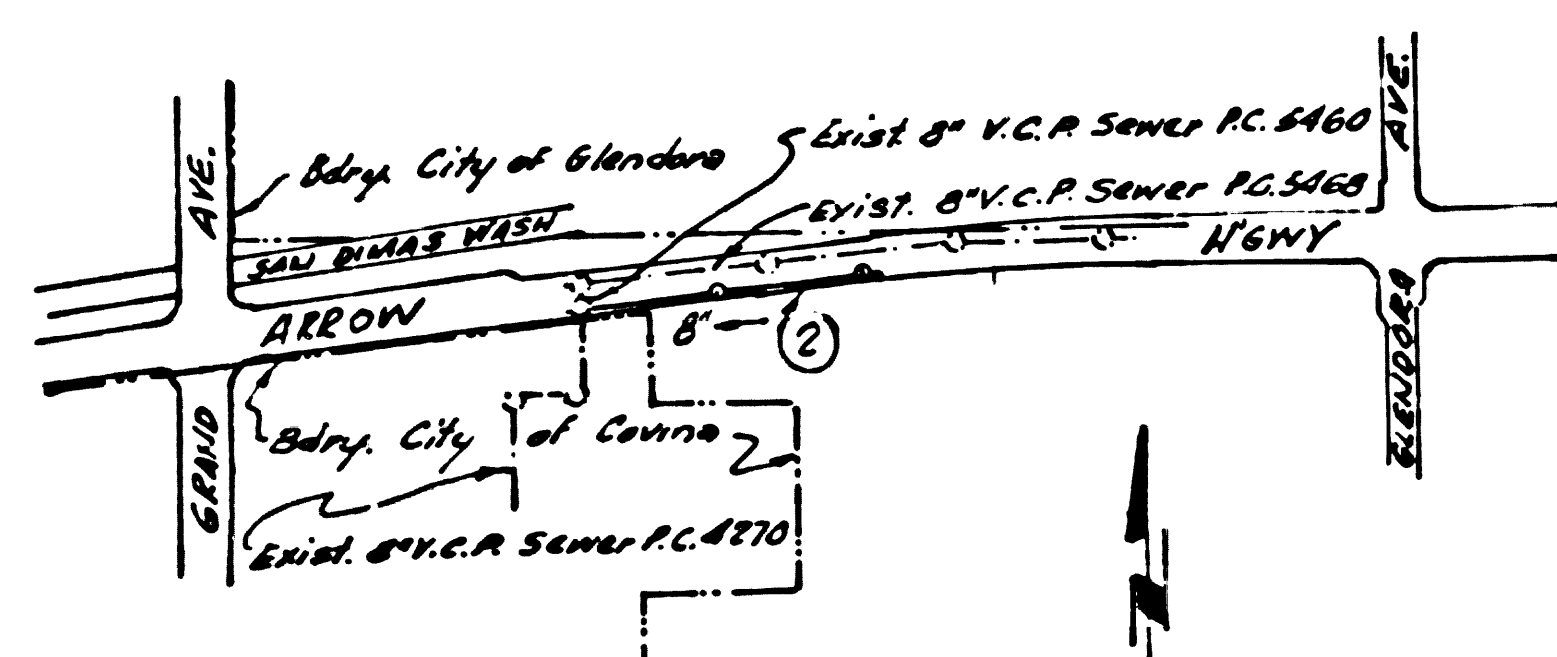

Scale 1"=600'
 INDEX MAP
 P.C. 6742

REVISION
 Relocate Sewer Line 12 Feet off
 South Property Line. Add Horizontal
 Curve from Sta. 1+35.60 to 1+62.75 and
 Raise Sewer Grade.
 Approved: *[Signature]*
 R.C.E. 116367-237-12-7-63

COLLECT CHARGES
 AS INDICATED
[Signature]

NO CONNECTIONS FOR THE DISPOSAL OF
 INDUSTRIAL WASTES SHALL BE MADE TO
 SEWERS SHOWN ON THESE DRAWINGS
 WITHOUT WRITTEN PERMISSION FROM THE
 CHIEF ENGINEER AND GENERAL MANAGER
 OF THE COUNTY SANITATION DISTRICTS

NOTE:
 GRADES TO WHICH THIS IMPROVEMENT IS TO BE CONSTRUCTED ARE SHOWN ON PLANS AND PROFILES. GRADE POINTS FOR TOP OF
 CURBS, CENTER LINE OF STREETS, OR CENTER LINE OF ALLEYS ARE SHOWN BY CIRCLES ON PROFILES AT ALL POINTS BETWEEN DESIGNATED
 POINTS THE GRADE SHALL BE ESTABLISHED SO AS TO CONFORM TO A STRAIGHT LINE DRAWN BETWEEN SAID DESIGNATED POINTS.
 ELEVATIONS ARE IN FEET ABOVE U.S.C. & G.S. SEA LEVEL DATUM OF 1929.
 THIS DRAWING AND THE DATA HEREON ARE HEREBY MADE A PART OF THE SPECIFICATIONS
 WORK SHALL BE CONSTRUCTED ACCORDING TO STANDARD SPECIFICATIONS DATED MAY 12, 1962, ON FILE IN THE OFFICE OF THE
 COUNTY ENGINEER AND SHALL BE PROSECUTED ONLY IN THE PRESENCE OF THE COUNTY ENGINEER.
 BEFORE WORK CAN BE STARTED, THE CONTRACTOR MUST OBTAIN A PERMIT TO EXCAVATE IN COUNTY STREETS FROM THE L.A. COUNTY
 ROAD DEPT., DISTRICT OFFICE NO. 1, AND PAY A FEE TO THE COUNTY ENGINEER, ROOM 300, COUNTY ENGINEERING BUILDING,
 108 WEST SECOND STREET OR SAN JOSE REGIONAL OFFICE, SUFFICIENT TO COVER THE COST OF
 CONSTRUCTION INSPECTION AND RECORD PLANS.
 APPROVAL OF THIS PLAN BY THE COUNTY OF LOS ANGELES DOES NOT CONSTITUTE A REPRESENTATION AS TO THE ACCURACY OF THE
 LOCATION OF OR THE EXISTENCE OR NON-EXISTENCE OF ANY UNDERGROUND UTILITY PIPE, OR STRUCTURE WITHIN THE LIMITS OF THIS
 PROJECT. THIS NOTE APPLIES TO ALL PAGES.
 IF WORK IS TO BE DONE ON A STATE HIGHWAY, A PERMIT MUST BE OBTAINED FROM THE STATE OF CALIFORNIA, DIVISION OF HIGHWAYS,
 120 SOUTH SPRING STREET, LOS ANGELES, CALIFORNIA.

COUNTY OF LOS ANGELES, CALIFORNIA
 JOHN A. LAMBIE, COUNTY ENGINEER
 J. D. PARKHURST, CHIEF ENGINEER
 CO. SAN DIST NO. 22
 APPROVED BY: *[Signature]* ASSISTANT SANITATION ENGINEER
 APPROVED BY: *[Signature]* OFFICE ENGINEER
 SUBMITTED BY: *[Signature]* SAN DIMAS REGIONAL ENGINEER
 CHECKED BY: *[Signature]* REG. C.E. NO. 2946

J.N. 036163

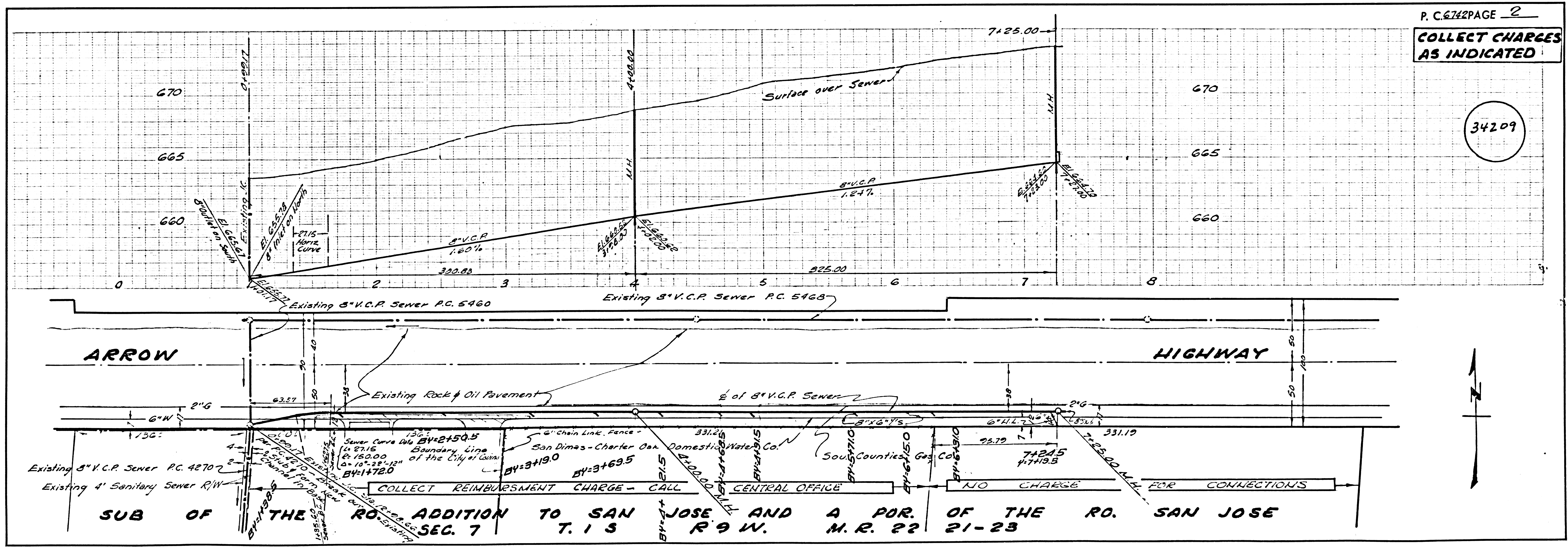

P.C. 6742 PAGE 2
 COLLECT CHARGES
 AS INDICATED

34209

SUB OF THE ROAD ADDITION TO SAN JOSE AND A POR. OF THE ROAD SAN JOSE
 SEC. 7 T. 1 S R 9 W. M. R. 22 21-23