

B.M. SAN DIST. 22 & M.ELEV. 456.76  
 2.17' in top of curb approx. 14'  
 North of North Curb Return N.E.  
 COP of Clark Ellen Ave. & Grove  
 Center St.

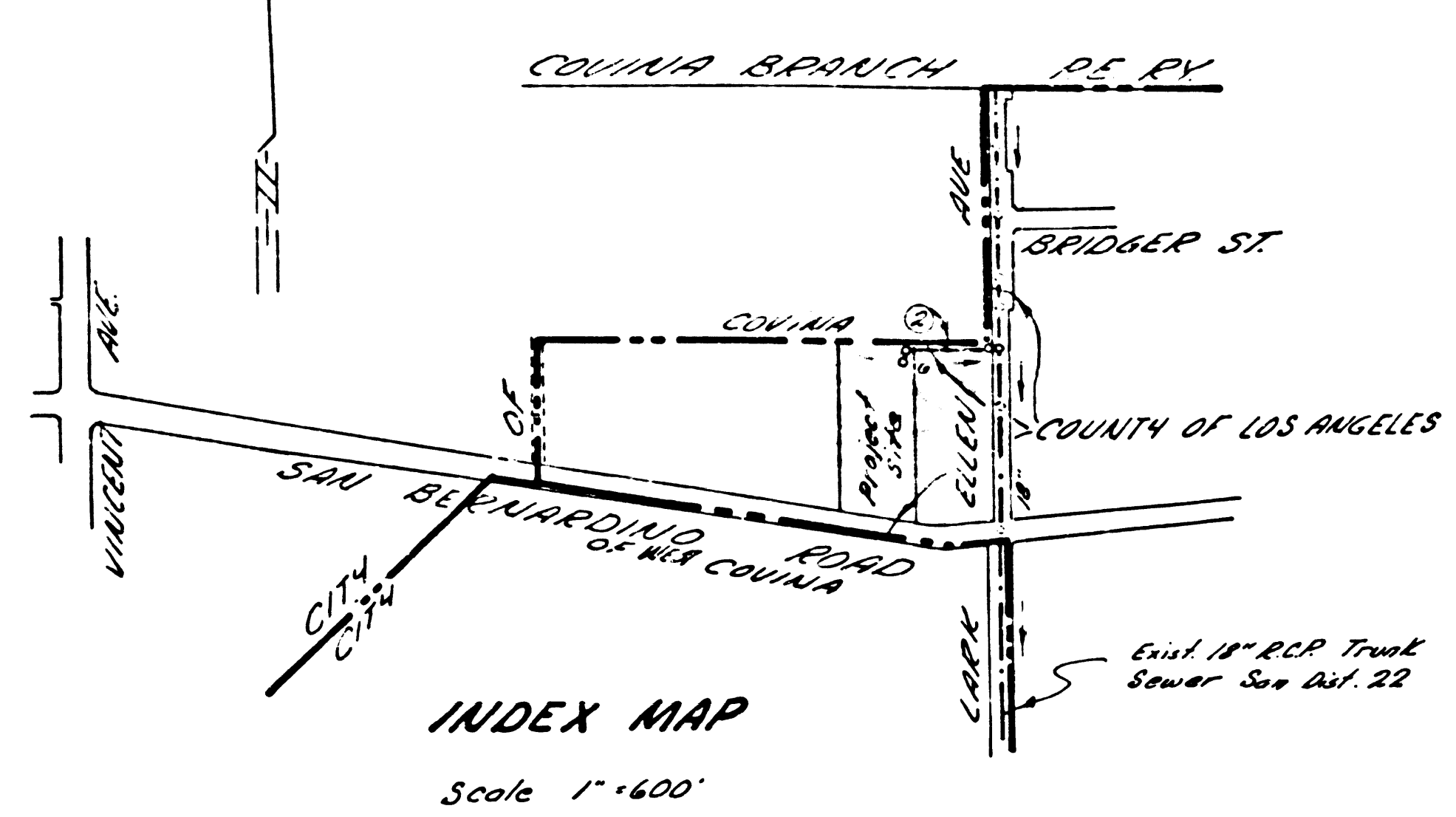

**SAN DIMAS BLDG. DIST. NO. 10**

**R/W NO SAN BERNARDINO RD.**  
**PRIVATE CONTRACT NO. 6753**

W.S. 97  
 2 SHEETS; 3 PAGES  
 SCALE: VERT. 1"=4' 02.600' 1963  
 HORIZ. 1"=40'  
 PREPARED IN THE OFFICES OF  
**INTEGRATED ENGINEERS, INC.**  
 1977 North Garry Avenue  
 Pasadena, California  
 By: *Philip S. Buffin*  
 REG. C. E. NO. 2052  
 FOR LEGEND SEE PLAN NO. S-6-64

36023

- NOTE
1. PROVIDE STAKES ON THE PROPERTY LINE OR PROPERTY LINES PRODUCED AT RIGHT ANGLES TO THE SEWER LINE AT THE CENTER LINE OF EACH MANHOLE.
  2. NO REPRESENTATIVE OF THE COUNTY ENGINEER WILL SURVEY OR LAY OUT ANY PORTION OF THE WORK.
  3. THE PRIVATE ENGINEER SHALL FURNISH THE COUNTY ENGINEER WITH GRADE SHEETS AND STATIONING FOR ALL HOUSE LATERALS AND BRANCHES AND SHALL PROVIDE STAKES FOR THEM AT THEIR PROPER LOCATIONS WITH STATIONING PLAINLY MARKED. ALL HOUSE LATERALS SHALL BE UNIMPROVED RIGHTS OF WAY TO A STRAIGHT ALIGNMENT AT RIGHT ANGLES FROM THE MAIN LINE SEWER EXCEPT AS SHOWN ON THE PLANS. HOUSE LATERALS FROM CHIMNEYS SHALL NOT HAVE AN ANGLE OF LESS THAN 45° WITH THE MAIN LINE SEWER. ANY CHANGE IN ALIGNMENT SHALL BE REQUESTED IN WRITING BY THE PRIVATE ENGINEER.
  4. NO REVISIONS SHALL BE MADE IN THESE PLANS WITHOUT THE APPROVAL OF THE COUNTY ENGINEER.
  5. THE CONTRACTOR SHALL NOTIFY THE CONSTRUCTION DIVISION BY TELEPHONE, MADISON 9-4747, EXT. 81551, AT LEAST TWENTY FOUR HOURS BEFORE STARTING ANY WORK UNDER THIS CONTRACT.
  6. MANHOLES SHALL BE BRICK SEWER STRUCTURES PER S-6-104. PRECAST CONCRETE MANHOLES PER S-6-135 OR S-6-173 MAY BE USED AS AN ALTERNATE IN LOCATIONS APPROVED BY THE COUNTY ENGINEER. EXCEPT AS NOTED.
  7. USE STANDARD MANHOLE FRAMES AND COVERS, S-6-117, EXCEPT AS NOTED.
  8. MANHOLE TIPS IN UNIMPROVED RIGHTS OF WAY TO BE SIX INCHES ABOVE FINISHED GRADE.
  9. USE EXTRA STRENGTH PIPE. ALL PIPE IS STANDARD DEPTH EXCEPT AS NOTED.
  10. USE MECHANICAL COMPRESSION JOINTS FOR ALL V.C.P. JOINTS PER SPECS. SECS. 36 & 48.
  11. IF A POWER POLE IS WITHIN THREE FEET OF THE SEWER, THE SEWER SHALL BE ENCASED, PER S-6-173, CASE III, TWO FEET ON EITHER SIDE FROM THE POINT OF INTERFERENCE.
  12. IF DURING THE COURSE OF CONSTRUCTION IT IS DETERMINED THAT THERE IS LESS THAN FOUR FEET OF COVER OVER THE TOP OF A MAIN LINE OR HOUSE LATERAL V.C.P. SEWER WHICH IS NOT INDICATED ON THE PLANS, THE PIPE SHALL BE ENCASED PER S-6-173, CASE III, UNLESS OTHERWISE APPROVED BY THE COUNTY ENGINEER.
  13. RESURFACE ALL TRENCHES WITHIN PAVED AREAS TO MEET L.A. COUNTY ROAD DEPT. OR CALIFORNIA STATE HIGHWAY REQUIREMENTS IN ACCORDANCE WITH PERMITS.
  14. FOR ALLOWABLE LEAKAGE TEST USE FORMULA NO. 2, SPECS. SEC. 54.
  15. ALL STATE AND LOCAL TRAFFIC SAFETY ORDERS WILL BE RIGIDLY ENFORCED.

NO CONNECTIONS FOR THE DISPOSAL OF INDUSTRIAL WASTES SHALL BE MADE TO SEWERS SHOWN ON THESE DRAWINGS WITHOUT WRITTEN PERMISSION FROM THE CHIEF ENGINEER AND GENERAL MANAGER OF THE COUNTY SANITATION DISTRICTS.

BEFORE BREAKING INTO ANY EXISTING STRUCTURE AND BEFORE FINAL ACCEPTANCE OF THIS WORK, COUNTY SANITATION DISTRICT (DU 4-1281) SHALL BE NOTIFIED IN ORDER THAT REQUIRED INSPECTION CAN BE MADE.

NOTE

GRADES TO WHICH THIS IMPROVEMENT IS TO BE CONSTRUCTED ARE SHOWN ON PLANS AND PROFILES. GRADE POINTS FOR TOP OF CURBS, CENTER LINE OF STREETS, OR CENTER LINE OF ALLEYS ARE SHOWN BY CIRCLES ON PROFILES. AT ALL POINTS BETWEEN DESIGNATED POINTS THE GRADE SHALL BE ESTABLISHED SO AS TO CONFORM TO A STRAIGHT LINE DRAWN BETWEEN SAID DESIGNATED POINTS. ELEVATIONS ARE IN FEET ABOVE U.S.C. & G.S. SEA LEVEL DATUM OF 1929.

THIS DRAWING AND THE DATA HEREON ARE HEREBY MADE A PART OF THE SPECIFICATIONS.

WORK SHALL BE CONSTRUCTED ACCORDING TO STANDARD SPECIFICATIONS DATED 1964, 75, 1768, ON FILE IN THE OFFICE OF THE COUNTY ENGINEER AND SHALL BE PROSECUTED ONLY IN THE PRESENCE OF THE COUNTY ENGINEER.

BEFORE WORK CAN BE STARTED, THE CONTRACTOR MUST OBTAIN A PERMIT TO EXCAVATE IN COUNTY STREETS FROM THE L.A. COUNTY ROAD DEPT., DISTRICT OFFICE NO. 2, AND PAY A FEE TO THE COUNTY ENGINEER, ROOM 380, COUNTY ENGINEERING BUILDING, 108 WEST SECOND STREET OR SAN DIMAS REGIONAL OFFICE, SUFFICIENT TO COVER THE COST OF CONSTRUCTION INSPECTION AND RECORD PLANS.

APPROVAL OF THIS PLAN BY THE COUNTY OF LOS ANGELES DOES NOT CONSTITUTE A REPRESENTATION AS TO THE ACCURACY OF THE LOCATION OF OR THE EXISTENCE OR NON-EXISTENCE OF ANY UNDERGROUND UTILITY PIPE, OR STRUCTURE WITHIN THE LIMITS OF THIS PROJECT. THIS NOTE APPLIES TO ALL PAGES.

IF WORK IS TO BE DONE IN A STATE HIGHWAY, A PERMIT MUST BE OBTAINED FROM THE STATE OF CALIFORNIA, DIVISION OF HIGHWAYS, 120 SOUTH SPRING STREET, LOS ANGELES, CALIFORNIA.

COUNTY OF LOS ANGELES, CALIFORNIA  
 JOHN A. LAMBIE, COUNTY ENGINEER  
 J. D. PARKHURST, CHIEF ENGINEER  
 CO. SAN. DIST. NO. 22  
 APPROVED BY: *Richard E. Kline* ASSISTANT SANITATION ENGINEER  
 APPROVED BY: *J. D. Parkhurst* OFFICE ENGINEER

CHECKED BY: *Bernard L. Volosky*  
 REG. C. E. NO. 2683

J. N. 0361-70

**ISSUE NO PERMITS**  
*Bernard L. Volosky*

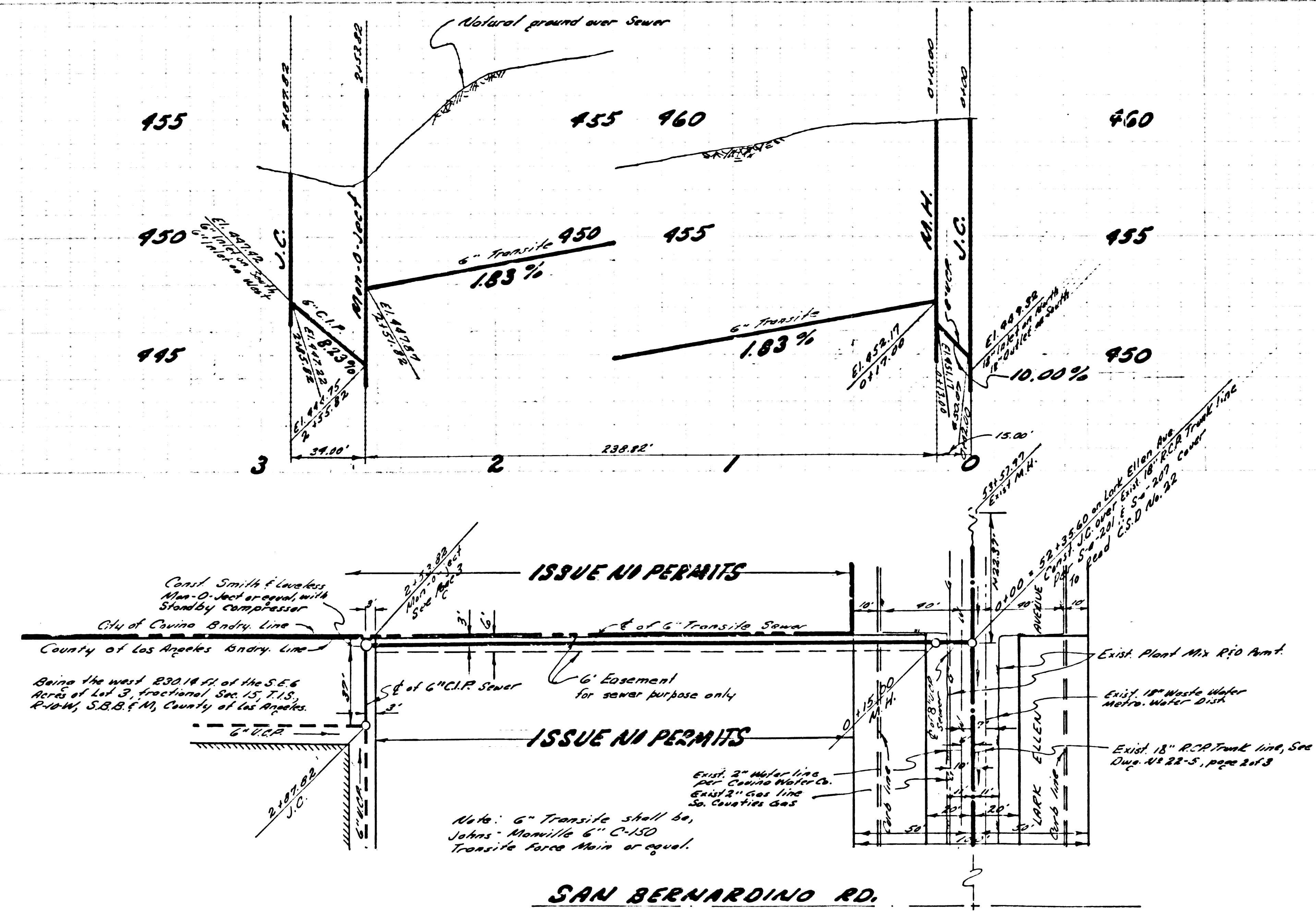

**ISSUE NO PERMITS**

County of Los Angeles Boundary Line

Being the west 230.01' of the S.E. 4 Area of Lot 3, Parcel No. 15, 715, R/W No. S.B.B.F.M. County of Los Angeles.

6" Transite Sewer

6" Easement for sewer purpose only

ISSUE NO PERMITS

Exist. 18" R.C.P. Tank Line, See Dist. No. 22-5, page 2-13

Exist. 18" Waste Water Meters, Water Dist.

Exist. Plant No. Rio Amt.

Exist. 6" Water Line and Gas Water Co. Existing Line in Existing Gas

Note: 6" Transite shall be Johns Manville 6" C-130 Transite force main or equal.

**SAN BERNARDINO RD.**

96025

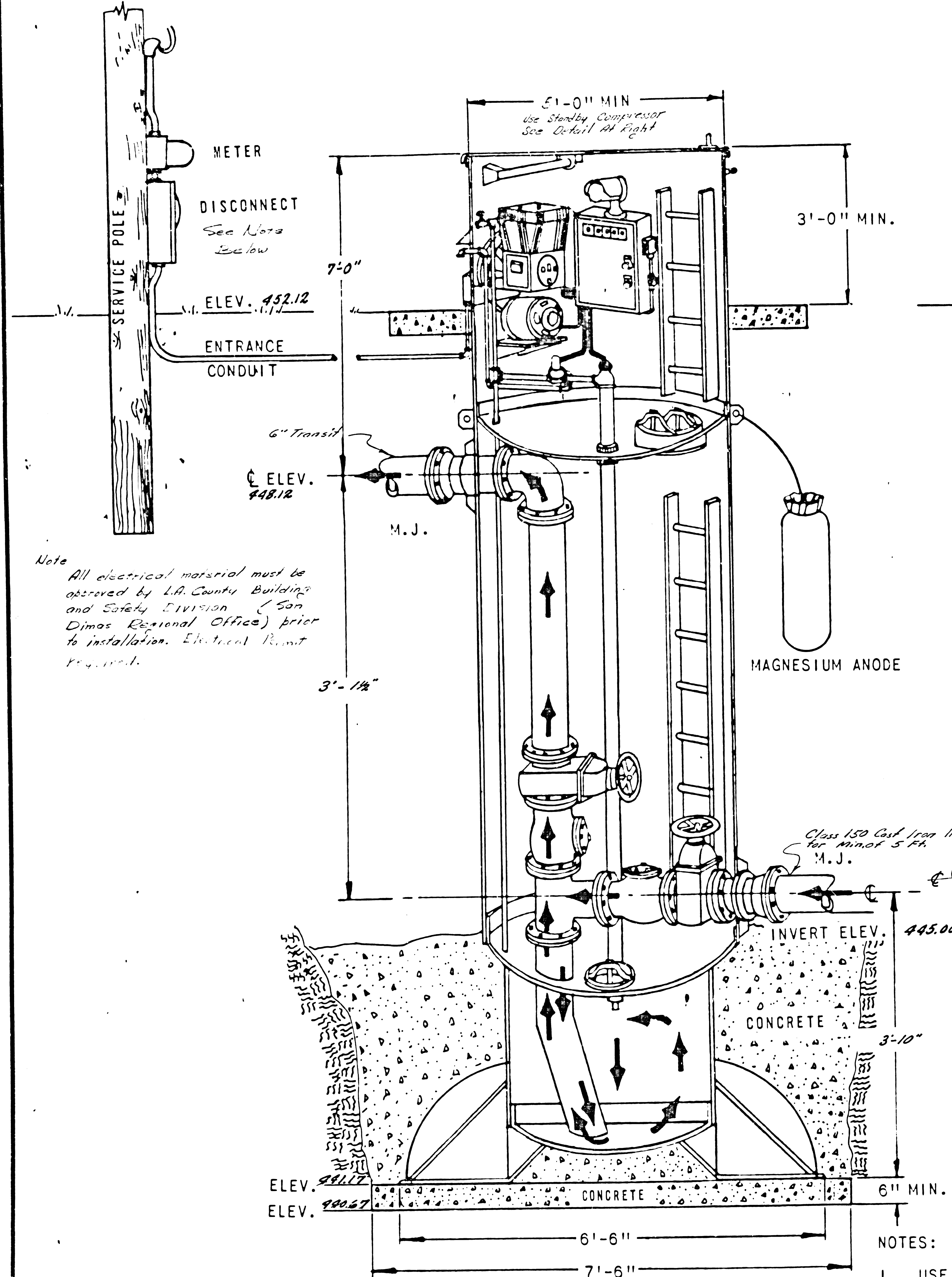

Note  
All electrical material must be approved by L.A. County Building and Safety Division (San Dimas Regional Office) prior to installation. Electrical Permit required.

- NOTES:
1. USE CLASS 150 CAST IRON INFLUENT LINE. AS NOTED ON THIS PLAN
  2. DISCHARGE AND INFLUENT LINES SHOULD BE LAID ON CAREFULLY COMPACTED BACKFILL OR SUPPORTS TO PREVENT BREAKAGE BY SETTLEMENT.

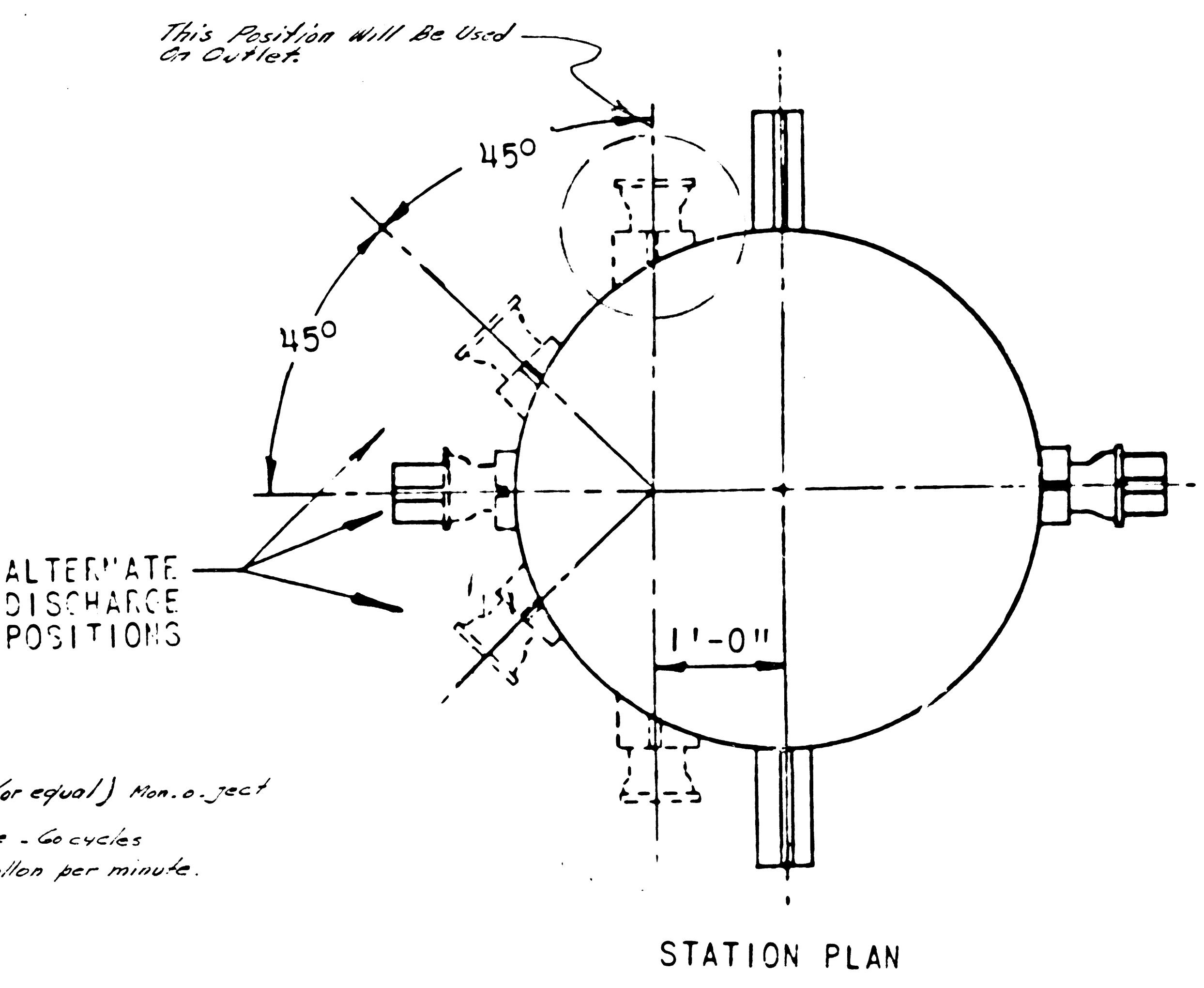
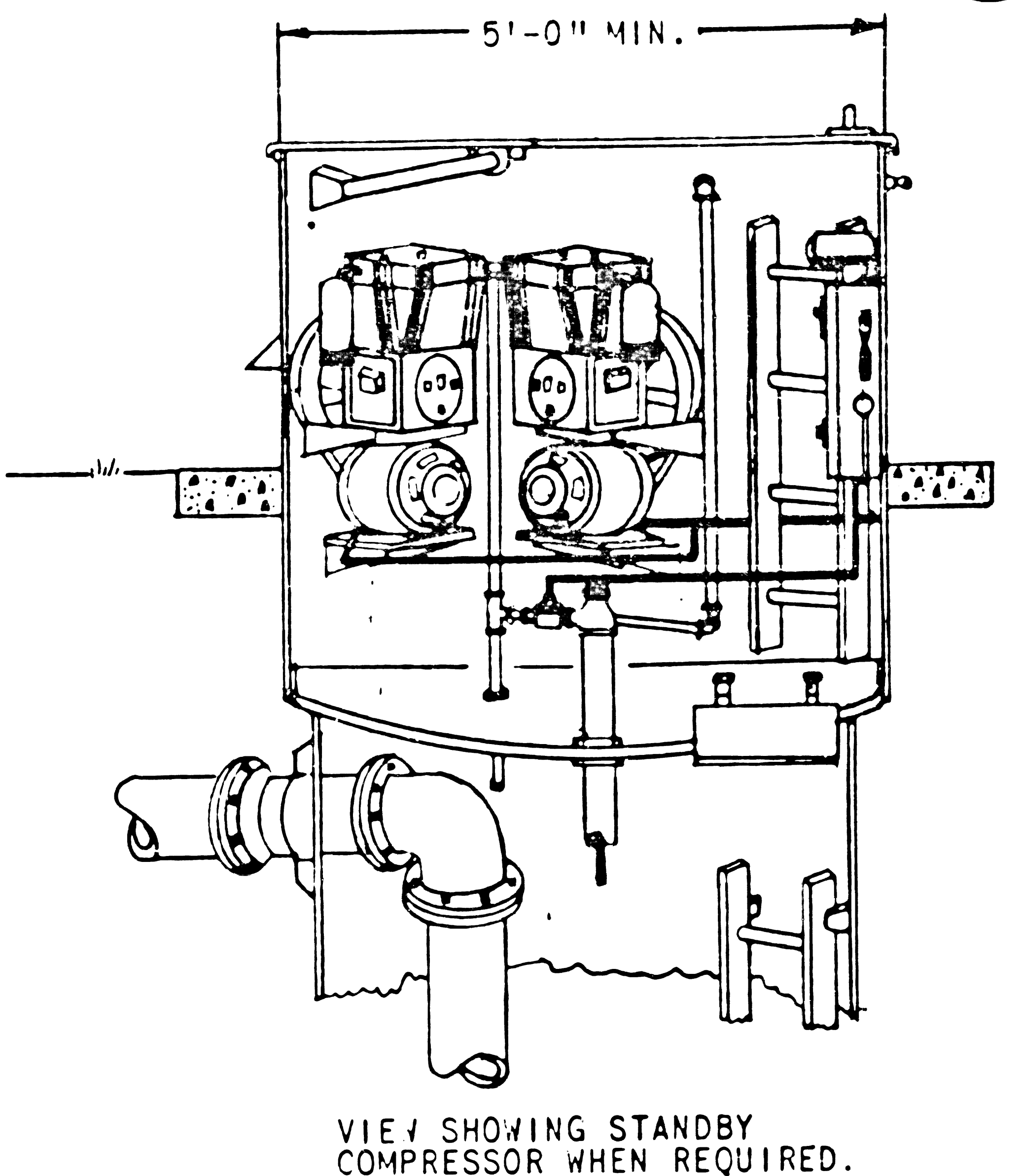
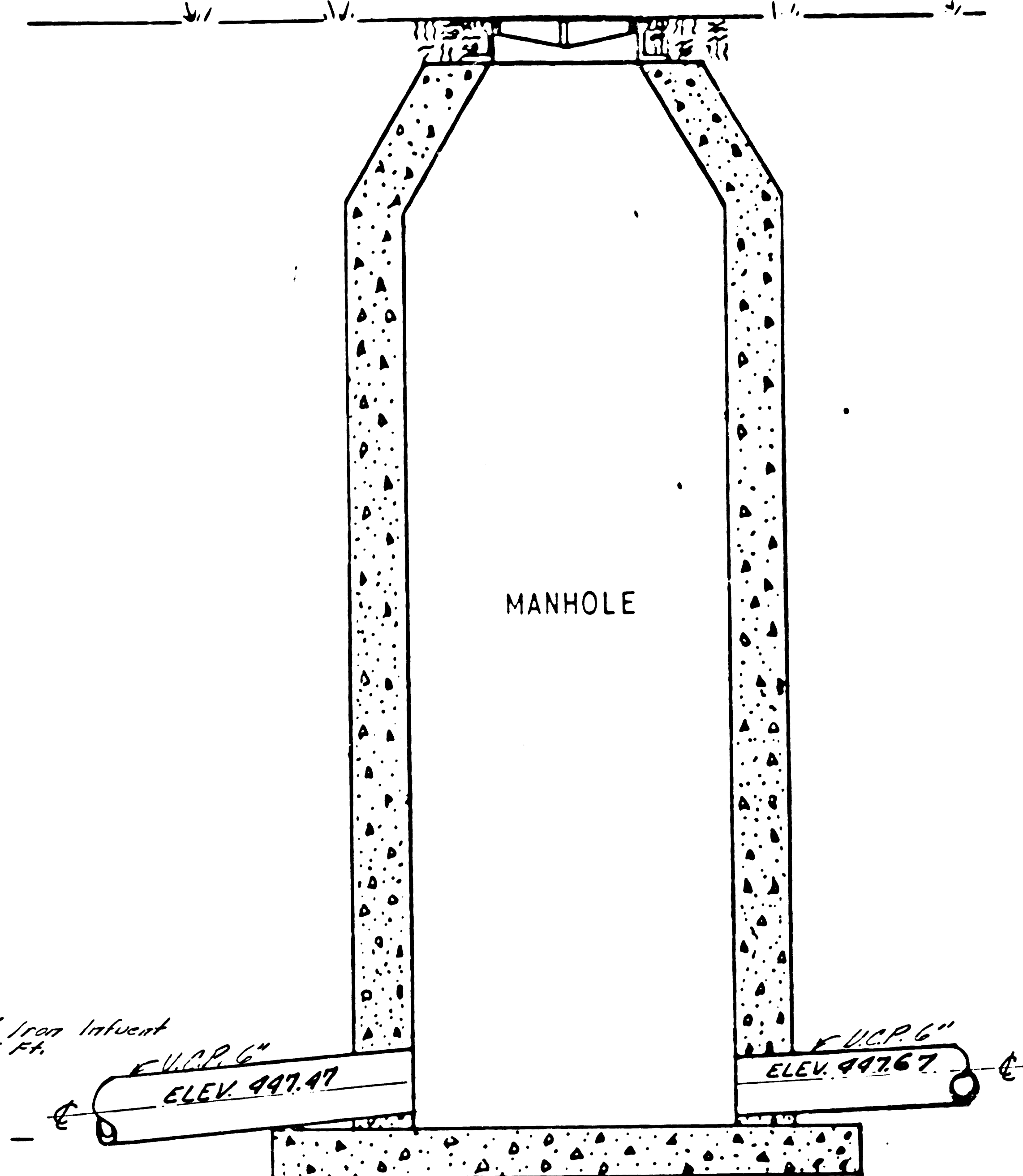

- Notes to contractor
1. Construct Smith and Loveless (or equal) Man. object with standby compressor.
  2. Meter to be 2HP single phase - 60 cycles
  3. Capacity of unit to be 100 gallon per minute.

Scale	No scale	Reference	Revisions	Prepared by	SEWAGE LIFT STATION	Checked by
Date	10.31.63			INTEGRATED ENGINEERS, INC.	for 54 Units on property located on North side of San Bernardino Road ± 250' West of Lark Ellen Avenue	FOR THE PROPERTY
Drawn				1977 North Gurey Pomona California NA. 3.1575		077 E Colorado Pasadena California 54 6.523
Checked						J. J. O'NEILL