

B.M. 8-15 ELEV. 33.514 (62 ad)  
 INTERS. OF CENTRALIA RD. AND BLOOMFIELD AVE. IN A WELL CUT THROUGH THE P.M.T. AND PROTECTED BY A C.I. COVER MKD. STAND. COUNTY SURVEYOR MON. STAMPED 1/4 COR. SEC. 7 98 T 45 R 11W FB. 1209 PAGE 17

LAKWOOD BLDG. DIST. NO. 4.3

PROFILE ALIGNMENT AND GRADE OF  
**SANITARY SEWERS** PAGE 1  
 TO BE CONSTRUCTED IN  
**BLOOMFIELD AVENUE**

PRIVATE CONTRACT NO. 6877

W.S. 31  
 1 SHEETS, 2 PAGES  
 SCALE: VERT. 1"=4' HORIZ. 1"=40'  
 DECEMBER, 1963

PREPARED IN THE OFFICES OF  
**ABELL and COUGHLIN**

BY *John S. Coughlin*  
 REG. C. E. NO. 11878

FOR LEGEND SEE PLAN NO. S-6-64

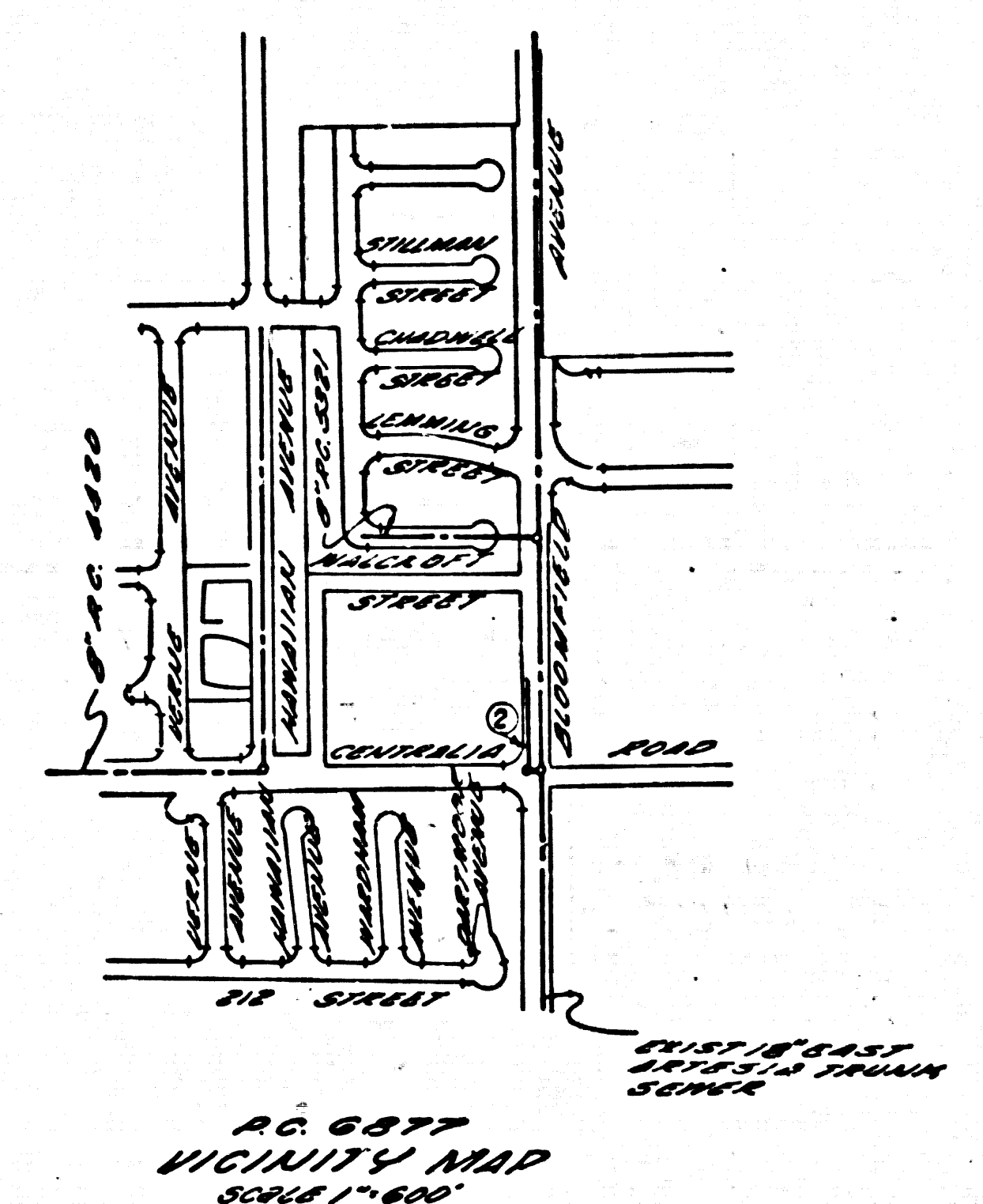

- NOTE:
- PROVIDE STAKES ON THE PROPERTY LINE OR PROPERTY LINES PRODUCED AT RIGHT ANGLES TO THE SEWER LINE AT THE CENTER LINE OF EACH MANHOLE.
  - NO REPRESENTATIVE OF THE COUNTY ENGINEER WILL SURVEY OR LAY OUT ANY PORTION OF THE WORK.
  - THE PRIVATE ENGINEER SHALL FURNISH THE COUNTY ENGINEER WITH GRADE SHEETS AND STATIONING FOR ALL HOUSE LATERALS AND Y BRANCHES AND SHALL PROVIDE STAKES FOR THEM AT THEIR PROPER LOCATIONS WITH STATIONING PLAINLY MARKED. ALL HOUSE LATERALS SHALL BE CONSTRUCTED IN A STRAIGHT ALIGNMENT AT RIGHT ANGLES FROM THE MAIN LINE SEWER EXCEPT AS SHOWN ON THE PLANS. HOUSE LATERALS FROM CHIMNEYS SHALL HAVE AN ANGLE OF LESS THAN 45 DEGREES WITH THE MAIN LINE SEWER. ANY CHANGE IN ALIGNMENT SHALL BE REQUESTED IN WRITING BY THE PRIVATE ENGINEER.
  - THE PRIVATE ENGINEER SHALL FURNISH THE HOUSE LATERAL DEPTH AT THE PROPERTY LINE BELOW THE TOP OF CURB ELEVATION FOR EACH HOUSE LATERAL ON THE GRADE SHEET.
  - NO REVISIONS SHALL BE MADE IN THESE PLANS WITHOUT THE APPROVAL OF THE COUNTY ENGINEER.
  - THE CONTRACTOR SHALL NOTIFY THE CONSTRUCTION DIVISION BY TELEPHONE, MADISON 9-4707, EXT. 8158, AT LEAST TWENTY-FOUR HOURS BEFORE STARTING ANY WORK UNDER THIS CONTRACT.
  - MANHOLES SHALL BE BRICK SEWER STRUCTURES PER S-6-104. PRECAST CONCRETE MANHOLES PER S-6-125 OR S-6-173 MAY BE USED AS AN ALTERNATE IN LOCATIONS APPROVED BY THE COUNTY ENGINEER.
  - USE STANDARD MANHOLE FRAMES AND COVERS, S-6-177, 80099-AS-100000.
  - MANHOLES 24" TO 30" DIAMETER SHALL BE 24" TO 30" DEPTH UNLESS OTHERWISE SPECIFIED.
  - USE EXTRA STRENGTH PIPE. ALL PIPE IS STANDARD DEPTH UNLESS OTHERWISE SPECIFIED.
  - USE 4" MINIMUM MECHANICAL COMPRESSION JOINTS FOR ALL V.C.P. JOINTS PER SPEC., SECS. 34 & 48.
  - WHERE EVER GROUND WATER IS ENCOUNTERED DURING THE CONSTRUCTION OF THE SEWERS, THE V.C.P. JOINTS SHALL BE OF JOINT COMPOUND PER SPEC., SECS. 32 & 48, OR MECHANICAL COMPRESSION JOINTS PER SPEC., SEC. 34.
  - IF A POWER POLE IS WITHIN THREE FEET OF THE SEWER, THE SEWER SHALL BE ENCASED, PER S-6-172, CASE III, TWO FEET ON EITHER SIDE FROM THE POINT OF INTERFERENCE.
  - IF DURING THE COURSE OF CONSTRUCTION IT IS DETERMINED THAT THERE IS LESS THAN FOUR FEET OF COVER OVER THE TOP OF A MAIN LINE OR HOUSE LATERAL V.C.P. SEWER WHICH IS NOT INDICATED ON THE PLANS, THE PIPE SHALL BE ENCASED PER S-6-172, CASE III, UNLESS OTHERWISE APPROVED BY THE COUNTY ENGINEER.
  - HOUSE LATERALS TO BE CONSTRUCTED WITH 1/2" G.P. PER FOOT TO THE PROPERTY LINE.
  - RESURFACE ALL TRENCHES WITHIN PAVED AREAS TO MEET L.A. COUNTY ROAD DEPT. OR CALIFORNIA STATE HIGHWAY REQUIREMENTS IN ACCORDANCE WITH PERMITS.
  - FOR ALLOWABLE LEAKAGE TEST USE FORMULA NO. 2, PER SPEC., SEC. 64.
  - ALL STATE AND LOCAL TRAFFIC SAFETY ORDERS WILL BE RIGIDLY ENFORCED.
  - COST WORK SHALL BE APPROVED MECHANICAL JOINTS WILL BE USED UNLESS THE JOB IS FOR A STATE HIGHWAY OR A STATE HIGHWAY PROJECT. IN SUCH CASES THE COST OF WORK SHALL BE PAID BY THE STATE.

BEFORE BREAKING INTO ANY EXISTING STRUCTURE AND BEFORE FINAL ACCEPTANCE OF THIS WORK, COUNTY SANITATION DISTRICT (DU 4-1281) SHALL BE NOTIFIED IN ORDER THAT REQUIRED INSPECTION CAN BE MADE.

NO CONNECTIONS FOR THE DISPOSAL OF INDUSTRIAL WASTES SHALL BE MADE TO SEWERS SHOWN ON THESE DRAWINGS WITHOUT WRITTEN PERMISSION FROM THE CHIEF ENGINEER AND GENERAL MANAGER OF THE COUNTY SANITATION DISTRICTS.

**COLLECT CHARGES AS INDICATED**  
*Quill E. McCollum*

APPROVED BY *Bob A. Moore*  
 INDUSTRIAL WASTE DIV.

COUNTY OF LOS ANGELES, CALIFORNIA  
 JOHN A. LAMBIE, COUNTY ENGINEER  
 J. D. PARKHURST, CHIEF ENGINEER  
 CO. SAN. DIST. NO. 4  
 APPROVED BY *Richard E. Kelly*  
 ASSISTANT SANITATION ENGINEER  
 APPROVED BY *J. D. Parkhurst*  
 OFFICE ENGINEER  
 SUBMITTED BY *John S. Coughlin*  
 LOS ANGELES REGIONAL ENGINEER, RE 3871  
 CHECKED BY *John S. Coughlin*  
 REG. C. E. NO. 11878

J. N. 0362.53

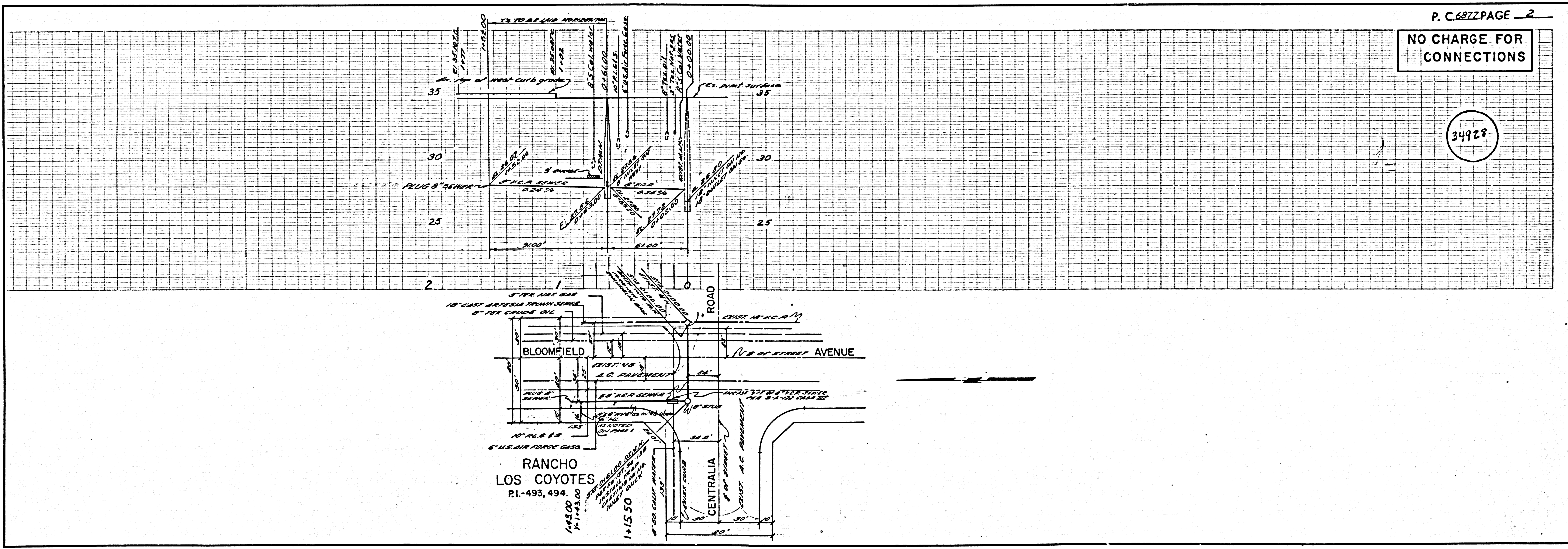

P. C. 6877 PAGE 2  
**NO CHARGE FOR CONNECTIONS**

34928

1788 BC 9811 BLOOMFIELD AVE