

DETAIL - CONNECTION TO 114" ROUND SEWER  
NOT TO SCALE

36763

**GENERAL NOTES:**

1. PRIOR TO COMMENCING ANY WORK ON THE 114" SEWER THE CONTRACTOR SHALL CONTACT THE DISTRICT ENGINEER AND NOTIFY THE DISTRICT ENGINEER OF THE WORK TO BE DONE ON THE SEWER. THE CONTRACTOR SHALL OBTAIN A WORKING PERMIT FROM THE SANITATION DISTRICT PRIOR TO COMMENCING WORK.
2. APPROVAL OF THIS DRAWING BY THE L.A. COUNTY SANITATION DISTRICT SHALL NOT RELIEVE THE CONTRACTOR OF THE REQUIREMENT TO OBTAIN A WORKING PERMIT FROM THE SANITATION DISTRICT PRIOR TO COMMENCING WORK.
3. ELEVATIONS ARE IN FEET ABOVE U.S.C. & G.S. SEA LEVEL DATUM OF 1929. THE DRAWING AND THE DATA HEREON ARE HEREBY MADE A PART OF THE SPECIFICATIONS. WORK SHALL BE CONSTRUCTED ACCORDING TO SPECIFICATIONS ON FILE IN THE OFFICE OF THE COUNTY ENGINEER AND REVISIONS PROCESSED ONLY IN THE PRESENCE OF THE COUNTY ENGINEER'S SPECIFICATIONS DATED JAN. 1, 1960 APPLY IN THE CONSTRUCTION OF THIS PROJECT.
4. BEFORE COMMENCING THE CONTRACTOR MUST OBTAIN A PERMIT TO EXCAVATE IN COUNTY STREETS FROM THE L.A. COUNTY ENGINEER'S DISTRICT OFFICE NO. 87 AND A PERMIT TO CONSTRUCT CONSTRUCTION INSPECTION AND RECORD FROM THE COUNTY ENGINEER'S DISTRICT OFFICE NO. 108 WEST 56TH STREET, LOS ANGELES, CALIF. A PERMIT MUST BE OBTAINED FROM THE STATE OF CALIFORNIA, DIVISION OF HIGHWAYS, 150 SOUTH BERING STREET.
5. APPROVAL OF THIS PLAN BY THE COUNTY OF LOS ANGELES DOES NOT CONSTITUTE A REPRESENTATION AS TO THE ACCURACY OF THE LOCATION OF UTILITIES WITHIN THE LIMITS OF THIS PROJECT. NO REPRESENTATIVE OF THE COUNTY ENGINEER WILL SURVEY BELAUNT ANY PORTION OF THIS WORK.
6. REVISIONS SHALL BE MADE IN THESE PLANS WITHOUT APPROVAL OF THE COUNTY ENGINEER.
7. BEFORE BREAKING INTO ANY EXISTING STRUCTURE AND BEFORE FINAL ACCEPTANCE OF THIS WORK, COUNTY SANITATION DISTRICT (D) 412811 SHALL BE NOTIFIED IN ORDER THAT REQUIRED INSPECTION CAN BE MADE.

APPROVED  
ALFRED I. SWITZER REG. C.E. NO. 69145

THE CONTRACTOR SHALL NOTIFY THE COUNTY SANITATION DISTRICT BY TELEPHONE (MADISON 9-4147) EXT. 362 AT LEAST 24 HOURS BEFORE STARTING ANY WORK UNDER THIS CONTRACT.

APPROVED  
COUNTY SANITATION DISTRICT NO. 8  
J.O. PARKHURST - CHIEF ENGR. & GEN. MGR.  
BY *[Signature]*  
DATE 2-24-64

BEFORE BREAKING INTO ANY EXISTING STRUCTURE AND BEFORE FINAL ACCEPTANCE OF THIS WORK, COUNTY SANITATION DISTRICT (D) 412811 SHALL BE NOTIFIED IN ORDER THAT REQUIRED INSPECTION CAN BE MADE.

COUNTY OF LOS ANGELES, CALIFORNIA  
APPROVED, JOHN A. LAMDIS, COUNTY ENGINEER  
BY *[Signature]*  
ASST. SANITATION ENGINEER  
CHECKED *[Signature]* 2-24-64  
OFFICE OF COUNTY ENGINEER REG. C.E. NO. 10653

NO CONNECTIONS FOR THE DISPOSAL OF INDUSTRIAL WASTES SHALL BE MADE TO SEWERS SHOWN ON THESE DRAWINGS WITHOUT WRITTEN PERMISSION FROM THE CHIEF ENGINEER AND GENERAL MANAGER OF THE COUNTY SANITATION DISTRICTS.

PC. 6883

OFFICE BUILDING for  
**LACY MANUFACTURING COMPANY**  
2400 DOMINGUEZ ST. LOS ANGELES, CALIF.

<p>MECHANICAL CONSULTING ENGINEERS Dulham 5-7213 1870 VENTURA BOULEVARD, TAZANA, CALIF.</p>	DRAWN BY	REVISIONS	DATE	BY
	TRACED BY			
	CHECKED BY			
	APPROVED			
	APPROVED			

**HERMAN CHARLES LIGHT A.I.A.**  
8240 BEVERLY BLVD.  
LOS ANGELES 44, CALIF.  
ARCHITECT &  
ASSOCIATES  
OLIVE 1-1058  
OF 19 SHEETS

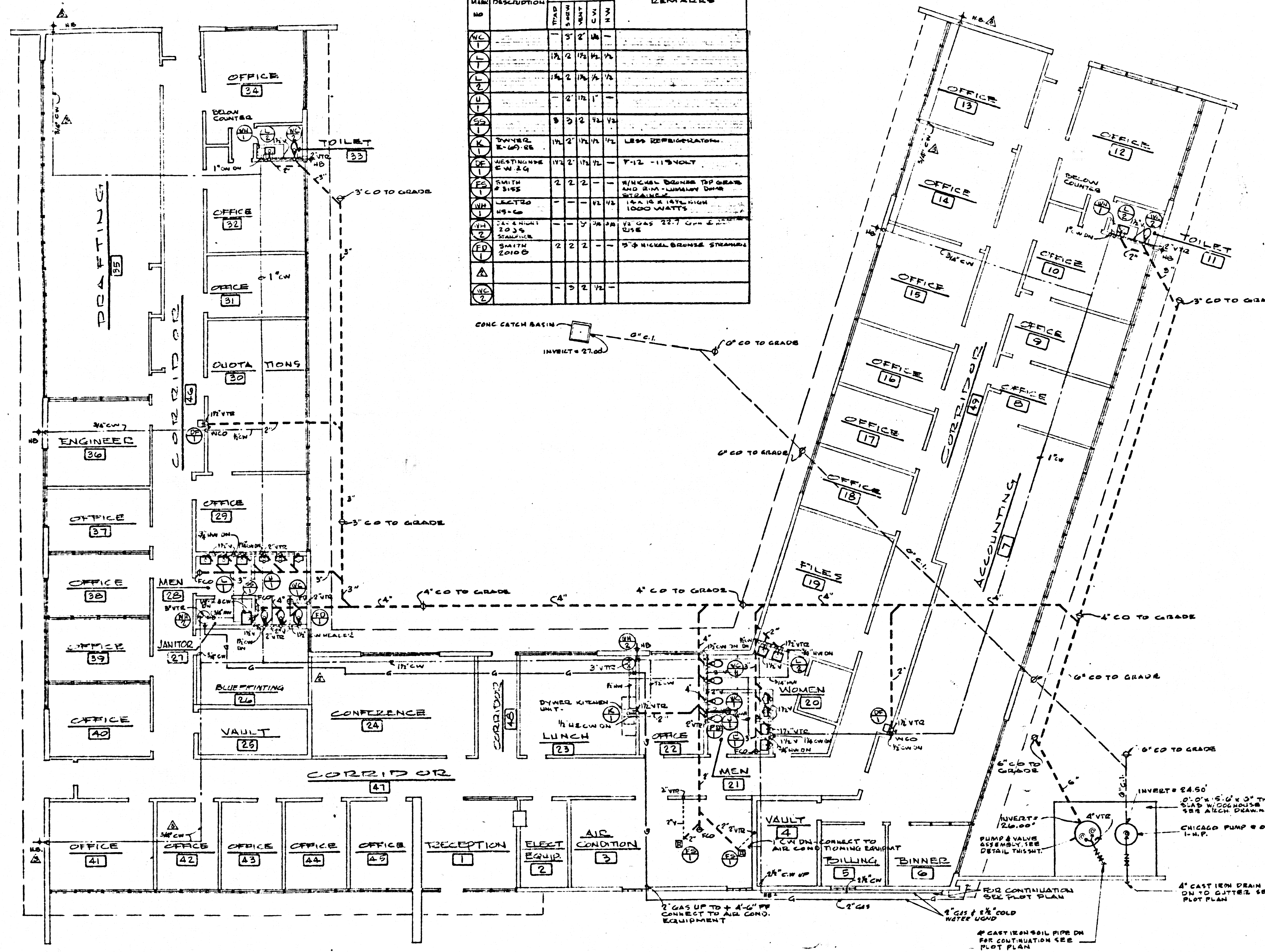

FIXTURE SCHEDULE							
NO.	DESCRIPTION	CONNECTION	TYPE	UNIT	QTY	REMARKS	
1	TOILET	1/2"	1/2"	1/2"	1		
2	TOILET	1/2"	1/2"	1/2"	1		
3	TOILET	1/2"	1/2"	1/2"	1		
4	TOILET	1/2"	1/2"	1/2"	1		
5	TOILET	1/2"	1/2"	1/2"	1		
6	TOILET	1/2"	1/2"	1/2"	1		
7	TOILET	1/2"	1/2"	1/2"	1		
8	TOILET	1/2"	1/2"	1/2"	1		
9	TOILET	1/2"	1/2"	1/2"	1		
10	TOILET	1/2"	1/2"	1/2"	1		
11	TOILET	1/2"	1/2"	1/2"	1		
12	TOILET	1/2"	1/2"	1/2"	1		
13	TOILET	1/2"	1/2"	1/2"	1		
14	TOILET	1/2"	1/2"	1/2"	1		
15	TOILET	1/2"	1/2"	1/2"	1		
16	TOILET	1/2"	1/2"	1/2"	1		
17	TOILET	1/2"	1/2"	1/2"	1		
18	TOILET	1/2"	1/2"	1/2"	1		
19	TOILET	1/2"	1/2"	1/2"	1		
20	TOILET	1/2"	1/2"	1/2"	1		
21	TOILET	1/2"	1/2"	1/2"	1		
22	TOILET	1/2"	1/2"	1/2"	1		
23	TOILET	1/2"	1/2"	1/2"	1		
24	TOILET	1/2"	1/2"	1/2"	1		
25	TOILET	1/2"	1/2"	1/2"	1		
26	TOILET	1/2"	1/2"	1/2"	1		
27	TOILET	1/2"	1/2"	1/2"	1		
28	TOILET	1/2"	1/2"	1/2"	1		
29	TOILET	1/2"	1/2"	1/2"	1		
30	TOILET	1/2"	1/2"	1/2"	1		
31	TOILET	1/2"	1/2"	1/2"	1		
32	TOILET	1/2"	1/2"	1/2"	1		
33	TOILET	1/2"	1/2"	1/2"	1		
34	TOILET	1/2"	1/2"	1/2"	1		
35	TOILET	1/2"	1/2"	1/2"	1		
36	TOILET	1/2"	1/2"	1/2"	1		
37	TOILET	1/2"	1/2"	1/2"	1		
38	TOILET	1/2"	1/2"	1/2"	1		
39	TOILET	1/2"	1/2"	1/2"	1		
40	TOILET	1/2"	1/2"	1/2"	1		
41	TOILET	1/2"	1/2"	1/2"	1		
42	TOILET	1/2"	1/2"	1/2"	1		
43	TOILET	1/2"	1/2"	1/2"	1		
44	TOILET	1/2"	1/2"	1/2"	1		
45	TOILET	1/2"	1/2"	1/2"	1		
46	TOILET	1/2"	1/2"	1/2"	1		
47	TOILET	1/2"	1/2"	1/2"	1		
48	TOILET	1/2"	1/2"	1/2"	1		
49	TOILET	1/2"	1/2"	1/2"	1		
50	TOILET	1/2"	1/2"	1/2"	1		
51	TOILET	1/2"	1/2"	1/2"	1		
52	TOILET	1/2"	1/2"	1/2"	1		
53	TOILET	1/2"	1/2"	1/2"	1		
54	TOILET	1/2"	1/2"	1/2"	1		
55	TOILET	1/2"	1/2"	1/2"	1		
56	TOILET	1/2"	1/2"	1/2"	1		
57	TOILET	1/2"	1/2"	1/2"	1		
58	TOILET	1/2"	1/2"	1/2"	1		
59	TOILET	1/2"	1/2"	1/2"	1		
60	TOILET	1/2"	1/2"	1/2"	1		
61	TOILET	1/2"	1/2"	1/2"	1		
62	TOILET	1/2"	1/2"	1/2"	1		
63	TOILET	1/2"	1/2"	1/2"	1		
64	TOILET	1/2"	1/2"	1/2"	1		
65	TOILET	1/2"	1/2"	1/2"	1		
66	TOILET	1/2"	1/2"	1/2"	1		
67	TOILET	1/2"	1/2"	1/2"	1		
68	TOILET	1/2"	1/2"	1/2"	1		
69	TOILET	1/2"	1/2"	1/2"	1		
70	TOILET	1/2"	1/2"	1/2"	1		
71	TOILET	1/2"	1/2"	1/2"	1		
72	TOILET	1/2"	1/2"	1/2"	1		
73	TOILET	1/2"	1/2"	1/2"	1		
74	TOILET	1/2"	1/2"	1/2"	1		
75	TOILET	1/2"	1/2"	1/2"	1		
76	TOILET	1/2"	1/2"	1/2"	1		
77	TOILET	1/2"	1/2"	1/2"	1		
78	TOILET	1/2"	1/2"	1/2"	1		
79	TOILET	1/2"	1/2"	1/2"	1		
80	TOILET	1/2"	1/2"	1/2"	1		
81	TOILET	1/2"	1/2"	1/2"	1		
82	TOILET	1/2"	1/2"	1/2"	1		
83	TOILET	1/2"	1/2"	1/2"	1		
84	TOILET	1/2"	1/2"	1/2"	1		
85	TOILET	1/2"	1/2"	1/2"	1		
86	TOILET	1/2"	1/2"	1/2"	1		
87	TOILET	1/2"	1/2"	1/2"	1		
88	TOILET	1/2"	1/2"	1/2"	1		
89	TOILET	1/2"	1/2"	1/2"	1		
90	TOILET	1/2"	1/2"	1/2"	1		
91	TOILET	1/2"	1/2"	1/2"	1		
92	TOILET	1/2"	1/2"	1/2"	1		
93	TOILET	1/2"	1/2"	1/2"	1		
94	TOILET	1/2"	1/2"	1/2"	1		
95	TOILET	1/2"	1/2"	1/2"	1		
96	TOILET	1/2"	1/2"	1/2"	1		
97	TOILET	1/2"	1/2"	1/2"	1		
98	TOILET	1/2"	1/2"	1/2"	1		
99	TOILET	1/2"	1/2"	1/2"	1		
100	TOILET	1/2"	1/2"	1/2"	1		

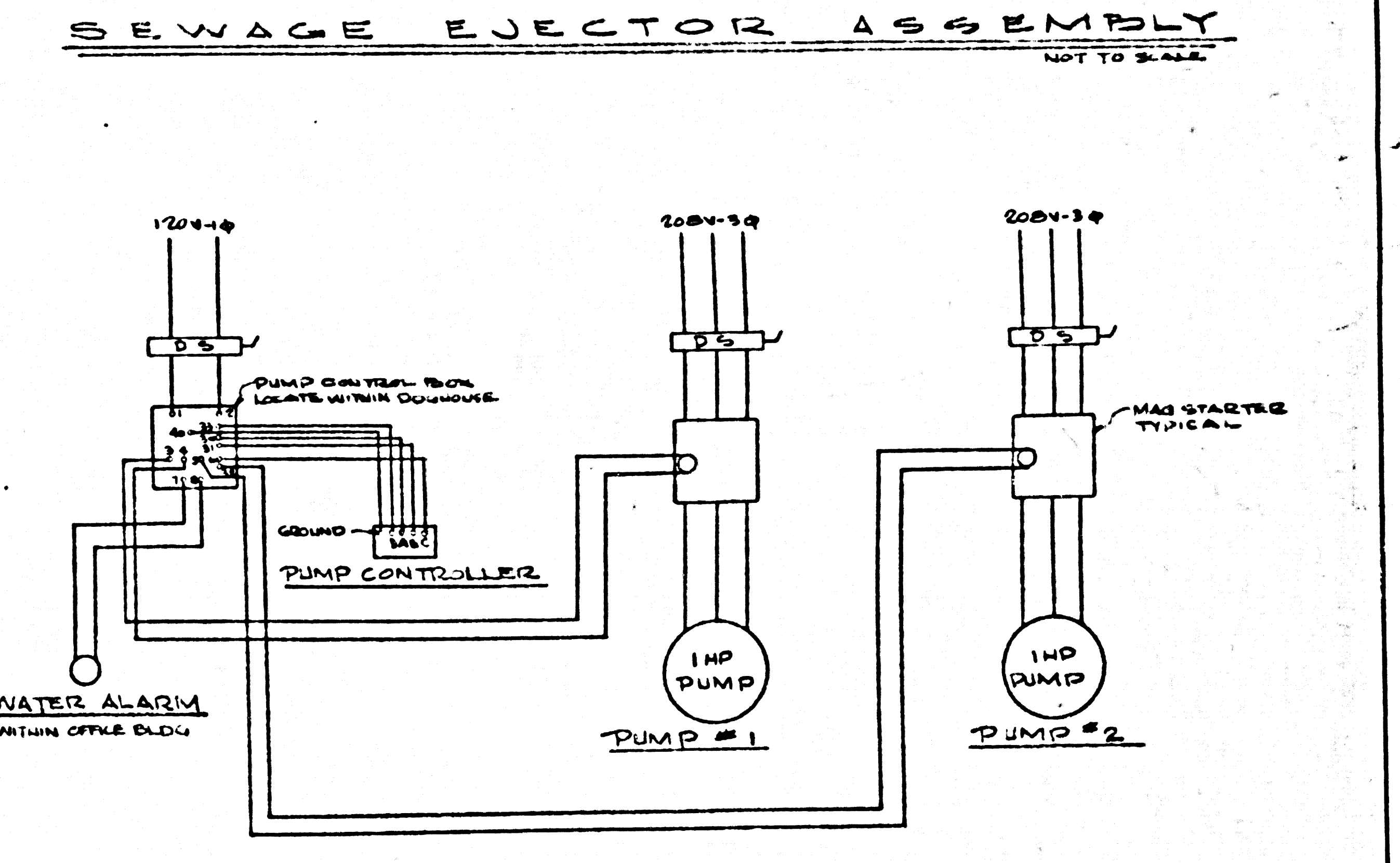
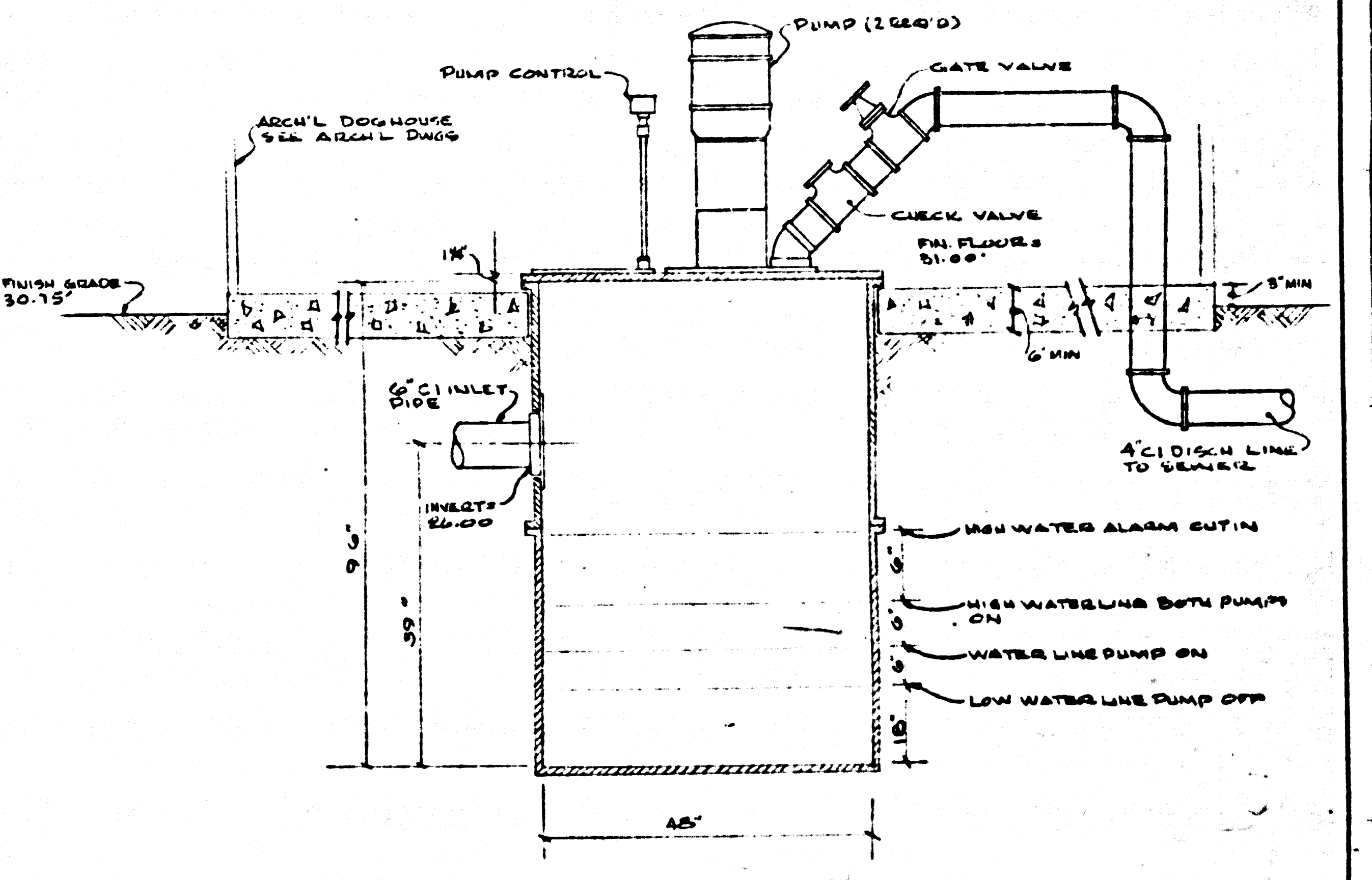
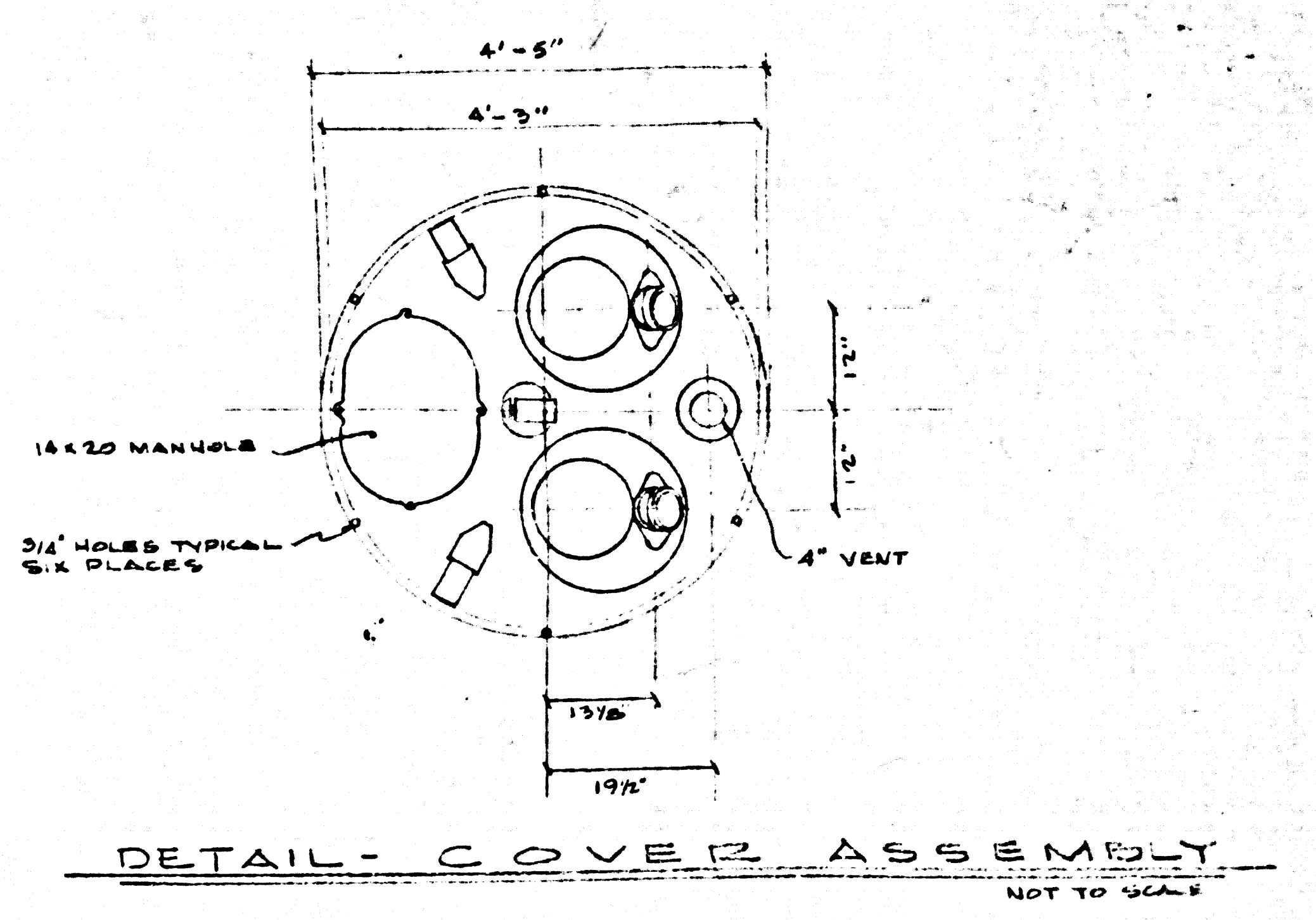

GENERAL NOTES:  
 1. ITEMS SHOWN SHOWN BY PLUMBING CONTRACTOR  
 2. ALL OTHER ITEMS BY ELECTRICAL CONTRACTOR  
 3. ALL WIRING BY ELECTRICAL CONTRACTOR  
 4. ALL DEVICES OR EQUIPMENT SHALL BE LOCATED WITHIN ARCHITECTURAL DOGHOUSE UNLESS OTHERWISE NOTED  
 5. ALL ELECTRICAL WORK SHALL CONFORM TO LOS ANGELES COUNTY ELECTRICAL CODE

OFFICE BUILDING for  
**LACY MANUFACTURING COMPANY**  
 2400 DOMINIQUEZ ST. LOS ANGELES, CALIF

	DRAWN BY R.E.G.	REVISIONS	DATE	BY
	CHECKED BY SA	APPROVED BY SA	4-18-66	J.R.
	APPROVED BY SA	APPROVED BY SA	7-29-66	L.R.
	APPROVED BY	APPROVED BY		
	APPROVED BY	APPROVED BY		

18670 VENTURA BOULEVARD, TAYLOR, CALIF.  
 8240 BEVERLY BLVD. LOS ANGELES 48, CALIF.  
**HERMAN CHARLES LIGHT A.I.A.**  
 ARCHITECT & ASSOCIATES  
 811 E. 1<sup>ST</sup> ST. S.F.

JOB NO. PC-6883  
 DATE 7-27-64  
 SHEET NO. P-2  
 OF 19 SHEETS