

- GENERAL NOTES**
- All work shall be constructed in accordance to specifications on file in the office of the City Engineer and shall be prosecuted only in the presence of an inspector.
 - Grades to which this improvement to be constructed to are shown on profiles. At all points between designated points the grade shall be established so as to conform to a straight line drawn between said designated points.
 - House laterals to be constructed of 6" V.C.P. with inverts at property line 6 feet below top of curb grade, except in Grandview Avenue and Chester Road.
 - These drawing and the data hereon are made a part of the Specifications.
 - Elevations are in feet above U.S.C.G.S. sea level datum of 1929.

NO CONNECTIONS FOR THE DISPOSAL OF INDUSTRIAL WASTES SHALL BE MADE TO SEWERS SHOWN ON THESE DRAWINGS WITHOUT WRITTEN PERMISSION FROM THE CHIEF ENGINEER AND GENERAL MANAGER OF THE COUNTY SANITATION DISTRICTS.

BENCH MARK: Los Angeles County Surveyors B.M., at the centerline intersection of Cypress Street and Barranca Avenue, Std. precast Monument 8" below surface.
ELEVATION 594.993

- LEGEND**
- ASSESSMENT DISTRICT BOUNDARIES
 - o- PROPOSED SEWER
 - o- EXISTING SEWER
 - 22 LOT NUMBERS
 - CITY BOUNDARY

NOTE:
The Contractor Must Obtain an Excavation Permit From the Los Angeles County Road Department, 14747 E. Ramona Blvd., Baldwin Park, Prior To Construction in County Streets.

PC 6968
APPROVED BY JOHN A. LAMBIE
LOS ANGELES COUNTY ENGINEER
BY: *R. E. K...* DATE 1-17-64
Assistant Sanitation Engineer

APPROVED BY JOHN D. PARKHURST,
CHIEF ENGINEER L.A. CO. SANITATION
DIST. NO. 22
BY: *M. Contin...* DATE 2-30-64
Office Engineer

CITY OF COVINA			
CYPRESS STREET AND OTHER RIGHTS-OF-WAY			
ASSESSMENT DISTRICT NUMBER S-6019			
GENERAL INDEX MAP			
Date: 2-24-64	SUBMITTED: <i>Clifford S. ...</i>	Sheet No.	
Scale: 1"=100'	DATE: 3-24-64	Project No.	1 of 15
Design: <i>CCJ</i>	APPROVED: <i>Carl W. Elliot</i>	Street Superintendent	
Drawn: <i>H.D.M.</i>	DATE: 3/25/64		S-6019
Checked: <i>C.H.R.</i>			

96216

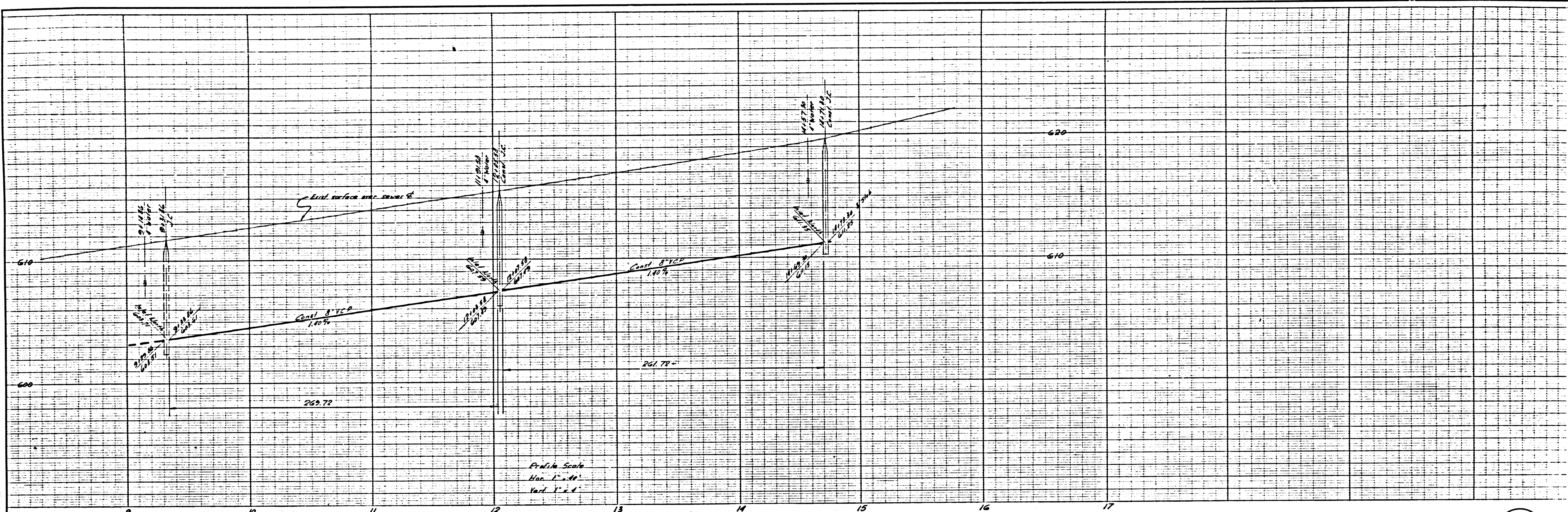

36217

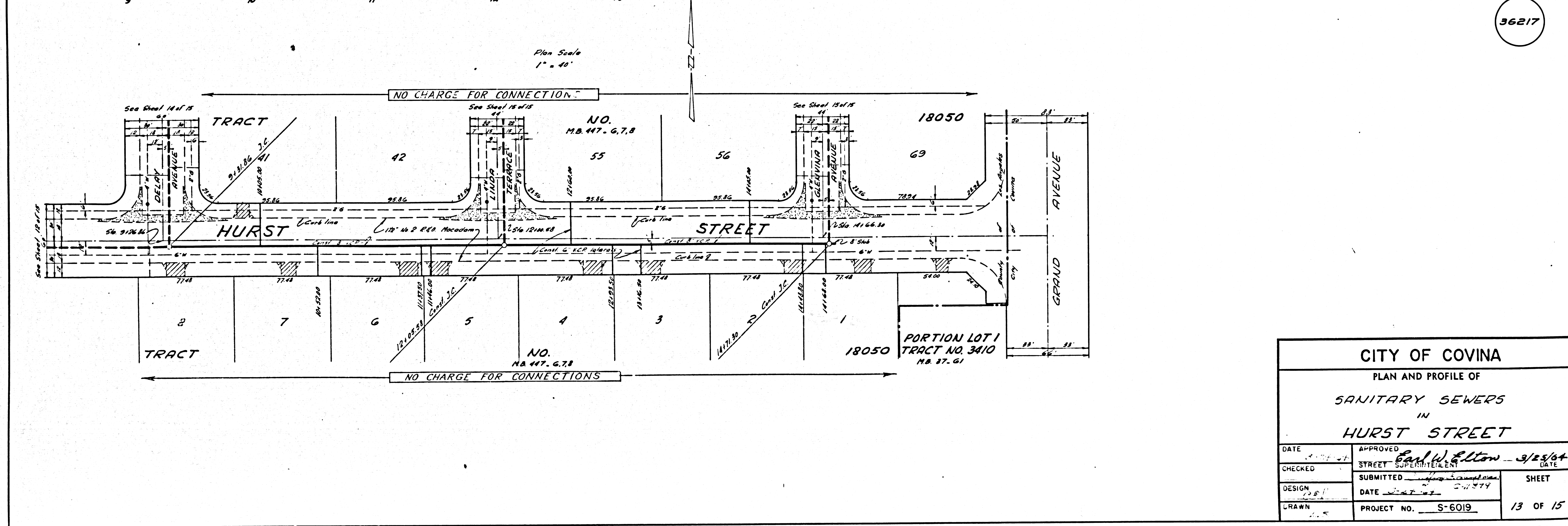

CITY OF COVINA			
PLAN AND PROFILE OF			
SANITARY SEWERS			
IN			
HURST STREET			
DATE	APPROVED	STREET SUPERINTENDENT	
CHECKED	DATE	SUBMITTED	
DESIGN	DATE	PROJECT NO.	
DRAWN	DATE	SHEET	
		13 OF 15	

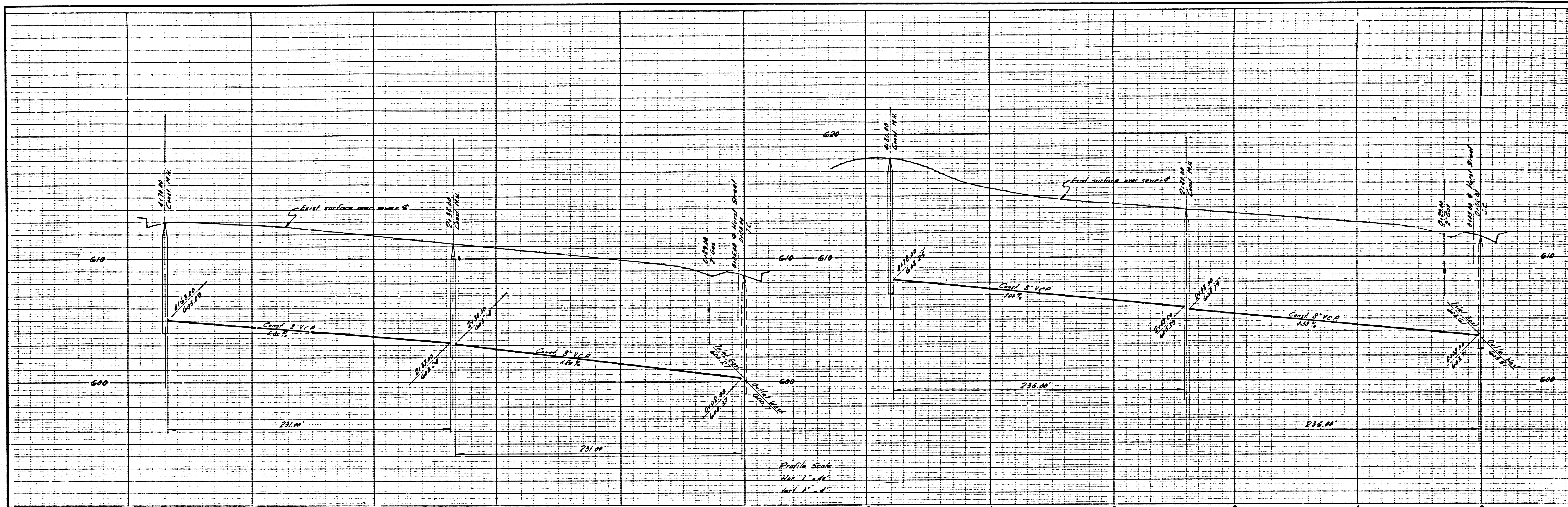

36218

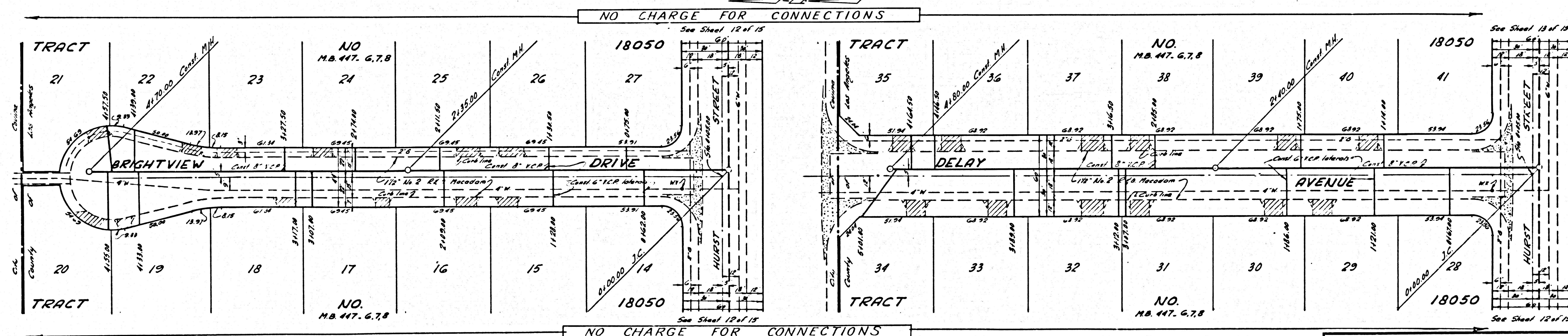

CITY OF COVINA			
PLAN AND PROFILE OF			
SANITARY SEWERS			
IN			
BRIGHTVIEW DRIVE AND DELAY AVENUE			
DATE	3-24-64	APPROVED	<i>Paul W. Elton</i> 3/25/64
CHECKED		STREET SUPERINTENDENT	
DESIGN	C.S.P.	SUBMITTED	C.S.P. 3/24/64
DRAWN	L.S.	PROJECT NO.	S-6019
			SHEET 14 OF 15

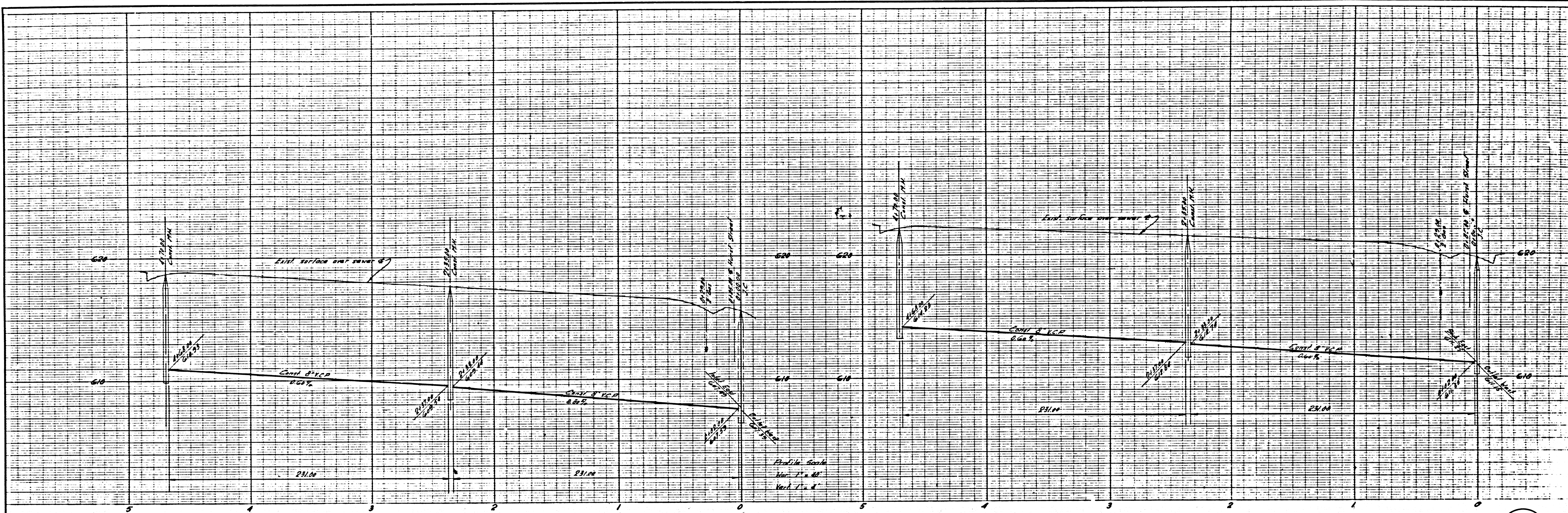

Plan Scale
1" = 40'

36219

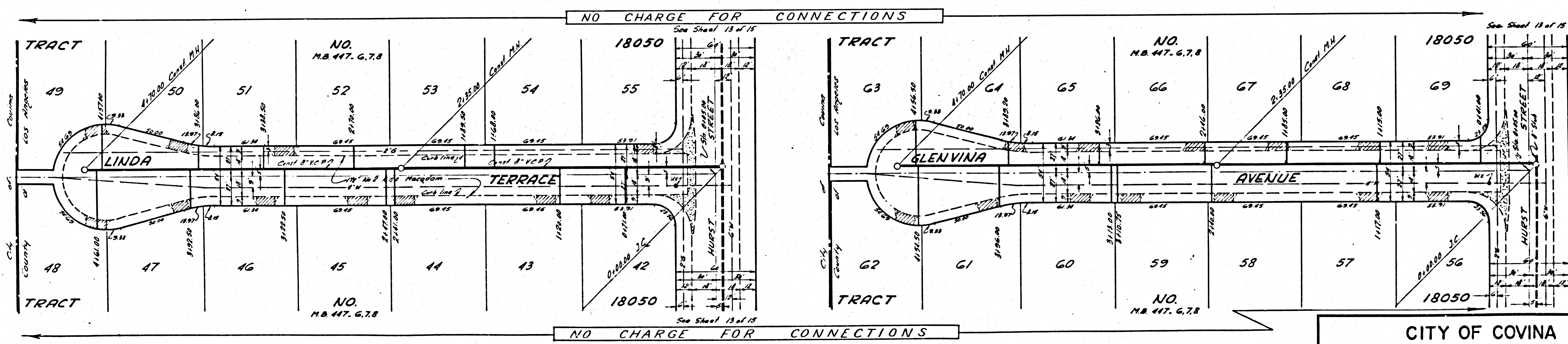

CITY OF COVINA		
PLAN AND PROFILE OF		
SANITARY SEWERS		
IN		
LINDA TERRACE AND GLENVINA AVENUE.		
DATE 3-24-64	APPROVED Paul W. Elton STREET SUPERINTENDENT	DATE 3/25/64
CHECKED	SUBMITTED C. J. ... C-11344	SHEET
DESIGN C.S.	DATE 3-24-64	15 OF 15
DRAWN L.S.	PROJECT NO. S-6019	