

PROJECT NO. 1
MIRA LOMA BLVD. W.
CHANGES BEARING COMPANY

B.M. 102-11A Elev. 2346.794 F.S. 2876, PAGE 6
AVE. 1 @ 330 MILES W. 60TH ST. W. 317.34 @ 1' AVE. 1
Button brass cap, North end of east headwall of Culvert

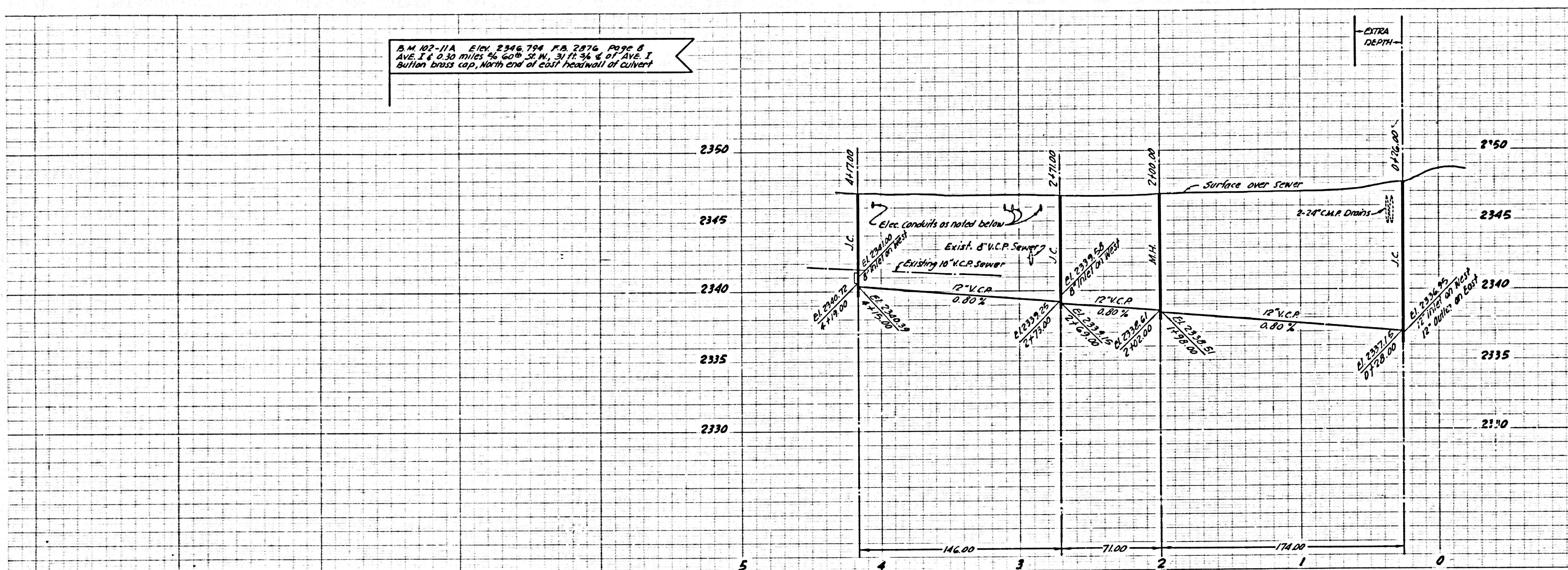

- GENERAL NOTES
1. USE EXTRA STRENGTH PIPE.
 2. USE MECHANICAL COMPRESSION JOINTS FOR ALL VITRIFIED CLAY PIPE PER SEC 36.138 OF STD SPEC.
 3. ALL STRUCTURES SHALL BE RIGID SEWER STRUCTURES AS PER PLAN NO 3-A-404.
 4. USE STANDARD WALKABLE FRAMES AND COVERS AS PER PLAN NO 3-A-177, ALL STATE AND LOCAL TRENCH SAFETY ORDERS WILL BE RIGIDLY ENFORCED.
 5. USE FORMULA NO 1 SEC 54 OF SPECIFICATIONS TO COMPUTE ALLOWABLE LEAKAGE.
 6. THE CONTRACTOR SHALL NOTIFY THE CONSTRUCTION DIVISION BY TELEPHONE MA 9-4747, EXT 01551 AT LEAST 24 HOURS BEFORE STARTING ANY WORK UNDER THIS CONTRACT.
 7. LOS ANGELES COUNTY STANDARD SPECIFICATIONS FOR SEWERS DATED MAY 25, 1962 SHALL APPLY TO THE CONSTRUCTION OF THIS PROJECT.
 8. ELEVATIONS ARE IN FEET ABOVE U.S.C. & G.S. SEA LEVEL DATUM OF 1929.
 9. APPROVAL OF THIS PLAN BY THE COUNTY OF LOS ANGELES DOES NOT CONSTITUTE A REPRESENTATION AS TO THE ACCURACY OF THE LOCATION OF OR THE EXISTENCE OR NON-EXISTENCE OF ANY UNDERGROUND UTILITY PIPE OR STRUCTURE WITHIN THE LIMITS OF THIS DRAWING.
 10. THIS DRAWING & THE DATA HEREON ARE HEREBY MADE A PART OF THE SPECIFICATIONS.
 11. FOR LEGEND SEE PLAN NO 3-A-64.
 12. GRADES TO WHICH THIS SEWER IS TO BE CONSTRUCTED ARE SHOWN ON THIS PLAN AND PROFILE AT ALL POINTS BETWEEN DESIGNATED POINTS THE GRADE SHALL BE ESTABLISHED SO AS TO CONFORM TO A STRAIGHT LINE BETWEEN SAID DESIGNATED POINTS.
 13. RESURFACE TRENCH WITHIN PAVED AREA WITH FRESH ROCK AND OIL TO A THICKNESS OF ONE INCH GREATER THAN THE EXISTING PAVEMENT AND IN NO EVENT LESS THAN TWO INCHES IN THICKNESS.

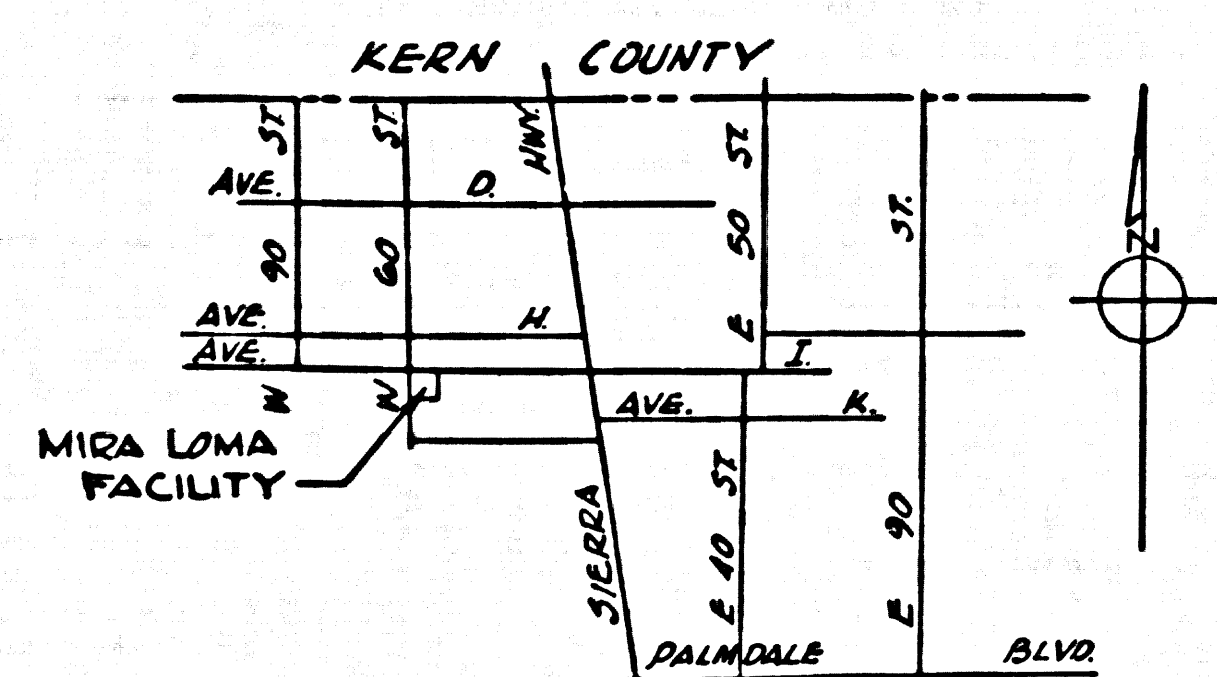

INDEX MAP
NO SCALE

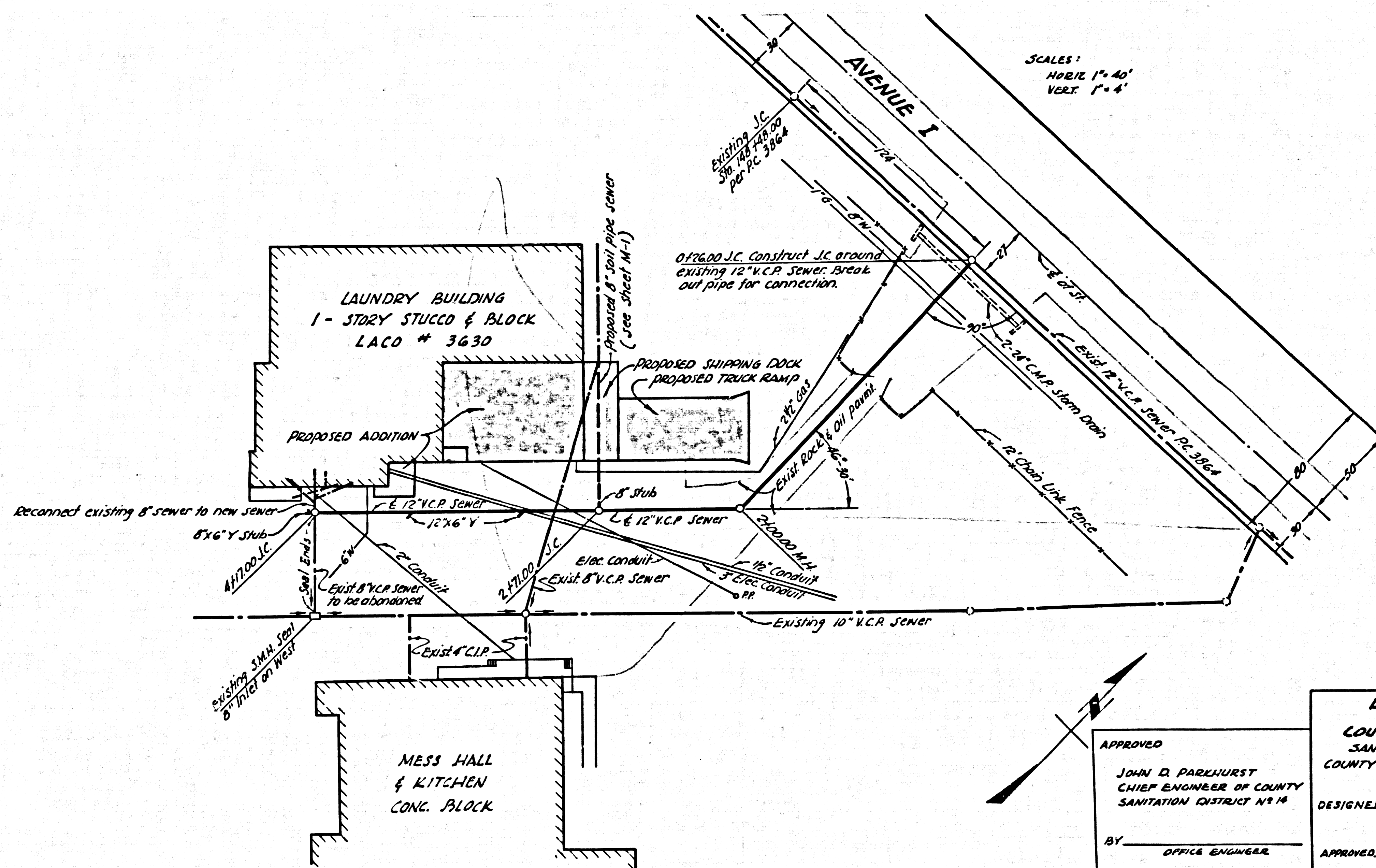

APPROVED
JOHN D. PARSHURST
CHIEF ENGINEER OF COUNTY
SANITATION DISTRICT NO 14
BY _____ OFFICE ENGINEER

DEPARTMENT
OF
COUNTY ENGINEER
SANITATION DIVISION
COUNTY OF LOS ANGELES
DESIGNED BY B. Valdez
RCE NO 10653
APPROVED _____ DIVISION ENGINEER

DATE
MAY 1964
DRAWN BY
G. ESYHRA
CHECKED BY
UNG
RC 6986
SCALE
AS SHOWN

SANITARY SEWER

LAUNDRY ADDITION
MIRA LOMA FACILITY
4500 N. AVE. 60 W.
LANCASTER, CALIFORNIA

SHEET NO
SAN-1