

B.M. SY 3516-A ELEV. 64.303  
 C.S. MON. IN WELL AT CENTERLINE  
 INTERSECTION OF LOMITA  
 BLVD. AND ESHELMAN AVENUE  
 BASELINE QUAD. 1955

LOMITA BLDG. DIST. NO. 12.01

PROFILE ALIGNMENT AND GRADE OF  
**SANITARY SEWERS** P.C. 7001  
 TO BE CONSTRUCTED IN PAGE 1

TRACT NO. 29498

PRIVATE CONTRACT NO. 7001

W.S. 28

1 SHEET OF 2 PAGES

SCALE: VERT. 1" = 4' HORIZ. 1" = 40'

APRIL 15, 1964

38288

PREPARED IN THE OFFICES OF  
**E.L. PEARSON & ASSOCIATES**  
 12545 WINTHROP WAY, WASHINGTON, D.C. 20541  
 502-2601  
 THOMAS C. CLARK - R.C.E. NO. 8787

FOR LEGEND SEE PLAN NO. S-1

**PRIVATE ENGINEER'S NOTICE TO CONTRACTORS**  
 THE EXISTENCE OF ANY LOCATION OF ANY UNDERGROUND UTILITY  
 PIPES OR STRUCTURES SHOWN ON THESE PLANS ARE OBTAINED  
 BY A SEARCH OF AVAILABLE RECORDS. TO THE BEST OF MY  
 KNOWLEDGE THERE ARE NO EXISTING UTILITIES EXCEPT AS  
 SHOWN ON THESE PLANS. THE CONTRACTOR IS REQUIRED TO  
 TAKE DUE PRECAUTIONARY MEASURES TO PROTECT THE UTILITY  
 LINES SHOWN AND OR ANY OTHER LINES OF RECORD OR NOT  
 SHOWN ON THESE PLANS.

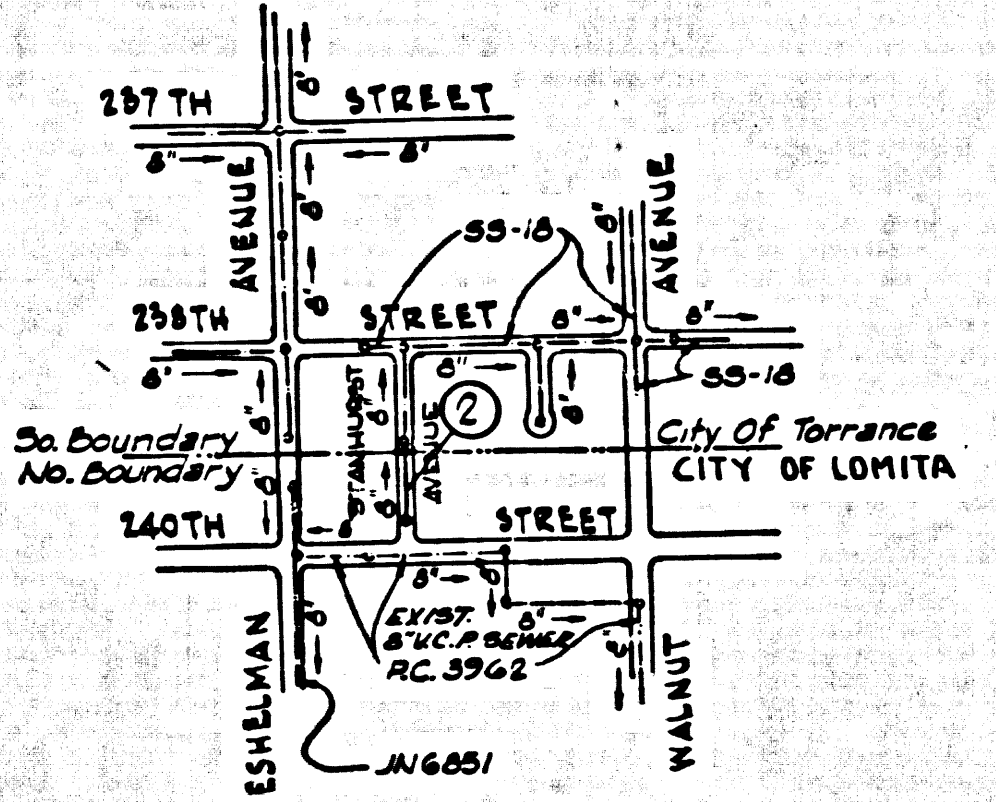

**INDEX MAP**  
 SCALE: 1" = 600'  
 TRACT NO. 29498

- NOTE:
1. PROVIDE STAKES ON THE PROPERTY LINE OR PROPERTY LINES PRODUCED AT RIGHT ANGLES TO THE SEWER LINE AT THE CENTER LINE OF EACH MANHOLE.
  2. NO REPRESENTATIVE OF THE CITY ENGINEER WILL SURVEY OR LAY OUT ANY PORTION OF THE WORK.
  3. THE PRIVATE ENGINEER SHALL FURNISH THE CITY ENGINEER WITH GRADE SHEETS AND STATIONING FOR ALL HOUSE LATERALS AND Y BRANCHES AND SHALL PROVIDE STAKES FOR THEM AT THEIR PROPER LOCATIONS WITH STATIONING PLAINLY MARKED. ALL HOUSE LATERALS SHALL BE CONSTRUCTED IN A STRAIGHT ALIGNMENT AT RIGHT ANGLES FROM THE MAIN LINE SEWER EXCEPT AS SHOWN ON THE PLANS. HOUSE LATERALS FROM CHIMNEYS SHALL NOT HAVE AN ANGLE OF LESS THAN 45° WITH THE MAIN LINE SEWER. ANY CHANGE IN ALIGNMENT SHALL BE REQUESTED IN WRITING BY THE PRIVATE ENGINEER.
  4. THE PRIVATE ENGINEER SHALL FURNISH THE HOUSE LATERAL DEPTH AT THE PROPERTY LINE BELOW THE TOP OF CURB ELEVATION FOR EACH HOUSE LATERAL ON THE GRADE SHEET.
  5. NO REVISIONS SHALL BE MADE IN THESE PLANS WITHOUT THE APPROVAL OF THE CITY ENGINEER.
  6. THE CONTRACTOR SHALL NOTIFY THE CONSTRUCTION DIVISION BY TELEPHONE, MADISON 9-4747, EXT. 5581, AT LEAST TWENTY-FOUR HOURS BEFORE STARTING ANY WORK UNDER THIS CONTRACT.
  7. MANHOLES SHALL BE BRICK SEWER STRUCTURES PER S-3. PRECAST CONCRETE MANHOLES PER S-5 OR S-6 MAY BE USED AS AN ALTERNATE IN LOCATIONS APPROVED BY THE COUNTY ENGINEER.
  8. USE STANDARD MANHOLE FRAMES AND COVERS, S-15, EXCEPT AS NOTED.
  9. MANHOLE TOPS IN UNIMPAVED RIGHTS-OF-WAY TO BE SIX INCHES ABOVE FINISHED GRADE.
  10. USE EXTRA STRENGTH PIPE. ALL PIPE IS STANDARD DEPTH EXCEPT AS NOTED.
  11. USE MECHANICAL COMPRESSION JOINTS FOR ALL V.C.P. JOINTS PER SPECS. SECS. 36 & 46, 49.
  12. ALL STATE & LOCAL TRENCH SAFETY ORDERS WILL BE RIGIDLY ENFORCED.
  13. IF A POWER POLE IS WITHIN THREE FEET OF THE SEWER, THE SEWER SHALL BE ENCASED, PER S-23 CASE III, TWO FEET ON EACH SIDE FROM THE POINT OF INTERFERENCE.
  14. IF DURING THE COURSE OF CONSTRUCTION IT IS DETERMINED THAT THERE IS LESS THAN FOUR FEET OF COVER OVER THE TOP OF A MAIN LINE OR HOUSE LATERAL V.C.P. SEWER WHICH IS NOT INDICATED ON THE PLANS, THE PIPE SHALL BE ENCASED PER S-23 CASE II, UNLESS OTHERWISE APPROVED BY THE CITY ENGINEER.
  15. HOUSE LATERALS TO BE CONSTRUCTED WITH INVERTS AT PROPERTY LINE... 9" FEET BELOW CURB GRADE EXCEPT AS NOTED.
  16. REINFORCE ALL TRENCHES WITHIN PAVED AREAS TO MEET CITY ROAD DEPT. OR CALIFORNIA STATE HIGHWAY REQUIREMENTS IN ACCORDANCE WITH PERMITS.
  17. FOR ALLOWABLE LEAKAGE TEST USE FORMULA NO. 2, SPECS. SEC. 54.

NOTE: LOT 9 SERVED BY HOUSE LATERAL FROM EXISTING SEWER IN 240<sup>TH</sup> ST.

NO CONNECTIONS FOR THE DISPOSAL OF  
 INDUSTRIAL WASTES SHALL BE MADE TO  
 SEWERS SHOWN ON THESE DRAWINGS  
 WITHOUT WRITTEN PERMISSION FROM THE  
 CHIEF ENGINEER AND GENERAL MANAGER  
 OF THE COUNTY SANITATION DISTRICTS.

**COLLECT CHARGES  
 AS INDICATED**

*L. Carter 2-4-65*

CITY OF TORRANCE  
 ENGINEERING DIVISION  
 CHECKED BY: *L.H.B. H.L.*  
 APPROVED: *W.M. Miller*  
 DATE: Nov 9, 1965  
 CITY ENGINEER R.C.E. NO. 8415

CITY OF LOMITA, CALIFORNIA  
 JOHN A. LAMBIE, CITY ENGINEER  
 J. D. PARKHURST, CHIEF ENGINEER  
 CO. SAN. DIST. NO. 3  
 APPROVED BY: *John A. Lambie*  
 ASSISTANT SANITATION ENGINEER  
 APPROVED BY: *J. D. Parkhurst*  
 OFFICE ENGINEER  
 SUBMITTED BY: *W.M. Miller*  
 REGIONAL ENGINEER  
 CHECKED BY: *W.M. Miller*  
 R.C.E. NO. 8415

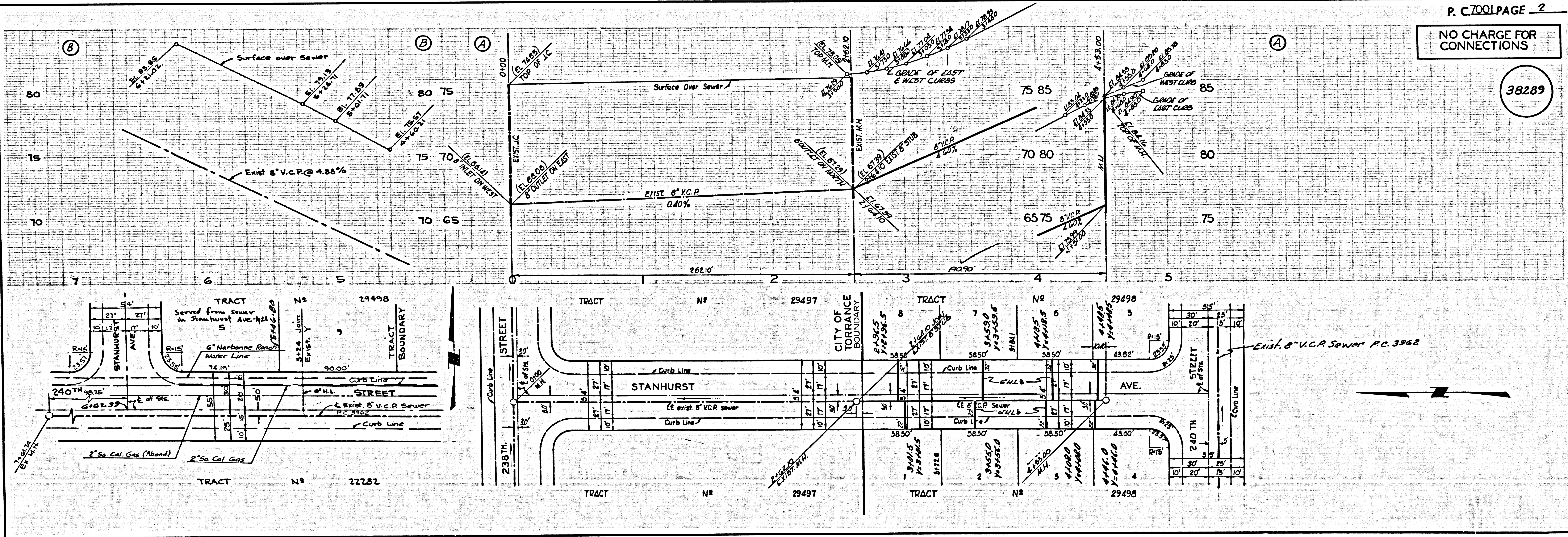

P. C. 7001 PAGE 2  
**NO CHARGE FOR  
 CONNECTIONS**

38289

TRACT NO. 29498