

BM. LE 113 ELEV. 667.823  
 Cienega Ave. & Janifer Ave. N.E. Cor.  
 5' N. of N. End of Curb Return Bit  
 Spk. in Curb.

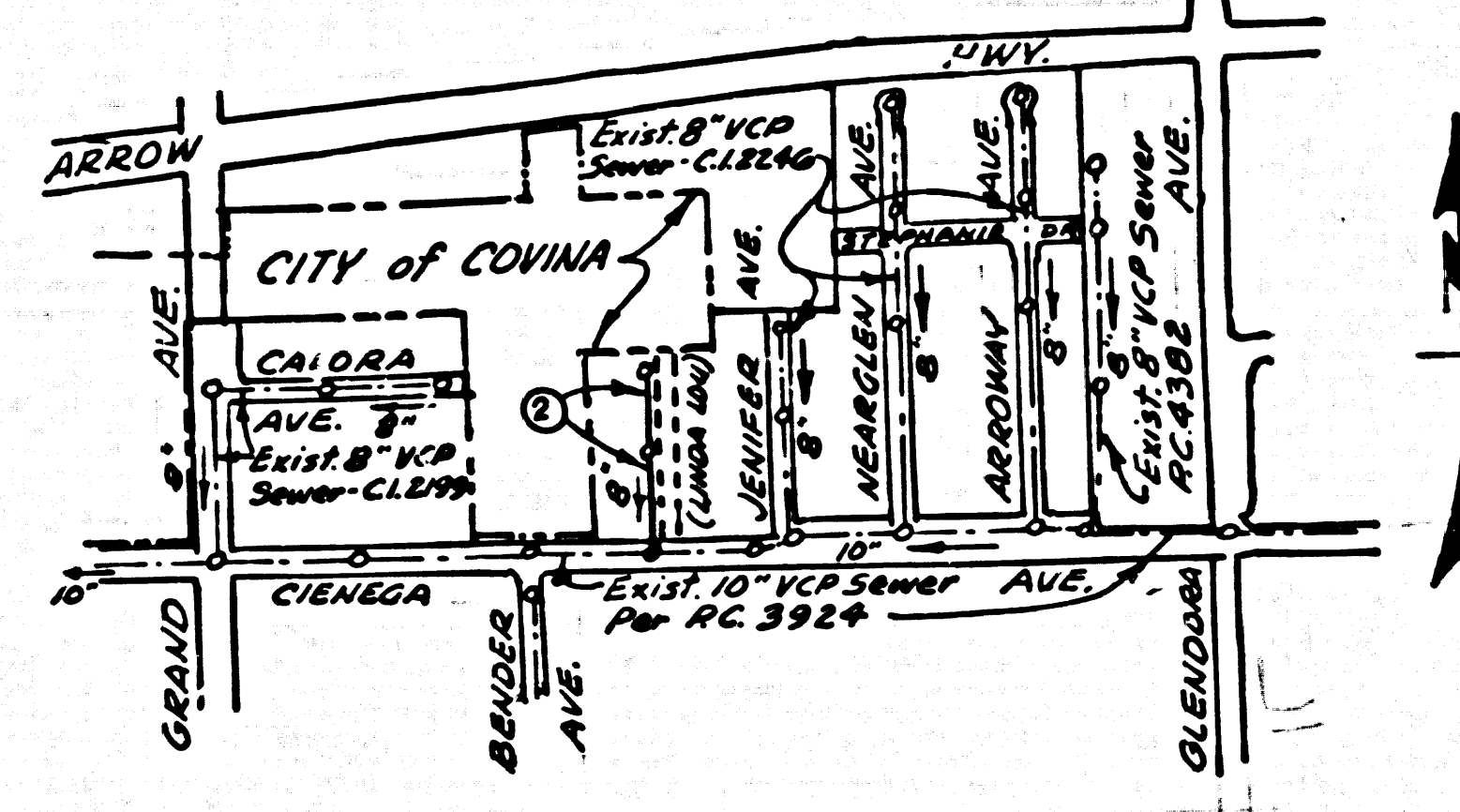

INDEX MAP  
 P.C. 7065  
 SCALE: 1"=600'

NO CONNECTIONS FOR THE DISPOSAL OF INDUSTRIAL WASTES SHALL BE MADE TO SEWERS SHOWN ON THESE DRAWINGS WITHOUT WRITTEN PERMISSION FROM THE CHIEF ENGINEER AND GENERAL MANAGER OF THE COUNTY SANITATION DISTRICTS.

DO NOT ISSUE HOUSE CONNECTION PERMITS UNTIL R/W IS CLEAR

SAN DIMAS BLDG. DIST. NO. 10

- NOTES:
1. PROVIDE STAKES ON THE PROPERTY LINE OR PROPERTY LINES PRODUCED AT RIGHT ANGLES TO THE SEWER LINE AT THE CENTER LINE OF EACH MANHOLE.
  2. NO REPRESENTATIVE OF THE COUNTY ENGINEER WILL SURVEY OR LAY OUT ANY PORTION OF THE WORK.
  3. THE CONTRACTOR SHALL BE RESPONSIBLE FOR THE PROTECTION OF ALL EXISTING UTILITIES AND SHALL BE RESPONSIBLE FOR THE PROTECTION OF ALL EXISTING UTILITIES WITH STAKES AND MARKS PLACED. ALL EXISTING UTILITIES SHALL BE PROTECTED BY THE CONTRACTOR AT HIS OWN EXPENSE.
  4. THE PRIVATE ENGINEER SHALL FURNISH THE HOUSE LATERAL DEPTH AT THE PROPERTY LINE BELOW THE TOP OF CURB ELEVATION FOR EACH HOUSE LATERAL ON THE GRADE SHEET.
  5. NO REVISIONS SHALL BE MADE IN THESE PLANS WITHOUT THE APPROVAL OF THE COUNTY ENGINEER.
  6. USE STANDARD MANHOLE FRAMES AND COVERS, 5'-11" DIA. UNLESS NOTED.
  7. USE EXTRA STRENGTH PIPE, ALL PIPES TO BE STANDARD DEPTH.
  8. USE JACOBSBURG COMPRESSION JOINTS ALL FOR ALL T.C.A. JOINTS PER SPEC. SECT. 11 & 12 OF 49.
  9. RESURFACE ALL TRENCH WITH PAVEMENT TO MEET L.A. COUNTY ROAD DEPT. OR CALIF. STATE HIGHWAY REQUIREMENTS IN ACCORDANCE WITH PERMITS.
  10. IF A HOUSE POLE IS WITHIN THREE FEET OF THE SEWER, THE SEWER SHALL BE ENCASED PER S-172. CASE BE TWO FEET ON EITHER SIDE FROM THE POINT OF INTERFERENCE.
  11. HOUSE LATERALS TO BE CONSTRUCTED WITH 1/2" ROSE PER FOOT TO R/W LINE.
  12. MANHOLES SHALL BE BRICK SEWER STRUCTURES, 5'-10" PRECAST CONC. MANHOLES PER S-172 OR S-173 FOR ALLOWABLE LEAKAGE TEST USE FORMULA NO. 2 APPROVED BY THE COUNTY ENGINEER.
  13. MANHOLE TOPS IN IMPROVED RIGHTS-OF-WAY TO BE LEVEL WITH FINISHED GRADE.
  14. THE CONTRACTOR SHALL NOTIFY THE CONSTRUCTION DIVISION BY TELEPHONE, MADISON 5-4741, AT LEAST TWENTY-FOUR HOURS BEFORE STARTING ANY WORK UNDER THIS CONTRACT.
  15. ALL STATE & LOCAL TRENCH SAFETY ORDERS WILL BE RIGIDLY ENFORCED.
  16. IF DURING THE COURSE OF CONSTRUCTION IT IS DETERMINED THAT THERE IS LESS THAN FOUR FEET OF COVER OVER THE TOP OF THE MAIN LINE OR HOUSE LATERAL V.C.P. PIPE WHICH IS NOT INDICATED ON THE PLANS, THE PIPE SHALL BE ENCASED PER S-172, CASE III UNLESS OTHERWISE APPROVED BY THE COUNTY ENGINEER.
  17. THE PRIVATE ENGINEER SHALL FURNISH THE COUNTY ENGINEER WITH GRADE SHEETS AND STAKING FOR ALL HOUSE LATERALS AND V BRANCHES AND SHALL PROVIDE STAKES FOR THEM AT THEIR PROPER LOCATIONS WITH 5' TYPING PLAINLY MARKED. ALL HOUSE LATERALS SHALL BE CONSTRUCTED IN A STRAIGHT ALIGNMENT AT RIGHT ANGLES FROM THE MAIN LINE SEWER EXCEPT AS SHOWN ON THE PLANS. HOUSE LATERALS FROM CHIMNEYS, SHALL NOT HAVE AN ANGLE OF LESS THAN 45° WITH THE MAIN LINE SEWER. ANY CHANGES IN ALIGNMENT SHALL BE REQUESTED IN WRITING BY THE PRIVATE ENGINEER.

COLLECT CHARGES AS INDICATED  
 D. R. Olson 9-14-64

PROFILE ALIGNMENT AND GRADE OF P.C. 7065  
 SANITARY SEWERS PAGE 1

TO BE CONSTRUCTED IN  
 R/W NORTH OF CIENEGA AVE.

PRIVATE CONTRACT NO. 7065

W.S. 48  
 1 SHEETS, 2 PAGES

SCALE: VERT. 1"=4'  
 HORIZ. 1"=40'  
 JULY, 1964

PREPARED IN THE OFFICES OF  
 CONSOLIDATED ENGINEERING CO.

By: Enrique Revolt  
 REG. C. E. NO. 10915

FOR LEGEND SEE PLAN NO. S-A-64

NOTE:  
 GRADES TO WHICH THIS IMPROVEMENT IS TO BE CONSTRUCTED ARE SHOWN ON PLANS AND PROFILES. GRADE POINTS FOR TOP OF CURB, CENTER LINE OF STREETS, OR CENTER LINE OF ALLEYS ARE SHOWN BY CIRCLES ON PROFILES. AT ALL POINTS BETWEEN DESIGNATED POINTS THE GRADE SHALL BE ESTABLISHED SO AS TO CONFORM TO A STRAIGHT LINE DRAWN BETWEEN SAID DESIGNATED POINTS.  
 ELEVATIONS ARE IN FEET ABOVE U.S.C. & G.S. SEA LEVEL DATUM OF 1929.  
 THIS DRAWING AND THE DATA HEREON ARE HEREBY MADE A PART OF THE SPECIFICATIONS.  
 WORK SHALL BE CONSTRUCTED ACCORDING TO STANDARD SPECIFICATIONS DATED MAY 26, 1962 IN FILE IN THE COUNTY ENGINEER'S OFFICE AND SHALL BE INSPECTED ONLY IN THE PRESENCE OF THE COUNTY ENGINEER.  
 BEFORE WORK CAN BE STARTED THE CONTRACTOR MUST OBTAIN A PERMIT TO EXCAVATE IN COUNTY STREETS FROM THE L.A. COUNTY ROAD DEPT., DISTRICT OFFICE NO. 1 AND PAY A FEE TO THE COUNTY ENGINEER'S ROOM 340 JEB W. ST., L.A. OR SAN DIMAS REG. OFFICE SUFFICIENT TO COVER THE COST OF CONSTRUCTION INSPECTION AND RECORD PLANS.  
 APPROVAL OF THIS PLAN BY THE COUNTY OF LOS ANGELES DOES NOT CONSTITUTE A REPRESENTATION AS TO THE ACCURACY OF THE LOCATION OF OR THE EXISTENCE OR NON-EXISTENCE OF ANY UNDERGROUND UTILITY PIPE OR STRUCTURE WITHIN THE LIMITS OF THIS PROJECT. THIS NOTE APPLIES TO ALL PAGES.  
 IF WORK IS TO BE DONE IN A STATE HIGHWAY, A PERMIT MUST BE OBTAINED FROM THE STATE OF CALIFORNIA, DIVISION OF HIGHWAYS, 128 SOUTH SPRING STREET.

COUNTY OF LOS ANGELES, CALIFORNIA

APPROVED, JOHN A. LAMBIE, COUNTY ENGINEER APPROVED, J.D. DRENNING, CHIEF ENGINEER  
 803 SAN. DIST. NO. 22

APPROVED BY: [Signature] ASSISTANT SANITATION ENGINEER APPROVED BY: [Signature] OFFICE ENGINEER  
 CHECKED BY: [Signature] 9-15-64  
 OFFICE OF COUNTY ENGINEER, REG. C. E. NO. 11636

SUBMITTED: Gordon W. Reigel  
 SAN DIMAS REGIONAL ENGINEER  
 JN 036371

P.C. 7065 PAGE 2

COLLECT CHARGES AS INDICATED

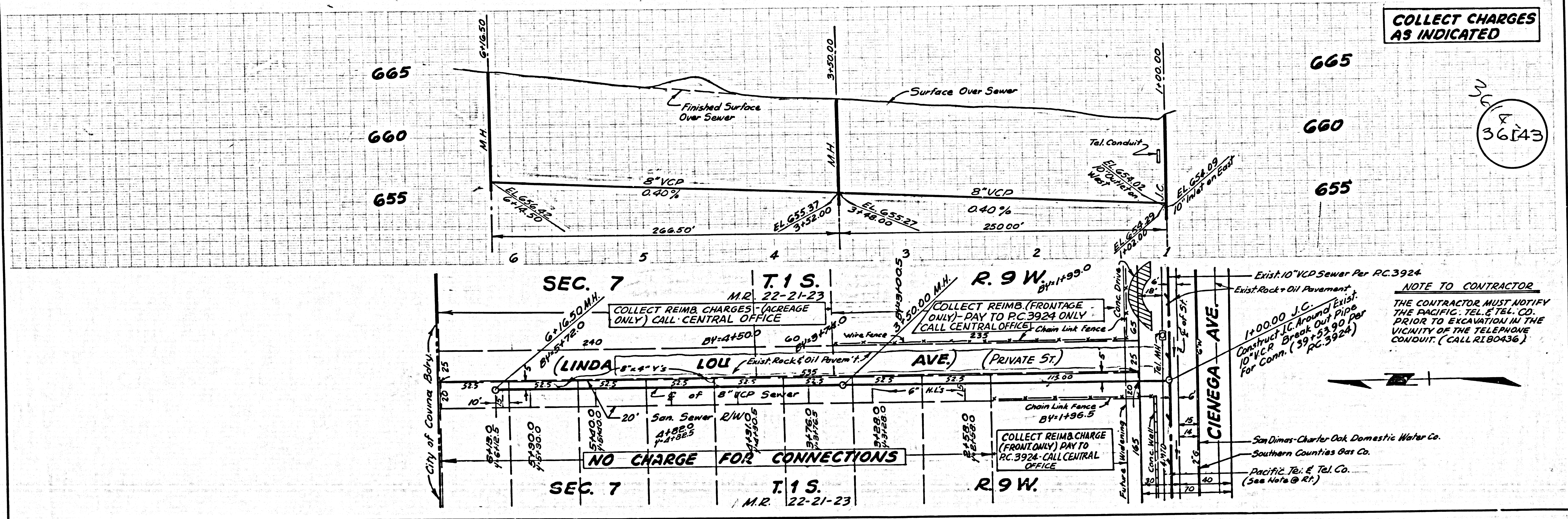

NO CHARGE FOR CONNECTIONS

COLLECT REIMB. CHARGE (FRONT ONLY) PAY TO P.C. 3924 CALL CENTRAL OFFICE

NOTE TO CONTRACTOR:  
 THE CONTRACTOR MUST NOTIFY THE PACIFIC TEL. & TEL. CO. PRIOR TO EXCAVATION IN THE VICINITY OF THE TELEPHONE CONDUIT. (CALL REB0436)

100.00 J.C. Construct J.C. Around Existing 10" V.C.P. Break Out Pipe For Conn. (39-52-90 per P.C. 3924)

San Dimas-Charter Oak Domestic Water Co.  
 Southern Counties Gas Co.  
 Pacific Tel. & Tel. Co.  
 (See Note @ RP.)