

B.M. SL 611 ELEV. 1155.290  
 USC U.S. Br. Man in South End of  
 Conn. Head of S.P.R.R. 235' E of C/L  
 Bouquet Can. Rd. 0.4 mi. N. 1st  
 San Fernando R. Man. 1898 1955  
 NEWHALL QUAD. 19 58

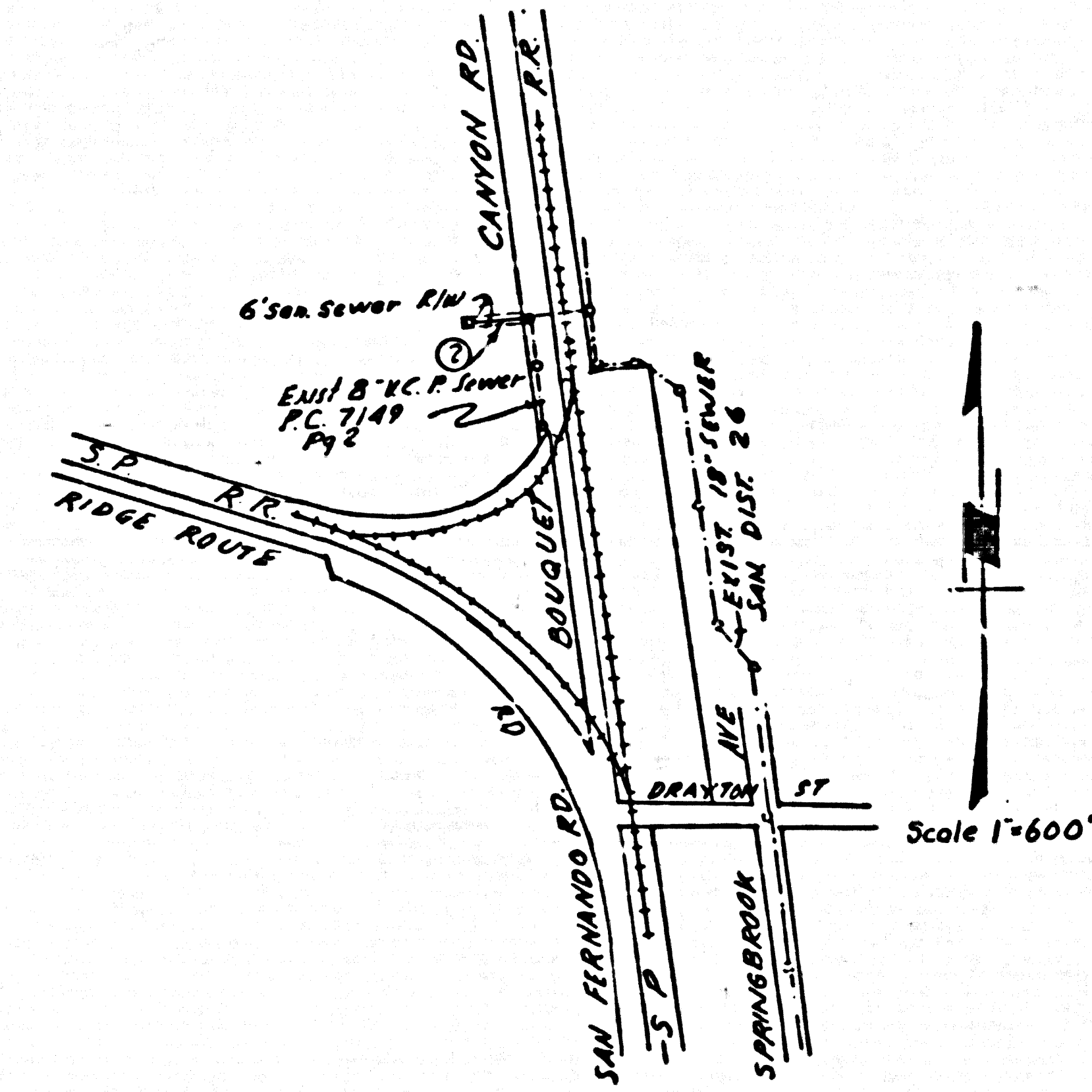

Note: Number in circle indicates page numbers  
 INDEX MAP  
 P.C. 7208

DO NOT ISSUE CONNECTION PERMITS  
 UNTIL P.C. 7149 HAS BEEN  
 COMPLETED AND ACCEPTED

COLLECT CHARGES  
 AS INDICATED  
 L.A. 5-5-65

NEWHALL BLDG. DIST. NO. 8.2

PROFILE ALIGNMENT AND GRADE OF  
 SANITARY SEWERS  
 CONSTRUCTED IN  
 P.C. 7208  
 PAGE 1

RIGHT OF WAY  
 WEST OF BOUQUET CANYON RD.  
 PRIVATE CONTRACT NO. 7208

W.S. 62  
 1 SHEET 2 PAGES  
 JAN 1965

PREPARED IN THE OFFICES OF  
 ANDEL ENGINEERING COMPANY  
 BY E. J. Anderson  
 REG. C.E. NO. 1011

FOR LEGEND SEE PLAN NO. S-1

- NOTES:
1. PROVIDE STAKES ON THE PROPERTY LINE OR PROPERTY LINES PRODUCED AT RIGHT ANGLES TO THE SEWER LINE AT THE CENTER LINE OF EACH MANHOLE.
  2. THE PRIVATE ENGINEER OF THE COUNTY ENGINEER WILL SURVEY OR LAY OUT ANY PORTION OF THE WORK.
  3. THE PRIVATE ENGINEER SHALL NUMBER THE COUNTY ENGINEER WITH GRADE SHEETS AND STATIONINGS FOR ALL HOUSE LATERALS AND Y BRANCHES AND SHALL PROVIDE STAKES FOR THEM AT THEIR PROPER LOCATIONS WITH STATIONING PLAINLY MARKED. THE HOUSE LATERALS SHALL BE CONSTRUCTED IN A STRAIGHT ALIGNMENT AS SHOWN UNLESS OTHERWISE INDICATED. THE HOUSE LATERALS SHALL BE CONSTRUCTED IN A STRAIGHT ALIGNMENT UNLESS OTHERWISE INDICATED. THE HOUSE LATERALS SHALL BE CONSTRUCTED IN A STRAIGHT ALIGNMENT UNLESS OTHERWISE INDICATED.
  4. THE CONTRACTOR SHALL NOTIFY THE CONSTRUCTION DIVISION BY TELEPHONE, MANHOLE 7-27, EXT. 8138, AT LEAST TWENTY-FIVE (25) HOURS BEFORE STARTING ANY WORK UNDER THIS CONTRACT.
  5. MANHOLES SHALL BE BUILT TO THE DEPTH SPECIFIED IN THE PLANS, THE PIPE SHALL BE BUILT TO THE DEPTH SPECIFIED IN THE PLANS, THE PIPE SHALL BE BUILT TO THE DEPTH SPECIFIED IN THE PLANS.
  6. USE STANDARD MANHOLE FRAMES AND COVERS, 5-15, SPEC. AS NOTED.
  7. MANHOLE TOPS IN UNIMPROVED RIGHTS-OF-WAY TO BE SIX INCHES ABOVE FINISHED GRADE.
  8. USE EXTRA STRENGTH PIPE. ALL PIPE IS STANDARD DEPTH UNLESS OTHERWISE NOTED.
  9. USE STANDARD MECHANICAL COMPRESSION JOINTS FOR ALL V.C.P. JOINTS PER SPEC., SEC. 34 & 40 (41).
  10. WHENEVER OVERHEAD WATER IS ENCOUNTERED DURING THE CONSTRUCTION OF THE SEWERS, THE V.C.P. JOINTS SHALL BE OF JOINT COMPRESSOR PER SPEC., SEC. 34 & 40 (41) OR MECHANICAL COMPRESSION JOINTS PER SPEC., SEC. 34 & 40 (41).
  11. IF A POWER POLE IS WITHIN THREE FEET OF THE SEWER, THE SEWER SHALL BE ENCASED PER S-23 - TWO FEET ON EITHER SIDE FROM THE POINT OF INTERFERENCE.
  12. IF DURING THE COURSE OF CONSTRUCTION IT IS DETERMINED THAT THERE IS LESS THAN FOUR FEET OF COVER OVER THE TOP OF A MAIN LINE OR HOUSE LATERAL V.C.P. SEWER WHICH IS NOT INDICATED ON THE PLANS, THE PIPE SHALL BE ENCASED PER S-23 UNLESS OTHERWISE APPROVED BY THE COUNTY ENGINEER.
  13. HOUSE LATERALS TO BE CONSTRUCTED WITHIN THE RIGHT-OF-WAY OF THE SANITARY SEWER SHALL BE CONSTRUCTED AS NOTED.
  14. RESURFACE ALL TRENCHES WITHIN PAVED AREAS TO MEET L.A. COUNTY ROAD DEPT. OR CALIFORNIA STATE HIGHWAY REQUIREMENTS IN ACCORDANCE WITH PERMITS.
  15. FOR ALLOWABLE LEAKAGE TEST USE FORMULA NO. 2 PER SPEC., SEC. 54.
  16. ALL State and Local Trench Safety orders will be rigidly enforced.

Utilities are shown according to available records  
 It shall be the responsibility of the contractor  
 to determine the exact location of all utilities  
 and their service connections.

NO CONNECTIONS FOR THE DISPOSAL OF  
 INDUSTRIAL WASTES SHALL BE MADE TO  
 SEWERS SHOWN ON THESE DRAWINGS  
 WITHOUT WRITTEN PERMISSION FROM THE  
 CHIEF ENGINEER AND GENERAL MANAGER  
 OF THE COUNTY SANITATION DISTRICTS.

NOTE:  
 GRADES TO WHICH THE IMPROVEMENTS ARE TO BE CONSTRUCTED ARE SHOWN ON PLANS AND PROFILES. GRADE POINTS FOR TOP OF CURBS, CENTER LINE OF STREETS, OR CENTER LINE OF ALLEYS ARE SHOWN BY CHECKS ON PROFILES AT ALL POINTS SET WITH DESIGNATED POINTS THE GRADE SHALL BE ESTABLISHED SO AS TO CONFORM TO A STRAIGHT LINE DRAWN BETWEEN SAID DESIGNATED POINTS. ELEVATIONS ARE IN FEET ABOVE U.S.C. & G.S. MEAN SEA LEVEL DATUM OF 1929.  
 THIS DRAWING AND THE DATA HEREON ARE HEREBY MADE A PART OF THE SPECIFICATIONS.  
 WORK SHALL BE CONSTRUCTED ACCORDING TO STANDARD SPECIFICATIONS DATED 12-1-1964 ON FILE IN THE OFFICE OF THE COUNTY ENGINEER AND SHALL BE PROSECUTED ONLY IN THE PRESENCE OF THE COUNTY ENGINEER.  
 BEFORE WORK CAN BE STARTED, THE CONTRACTOR MUST OBTAIN A PERMIT TO EXCAVATE IN COUNTY STREETS FROM THE L.A. COUNTY ROAD DEPT., DISTRICT OFFICE NO. 1 AND PAY A FEE TO THE COUNTY ENGINEER, ROOM 308, COUNTY ENGINEER'S BUILDING, 100 WEST SECOND STREET, LOS ANGELES, CALIFORNIA. REGIONAL OFFICE, SUPPLIERS TO COVER THE COST OF CONSTRUCTION INSPECTION AND RECORD PLANS.  
 APPROVAL OF THIS PLAN BY THE COUNTY OF LOS ANGELES DOES NOT CONSTITUTE A REPRESENTATION AS TO THE ACCURACY OF THE LOCATION OR OF THE EXISTENCE OR NON-EXISTENCE OF ANY UNDERGROUND UTILITY PIPE, OR STRUCTURE WITHIN THE LIMITS OF THE PROJECT. THIS NOTE APPLIES TO ALL PAGES.  
 IF WORK IS TO BE DONE IN A STATE HIGHWAY, A PERMIT MUST BE OBTAINED FROM THE STATE OF CALIFORNIA, DIVISION OF HIGHWAYS, 120 SOUTH SPRING STREET, LOS ANGELES, CALIFORNIA.

COUNTY OF LOS ANGELES, CALIFORNIA  
 JOHN A. LAMBIE, COUNTY ENGINEER  
 APPROVED BY: [Signature]  
 J. D. PARKHURST, CHIEF ENGINEER  
 APPROVED BY: [Signature]  
 SUBMITTED BY: [Signature]  
 CHECKED BY: [Signature]

J.N. 0364.67

