

B.M. 51-3071-A ELEV. 33.103  
 Found Square head spike near center  
 of curb 1840, N.E. corner of LOMITA  
 BOULEVARD and VERMONT AVENUE  
 1" North of L.T.  
 BASE LINE QUAD. 19 55

LOMITA — BLDG. DIST. NO. 12

R/W EAST OF VERMONT AVENUE

PRIVATE CONTRACT NO. 7238

W.S. 28  
 1 SHEET 2 PAGES  
 SCALE: HORIZ. 1"=40' VERT. 1"=4'

JANUARY, 1965  
 PREPARED BY THE OFFICES OF  
**E.L. PEARSON & ASSOCIATES**  
 By: *James C. Clark*  
 REG. C. E. NO. 9737

FOR LEGEND SEE PLAN NO. S-1

NOTE:  
 GRADES TO WHICH THIS IMPROVEMENT IS TO BE CONSTRUCTED ARE SHOWN ON PLANS AND PROFILES. GRADE POINTS FOR TOP OF CURBS, CENTER LINE OF STREETS, OR CENTER LINE OF ALLEYS ARE SHOWN BY CIRCLES ON PROFILES. AT ALL POINTS BETWEEN DESIGNATED POINTS THE GRADE SHALL BE ESTABLISHED SO AS TO CONFORM TO A STRAIGHT LINE DRAWN BETWEEN SAID DESIGNATED POINTS. ELEVATIONS ARE BY FEET ABOVE U.S.C. & G.S. SEA LEVEL DATUM OF 1929.  
 THIS DRAWING AND THE DATA HEREON ARE HEREBY MADE A PART OF THE SPECIFICATIONS. BEFORE WORK CAN BE STARTED, THE CONTRACTOR MUST OBTAIN A PERMIT TO EXCAVATE IN COUNTY STREETS FROM THE L.A. COUNTY ROAD DEPT., DISTRICT OFFICE NO. 3, AND PAY A FEE TO THE COUNTY ENGINEER, ROOM 388, COUNTY ENGINEERING BUILDING, 100 WEST SECOND STREET OR THE DISTRICT OFFICE, DISTRICT OFFICE NO. 3, DISTRICT OFFICE, SUPERVISOR TO COVER THE COST OF CONSTRUCTION INSPECTION AND RECORD PLANS.  
 APPROVAL OF THIS PLAN BY THE COUNTY OF LOS ANGELES DOES NOT CONSTITUTE A REPRESENTATION AS TO THE ACCURACY OF THE LOCATION OF OR THE EXISTENCE OR NON-EXISTENCE OF ANY UNDERGROUND UTILITY PIPE, OR STRUCTURE WITHIN THE LIMITS OF THIS PROJECT. THIS NOTE APPLIES TO ALL PAGES.  
 IF WORK IS TO BE DONE IN A STATE HIGHWAY, A PERMIT MUST BE OBTAINED FROM THE STATE OF CALIFORNIA, DIVISION OF HIGHWAYS, 120 SOUTH SPRING STREET, LOS ANGELES, CALIFORNIA.

COUNTY OF LOS ANGELES, CALIFORNIA  
 JOHN A. LAMBIE, COUNTY ENGINEER J. D. PARKHURST, CHIEF ENGINEER  
 APPROVED BY: *James C. Clark* ASSESSOR SANITATION ENGINEER APPROVED BY: *J. D. Parkhurst* OFFICE ENGINEER

CHECKED BY: *W. W. Wade* 1-12-65  
 REG. C. E. NO. 3425

J.N. 0366.10

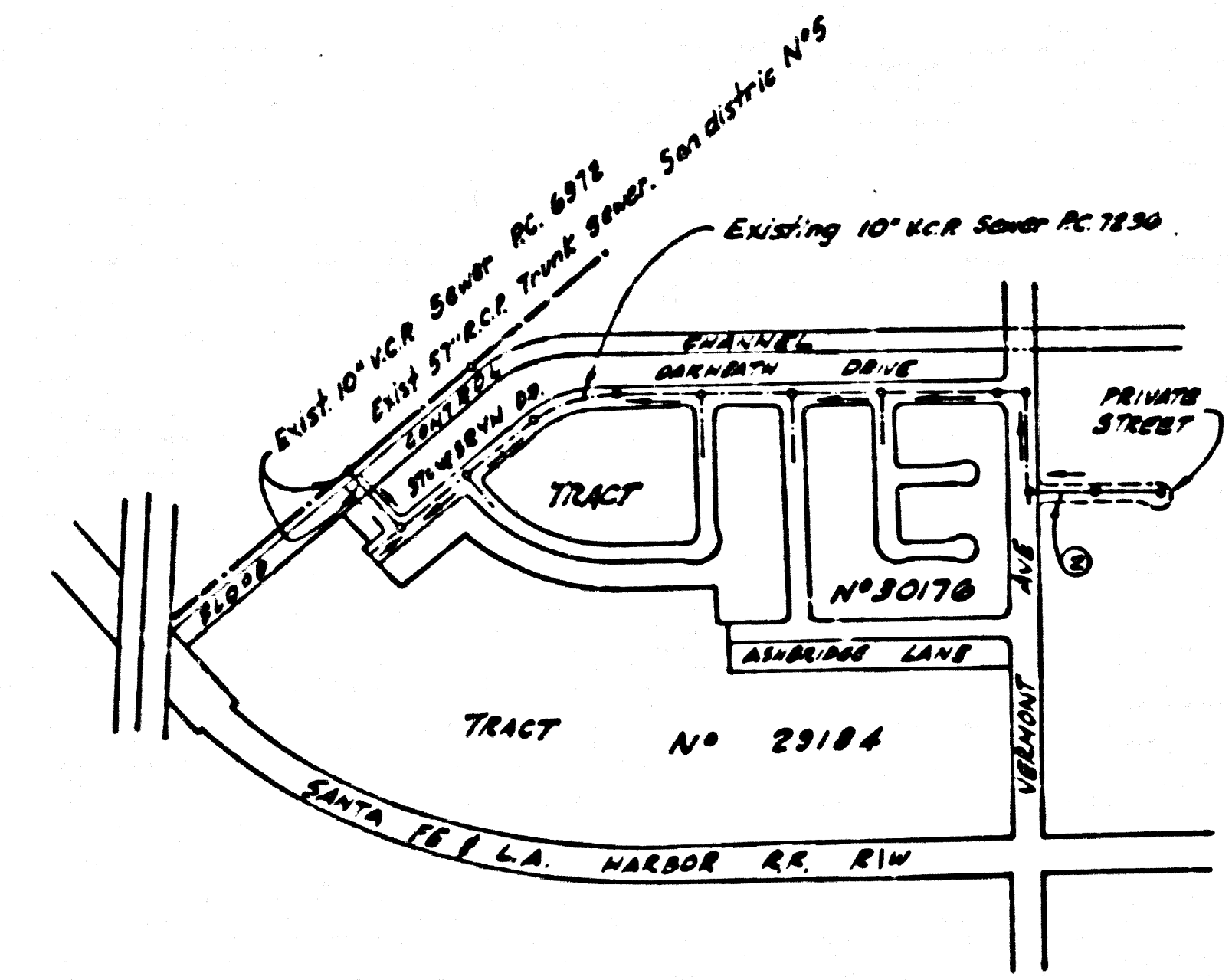

INDEX MAP  
 1"=600'  
 RC. 7238

ISSUE NO HOUSE CONNECTION PERMITS UNTIL RC. 7236 IS ACCEPTED.

APPROVED: *Geo. E. Knight* 3/18/65  
 INDUSTRIAL WASTE DIVISION

COLLECT CHARGES AS INDICATED  
*James C. Clark*

NO CONNECTIONS FOR THE DISPOSAL OF INDUSTRIAL WASTES SHALL BE MADE TO SEWERS SHOWN ON THESE DRAWINGS WITHOUT WRITTEN PERMISSION FROM THE CHIEF ENGINEER AND GENERAL MANAGER OF THE COUNTY SANITATION DISTRICTS.

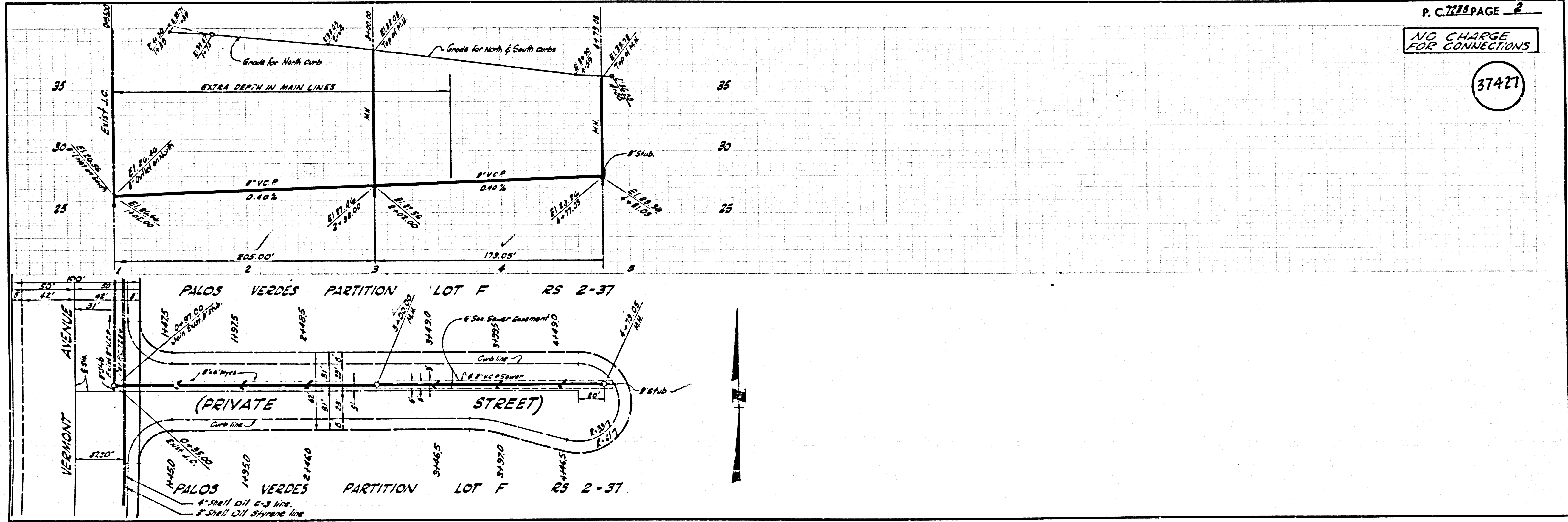

NO CHARGE FOR CONNECTIONS

37421