

TO BE CONSTRUCTED IN
**GLENDORA AVE
 WEST COVINA**

PRIVATE CONTRACT NO. 7262

W.S. 47
 1 SHEET 2 PAGES
 SCALE: VERT. 1" = 4'-0" HORIZ. 1" = 20'-0"
 FEBRUARY, 1965

PREPARED IN THE OFFICES OF
F.E. MAC DONALD JR.
 215 W. LOSTUNAS CR.
 SAN GABRIEL
 REG. C.E. NO. 7776

FOR LEGEND SEE PLAN NO. S-1

NOTE:
 GRADES TO WHICH THIS IMPROVEMENT IS TO BE CONSTRUCTED ARE SHOWN ON PLANS AND PROFILES. GRADE POINTS FOR TOP OF CURBS, CENTER LINE OF STREETS, OR CENTER LINE OF ALLEYS ARE SHOWN BY CIRCLES ON PROFILES. AT ALL POINTS BETWEEN DESIGNATED POINTS THE GRADE SHALL BE ESTABLISHED SO AS TO CONFORM TO A STRAIGHT LINE DRAWN BETWEEN SAID DESIGNATED POINTS. ELEVATIONS ARE IN FEET ABOVE U.S.C. & G.S. SEA LEVEL DATUM OF 1929. THIS DRAWING AND THE DATA HEREON ARE HEREBY MADE A PART OF THE SPECIFICATIONS. WORK SHALL BE CONSTRUCTED ACCORDING TO STANDARD SPECIFICATIONS DATED JULY 25, 1962, ON FILE IN THE OFFICE OF THE COUNTY ENGINEER AND SHALL BE PROSECUTED ONLY BY THE PRESENT OFFICE OF THE COUNTY ENGINEER. BEFORE WORK CAN BE STARTED, THE CONTRACTOR MUST OBTAIN A PERMIT TO EXCAVATE IN COUNTY STREETS FROM THE L.A. COUNTY ROAD DEPT., DISTRICT OFFICE NO. 22, AND PAY A FEE TO THE COUNTY ENGINEER, ROOM 308, COUNTY ENGINEERING BUILDING, 128 WEST SECOND STREET, SAN GABRIEL, CALIFORNIA. APPROVAL OF THIS PLAN BY THE COUNTY OF LOS ANGELES DOES NOT CONSTITUTE A REPRESENTATION AS TO THE ACCURACY OF THE LOCATION OF OR THE EXISTENCE OR NON-EXISTENCE OF ANY UNDERGROUND UTILITY PIPE, GAS STRUCTURE WITHIN THE LIMITS OF THIS PROJECT. THIS NOTE APPLIES TO ALL PAGES. IF WORK IS TO BE DONE IN A STATE HIGHWAY, A PERMIT MUST BE OBTAINED FROM THE STATE OF CALIFORNIA, DIVISION OF HIGHWAYS, 128 SOUTH SPRING STREET, LOS ANGELES, CALIFORNIA.

COUNTY OF LOS ANGELES, CALIFORNIA
 JOHN A. LAMBIE, COUNTY ENGINEER J. D. PARKHURST, CHIEF ENGINEER
 CO. 1448, 1952, 1957, 1962

APPROVED BY: *R.E. Gorton* APPROVED BY: *J. D. Parkhurst*
 ASSISTANT SANITATION ENGINEER OFFICE 308-308

SUBMITTED BY: *Franklin W. Knight*
 DAN DIMAS, REGIONAL ENGINEER
 CHECKED BY: *Richard Lee* 4-7-65
 REG. C.E. NO. 10883

CITY OF WEST COVINA, CALIFORNIA
 APPROVED BY: *R.E. Gorton*
 R.E. GORTON, C.E. 7676
 CITY ENGINEER
 DATE: March 29, 1965

36818
 J.N.0365.01

LA PUENTE BLDG. DIST. NO. 2,00

BENCH MARK 37-8 ELEV. 354.082
 I.S. of Glendora and Francisquito East
 BM 37-8 (Puente 6-61) 466' NW 1/4 of Traffic
 Signal at SE cor. of I.S. and 42.4' E 1/4 of
 Traffic signal at W. side of Glendora in well
 with C.I. cover (Marked C.S. Mon). L.A. Co.
 Survey Control System Traverse Station,
 stamped Puente 6-61 1953 R2 G3, approx.
 10' below surface. FB 2890 P7, 1963 adj.
 elev 354.082.
 BALDWIN PK. QUAD 1963

1. PROVIDE STAKES ON THE PROPERTY LINE OR PROPERTY LINES PRODUCED AT RIGHT ANGLES TO 8" V. SEWER LINE AT THE CENTER LINE OF EACH MANHOLE.
2. NO REPRESENTATIVE OF THE COUNTY ENGINEER WILL SURVEY OR LAY OUT ANY PORTION OF THE WORK.
3. THE PRIVATE ENGINEER SHALL FURNISH THE COUNTY ENGINEER WITH GRADE SHEETS AND STATIONING FOR ALL HOUSE LATERALS AND T-BRANCHES AND SHALL PROVIDE STAKES FOR THEM AT THEIR PROPER LOCATIONS WITH STATIONING PLAINLY MARKED. ALL HOUSE LATERALS SHALL BE CONSTRUCTED IN A STRAIGHT ALIGNMENT AT RIGHT ANGLES FROM THE MAIN LINE SEWER EXCEPT AS SHOWN ON THE PLANS. HOUSE LATERALS FROM BRANCHES SHALL HAVE AN ANGLE OF LESS THAN 90 DEGREES WITH THE MAIN LINE SEWER. ANY CHANGE IN ALIGNMENT SHALL BE REQUESTED IN WRITING BY THE PRIVATE ENGINEER.
4. THE PRIVATE ENGINEER SHALL FURNISH THE HOUSE LATERAL DEPTH AT THE PROPERTY LINE BELOW THE TOP OF CURB ELEVATION FOR EACH HOUSE LATERAL ON THE 6" SIDE SHEET.
5. NO REVISIONS SHALL BE MADE IN THESE PLANS WITHOUT THE APPROVAL OF THE COUNTY ENGINEER.
6. THE CONTRACTOR SHALL NOTIFY THE CONSTRUCTION DIVISION BY TELEPHONE, ROOM 308, EXT. 3148, AT LEAST TWENTY-FOUR HOURS BEFORE STARTING ANY WORK UNDER THIS CONTRACT.
7. MANHOLES SHALL BE BRICK SEWER STRUCTURES PER S. 87 PERCAST CONCRETE MANHOLES PER S-5 OR S-6 MAY BE USED AS AN ALTERNATE IN LOCATIONS APPROVED BY THE COUNTY ENGINEER.
8. USE STANDARD 24" MANHOLE FRAMES AND COVERS, S/S, SNAPP AS NOTED.
9. MANHOLES 24" OR 30" APPROVED DEPT. OF HIGHWAYS OR 30" DEPT. OF HIGHWAYS ABOVE FINISHED GRADE.
10. USE EXTRA STRENGTH PIPE. ALL PIPE IS STANDARD DEPTH EXCEPT AS NOTED.
11. "THE QUALITY AND WORKMANSHIP OF MECHANICAL JOINTS FOR ALL V.C.P. JOINTS PER SPEC., SECT. 54, 48.149
12. UNLESS OTHERWISE SPECIFIED, ALL JOINTS SHALL BE MECHANICAL JOINTS PER SPEC., SECT. 54.
13. IF A POLE IS WITHIN THREE FEET OF THE SEWER, THE SEWER SHALL BE ENCASED PER S-23, 48-23, TWO FEET ON EITHER SIDE FROM THE POINT OF INTERFERENCE.
14. IF DURING THE COURSE OF CONSTRUCTION IT IS DETERMINED THAT THERE IS LESS THAN FOUR FEET OF COVER OVER THE TOP OF A MAIN LINE OR HOUSE LATERAL V.C.P. SEWER WHICH IS NOT INDICATED ON THE PLANS, THE PIPE SHALL BE ENCASED PER S-23, 48-23, UNLESS OTHERWISE APPROVED BY THE COUNTY ENGINEER.
15. HOUSE LATERAL TO BE CONSTRUCTED WITH 1/8" RISE PER FOOT TO PROPERTY LINE
16. REINFORCE ALL TRENCHES WITH PAVED AREAS TO MEET L.A. COUNTY ROAD DEPT. OR CALIFORNIA STATE HIGHWAY REQUIREMENTS IN ACCORDANCE WITH PLANS.
17. FOR ALLOWANCE MESSAGE TEST USE FORMULA NO. 2, SPEC. 54.
18. ALL STATE AND LOCAL SAFETY ORDERS WILL BE RIGIDLY ENFORCED.
19. PRIOR TO EXCAVATING IN THE CITY OF WEST COVINA, A PERMIT SHALL BE OBTAINED FROM THE ENGINEERING OFFICE OF THE CITY OF WEST COVINA.

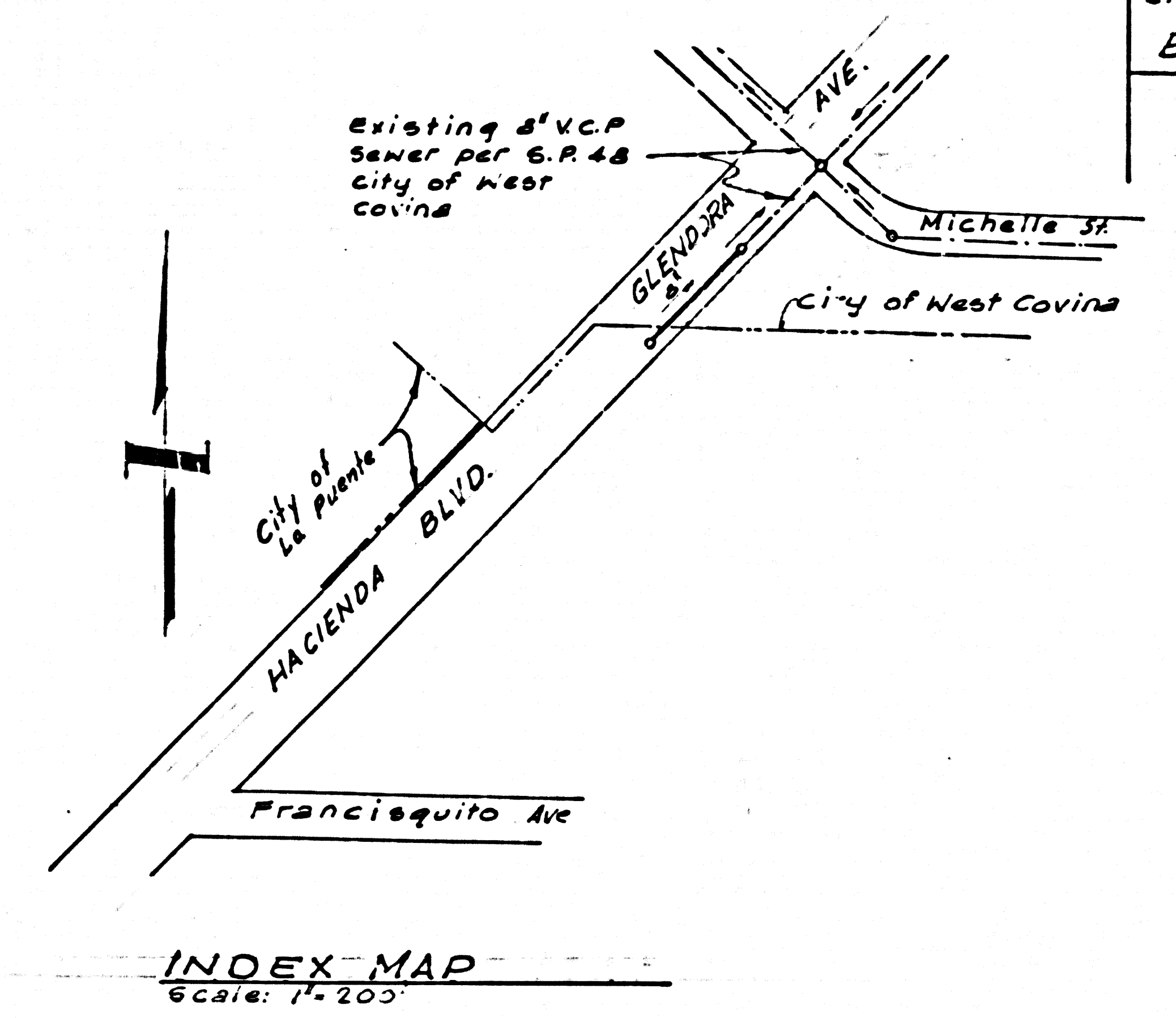

Approved by
Joseph B. Graciano 4-7-65
 INDUSTRIAL WASTE DIVISION Date

COLLECT CHARGES
 AS INDICATED
P.R. Smith 4-7-65

CITY OF WEST COVINA, CALIFORNIA
 APPROVED BY: *R.E. Gorton*
 R.E. GORTON, C.E. 7676
 CITY ENGINEER
 DATE: March 29, 1965

COLLECT CHARGE
 AS INDICATED

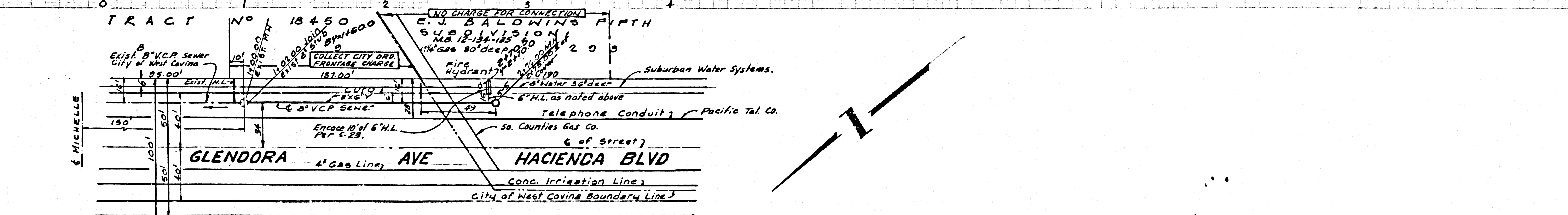
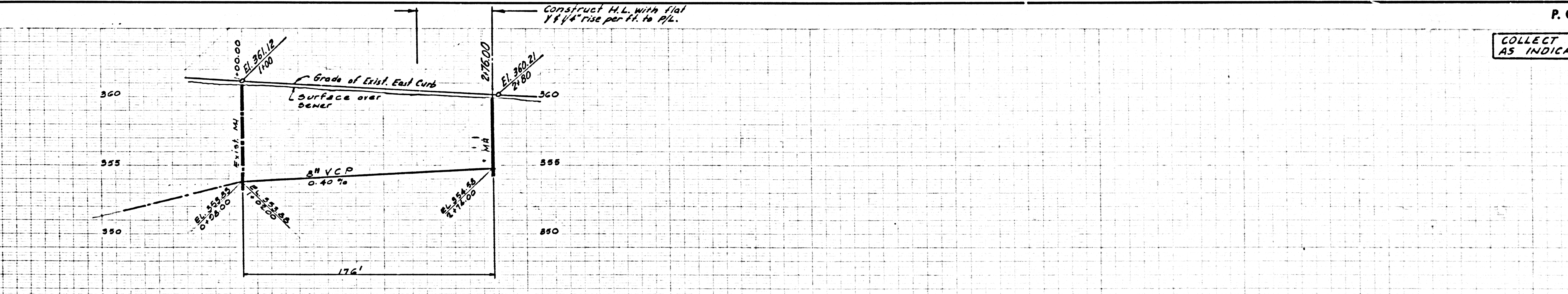

36819

