

B.M. BMLN-34 ELEV. 94.912
 116th Pl. 463' ± E. of Compton Ave.
 Bl. Sp. in curb 2' S. & Prod. of
 116th Pl. F.B. 1666 Pg. 145

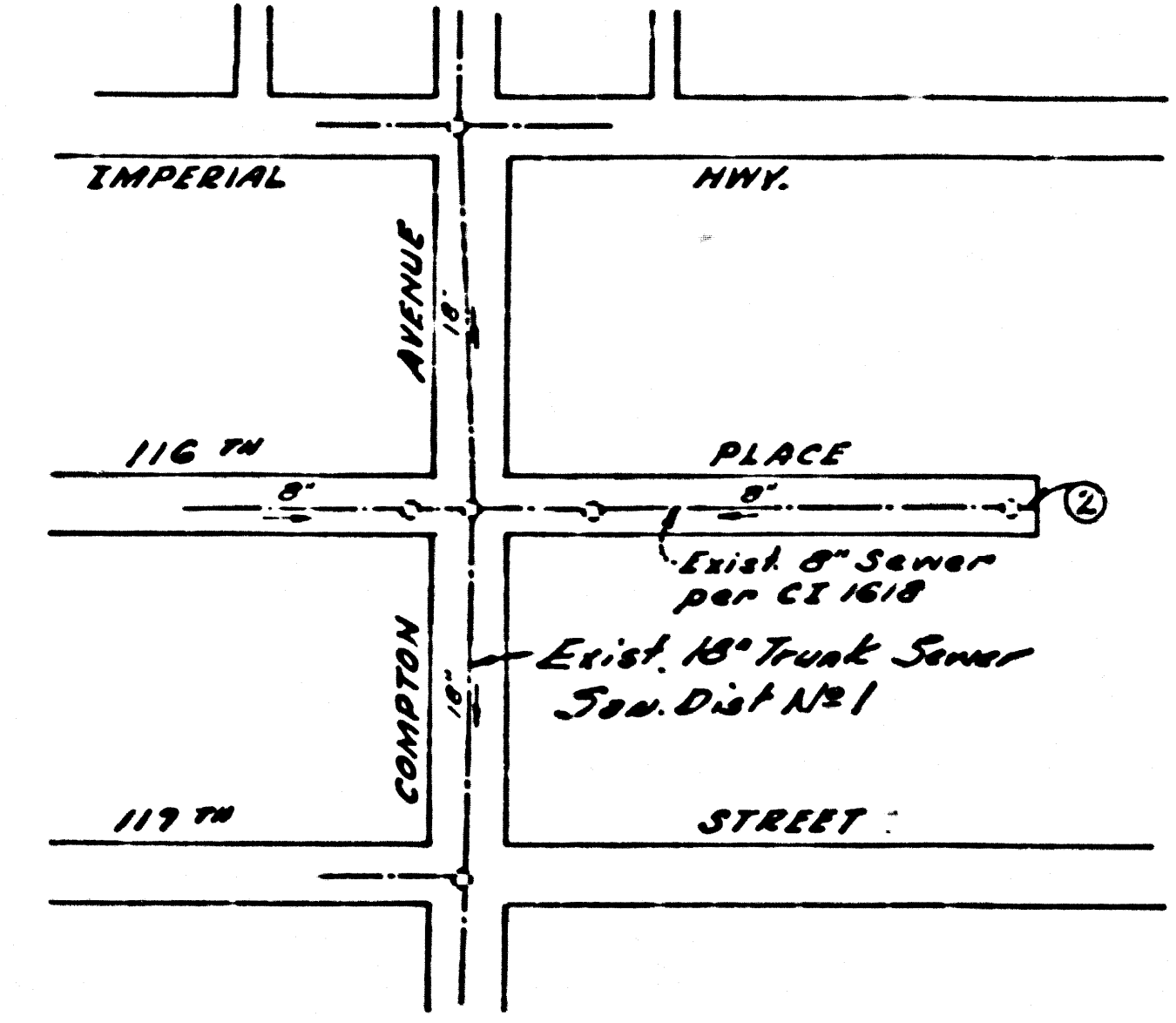

INDEX MAP
 116th Place
 Scale 1"=200'
 P.C. 7270

FIRESTONE BLDG. DIST. NO. 1

- NOTES:
1. PROVIDE STAKES ON THE PROPERTY LINE OR PROPERTY LINES PRODUCED AT RIGHT ANGLES TO THE SEWER LINE AT THE CENTER LINE OF EACH MANHOLE.
 2. NO REPRESENTATIVE OF THE COUNTY ENGINEER WILL SURVEY OR LAY OUT ANY PORTION OF THE WORK.
 3. THE PRIVATE ENGINEER SHALL FURNISH THE COUNTY ENGINEER WITH GRADE SHEETS AND STATIONING FOR ALL HOUSE LATERALS AND Y BRANCHES AND SHALL PROVIDE STAKES FOR THEM AT THEIR PROPER LOCATIONS WITH STATIONING PLAINLY MARKED. ALL HOUSE LATERALS SHALL BE CONSTRUCTED IN A STRAIGHT ALIGNMENT AT RIGHT ANGLES FROM THE MAIN LINE SEWER EXCEPT AS SHOWN ON THE PLANS. HOUSE LATERALS FROM CHIMNEYS SHALL NOT HAVE AN ANGLE OF LESS THAN 45° WITH THE MAIN LINE SEWER. ANY CHANGE IN ALIGNMENT SHALL BE REQUESTED IN WRITING BY THE PRIVATE ENGINEER.
 4. THE PRIVATE ENGINEER SHALL FURNISH THE HOUSE LATERAL SEWER AT THE PROPERTY LINE AND SHALL BE RESPONSIBLE FOR THE PROTECTION OF SAID HOUSE LATERAL FROM THE GRADE SHEET.
 5. NO REVISIONS SHALL BE MADE IN THESE PLANS WITHOUT THE APPROVAL OF THE COUNTY ENGINEER.
 6. THE CONTRACTOR SHALL NOTIFY THE CONSTRUCTION DIVISION BY TELEPHONE, PARAGRAPH 9-27 OF, ST. 2142, AT LEAST TWENTY-FOUR HOURS BEFORE STARTING ANY WORK UNDER THIS CONTRACT.
 7. MANHOLES SHALL BE 30" DIA. SEWER STRUCTURES AND 4" DIA. RINGS OF 12" DIA. RINGS PER 6" DIA. RING. MANHOLE DEPTH SHALL BE AS APPROVED BY THE COUNTY ENGINEER.
 8. THE STANDARD JACOBS FRAMES AND COVERS, 5" HP, SHALL BE USED.
 9. MANHOLE TOPS IN UNIMPROVED AREAS OF 116th PL. SHALL BE 6" BELOW FINISHED GRADE.
 10. USE EXTRA STRENGTH PIPE. ALL PIPE IS STANDARD DEPTH EXCEPT AS NOTED.
 11. USE CEMENT MORTAR OR MECHANICAL COMPRESSION JOINTS FOR ALL V.C.P. JOINTS PER SPEC'S, SECT. 7.1 & 6.
 12. THE CONTRACTOR SHALL BE RESPONSIBLE FOR THE PROTECTION OF THE SEWER, THE U.S.A. SHALL BE RESPONSIBLE FOR THE PROTECTION OF THE SEWER FROM THE GRADE SHEET TO THE PROPERTY LINE.
 13. U.S.A. SHALL BE RESPONSIBLE FOR THE PROTECTION OF THE SEWER FROM THE GRADE SHEET TO THE PROPERTY LINE.
 14. THE CONTRACTOR SHALL BE RESPONSIBLE FOR THE PROTECTION OF THE SEWER FROM THE GRADE SHEET TO THE PROPERTY LINE.
 15. THE CONTRACTOR SHALL BE RESPONSIBLE FOR THE PROTECTION OF THE SEWER FROM THE GRADE SHEET TO THE PROPERTY LINE.
 16. THE CONTRACTOR SHALL BE RESPONSIBLE FOR THE PROTECTION OF THE SEWER FROM THE GRADE SHEET TO THE PROPERTY LINE.
 17. FOR ALLOWABLE LEAKAGE TEST USE FORMULA NO. 1, SPEC'S, SEC. 54.
 18. ALL STATE AND LOCAL TRENCH SAFETY ORDERS WILL BE RIGIDLY ENFORCED.

NO CONNECTIONS FOR THE DISPOSAL OF INDUSTRIAL WASTES SHALL BE MADE TO SEWERS SHOWN ON THESE DRAWINGS WITHOUT WRITTEN PERMISSION FROM THE CHIEF ENGINEER AND GENERAL MANAGER OF THE COUNTY SANITATION DISTRICTS.

COLLECT CHARGES AS INDICATED
William Scott

116th PLACE
 PRIVATE CONTRACT NO. 7270

W.S. 26
 SHEET 1 OF 2 PAGES
 PREPARED IN THE OFFICES OF
 J.H. EDWARDS CO.
 CIVIL ENGINEERS
 735-4242
 FEBRUARY, 1965
 REG. C. E. NO. 14302
 FOR LEGEND SEE PLAN NO. S-64

NOTE:
 GRADES TO WHICH THIS IMPROVEMENT IS TO BE CONSTRUCTED ARE SHOWN ON PLANS AND PROFILE. GRADE POINTS FOR TOP OF CURBS, CENTER LINE OF STREETS, OR CENTER LINE OF ALLEYS ARE SHOWN BY CIRCLES ON PROFILES. AT ALL POINTS BETWEEN DESIGNATED POINTS THE GRADE SHALL BE ESTABLISHED SO AS TO CONFORM TO A STRAIGHT LINE DRAWN BETWEEN SAID DESIGNATED POINTS. REVISIONS ARE IN RED ABOVE U.S.C. & G.S. SEA LEVEL DATUM OF 1929.
 THIS DRAWING AND THE DATA HEREON ARE HEREBY MADE A PART OF THE SPECIFICATIONS FOR THE WORK. ON FILE IN THE OFFICE OF THE COUNTY ENGINEER AND SHALL BE PROSECUTED ONLY IN THE PRESENCE OF THE COUNTY ENGINEER.
 BEFORE WORK CAN BE STARTED, THE CONTRACTOR MUST OBTAIN A PERMIT TO EXCAVATE IN COUNTY STREETS FROM THE U.S. COUNTY ROAD DEPT., DISTRICT OFFICE NO. 1, AND PAY A FEE TO THE COUNTY ENGINEER, ROOM 328, COUNTY ENGINEERING BUILDING, 100 WEST SECOND STREET, LOS ANGELES, CALIFORNIA. REGIONAL OFFICE, SUFFICIENT TO COVER THE COST OF CONSTRUCTION INSPECTION AND SECOND PLANS.
 APPROVAL OF THIS PLAN BY THE COUNTY OF LOS ANGELES DOES NOT CONSTITUTE A REPRESENTATION AS TO THE ACCURACY OF THE LOCATION OF OR THE EXISTENCE OR NON-EXISTENCE OF ANY UNDERGROUND UTILITY PIPE OR STRUCTURE WITHIN THE LIMITS OF THIS PROJECT. THIS NOTE APPLIES TO ALL PAGES.
 IF WORK IS TO BE DONE IN A STATE HIGHWAY, A PERMIT MUST BE OBTAINED FROM THE STATE OF CALIFORNIA, DIVISION OF HIGHWAYS, 120 SOUTH SPRING STREET, LOS ANGELES, CALIFORNIA.

COUNTY OF LOS ANGELES, CALIFORNIA
 JOHN A. LAMBIE, COUNTY ENGINEER
 APPROVED BY: *Richard E. Klein*
 ASSISTANT SANITATION ENGINEER
 SUBMITTED BY: *William Scott*
 REGIONAL ENGINEER
 CHECKED BY: *Thomas J. Valerius*
 REG. C.E. NO. 10553
 J. D. PARKHURST, CHIEF ENGINEER
 APPROVED BY: *J. D. Parkhurst*
 CHIEF ENGINEER
 36735
 J.N. 0365.06

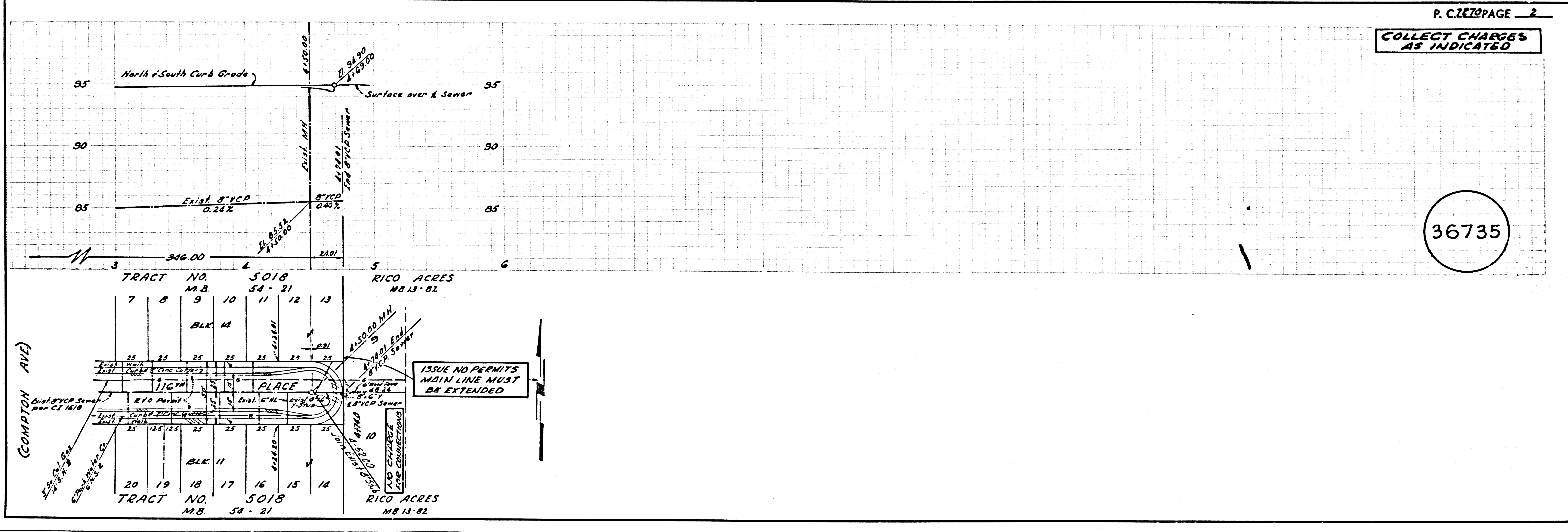

COLLECT CHARGES AS INDICATED

36735