

B.M. S.Y. 742 ELEV. 44.619  
 LEAD AND TACK IN PVMT.  
 NEAR ELY AVE. & 1/2' SOUTH  
 OF SOUTH ST.  
 ARTESIA QUAD. 1960

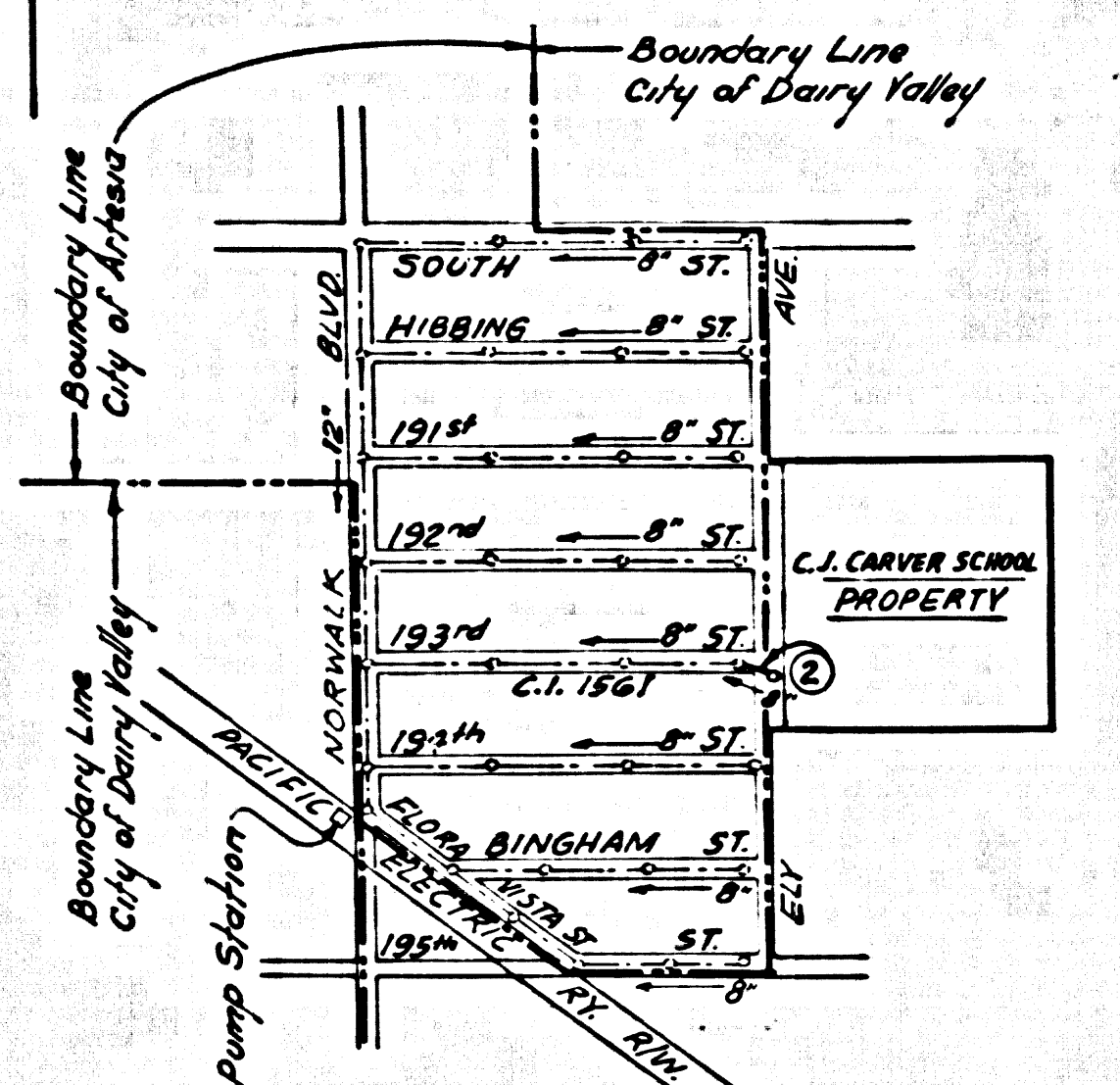

**CHARLES J. CARVER SCHOOL**  
 INDEX MAP  
 P.C. 7328  
 SCALE 1"=600'

APPROVAL OF THIS PLAN BY THE CITY OF ARTESIA IS FOR CAPACITY TO SERVE THE CHARLES J. CARVER SCHOOL ONLY. ANY EXTENSIONS TO P.C. 7328 SHALL REQUIRE FURTHER APPROVAL BY THE CITY OF ARTESIA.

APPROVED: *Alan B. Fenwick*  
 CITY OF ARTESIA

**DAIRY VALLEY BLDG. DIST. NO. 4.02**

- NOTES:
1. PROVIDE STAKES ON THE PROPERTY LINE OR PROPERTY LINES PRODUCED AT RIGHT ANGLES TO THE SEWER LINE AT THE CENTER LINE OF EACH MANHOLE.
  2. NO REPRESENTATIVE OF THE CITY ENGINEER WILL SURVEY OR LAY OUT ANY PORTION OF THE WORK.
  3. THE PRIVATE ENGINEER SHALL FURNISH THE CITY ENGINEER WITH GRADE SHEETS AND STATIONING FOR ALL HOUSE LATERALS AND Y BRANCHES AND SHALL PROVIDE STAKES FOR THEM AT THEIR PROPER LOCATIONS WITH STATIONING PLAINLY MARKED. ALL HOUSE LATERALS SHALL BE CONSTRUCTED IN A STRAIGHT ALIGNMENT AT RIGHT ANGLES FROM THE MAIN LINE SEWER EXCEPT AS SHOWN ON THE PLANS. HOUSE LATERALS FROM CHIMNEYS SHALL NOT HAVE AN ANGLE OF LESS THAN 45° WITH THE MAIN LINE SEWER. ANY CHANGE IN ALIGNMENT SHALL BE REQUESTED IN WRITING BY THE PRIVATE ENGINEER.
  4. THE PRIVATE ENGINEER SHALL FURNISH THE HOUSE LATERAL DEPTH AT THE PROPERTY LINE BELOW THE TOP OF CURB ELEVATION FOR EACH HOUSE LATERAL ON THE GRADE SHEET.
  5. NO REVISIONS SHALL BE MADE IN THESE PLANS WITHOUT THE APPROVAL OF THE CITY ENGINEER.
  6. THE CONTRACTOR SHALL NOTIFY THE CONSTRUCTION DIVISION BY TELEPHONE, MADISON 9-4747, EXT. 8152, AT LEAST TWENTY-FOUR HOURS BEFORE STARTING ANY WORK UNDER THIS CONTRACT.
  7. MANHOLES SHALL BE BRICK SEWER STRUCTURES PER S. 2. PRECAST CONCRETE MANHOLES PER S. 5 OR S. 6 MAY BE USED AS AN ALTERNATE IN LOCATIONS APPROVED BY THE CITY ENGINEER.
  8. USE STANDARD MANHOLE FRAMES AND COVERS, S-12, EXCEPT AS NOTED.
  9. MANHOLE TOPS IN UNIMPROVED RIGHTS-OF-WAY TO BE SIX INCHES ABOVE FINISHED GRADE.
  10. USE EXTRA STRENGTH PIPE. ALL PIPE IS STANDARD DEPTH EXCEPT AS NOTED.
  11. USE MECHANICAL COMPRESSION JOINTS FOR ALL V.C.P. JOINTS PER SPECS. SEC. 34, 48 & 49.
  12. ALL HOUSE LATERALS SHALL BE CONSTRUCTED TO EQUAL THE COVERED INLET AT THE MANHOLE. THE COVER SHALL BE AT LEAST 18" ABOVE FINISHED GRADE. EXCEPT AS NOTED, ALL HOUSE LATERALS SHALL BE CONSTRUCTED TO EQUAL THE COVERED INLET AT THE MANHOLE. THE COVER SHALL BE AT LEAST 18" ABOVE FINISHED GRADE.
  13. IF A POWER POLE IS WITHIN THREE FEET OF THE SEWER, THE SEWER SHALL BE ENCASED, PER S. 2-23, TWO FEET ON EACH SIDE FROM THE POINT OF INTERFERENCE.
  14. IF DURING THE COURSE OF CONSTRUCTION IT IS DETERMINED THAT THERE IS LESS THAN FOUR FEET OF COVER OVER THE TOP OF A MAIN LINE OF HOUSE LATERAL V.C.P. SEWER WHICH IS NOT INDICATED ON THE PLANS, THE PIPE SHALL BE ENCASED PER S. 2-23 UNLESS OTHERWISE APPROVED BY THE CITY ENGINEER.
  15. HOUSE LATERALS TO BE CONSTRUCTED WITH INVERTS AT 1/4" RISE PER FOOT TO PROPERTY LINE.
  16. IMPACT ALL TRINCHES WITHIN PAVED AREAS TO MEET L.A. COUNTY ROAD DEPT. OR CALIFORNIA STATE HIGHWAY REQUIREMENTS IN ACCORDANCE WITH PERMITS.
  17. FOR ALLOWABLE LEAKAGE TEST USE FORMULA NO. 2, SPECS. SEC. 54.
  18. ALL STATE AND LOCAL TRINCH SAFETY ORDERS WILL BE RIGIDLY ENFORCED.
  19. FROM STATION 0+30.00 TO STATION 0+44.00 CONSTRUCT SEWER BY JACKING PER SPECS. SEC. 61 OR BY TUNNELING THE TUNNEL SHALL:
    - A. BE NO LESS THAN TWO FEET HIGH AND THE ROOF SHALL BE SLOPED PER SPECS. SEC. 52.
    - B. BE SO BRACED AND SUPPORTED AS TO BE SAFE FROM CAVING.
    - C. BE KEPT FREE OF WATER.
    - D. BE OPEN TO THE SURFACE AT EACH END PRIOR TO ANY WORK THEREIN OTHER THAN DIGGING OR SHORING.
    - E. BE BACKFILLED PER SPECS. SEC. 52.

**COLLECT CHARGES AS INDICATED**  
*Edith W. Brown*

APPROVED: *Robert A. Moore*  
 INDUSTRIAL WASTE DIVISION

PROFILE ALIGNMENT AND GRADE OF **P.C. 7328**  
**SANITARY SEWERS PAGE 1**

TO BE CONSTRUCTED IN  
**CHARLES J. CARVER SCHOOL**

**PRIVATE CONTRACT NO. 7328**

W.S. 33  
 1 SHEET 2 PAGES  
 SCALE: VERT. 1"=4' HORIZ. 1"=40' APRIL 1965

37555

PREPARED IN THE OFFICES OF  
**KISTNER, WRIGHT & WRIGHT**  
 BY: *H.C. Vandenberg*  
 REG. C.E. NO. 6517

FOR LEGEND SEE PLAN NO. S-1

NOTE:  
 GRADES TO WHICH THIS IMPROVEMENT IS TO BE CONSTRUCTED ARE SHOWN ON PLANS AND PROFILES. GRADE POINTS FOR TOP OF CURBS, CENTER LINE OF STREETS, OR CENTER LINE OF ALLEYS ARE SHOWN BY CIRCLES ON PROFILES. AT ALL POINTS BETWEEN DESIGNATED POINTS THE GRADE SHALL BE ESTABLISHED SO AS TO CONFORM TO A STRAIGHT LINE DRAWN BETWEEN SAID DESIGNATED POINTS. ELEVATIONS ARE IN FEET ABOVE U.S.C. & G.S. MEAN DATUM OF 1929.  
 THIS DRAWING AND THE DATA HEREON ARE HEREBY MADE A PART OF THE SPECIFICATIONS.  
 WORK SHALL BE CONSTRUCTED ACCORDING TO STANDARD SPECIFICATIONS DATED MAY 25, 1958, ON FILE IN THE OFFICE OF THE CITY ENGINEER AND SHALL BE PROSECUTED ONLY IN THE PRESENCE OF THE CITY ENGINEER.  
 BEFORE WORK CAN BE STARTED, THE CONTRACTOR MUST OBTAIN A PERMIT TO EXCAVATE IN CITY STREETS FROM THE L.A. COUNTY ROAD DEPT., DISTRICT OFFICE NO. 9, AND SUFFICIENT TO COVER THE COST OF CONSTRUCTION INSPECTION AND RECORD PLANS.

APPROVAL OF THIS PLAN BY THE CITY OF DAIRY VALLEY DOES NOT CONSTITUTE A REPRESENTATION AS TO THE ACCURACY OF THE LOCATION OF OR THE EXISTENCE OR NON-EXISTENCE OF ANY UNDERGROUND UTILITY PIPE, OR STRUCTURE WITHIN THE LIMITS OF THIS PROJECT. THIS NOTE APPLIES TO ALL PAGES.  
 IF WORK IS TO BE DONE IN A STATE HIGHWAY, A PERMIT MUST BE OBTAINED FROM THE STATE OF CALIFORNIA, DIVISION OF HIGHWAYS, 120 SOUTH SPRING STREET, LOS ANGELES, CALIFORNIA.

**CITY OF DAIRY VALLEY, CALIFORNIA**  
 JOHN A. LAMBIE, CITY ENGINEER  
 I. D. PARKHURST, CHIEF ENGINEER

APPROVED BY: *Robert A. Moore* ASSISTANT SANITATION ENGINEER  
 APPROVED BY: *Edith W. Brown* OFFICE ENGINEER

SUBMITTED BY: *Edith W. Brown*  
 L.O.S. 6287102 REGIONAL ENGINEER R.C.E. 3871  
 CHECKED BY: *Alfred W. Moore*  
 REG. C.E. NO. 2446

NO CONNECTIONS FOR THE DISPOSAL OF INDUSTRIAL WASTES SHALL BE MADE TO SEWERS SHOWN ON THESE DRAWINGS WITHOUT WRITTEN PERMISSION FROM THE CHIEF ENGINEER AND GENERAL MANAGER OF THE COUNTY SANITATION DISTRICTS.

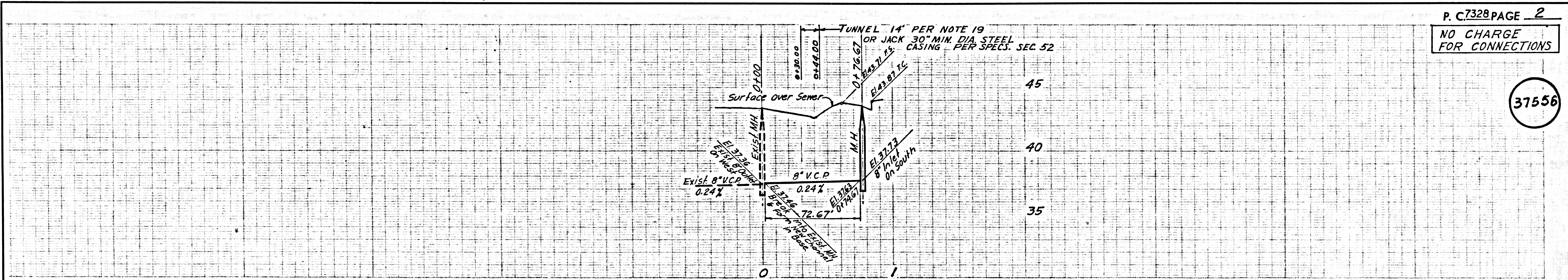

P.C. 7328 PAGE 2  
 NO CHARGE FOR CONNECTIONS

37556

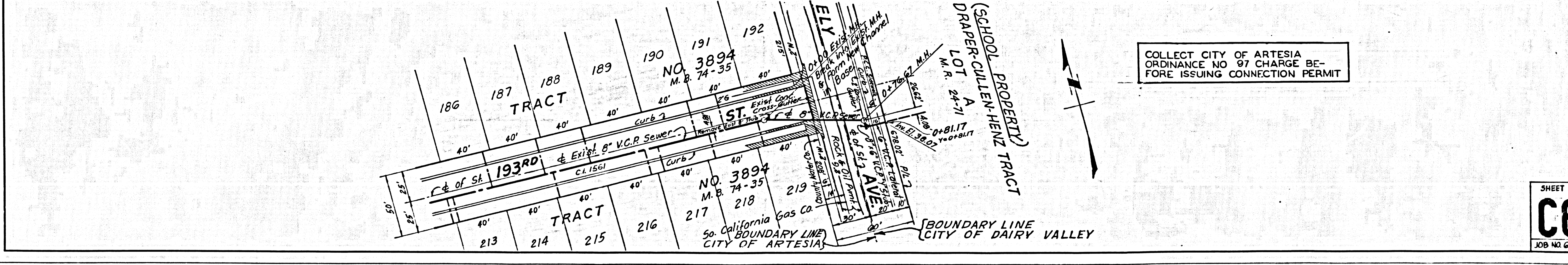

COLLECT CITY OF ARTESIA ORDINANCE NO 97 CHARGE BEFORE ISSUING CONNECTION PERMIT

SHEET NO.  
**C6**  
 JOB NO. 64-4