

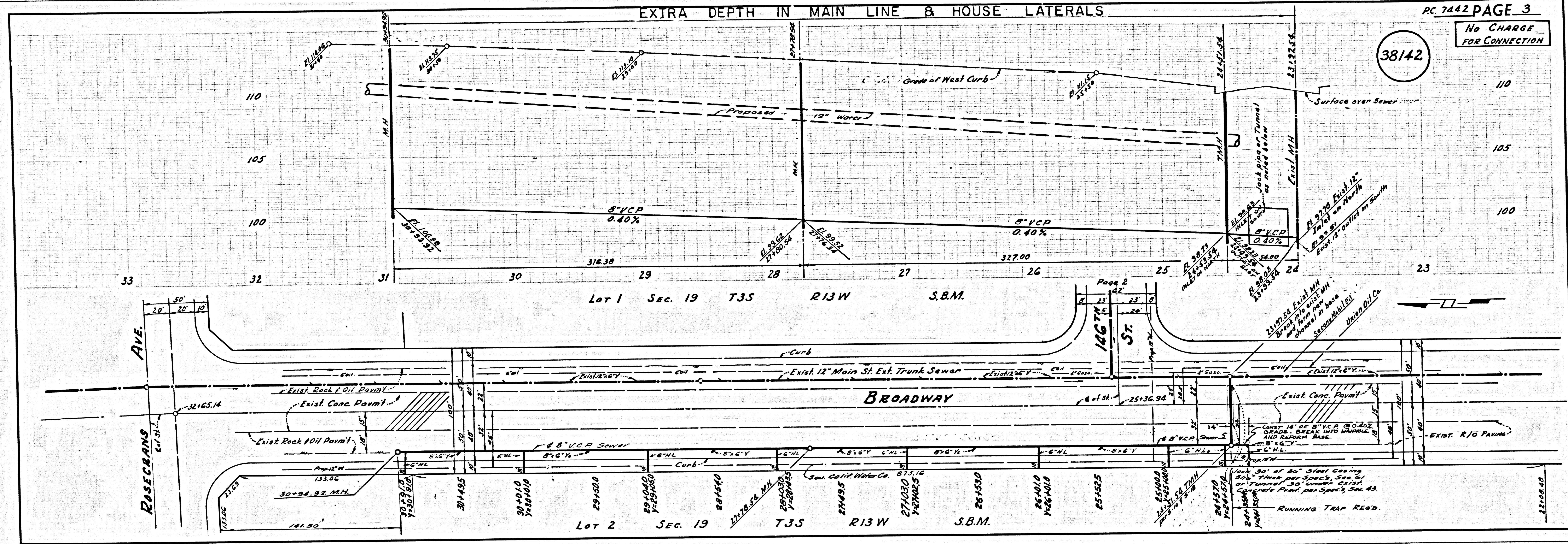

EXTRA DEPTH IN MAIN LINE & HOUSE LATERALS

PC 7442 PAGE 3  
38142  
NO CHARGE FOR CONNECTION



PAGE

L.A. CO. THE L.A. COUNTY SEWER SHEET NO. 2 80 CAL. BLUEPRINT CO.

B.M. SY 3880 ELEV. 102.554  
 L & BN in conc. pavm't 14 Ft. S.E. of  
 Broadway 1380 Ft. S. Rosecrans  
 Ave.  
 Gardens QUAD. 19.60

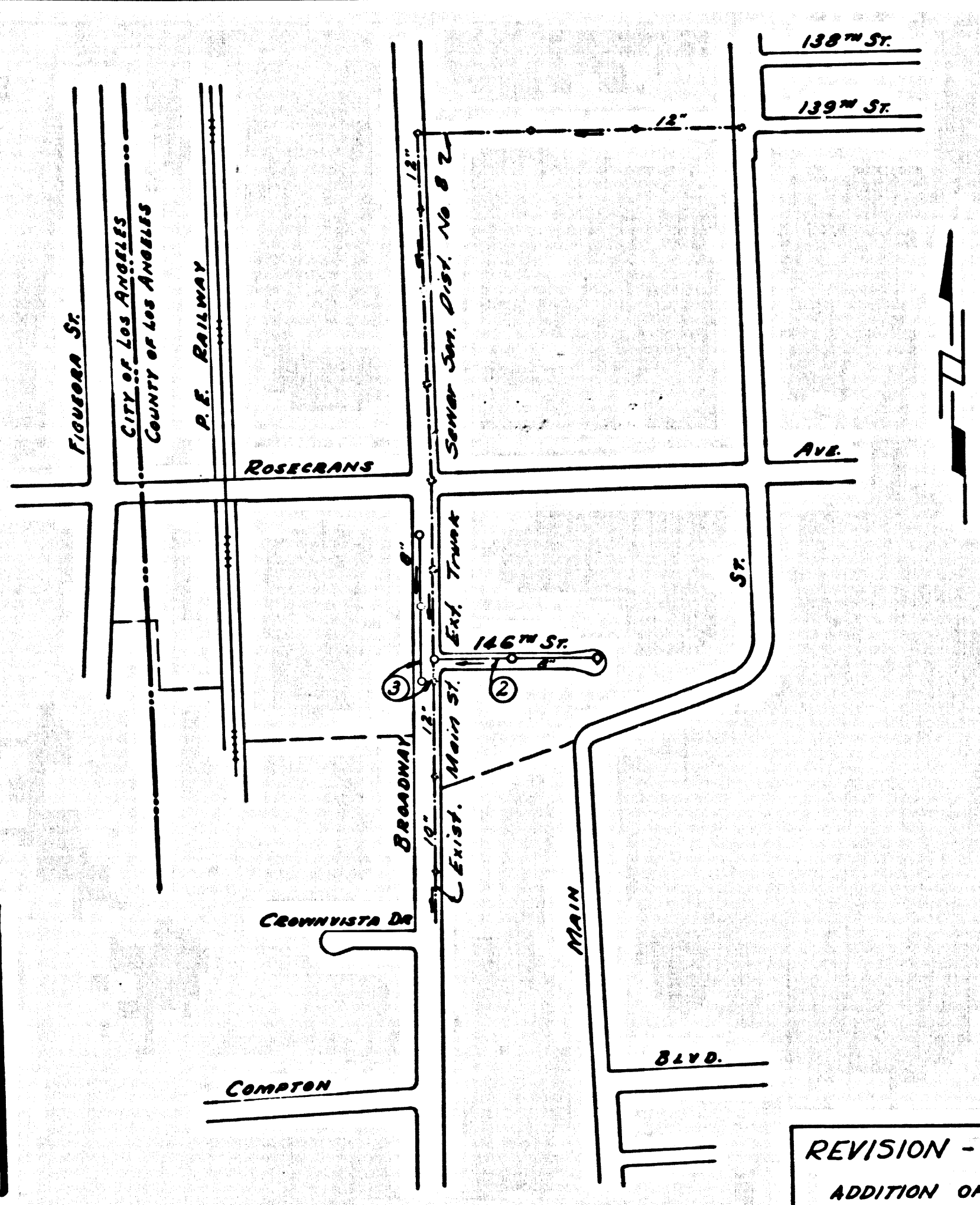

**ISSUE NO H.L. PERMITS  
 UNTIL 146TH STREET  
 IS DEDICATED.**

**INDEX MAP**  
 BROADWAY AND 146TH ST.  
 P.C. 7442  
 Scale 1" = 600'

REVISION - Page 3 3-21-66  
 ADDITION OF 14 FT. OF 8" V.C.P.  
 AND 1 HOUSE LATERAL SOUTH  
 OF T.M.N. AT STA. 2+51.54  
 APPROVED *Samuel J. Valdes*  
 OFFICE OF THE COUNTY ENGINEER

**LENNOX BLDG. DIST. NO. 7**

- NOTES:
1. PROVIDE STAGES ON THE PROPERTY LINE OR PROPERTY LINES PRODUCED AT RIGHT ANGLES TO THE SEWER LINE AT THE CENTER LINE OF EACH MANHOLE.
  2. NO REPRESENTATIVE OF THE COUNTY ENGINEER WILL SURVEY OR LAY OUT ANY PORTION OF THE WORK.
  3. THE PRIVATE ENGINEER SHALL FURNISH THE COUNTY ENGINEER WITH GRADE SHEETS AND STATIONING FOR ALL HOUSE LATERALS AND Y BRANCHES AND SHALL PROVIDE STAGES FOR RISES AT THESE PROPER LOCATIONS WITH STATIONING PLAINLY MARKED. ALL HOUSE LATERALS SHALL BE CONSTRUCTED AT RIGHT ANGLES TO THE MAIN LINE SEWER EXCEPT AS SHOWN ON THE PLANS. HOUSE LATERALS FROM CHIMNEYS SHALL NOT HAVE AN ANGLE OF LESS THAN 45° WITH THE MAIN LINE SEWER. ANY CHANGE IN ALIGNMENT SHALL BE REQUESTED BY WRITING BY THE PRIVATE ENGINEER.
  4. THE PRIVATE ENGINEER SHALL FURNISH THE HOUSE LATERAL DEPTH AT THE PROPERTY LINE BELOW THE TOP OF CURB ELEVATION FOR EACH HOUSE LATERAL ON THE GRADE SHEET.
  5. NO REVISIONS SHALL BE MADE IN THESE PLANS WITHOUT THE APPROVAL OF THE COUNTY ENGINEER.
  6. THE CONTRACTOR SHALL NOTIFY THE CONSTRUCTION DIVISION BY TELEPHONE, MADISON 9-6747, EXT. 6181, AT LEAST TWENTY-FOUR HOURS BEFORE STARTING ANY WORK UNDER THIS CONTRACT.
  7. MANHOLES SHALL BE BRICK SEWER STRUCTURES PER S-2 PRECAST CONCRETE MANHOLES PER S-5 OR S-6 MAY BE USED AS AN ALTERNATE IN LOCATIONS APPROVED BY THE COUNTY ENGINEER, EXCEPT AS NOTED.
  8. USE STANDARD MANHOLE FRAMES AND COVERS, S-17, EXCEPT AS NOTED.
  9. MANHOLE TOPS IN UNIMPROVED RIGHTS-OF-WAY TO BE 20 INCHES ABOVE FINISHED GRADE.
  10. USE EXTRA STRENGTH PIPE. ALL PIPE IS STANDARD DEPTH EXCEPT AS NOTED.
  11. USE MECHANICAL COMPRESSION JOINTS FOR ALL V.C.P. JOINTS PER SPCCS, SECS. 24 & 46, § 69
  12. MANHOLES SHALL BE CONSTRUCTED WITH A MINIMUM COVER OF 48 INCHES OVER THE TOP OF THE MANHOLE FRAME.
  13. IF A POWER POLE IS WITHIN THREE FEET OF THE SEWER, THE SEWER SHALL BE ENCASED, PER S-23 TWO FEET ON EACH SIDE FROM THE POINT OF INTERFERENCE.
  14. IF DURING THE COURSE OF CONSTRUCTION IT IS DETERMINED THAT THERE IS LESS THAN FOUR FEET OF COVER OVER THE TOP OF A MAIN LINE OR HOUSE LATERAL V.C.P. SEWER WHICH IS NOT INDICATED ON THE PLANS, THE PIPE SHALL BE ENCASED PER S-23 UNLESS OTHERWISE APPROVED BY THE COUNTY ENGINEER.
  15. HOUSE LATERALS TO BE CONSTRUCTED WITH INVERTS AT PROPERTY LINE... FEET BELOW CURB GRADE EXCEPT AS NOTED.
  16. RESURFACE ALL TRENCHES WITHIN PAVED AREAS TO MEET L.A. COUNTY ROAD DEPT. OR CALIFORNIA STATE HIGHWAY REQUIREMENTS IN ACCORDANCE WITH PERMITS.
  17. FOR ALLOWABLE LEAKAGE THEY USE FORMULA NO. 1, SPCCS, SEC. 24.
  18. ALL STATE AND LOCAL TRAFFIC SAFETY MEASURES SHALL BE RIGIDLY ENFORCED.

NO CONNECTIONS FOR THE DISPOSAL OF INDUSTRIAL WASTES SHALL BE MADE TO SEWERS SHOWN ON THESE DRAWINGS WITHOUT WRITTEN PERMISSION FROM THE CHIEF ENGINEER AND GENERAL MANAGER OF THE COUNTY SANITATION DISTRICTS.

APPROVED BY: *John N. McNamee* 8/1/65  
 INDUSTRIAL WASTE DIVISION

**COLLECT CHARGES  
 AS INDICATED**  
*John N. McNamee* 8/1/65

BEFORE BREAKING INTO ANY EXISTING STRUCTURE AND BEFORE FINAL ACCEPTANCE OF THIS WORK, COUNTY SANITATION DISTRICT (DU 4-1251) SHALL BE NOTIFIED IN ORDER THAT REQUIRED INSPECTION CAN BE MADE.

PROFILE ALIGNMENT AND GRADE OF **P.C. 7442**  
**SANITARY SEWERS** PAGE 1  
 TO BE CONSTRUCTED IN  
**BROADWAY AND 146TH ST.**

**PRIVATE CONTRACT NO. 7442**

W.S. 26  
 2 SHEETS, 3 PAGES  
 SCALE: VERT. 1" = 4' AUGUST, 1965  
 PREPARED IN THE OFFICES OF  
**J.H. EDWARDS CO.**  
 2229 S. GARDEN ST. LOS ANGELES, CALIF. 90007  
 REG. C.E. NO. 11302

38140

FOR LEGEND SEE PLAN NO. S-1

NOTE:  
 GRADES TO WHICH THIS IMPROVEMENT IS TO BE CONSTRUCTED ARE SHOWN ON PLANS AND PROFILES. GRADE POINTS FOR TOP OF CURBS, CENTER LINE OF STREETS, OR CENTER LINE OF ALLEYS ARE SHOWN BY CIRCLES ON PROFILES. AT ALL POINTS BETWEEN DESIGNATED POINTS THE GRADE SHALL BE ESTABLISHED SO AS TO CONFORM TO A STRAIGHT LINE DRAWN BETWEEN SAID DESIGNATED POINTS. ELEVATIONS ARE IN FEET ABOVE U.S.C. & G.S. SEA LEVEL DATUM OF 1929.  
 THIS DRAWING AND THE DATA HEREON ARE HEREBY MADE A PART OF THE SPECIFICATIONS.  
 WORK SHALL BE CONSTRUCTED ACCORDING TO STANDARD SPECIFICATIONS DATED 2/22/58, ON FILE IN THE OFFICE OF THE COUNTY ENGINEER AND SHALL BE PROSECUTED ONLY IN THE PRESENCE OF THE COUNTY ENGINEER.  
 COUNTY ENGINEER AND SHALL BE PROSECUTED ONLY IN THE PRESENCE OF THE COUNTY ENGINEER.  
 APPROVAL OF THIS PLAN BY THE COUNTY OF LOS ANGELES DOES NOT CONSTITUTE A REPRESENTATION AS TO THE ACCURACY OF THE LOCATION OF THE EXISTENCE OR NON-EXISTENCE OF ANY UNDERGROUND UTILITY PIPE, OR STRUCTURE WITHIN THE LIMITS OF THIS PROJECT. THE NOTE APPLIES TO ALL PAGES.  
 IF WORK IS TO BE DONE ON A STATE HIGHWAY, A PERMIT MUST BE OBTAINED FROM THE STATE OF CALIFORNIA, DIVISION OF HIGHWAYS, 126 SOUTH BRINK STREET, LOS ANGELES, CALIFORNIA.

COUNTY OF LOS ANGELES, CALIFORNIA  
 JOHN A. LAMBIE, COUNTY ENGINEER J. D. PARKHURST, CHIEF ENGINEER  
 CO. SAN. DIST. NO. 7  
 APPROVED BY: *Richard E. Keller* ASSISTANT SANITATION ENGINEER APPROVED BY: *Samuel J. Valdes* OFFICE ENGINEER

SUBMITTED BY: *John C. Gussing* REGIONAL ENGINEER  
 CHECKED BY: *John N. McNamee* REG. C.E. NO. 2414

J.N. 0366.26

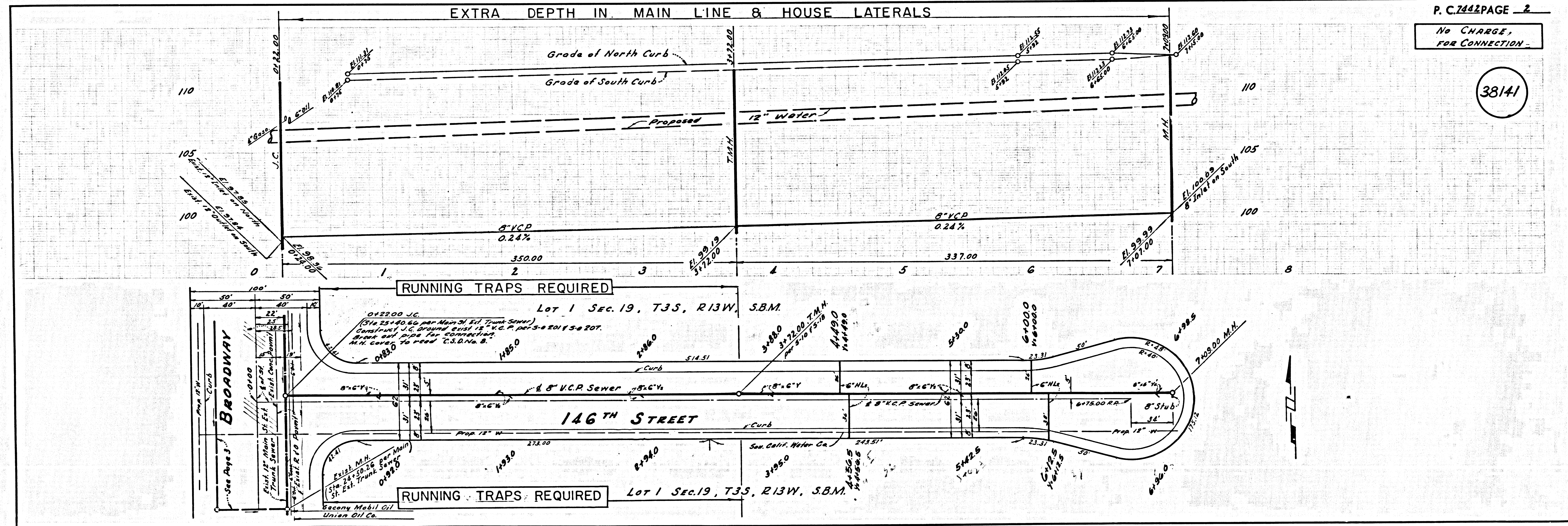

P.C. 7442 PAGE 2  
 No CHARGE FOR CONNECTION

38141

EXTRA DEPTH IN MAIN LINE & HOUSE LATERALS

RC 7442 PAGE 3

NO CHARGE FOR CONNECTION

38142

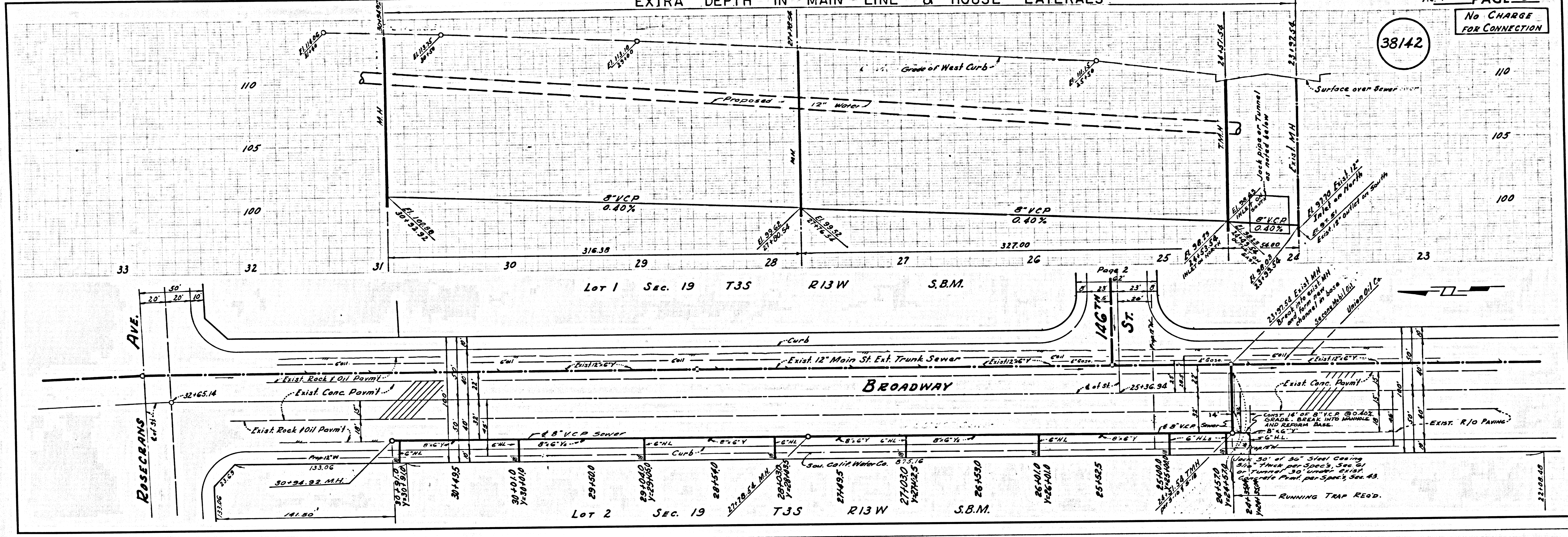

PAGE