

F.P. No.	STATE	FEDERAL PROJECT No.	FISCAL YEAR	SHEET No.	TOTAL SHEETS
	CALIF.				
Dist.	County	Dist. No.	Project No.	SHEET No.	TOTAL SHEETS
VII	LA	172			

APPROVED: _____
DEPUTY DISTRICT ENGINEER

**PLAN & PROFILE OF
SANITARY SEWER
TO BE CONSTRUCTED UNDER
P.C. 7520**

ONE SHEET JAN., 1966
 SCALES: HORIZ: 1"=50', VERT: 1"=5' W.S. 36
COUNTY OF LOS ANGELES, CALIFORNIA
 APPROVED, JOHN A. LAMBIE, COUNTY ENGINEER
 BY: *R. E. Kline*
 ASST. SANITATION ENGINEER
 APPROVED, J. D. PARKHURST, CHIEF ENGINEER
 COUNTY SANITATION DISTRICT #15
 BY: *A. C. Williams*
 OFFICE ENGINEER
 SUBMITTED BY: *R. E. Kline*
 S.D. C.E. No. 14580

No charges for connections

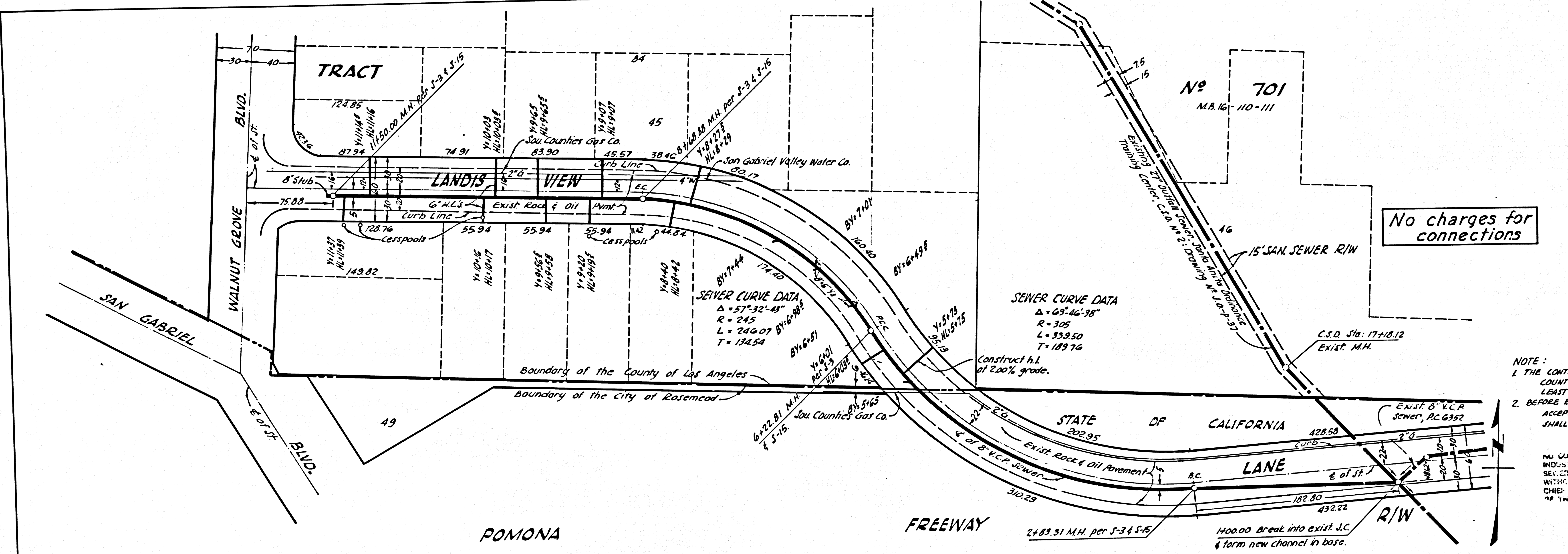

NOTE:
 1. THE CONTRACTOR SHALL NOTIFY THE CONSTRUCTION DIVISION OF THE COUNTY ENGINEER BY TELEPHONE: MADISON 9-4747 EXT. 81551 AT LEAST 24 HOURS BEFORE STARTING ANY WORK ON THIS PROJECT.
 2. BEFORE BREAKING INTO THE EXISTING STRUCTURE AND BEFORE FINAL ACCEPTANCE OF THIS WORK, COUNTY SANITATION DISTRICT (DU-4-1281) SHALL BE NOTIFIED IN ORDER THAT REQUIRED INSPECTION CAN BE MADE.

NO CONNECTIONS FOR THE DISPOSAL OF INDUSTRIAL WASTES SHALL BE MADE TO SEWERS SHOWN ON THESE DRAWINGS WITHOUT WRITTEN PERMISSION FROM THE CHIEF ENGINEER AND GENERAL MANAGER OF THE COUNTY SANITATION DISTRICTS.

39097

DRAWN BY: M. ESQUEVE
 CHECKED BY: W. C. MURRELL

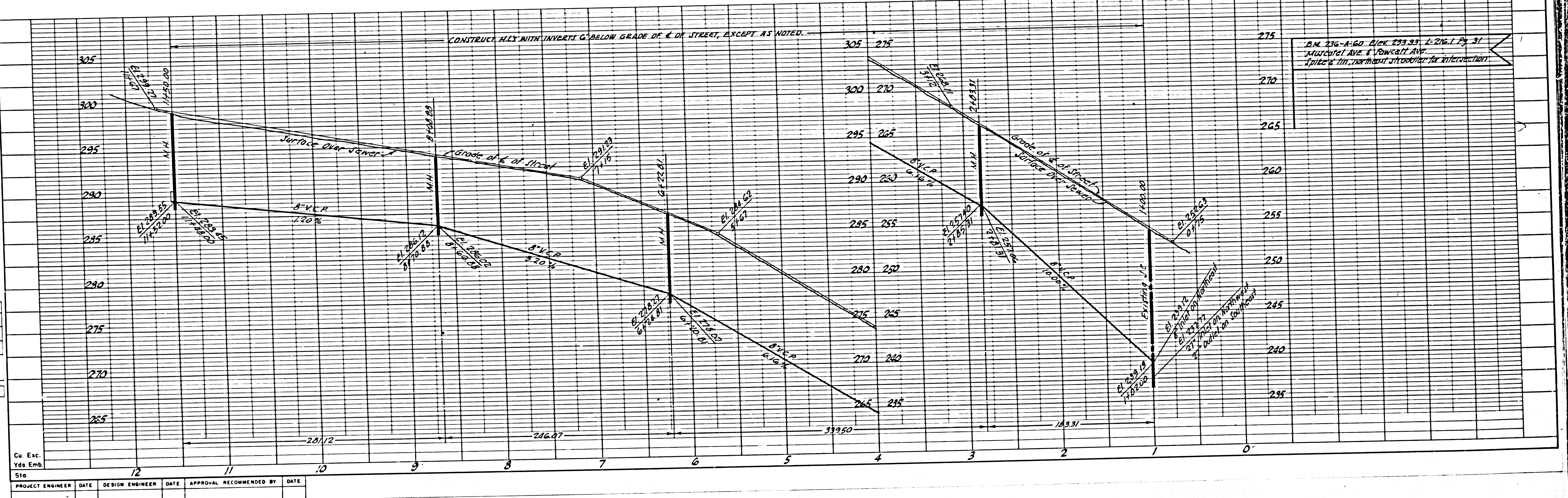

AM 236-A-60 Elev. 239.33 L. 216.1 Dy. 31
 Walnut Ave & Fremont Ave.
 1 piece of 10" dia manhole structure for intersection

DESIGN DEPT	INITIAL	DATE
DESIGNED		
TRACED		
CHECKED		
SUPERVISED BY		

PROJECT ENGINEER	DATE	DESIGN ENGINEER	DATE	APPROVAL RECOMMENDED BY	DATE