

B.M. SY 3423 ELEV. 64.362
 Set L&BN's 1' N. of B.C.P.
 @ N.W. Cor. Pioneer Blvd.
 and Arkansas St.
 Artesia QUAD. 19.55

REVISION NO. 2-3-69
 Page 1 - Brought Plan up to new standards.
 by Ronald W. Bishop 2-3-69
 R.C.E. NO. 18510
 APPROVED: Quill E. McCollum 2/4/69
 Office of County Engineer

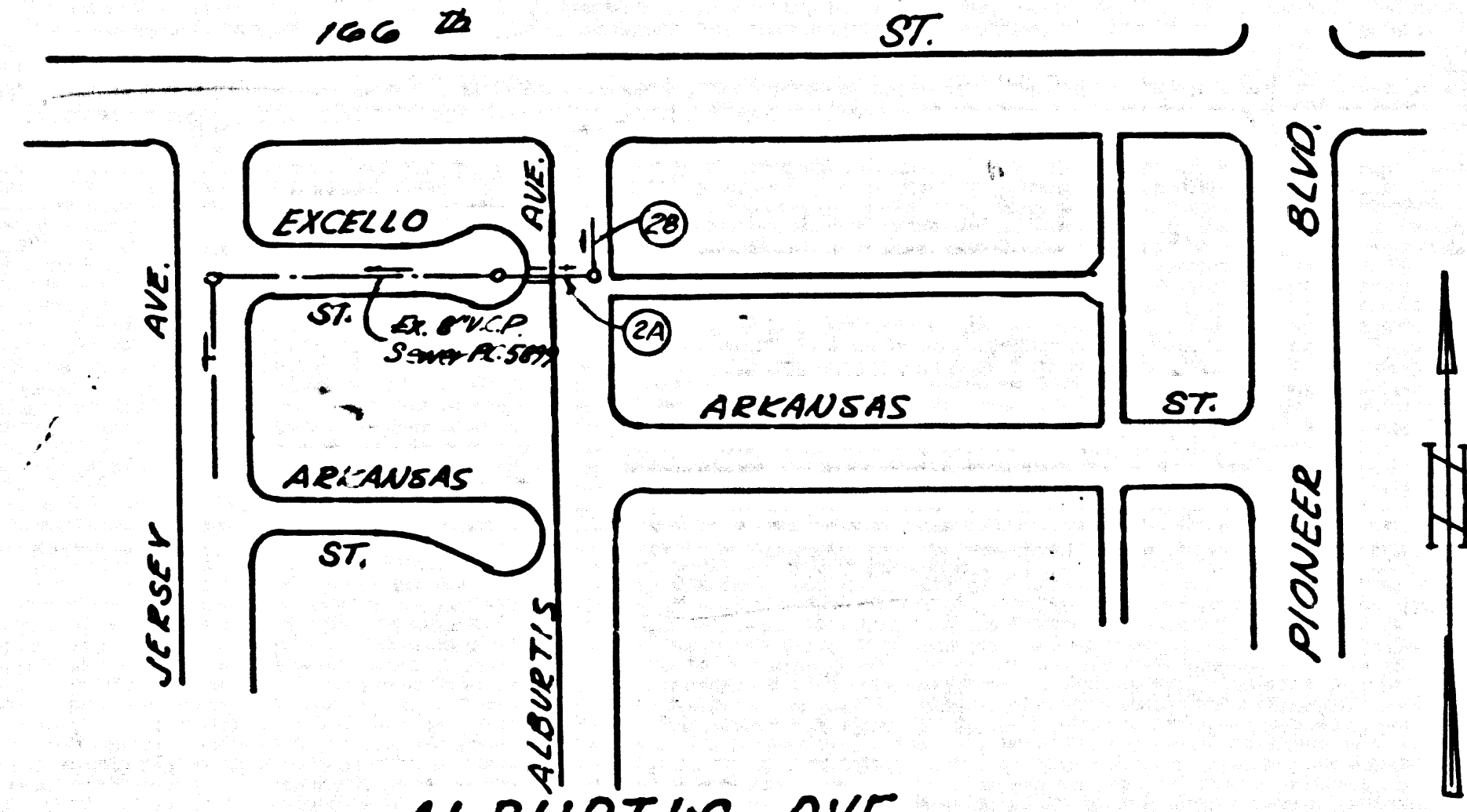

ALBURTO AVE.
 Index Map
 P.C. 7542
 SCALE 1"=200'

Any connection to the sewage system of County Sanitation District, provided directly or indirectly by the sewers shown on these plans, shall be considered a temporary connection district, at which time the connection shall become permanent. If for any reason the annexation to the district of any area sewer hereunder is not completed, the property not in the district will be required to disconnect unless a contract is entered into with the district providing for the disposal of sewage from the area.

PRIVATE ENGINEER'S
 NOTICE TO CONTRACTOR

The existence and location of any underground utility pipes or structures shown on these plans are obtained by a search of the records of the City of Artesia. It is the responsibility of the contractor to verify the location and depth of all utilities shown on this map.
 The Contractor is required to take due precautionary measures to protect the utility lines shown and any other lines not of record or not shown on this drawing.

THE FOLLOWING CITY ENGINEER STANDARD PLANS APPLY TO THIS PROJECT

Legend	S-1
Min. Public Safety Requirements	S-2
Brick Manhole	S-3
Non Reinforced Precast Concrete Manhole	S-5
Reinforced Precast Concrete Manhole	S-6
Manhole Frame and Cover	S-15
Manhole Step	S-17
Bedding for Sewer Pipe	S-21
Cradling and Encasement	S-23
Wye or Tee Support	S-26
Allowable Trench Widths	S-33
Stopper	S-30

ARTESIA BLDG. DIST. NO. 4.09

- PROVIDE STAKES ON THE PROPERTY LINE OR PROPERTY LINES PRODUCED AT RIGHT ANGLES TO THE SEWER LINE AT THE CENTER LINE OF EACH MANHOLE.
- NO REPRESENTATIVE OF THE CITY ENGINEER WILL SURVEY OR LAY OUT ANY PORTION OF THE WORK.
- THE PRIVATE ENGINEER SHALL FURNISH THE CITY ENGINEER WITH GRADE SHEETS AND STATIONING FOR ALL HOUSE LATERALS AND 7 1/2" BRANCHES AND SHALL PROVIDE STAKES FOR THEM AT THEIR PROPER LOCATIONS WITH STATIONING PLAINLY MARKED. ALL HOUSE LATERALS SHALL BE CONSTRUCTED IN A STRAIGHT ALIGNMENT AT RIGHT ANGLES FROM THE MAIN LINE SEWER EXCEPT AS SHOWN ON THE PLANS. HOUSE LATERALS FROM CHIMNEYS SHALL NOT HAVE AN ANGLE OF LESS THAN 45° WITH THE MAIN LINE SEWER. ANY CHANGE IN ALIGNMENT SHALL BE REQUESTED IN WRITING BY THE PRIVATE ENGINEER.
- THE PRIVATE ENGINEER SHALL FURNISH THE HOUSE LATERAL DEPTH AT THE PROPERTY LINE BELOW THE TOP OF CURB ELEVATION FOR EACH HOUSE LATERAL ON THE GRADE SHEET.
- NO REVISIONS SHALL BE MADE IN THESE PLANS WITHOUT THE APPROVAL OF THE CITY ENGINEER.
- THE CONTRACTOR SHALL NOTIFY THE CONSTRUCTION DIVISION BY TELEPHONE, MADISON 9-4747, EXT. 8151, AT LEAST TWENTY-FOUR HOURS BEFORE STARTING ANY WORK UNDER THIS CONTRACT.
- MANHOLES SHALL BE BRICK SEWER STRUCTURES PER S-3. PRECAST CONCRETE MANHOLES PER S-5 OR S-6 MAY BE USED AS AN ALTERNATIVE AS APPROVED BY THE CITY ENGINEER.
- USE STANDARD MANHOLE FRAMES AND COVERS, S-16, EXCEPT AS NOTED.
- MANHOLE TOPS TO BE FINISHED GRADE.
- USE EXTRA STRENGTH PIPE. ALL PIPE IS STANDARD DEPTH EXCEPT AS NOTED.
- WITRIFIED CLAY PIPE JOINTS SHALL BE TYPE "D", OR "C" PER STANDARD SPECIFICATIONS, SEC. 10.
- IF A POWER POLE IS WITHIN THREE FEET OF THE SEWER, THE SEWER SHALL BE ENCASED, PER S-25, TWO FEET ON EACH SIDE FROM THE POINT OF INTERFERENCE.
- IF DURING THE COURSE OF CONSTRUCTION IT IS DETERMINED THAT THERE IS LESS THAN FOUR FEET OF COVER OVER THE TOP OF A MAIN LINE OR HOUSE LATERAL V.C.P. SEWER WHICH IS NOT INDICATED ON THE PLANS, THE PIPE SHALL BE ENCASED PER S-25, UNLESS OTHERWISE APPROVED BY THE CITY ENGINEER.
- HOUSE LATERALS TO BE CONSTRUCTED WITH INVERTS AT PROPERTY LINE 4 FEET BELOW CURB GRADE EXCEPT AS NOTED.
- RESURFACE ALL TRENCHES WITHIN PAVED AREAS TO MEET L.A. COUNTY ROAD DEPT. OR CALIFORNIA STATE HIGHWAY REQUIREMENTS IN ACCORDANCE WITH PERMITS.
- SEWERS TO BE TESTED FOR LEAKAGE PER SECTION 306-E.2.7 SOUTHERN STANDARD SPECIFICATIONS.
- REFER TO SECTION 7-10.41 OF THE STANDARD SPECIFICATIONS, REGARDING SAFETY ORDERS.
- SPECIAL BRACKLE IN DESIGNATED AREAS IS REQUIRED AS TO LOCATING THE NETWORK OF PAVED AREAS AND SLOPE.
- ALL TRENCHES SHALL BE PROTECTED BY THE INSTALLATION OF SAFETY DEVICES AS SPECIFIED IN THE STANDARD SPECIFICATIONS, SEC. 10.1.1.1. ALL TRENCHES SHALL BE PROTECTED BY THE INSTALLATION OF SAFETY DEVICES AS SPECIFIED IN THE STANDARD SPECIFICATIONS, SEC. 10.1.1.1.
- ALL JOINTS BETWEEN CAST IRON PIPE AND WITRIFIED CLAY PIPE SHALL BE MADE WITH A RUBBER SLEEVE JOINT TYPE "C" OR "D" (WITH PROBE IF NECESSARY) PER STANDARD SPEC. SEC. 208.2.
- "V" OR "T" BOMBSHELLS MAY BE USED FOR CONNECTIONS TO MAINLINE SEWERS EXCEPT AS NOTED.

NO CONNECTIONS FOR THE DISPOSAL OF INDUSTRIAL WASTES SHALL BE MADE TO SEWERS SHOWN ON THESE DRAWINGS WITHOUT WRITTEN PERMISSION FROM THE CHIEF ENGINEER AND GENERAL MANAGER OF THE COUNTY SANITATION DISTRICTS.

COLLECT CHARGES AS INDICATED
 [Signature]

Approved [Signature]
 Industrial Waste Division

PROFILE, ALIGNMENT AND GRADE OF P.C. 7542
 SANITARY SEWERS PAGE 1
 TO BE CONSTRUCTED IN
 ALBURTO AVE.

PRIVATE CONTRACT NO. 7542

W.S. 33
 1 SHEET 2 PAGES
 SCALE: VERT. 1"=4' HORIZ. 1"=40'
 Dec. 1965
 41092

PREPARED IN THE OFFICES OF
 Olson Surveying Service Inc.
 by Ronald W. Bishop 1-6-66
 REG. C. E. NO. 8510
 FOR LEGEND SEE PLAN NO. S-1

NOTE:
 GRADES TO WHICH THIS IMPROVEMENT IS TO BE CONSTRUCTED ARE SHOWN ON PLANS AND PROFILE. GRADE POINTS FOR TOP OF CURB, CENTER LINE OF STREETS, OR CENTER LINE OF ALLEYS ARE SHOWN BY CIRCLES ON PROFILE. AT ALL POINTS BETWEEN DESIGNATED POINTS THE GRADE SHALL BE ESTABLISHED SO AS TO CONFORM TO A STRAIGHT LINE DRAWN BETWEEN SAID DESIGNATED POINTS. ELEVATIONS ARE IN FEET ABOVE U.S.C. & G.S. MEAN LEVEL DATUM OF 1929.
 WORK SHALL BE CONSTRUCTED ACCORDING TO THE UNIFORM STANDARD SPECIFICATIONS FOR PUBLIC WORKS, CANSTRUCTION AND CITY ENGINEER SPECIAL PROVISIONS DATED JANUARY 2, 1965, AS REVISED, AND SHALL BE PROSECUTED ONLY IN THE PRESENCE OF THE CITY ENGINEER.
 BEFORE WORK CAN BE STARTED, THE CONTRACTOR MUST OBTAIN A PERMIT TO EXCAVATE IN CITY STREETS FROM THE L.A. COUNTY ROAD DEPT., DISTRICT OFFICE NO. 8, AND MAKE A DEPOSIT WITH THE CITY OF ARTESIA, 117 1/2 EAST 183RD ST., SURVEYOR TO COVER THE COST OF CONSTRUCTION AND RECORD PLANS.
 CONSTRUCTION AND RECORD PLANS APPROVAL OF THIS PLAN BY THE CITY OF ARTESIA DOES NOT CONSTITUTE A REPRESENTATION AS TO THE ACCURACY OF THE LOCATION OF OR THE EXISTENCE OR NON-EXISTENCE OF ANY UNDERGROUND UTILITY PIPE, OR STRUCTURE WITHIN THE LIMITS OF THIS PROJECT. THIS NOTE APPLIES TO ALL PAGES.
 IF WORK IS TO BE DONE IN A STATE HIGHWAY, A PERMIT MUST BE OBTAINED FROM THE STATE OF CALIFORNIA, DIVISION OF HIGHWAYS, 120 SOUTH BRINK STREET, LOS ANGELES, CALIFORNIA.

CITY OF ARTESIA CALIFORNIA
 JOHN A. LAMBIE, CITY ENGINEER J. D. PARKHURST, CHIEF ENGINEER
 CO. SAN. DIST. NO. 4
 APPROVED BY [Signature] APPROVED BY [Signature]
 ASSISTANT SANITATION ENGINEER OFFICE ENGINEER
 CHECKED BY [Signature] REG. C. E. NO. 15731

P.C. 7542 PAGE 2

NO CHARGE FOR CONNECTIONS

