

B.M. 51.926 ELEV. 1302.166
 S.D. 12.175 IN N.W. 1/4 COR. CORNER OF
 S.W. 1/4, SECTION 44, T. 27 N. R. 12 W. OF
 S.W. 1/4, SECTION 44, T. 27 N. R. 12 W. OF
 S.W. 1/4, SECTION 44, T. 27 N. R. 12 W. OF
 HONEY AVENUE 3 1/2 MILES E.W. OF BONDHILL
 CANYON ROAD,
 NEWHALL. QUAD. 1958

THE ACCURACY OF THE LOCATION OF OR THE EXISTENCE OR NON-EXISTENCE OF ANY UTILITY PIPE OR STRUCTURE WITHIN THE
 LIMITS OF THIS PROJECT DOES NOT CONSTITUTE RESPONSIBILITY BY THE ENGINEER.

REVISIONS: AUGUST 1966
 PAGE 2 - RAISED CURB GRADES; ADDED H.L. TO SCHOOL
 SITE FROM STA. 3+30 TO STA. 3+44.0;
 REMOVED STORM DRAINS.
 PAGE 3 - RAISED CURB GRADES, STA. 6+13 TO STA.
 2+85; ADDED STORM DRAINS.
 PAGE 4 - RAISED CURB GRADES.
 PAGE 4-B - RAISED CURB GRADES, STA. 0+67.71 TO
 STA. 2+85; ADDED STORM DRAINS.
 PAGE 5 - ADDED STORM DRAINS; ADDED 4" OF
 ENCASUREMENT ON H.L. TO LOT 55.
 APPROVED: *Ralph Schaffer* 8/5/66
 OFFICE OF COUNTY ENGINEER

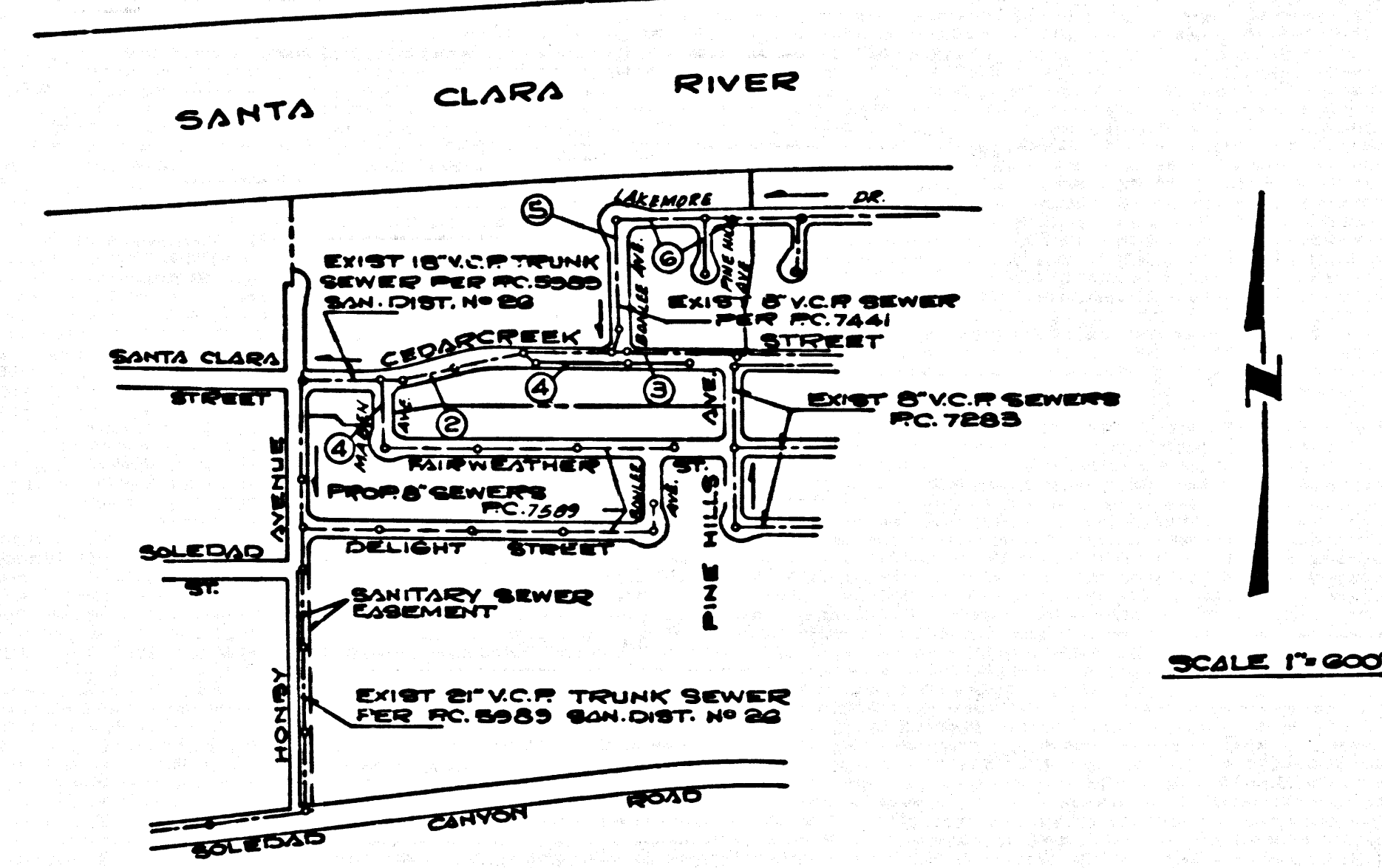

KEY MAP
 TRACT NO. 30319
 P.C. 7588

Any connection to the sewage system of County Sanitation District, provided directly or indirectly by the sewers shown on these plans, shall be considered a temporary connection until all area covered is annexed to said district; at which time the connection shall become permanent. If for any reason the annexation to the district of any area covered hereunder is not completed, the property owner in the district will be required to discontinue unless a contract is entered into with the district providing for the disposal of sewage from the area.

ISSUE NO HOUSE CONNECTION PERMITS UNTIL TRACT NO. 30319 HAS BEEN RECORDED.

NEWHALL BLDG. DIST. NO. 8.2

PROFILE, ALIGNMENT AND GRADE OF
 SANITARY SEWERS PAGE 1

TRACT NO. 30319
 PRIVATE CONTRACT NO. 7588

W.S. 62
 3 SHEETS, 6 PAGES
 SCALE: VERT. 1" = 4' HORIZ. 1" = 40' FEBRUARY, 1966

PREPARED IN THE OFFICES OF
 MCINTIRE AND QUIROS, INC.
 670 MONTEREY PASS ROAD
 MONTEREY PARK, CALIF.
 TEL. 283-7661, 289-5111

FOR LEGEND SEE PLAN NO. S-1

- NOTES:
1. HOUSE STAKES ON THE PROPERTY LINE OR PROPERTY LINES PRODUCED AT RIGHT ANGLES TO THE SEWER LINE AT THE CENTER LINE OF EACH MANHOLE.
 2. NO REPRESENTATIVE OF THE COUNTY ENGINEER WILL SURVEY OR LAY OUT ANY PORTION OF THE WORK.
 3. THE PRIVATE ENGINEER SHALL FURNISH THE COUNTY ENGINEER WITH GRADE SHEETS AND STATIONING FOR ALL HOUSE LATERALS AND "T" BRANCHES AND SHALL PROVIDE STAKES FOR THEM AT THEIR PROPER LOCATIONS WITH STATIONING PLAINLY MARKED. ALL HOUSE LATERALS SHALL BE CONSTRUCTED IN A STRAIGHT ALIGNMENT AT RIGHT ANGLES FROM THE MAIN LINE SEWER EXCEPT AS SHOWN ON THE PLANS. HOUSE LATERALS FROM CHIMNEYS SHALL NOT HAVE AN ANGLE OF LESS THAN 45° WITH THE MAIN LINE SEWER. ANY CHANGE IN ALIGNMENT SHALL BE REQUESTED IN WRITING BY THE PRIVATE ENGINEER.
 4. THE PRIVATE ENGINEER SHALL FURNISH THE HOUSE LATERAL DEPTH AT THE PROPERTY LINE BELOW THE TOP OF CURB ELEVATION FOR EACH HOUSE LATERAL ON THE GRADE SHEET.
 5. NO REVISIONS SHALL BE MADE IN THESE PLANS WITHOUT THE APPROVAL OF THE COUNTY ENGINEER.
 6. THE CONTRACTOR SHALL NOTIFY THE CONSTRUCTION DIVISION BY TELEPHONE, MADISON 9-6747, EXT. 81581, AT LEAST TWENTY-FOUR HOURS BEFORE STARTING ANY WORK UNDER THIS CONTRACT.
 7. MANHOLES SHALL BE BRICK SEWER STRUCTURES PER S.D. PRECAST CONCRETE MANHOLES PER S.D. OR S.D. MAY BE USED AS AN ALTERNATE IN LOCATIONS APPROVED BY THE COUNTY ENGINEER.
 8. USE STANDARD MANHOLE FRAMES AND COVERS, S-1, EXCEPT AS NOTED.
 9. MANHOLE TOPS IN UNIMPROVED RIGHTS-OF-WAY TO BE SIX INCHES ABOVE FINISHED GRADE.
 10. USE EXTRA STRENGTH PIPE, ALL PIPE IS STANDARD BOWEN EXCEPT AS NOTED.
 11. USE MECHANICAL COMPRESSION JOINTS FOR ALL V.C.P. JOINTS PER S.D.C., SECS. 24, 28 & 49.
 12. IF A POWER POLE IS WITHIN THREE FEET OF THE SEWER, THE SEWER SHALL BE ENCASED, PER S.D. 22, TWO FEET ON EACH SIDE FROM THE POINT OF INTERFERENCE.
 13. IF DURING THE COURSE OF CONSTRUCTION IT IS DETERMINED THAT THERE IS LESS THAN FOUR FEET OF COVER OVER THE TOP OF A MAIN LINE OR HOUSE LATERAL V.C.P. SEWER WHICH IS NOT INDICATED ON THE PLANS, THE PIPE SHALL BE ENCASED PER S.D. UNLESS OTHERWISE APPROVED BY THE COUNTY ENGINEER.
 14. HOUSE LATERALS TO BE CONSTRUCTED WITH INVERTS AT PROPERTY LINE 6 FEET BELOW CURB GRADE EXCEPT AS NOTED.
 15. RESURFACE ALL TRENCHES WITHIN PAVED AREAS TO MEET L.A. COUNTY ROAD DEPT. OR CALIFORNIA STATE HIGHWAY REQUIREMENTS IN ACCORDANCE WITH PERMITS.
 16. FOR ALLOWABLE LEAKAGE TEST USE FORMULA NO. 2, S.P.C. 2, SEC. 14.
 17. ALL STATE AND LOCAL TRENCH SAFETY ORDERS WILL BE STRICTLY ENFORCED.

NO CONNECTIONS FOR THE DISPOSAL OF INDUSTRIAL WASTES SHALL BE MADE TO SEWERS SHOWN ON THESE DRAWINGS WITHOUT WRITTEN PERMISSION FROM THE CHIEF ENGINEER AND GENERAL MANAGER OF THE COUNTY SANITATION DISTRICTS.

BEFORE BREAKING INTO ANY EXISTING STRUCTURE AND BEFORE FINAL ACCEPTANCE OF THIS WORK, COUNTY SANITATION DISTRICT (DU 4-1281) SHALL BE NOTIFIED IN ORDER THAT REQUIRED INSPECTION CAN BE MADE.

COLLECT CHARGES AS INDICATED
Ralph Schaffer

COUNTY OF LOS ANGELES, ENGINEER
 JOHN A. LAMBE, COUNTY ENGINEER
 APPROVED BY: *Ralph Schaffer* ASSISTANT SANITATION ENGINEER

J. D. PARKHURST, CHIEF ENGINEER
 CO. SAN. DIST. NO. 8.2
 APPROVED BY: *J. D. Parkhurst* OFFICE ENGINEER

SUBMITTED BY:
 CHECKED BY: *Ralph Schaffer* 6/2/66
 S.W. C.E. NO. 13746

J.N. 0367.20

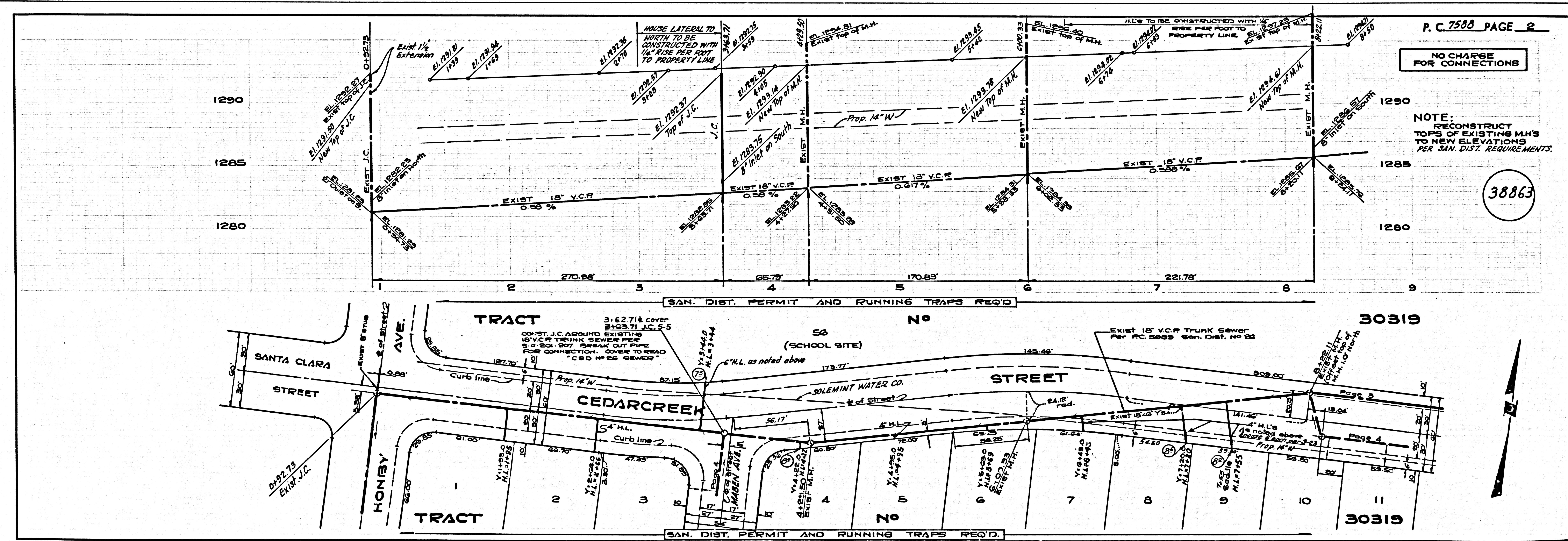

P.C. 7588 PAGE 2
 NO CHARGE FOR CONNECTIONS

NOTE:
 RECONSTRUCT TOPS OF EXISTING M.H.'S TO NEW ELEVATIONS PER SAN. DIST. REQUIREMENTS.

38863

